

BEGIN PROJECT STA. 94+99.21 TO CTA ENTRANCE / RAMP 7&8 INTERSECTION AT 110+00.00

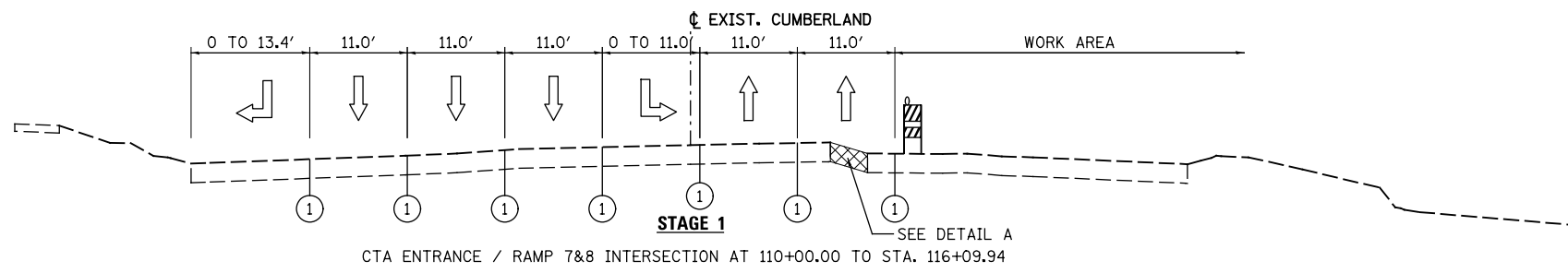

CTA ENTRANCE / RAMP 7&8 INTERSECTION AT 110+00.00 TO STA. 116+09.94

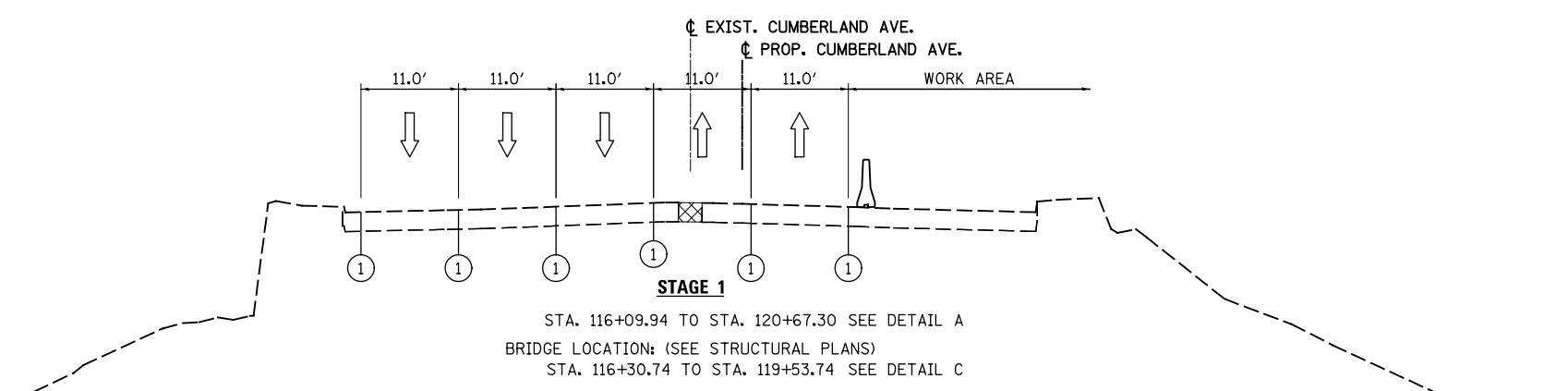

STA. 116+09.94 TO STA. 120+67.30 SEE DETAIL A  
BRIDGE LOCATION: (SEE STRUCTURAL PLANS)  
STA. 116+30.74 TO STA. 119+53.74 SEE DETAIL C

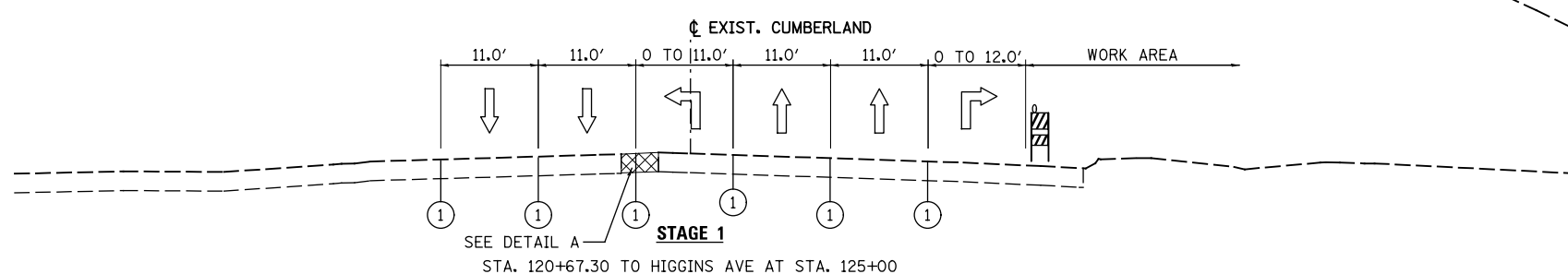

SEE DETAIL A  
STA. 120+67.30 TO HIGGINS AVE AT STA. 125+00

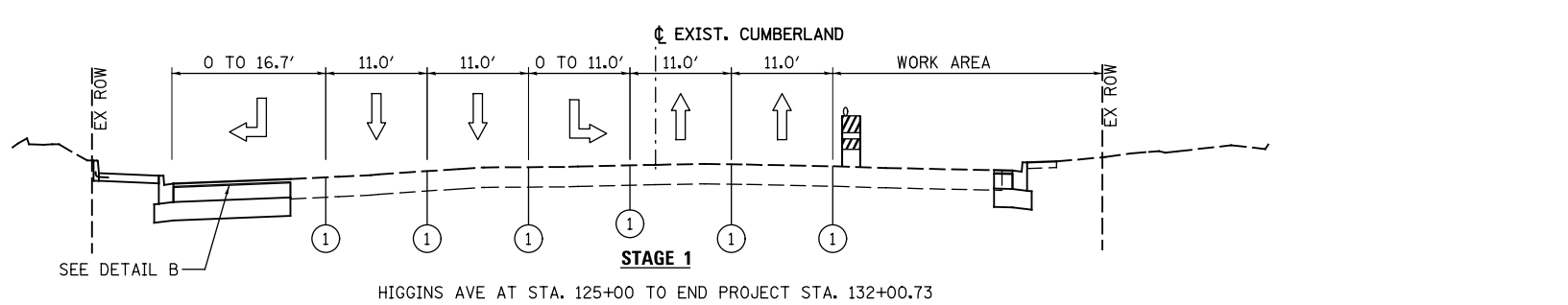

HIGGINS AVE AT STA. 125+00 TO END PROJECT STA. 132+00.73

**TEMPORARY PAVEMENT DETAILS:**

**DETAIL A - FULL DEPTH TEMPORARY PAVEMENT**

(CONTRACTOR HAS THE OPTION OF USING HMA OR PCC SECTION FOR TEMPORARY PAVEMENT)

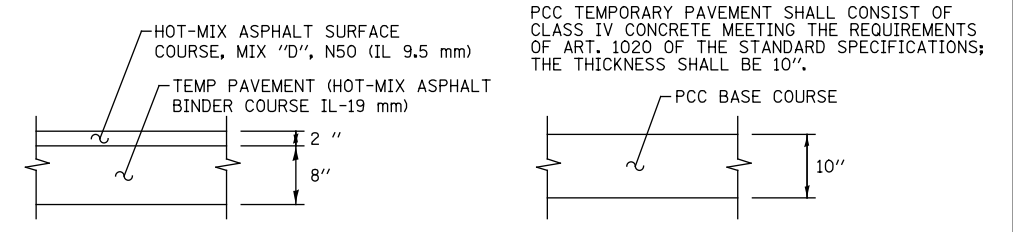

**DETAIL B - PCC BASE COURSE WIDENING AREAS DURING STAGED CONSTRUCTION**

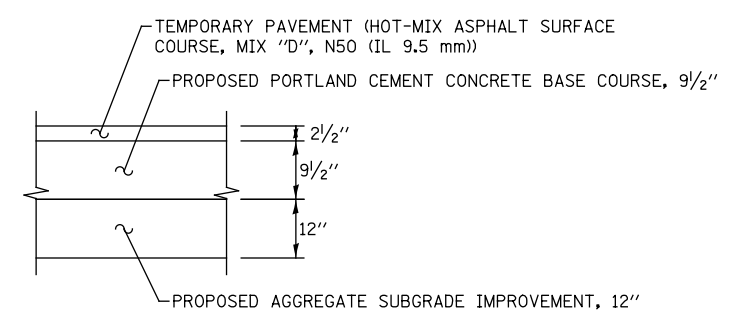

**DETAIL C - MEDIAN REMOVAL PARTIAL DEPTH OVER THE CUMBERLAND AVE BRIDGE**

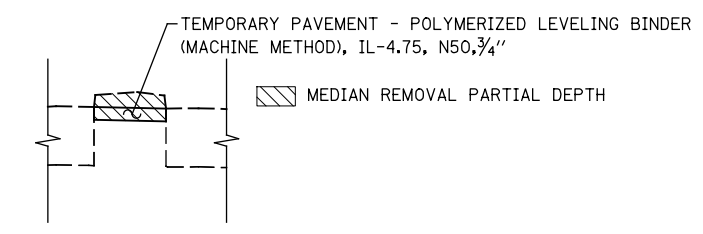

**LEGEND**

- ① TEMPORARY PAVEMENT MARKING
- ② WET REF TEM TAPE T3
- ③ EPOXY PVT MK
- TYPE II BARRICADES OR DRUMS WITH STEADY BURNING LIGHTS (50 FT C-C @ TANGENTS, 25 FT C-C @ TAPERS & 12 FT C-C ALONG RADII)
- TEMPORARY CONCRETE BARRIER
- TEMPORARY PAVEMENT
- GUARDRAIL

**NOTE:**  
SEE THE MAINTENANCE OF TRAFFIC PLAN SHEETS FOR DETAILED LANE CONFIGURATIONS AND TEMPORARY PAVEMENT LOCATIONS.

USER NAME = tkoeppen(Rdwy_L1s1e)	DESIGNED - CPK	REVISED -
PLOT CONFIG = PDF(Grey_Small).plt	DRAWN - CPK	REVISED -
PLOT SCALE = 1:20	CHECKED - JAH	REVISED -
PLOT DATE = 2/18/2013 7:06:32 PM	DATE - 2/18/2013	REVISED -

**STATE OF ILLINOIS  
DEPARTMENT OF TRANSPORTATION**

**SUGGESTED STAGES OF CONSTRUCTION & TRAFFIC CONTROL  
TYPICAL SECTIONS STAGE 1 CUMBERLAND AVE**

SCALE: NA SHEET MOT-04 OF 42 STA. TO STA.

F.A.U. RTE.	SECTION	COUNTY	TOTAL SHEETS	SHEET NO.
2746	1616B	COOK	404	64
				<b>60J14</b>
FED. ROAD DIST. NO.		ILLINOIS FED. AID PROJECT		

G:\DOT\21050\_006\_CumberlandAve\Drawings\CADD Sheets\160J14-sh1-staging\_00\_00\_Typ\_01.dgn