

NOTES:

1. FINAL PAVEMENT MARKING ON PCC PAVEMENT SHALL BE POLYUREA PAVEMENT MARKING.
2. FINAL PAVEMENT MARKING ON HMA PAVEMENT SHALL BE THERMOPLASTIC PAVEMENT MARKING.
3. THE CONTRACTOR SHALL CONTACT WALTER CZARNY AT 847-715-8419 TWO WEEKS PRIOR TO INSTALLING FINAL PAVEMENT MARKINGS.
4. INSTALL RAISED REFLECTIVE PAVEMENT MARKERS PER IDOT DISTRICT ONE STANDARD TC-11
5. CONTRACTOR TO VERIFY THE REMOVAL OF ANY EXISTING SIGNS IN THE FIELD WITH THE ENGINEER

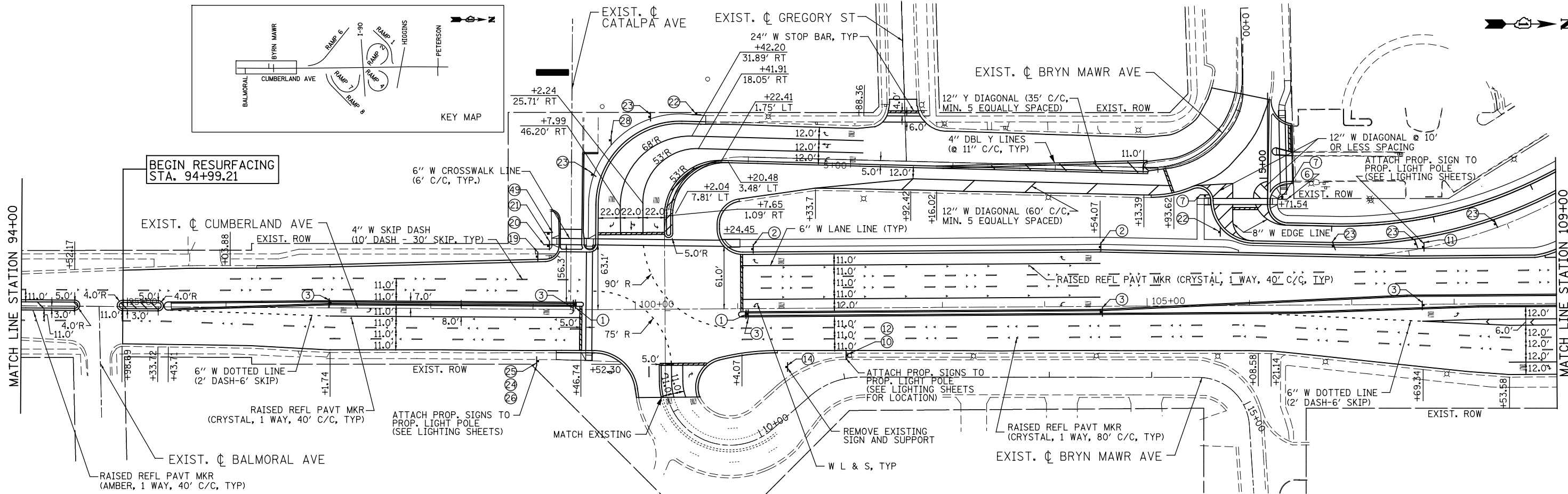
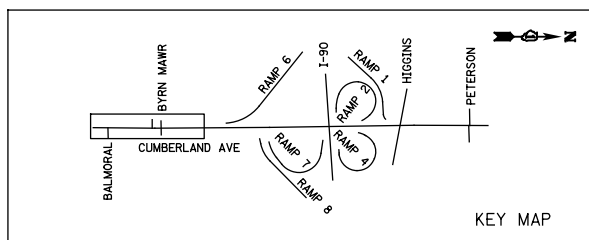
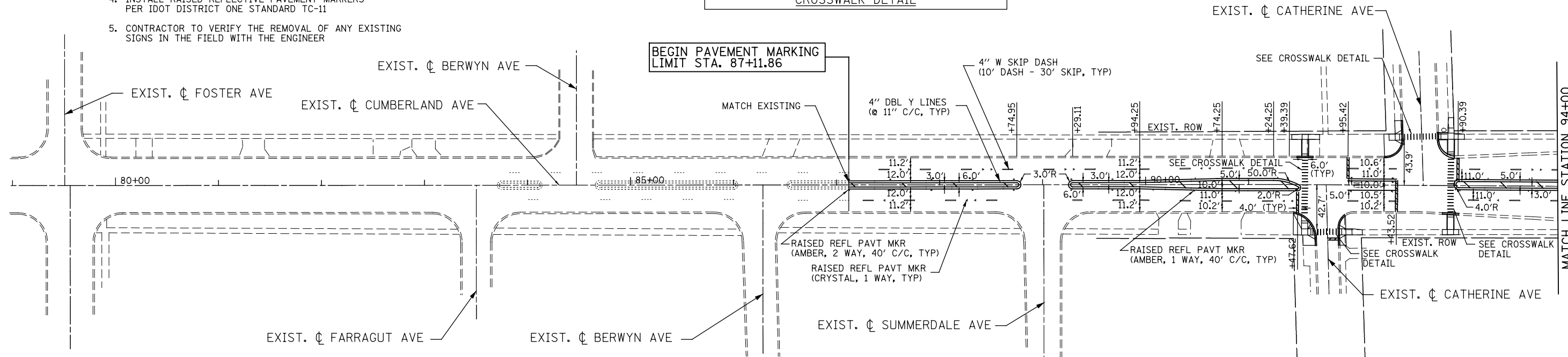
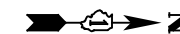
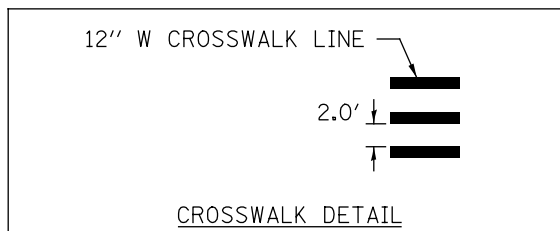

PATRICK ENGINEERING INC.
4970 VARSITY DRIVE
LISLE, IL 60532
patrickengineering.com

USER NAME = tkoeppen@rdwy.lisle
PLOT CONFIG = PDF(Grey_Small).plt
PLOT SCALE = 1:1000
PLOT DATE = 2/18/2013 5:13:11 PM

DESIGNED - CPK
DRAWN - MJP
CHECKED - JAH
DATE - 2/18/2013

REVISED -
REVISED -
REVISED -
REVISED -

STATE OF ILLINOIS
DEPARTMENT OF TRANSPORTATION

PAVEMENT MARKING AND SIGNING PLAN
CUMBERLAND AVENUE

SCALE: 1"=50' SHEET PMK-01 OF 9 STA. 87+11.86 TO STA. 109+00

F.A.U. RTE.	SECTION	COUNTY	TOTAL SHEETS	SHEET NO.
2746	1616B	COOK	404	136
				60J14

FED. ROAD DIST. NO. ILLINOIS FED. AID PROJECT