

NOTE:
THE TRAFFIC SIGNAL CONTROLLER EQUIPMENT FOR THIS PROJECT SHALL BE "EAGLE" TO MATCH THE EXISTING ADJACENT SYSTEM.

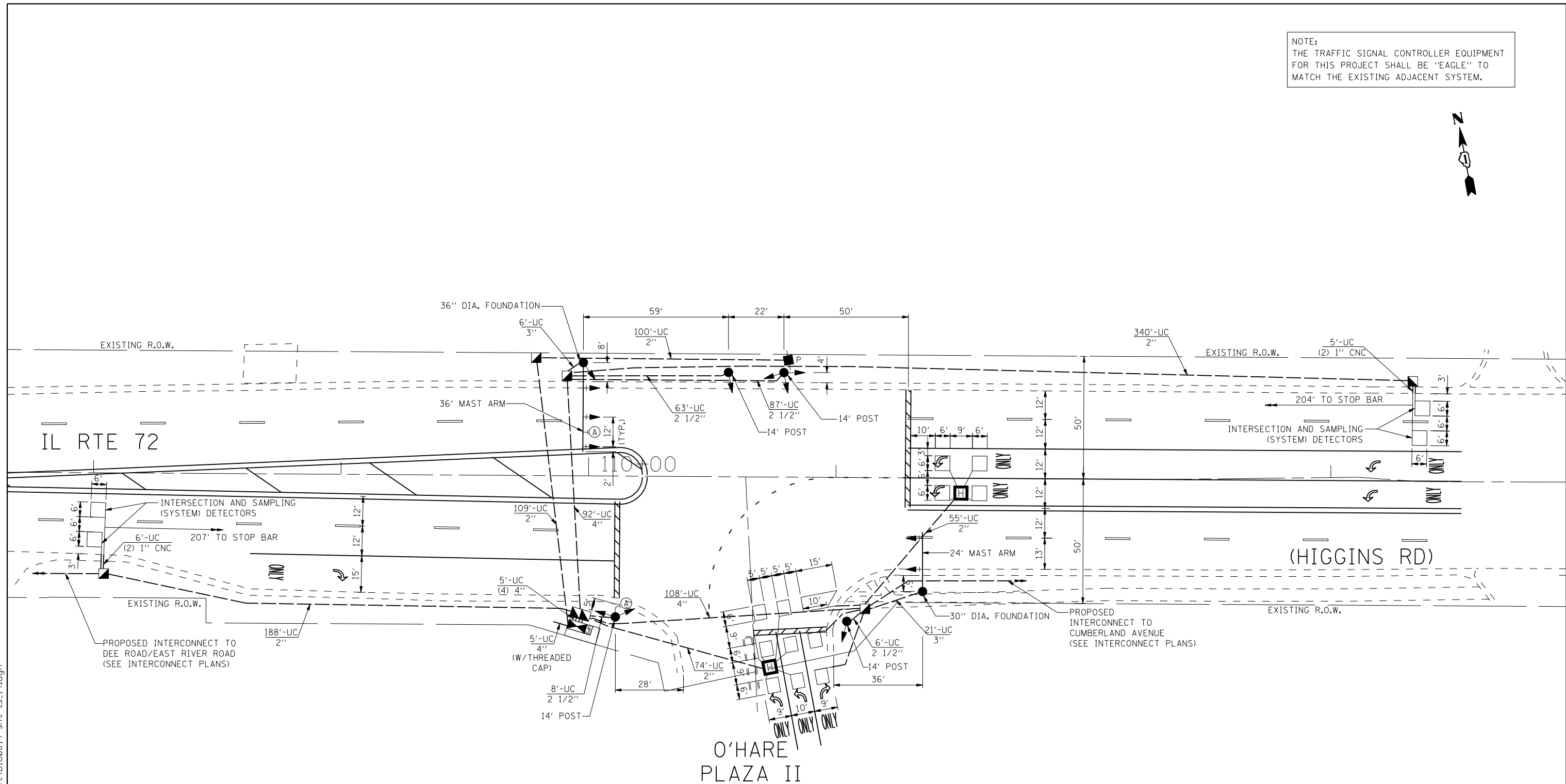

RESTORATION OF WORK AREA, RESTORATION OF THE TRAFFIC SIGNAL WORK AREA SHALL BE INCIDENTAL TO THE RELATED PAY ITEM SUCH AS FOUNDATION, CONDUIT, HANDHOLE, TRENCH AND BACKFILL, ETC., AND NO EXTRA COMPENSATION SHALL BE ALLOWED. ALL ROADWAY SURFACES SUCH AS SHOULDERS, MEDIANS, SIDEWALKS, PAVEMENT, ETC. SHALL BE REPLACED IN KIND. ALL DAMAGE TO MOWED LAWNS SHALL BE REPLACED WITH AN APPROVED SOD, AND ALL DAMAGE TO UNMOWED FIELDS SHALL BE SEEDED IN ACCORDANCE WITH STANDARD SPECIFICATIONS 252 AND 250 RESPECTIVELY.

LEFT ON GREEN ARROW ONLY

SIGN (A)
R10-5
24" X 30"
(2 REQUIRED)

2/18/2013 1:58:46 PM ...sheet\DI60J14-sht-ts_14.dgn

USER NAME =	DESIGNED - GR	REVISED -
	DRAWN - GR	REVISED -
PLOT SCALE =	CHECKED - CG	REVISED -
PLOT DATE =	DATE - 2/18/2013	REVISED -



STATE OF ILLINOIS
DEPARTMENT OF TRANSPORTATION

TRAFFIC SIGNAL INSTALLATION
IL RTE 72 (HIGGINS ROAD) AT O'HARE PLAZA II
SCALE: 1" = 20' SHEET NO. 1 OF 1 SHEETS STA. TO STA.

F.A.U. RTE.	SECTION	COUNTY	TOTAL SHEETS	SHEET NO.
2746	1616B	COOK	404	173
CONTRACT NO. 60J14				
ILLINOIS FED. AID PROJECT				

TS-14