

MATCHLINE STA. 108+54  
SEE SHEET TS-41

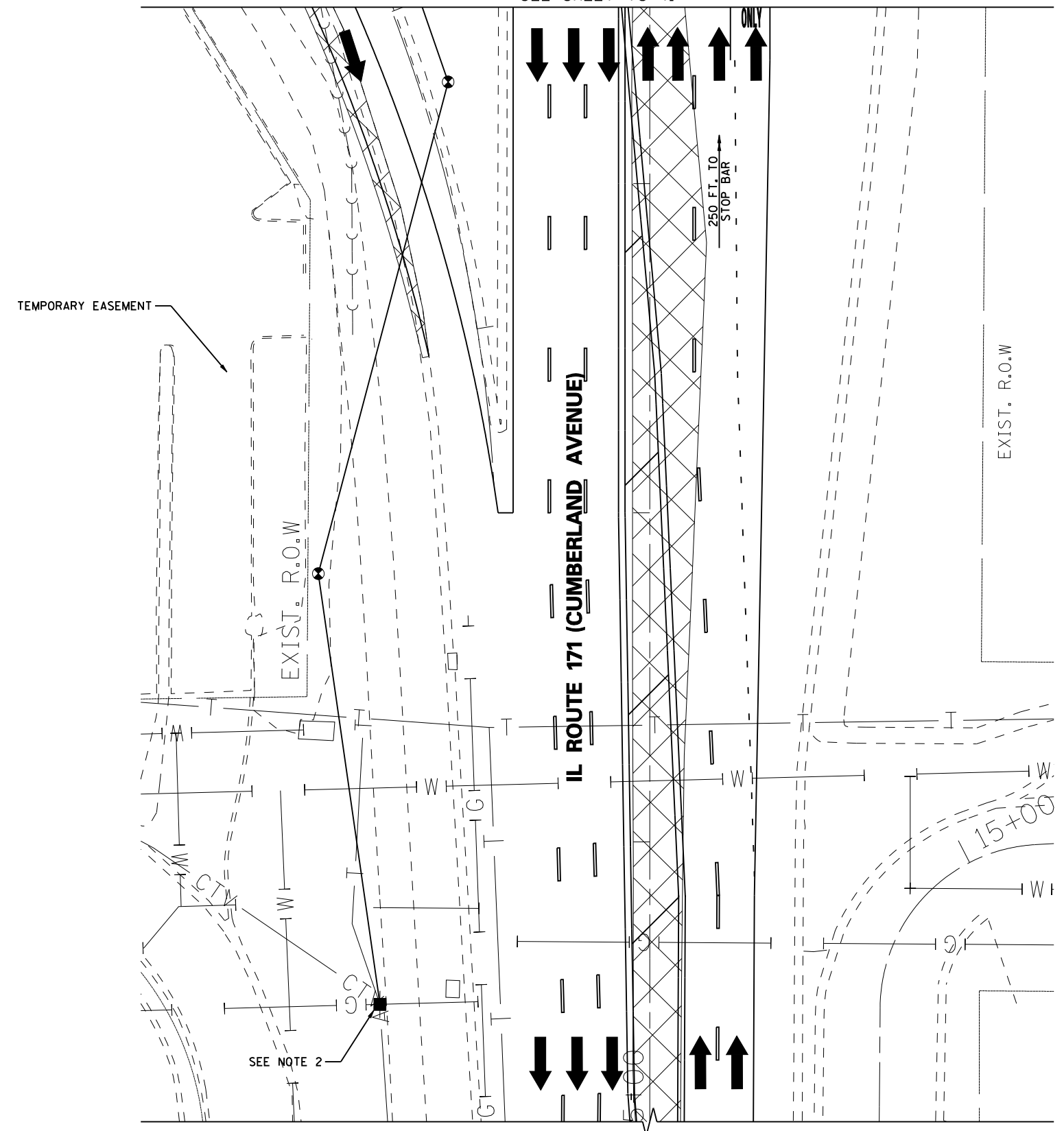

**NOTES:**

1. SYMBOLOGY USED ON THIS SHEET IS IN ACCORDANCE WITH SHEET TS-07.
2. ELECTRICAL AERIAL LINES SHALL BE RELOCATED PRIOR TO CONTRACT BY SERVICE OWNER. LOCATION OF SERVICE IS APPROXIMATE AND SHALL BE DETERMINED IN THE FIELD BY THE ENGINEER. REMOVE TEMPORARY SERVICE INSTALLATION UPON REMOVAL OF TEMPORARY TRAFFIC SIGNALS.

2/18/2013 1:59:56 PM ...sheet\DI60J14-sht-ts\_44.dgn

USER NAME =	DESIGNED - GR	REVISED -
	DRAWN - GR	REVISED -
PLOT SCALE =	CHECKED - CG	REVISED -
PLOT DATE =	DATE - 2/18/2013	REVISED -



**STATE OF ILLINOIS  
DEPARTMENT OF TRANSPORTATION**

**TEMPORARY TRAFFIC SIGNAL INSTALLATION (STAGE 1)  
IL RTE 171 (CUMBERLAND AVENUE) AT CTA ENTRANCE-90 RAMP**

SCALE: 1" = 20'    SHEET NO.    OF    SHEETS    STA.    TO STA.

F.A.U. RTE.	SECTION	COUNTY	TOTAL SHEETS	SHEET NO.
2746	1616B	COOK	404	211
CONTRACT NO. 60J14				
ILLINOIS FED. AID PROJECT				

TS-52