

Bench Mark: PK nail on shoulder, 162' north of the center pier, Sta. 119+42.50 Offset 46.5' RT, Elev. 653.65.

Existing Structure: S.N. 016-0700 built as F.A.U. 2746 under Sec. 267-1616 F-15D in 1958. The existing bridge has four simple spans which consist of a 7" reinforced concrete deck slab resting on 48" PPC I-beams. Span lengths are 31'-9", 81'-9", 81'-9", and 38'-3". The bridge deck is 242'-4" long and 95'-0" wide. Traffic to be maintained utilizing stage construction.

Salvage existing bridge railing. See General Notes.

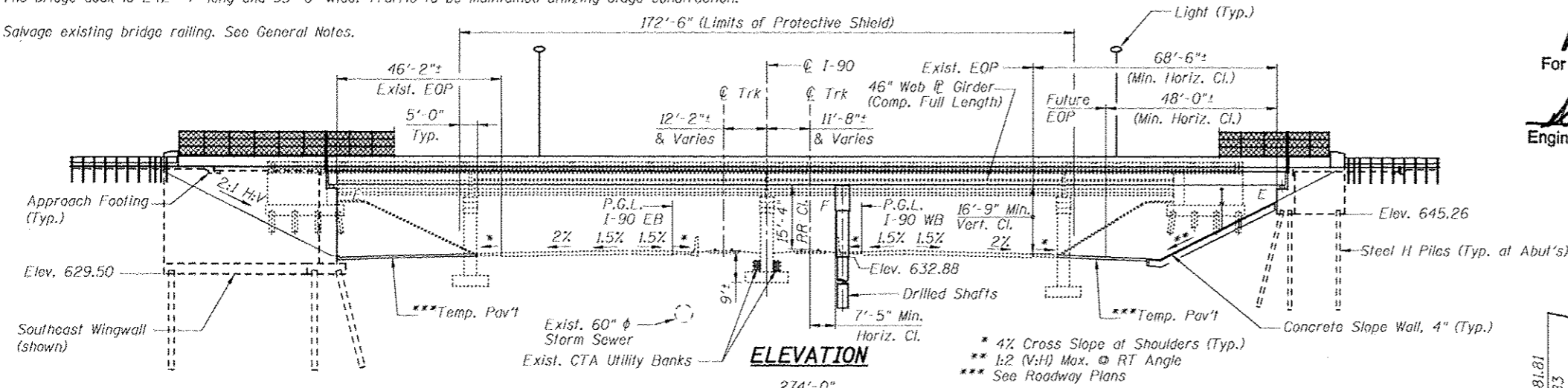

APPROVED
For Structural Adequacy Only
Dr. Carl Ruyger
Engineer of Bridges & Structures

DESIGN SPECIFICATIONS
2010 AASHTO LRFD Bridge Design Specifications with 2010 Interims
LOADING HL-93
Allow 50#/#sq. ft. for future wearing surface.
DESIGN STRESSES
FIELD UNITS
f'c = 3,500 psi
fy = 60,000 psi (Reinforcement)
fy = 50,000 psi (M270 Grade 50)
SEISMIC DATA
Seismic Performance Zone (SPZ) = 1
Design Spectral Acc. at 0.2 sec (SDS) = 0.145g
Design Spectral Acc. at 1.0 sec (SD1) = 0.084g
Soil Site Class = D

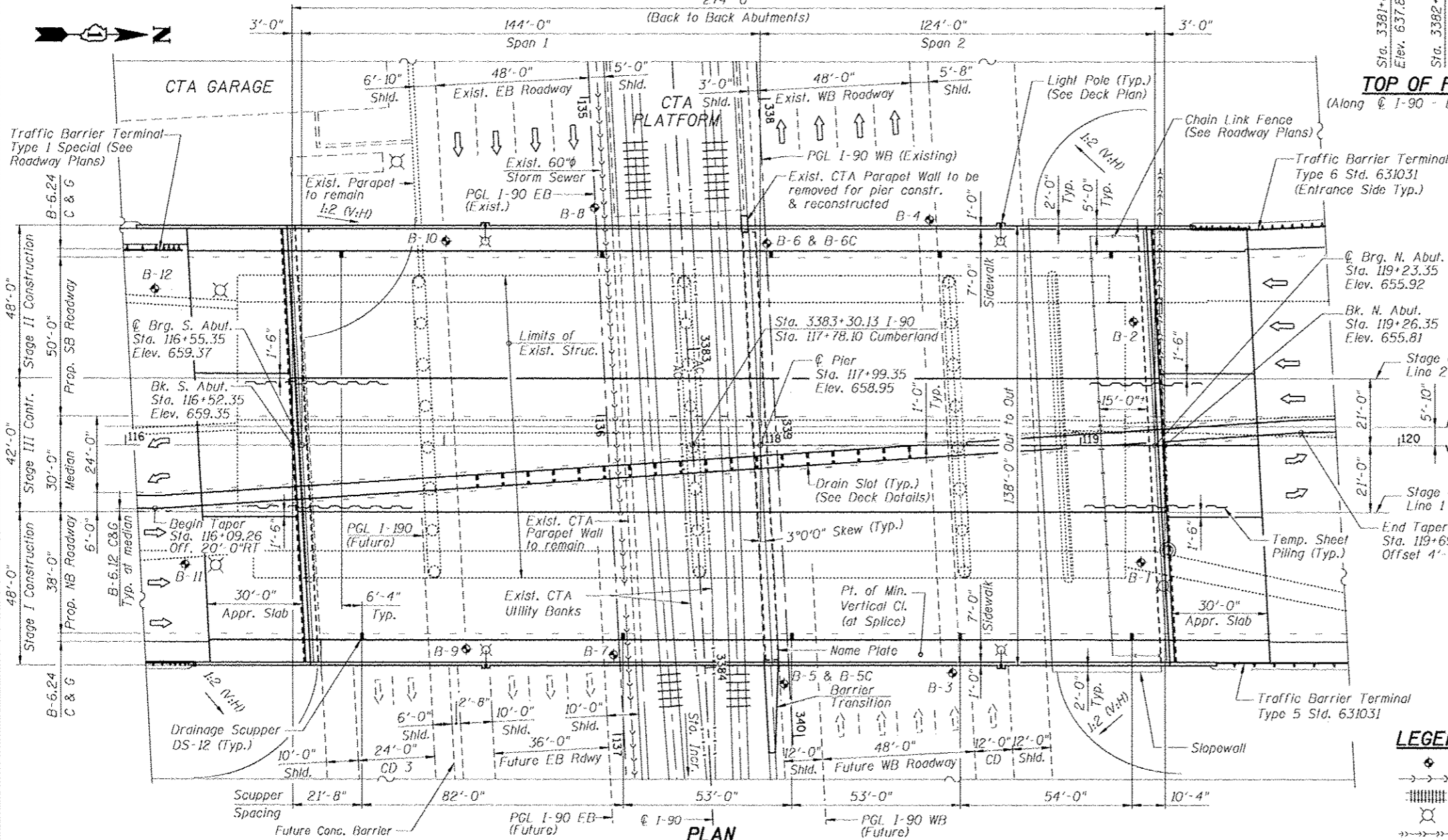
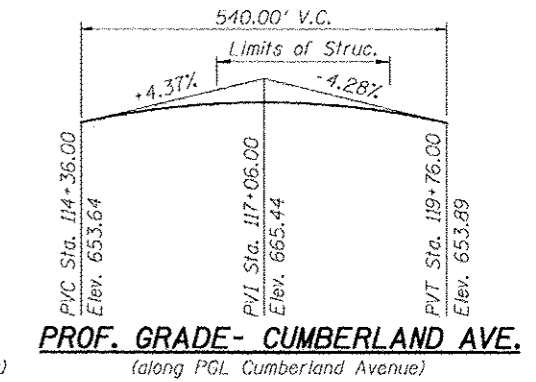
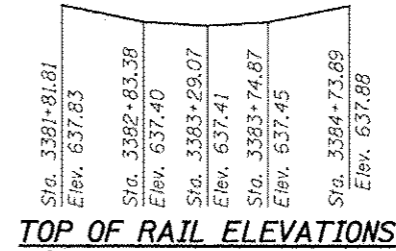

TOP OF RAIL ELEVATIONS
(Along @ I-90 - Existing from CTA Rail Survey)

PROF. GRADE- CUMBERLAND AVE.
(along PGL Cumberland Avenue)

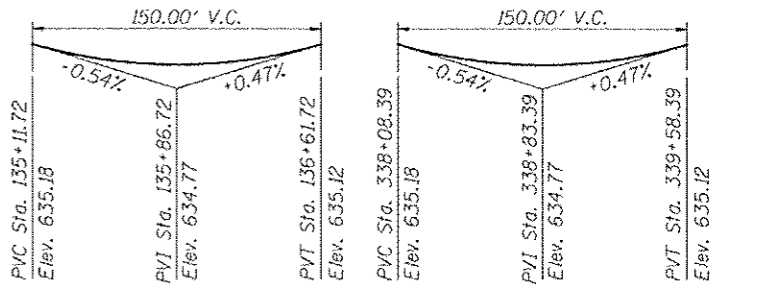

EB PROFILE GRADE- KENNEDY EXPRWY.
(Along PGL I-90 - Existing from Survey Elevations)

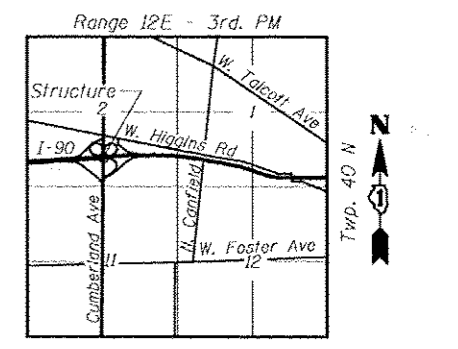

PATRICK ENGINEERING, INC.
ATLAY YARGICOLU, S.E.
081-005358
EXP 11/30/2014
DATE 12/10/2012



LEGEND

- ⊙ Soil Boring
- - - - - Exist. Sewer
- ||||| CTA Track
- ⊗ Exist. Light Pole
- --- --- Exist. Drain

GENERAL PLAN
IL ROUTE 171 (CUMBERLAND AVENUE) OVER INTERSTATE 90 (KENNEDY EXPRESSWAY)
COOK COUNTY
STATION 117+78.10
STRUCTURE NO. 016-1250

PATRICK ENGINEERING, INC.
4970 VARSITY DRIVE
LISLE, IL 60532
patrickengineering.com

USER NAME -
DESIGNED - AY
DRAWN - AY
CHECKED - RLD
DATE - 12/10/2012

REVISOR -
REVISED -
REVISED -
REVISED -

STATE OF ILLINOIS
DEPARTMENT OF TRANSPORTATION

GENERAL PLAN
STRUCTURE NO. 016-1250
SCALE: NONE SHEET NO. S1 OF S59 SHEETS

F.A.U. RTE.	SECTION	COUNTY	TOTAL SHEETS	SHEET NO.
2746	1616B	COOK	368	233
CONTRACT NO. 60J14				
ILLINOIS FED. AID PROJECT				