

s:\projects\3009\_1-90\_cumberland-patrick-work\disciplines\electrical\sheet\DI60J14-sht-light.04.dgn

2:43:20 PM

2/18/2013

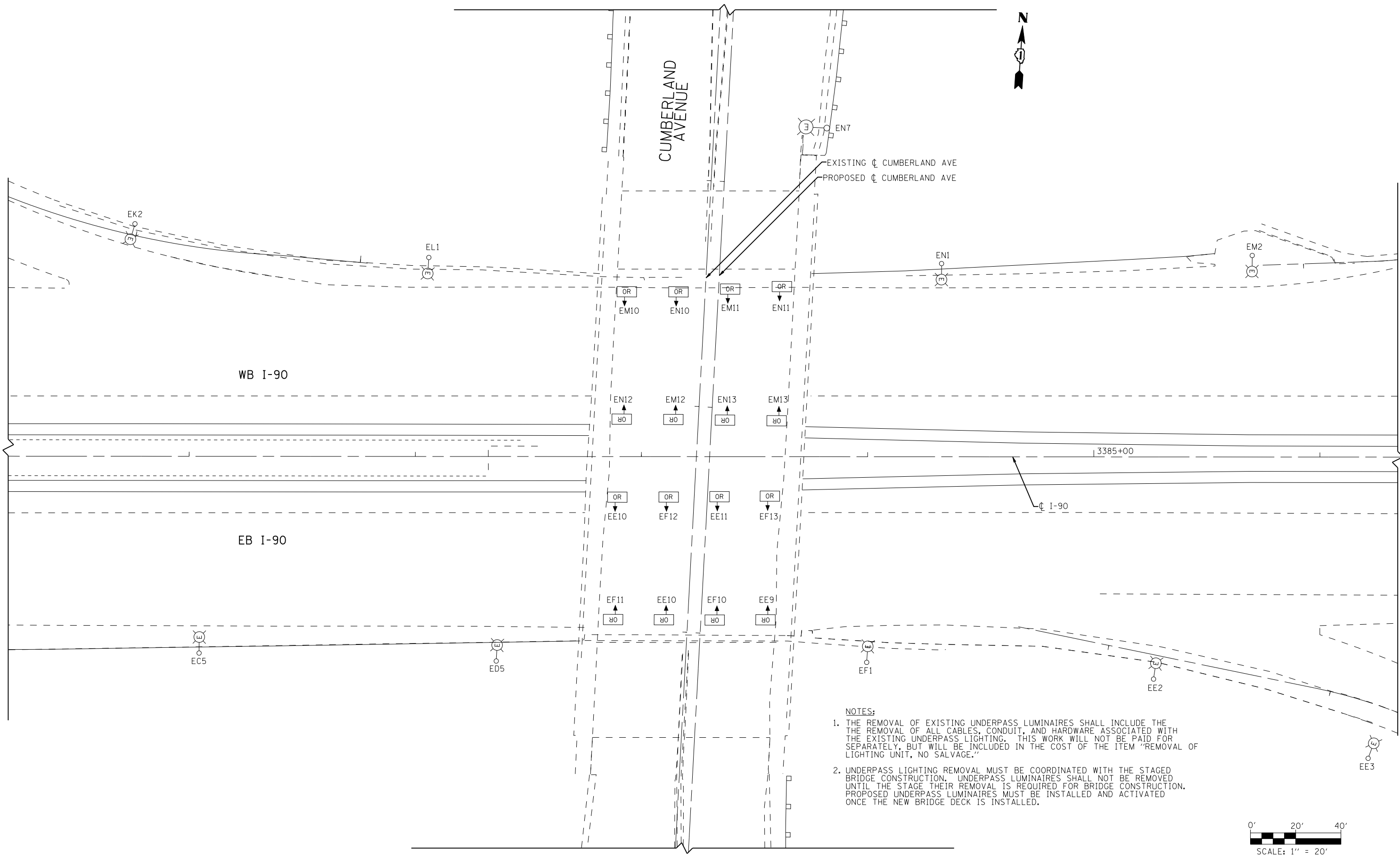

- NOTES:**
1. THE REMOVAL OF EXISTING UNDERPASS LUMINAIRES SHALL INCLUDE THE REMOVAL OF ALL CABLES, CONDUIT, AND HARDWARE ASSOCIATED WITH THE EXISTING UNDERPASS LIGHTING. THIS WORK WILL NOT BE PAID FOR SEPARATELY, BUT WILL BE INCLUDED IN THE COST OF THE ITEM "REMOVAL OF LIGHTING UNIT, NO SALVAGE."
  2. UNDERPASS LIGHTING REMOVAL MUST BE COORDINATED WITH THE STAGED BRIDGE CONSTRUCTION. UNDERPASS LUMINAIRES SHALL NOT BE REMOVED UNTIL THE STAGE THEIR REMOVAL IS REQUIRED FOR BRIDGE CONSTRUCTION. PROPOSED UNDERPASS LUMINAIRES MUST BE INSTALLED AND ACTIVATED ONCE THE NEW BRIDGE DECK IS INSTALLED.

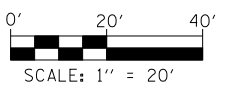

USER NAME =	DESIGNED - RAS	REVISED -
	DRAWN - RAS	REVISED -
PLOT SCALE =	CHECKED - MKR	REVISED -
PLOT DATE =	DATE - 2/18/2013	REVISED -



**STATE OF ILLINOIS  
DEPARTMENT OF TRANSPORTATION**

**IDOT UNDERPASS LIGHTING REMOVAL PLAN  
CUMBERLAND AVENUE OVER I-90**

SCALE: 1" = 20' SHEET NO. 1 OF 1 SHEETS STA. 116+04 TO STA. 119+76

F.A.U. RTE.	SECTION	COUNTY	TOTAL SHEETS	SHEET NO.
2746	1616B	COOK	404	236
CONTRACT NO. 60J14				
ILLINOIS FED. AID PROJECT				

LT-04