

**LEGEND**

- EXISTING INLET
- EXISTING CATCH BASIN
- EXISTING MANHOLE
- ⊕ FRAMES AND LIDS TO BE ADJUSTED, SPECIAL

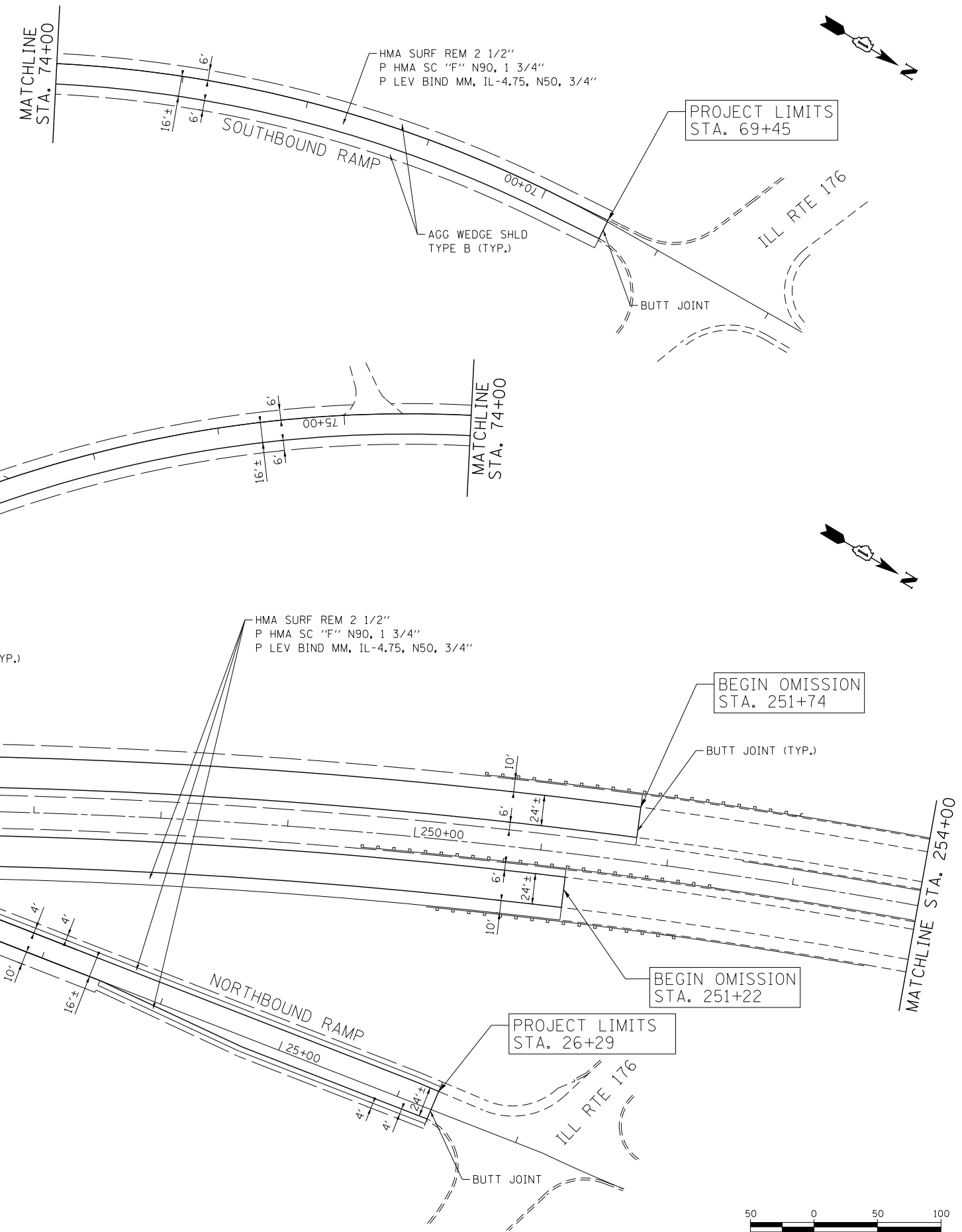

MATCHLINE STA. 239+00

MATCHLINE STA. 254+00



COMPANY NAME: HRGreen  
 PROJECT CONTACT: HRGreen.com  
 DATE PLOTTED: 10/24/2012 9:53:10 AM  
 FILE NAME: 86100196107-plan-04.dgn  
 PLOT DRIVER: pafplot  
 PEN TABLE: standard-trans.tbl



USER NAME = spenel	DESIGNED - CMH	REVISED -
	DRAWN - SMP	REVISED -
PLOT SCALE = 1" = 50'	CHECKED - TEH	REVISED -
PLOT DATE = 10/24/2012	DATE - 10/24/2012	REVISED -

**STATE OF ILLINOIS  
DEPARTMENT OF TRANSPORTATION**

**ROADWAY PLAN  
U.S. ROUTE 12 (OLD RAND RD/MAIN STREET TO FISH LAKE RD.)**

SCALE: 1" = 50'    SHEET NO. 4 OF 14 SHEETS    STA. 239+00 TO STA. 254+00

F.A. RTE.	SECTION	COUNTY	TOTAL SHEETS	SHEET NO.
334	TR-RS-3	LAKE	52	11
FED. ROAD DIST. NO. ILLINOIS FED. AID PROJECT			CONTRACT NO. 60N25	