

QUANTITY
 4 (100) LINE = 64.1 ft. (19.7 m)
 21.1 sq. ft. (1.97 sq. m)

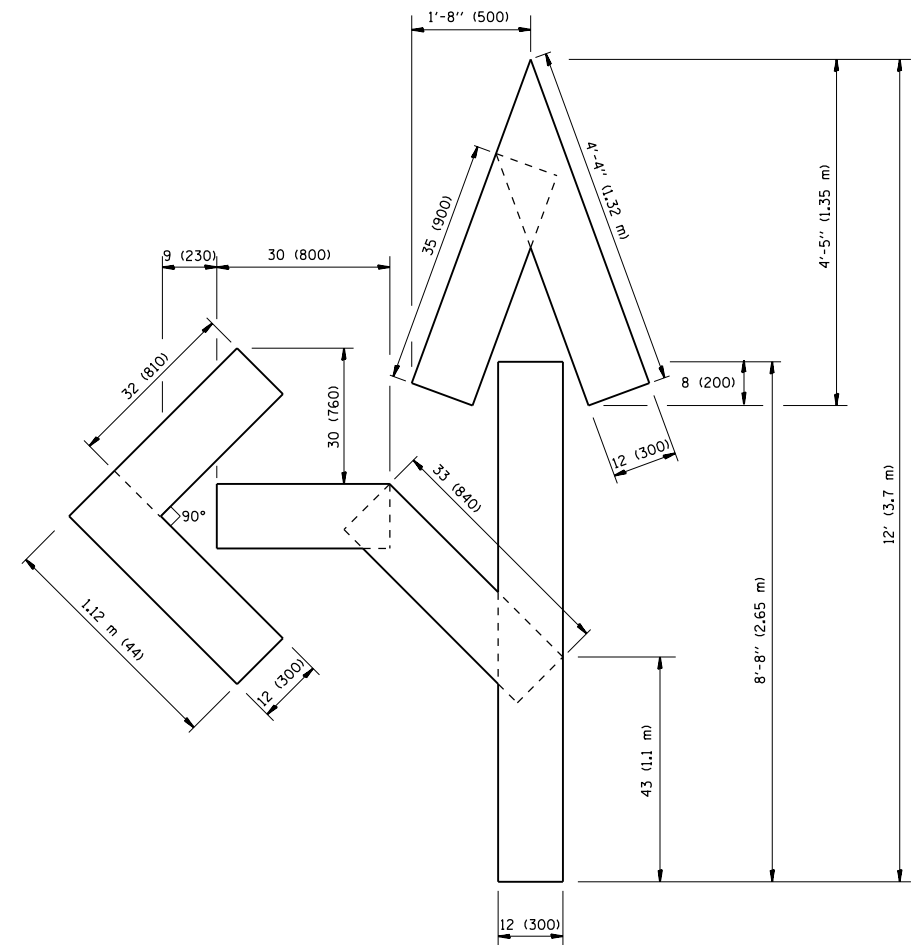

QUANTITY
 4 (100) LINE = 82.5 ft. (25.3 m)
 27.5 sq. ft. (2.53 sq. m)

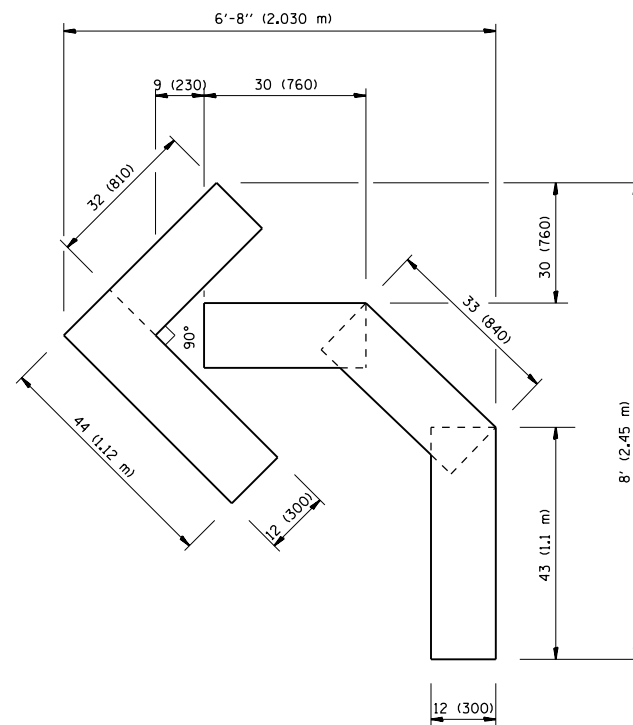

QUANTITY
 4 (100) LINE = 45.5 ft. (13.9 m)
 15.2 sq. ft. (1.39 sq. m)

All dimensions are in inches (millimeters) unless otherwise shown.

| | | | |
|---|-----------------------------|-----------------|--------------------------------|
| FILE NAME = | USER NAME = 11aydj | DESIGNED - | REVISED -T. RAMMACHER 06-05-96 |
| et:\pwork\pwork\11aydj\11aydj\0249858\DistStd.dgn | | DRAWN - | REVISED -T. RAMMACHER 11-04-97 |
| | PLOT SCALE = 100.0000' / 1" | CHECKED - | REVISED -T. RAMMACHER 03-02-98 |
| | PLOT DATE = 12/10/2012 | DATE - 09-18-94 | REVISED -E. GOMEZ 08-28-00 |

STATE OF ILLINOIS
 DEPARTMENT OF TRANSPORTATION

PAVEMENT MARKING LETTERS AND SYMBOLS
 FOR TRAFFIC STAGING

SCALE: NONE SHEET NO. 1 OF 1 SHEETS STA. TO STA.

| | | | | |
|---|-----------|--------|--------------------|-----------|
| F.A.P. RTE. | SECTION | COUNTY | TOTAL SHEETS | SHEET NO. |
| 307 | 542R-2-RS | DuPAGE | 34 | 31 |
| TC-16 | | | CONTRACT NO. 60N47 | |
| FED. ROAD DIST. NO. 1 ILLINOIS FED. AID PROJECT | | | | |