

F.A.P. RTE.	SECTION	COUNTY	TOTAL SHEETS	SHEET NO.
344	540R-RS-2	DUPAGE & COOK	49	1
		ILLINOIS	CONTRACT NO. 60N49	

STATE OF ILLINOIS
DEPARTMENT OF TRANSPORTATION
DIVISION OF HIGHWAYS

**PROPOSED
HIGHWAY PLANS**

F.A.P. 344: ILLINOIS ROUTE 83
SECTION: 540R-RS-2
ILLINOIS ROUTE 19 TO ILLINOIS ROUTE 72
RESURFACING (3P), DRAINAGE
DUPAGE & COOK COUNTIES

C-91-319-11

FOR INDEX OF SHEETS, SEE SHEET NO. 2

PROJECT LOCATED WITHIN
THE VILLAGE OF ELK GROVE VILLAGE,
THE VILLAGE OF BENSENVILLE,
AND THE CITY OF WOOD DALE

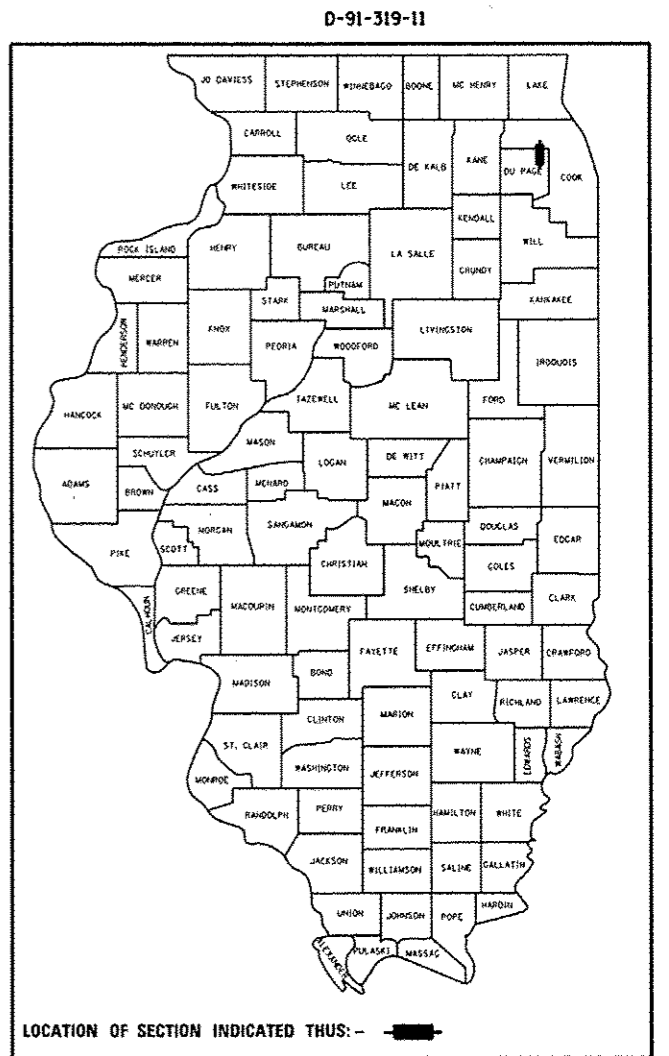

LOCATION OF SECTION INDICATED THUS: - [black rectangle] -

TRAFFIC DATA
ILLINOIS ROUTE 83
2011 ADT = 43300
SPEED LIMIT = 45MPH

PROJECT ENDS
STA. 1279 + 00

OMISSION
STA. 1207 + 62 TO
STA. 1217 + 05

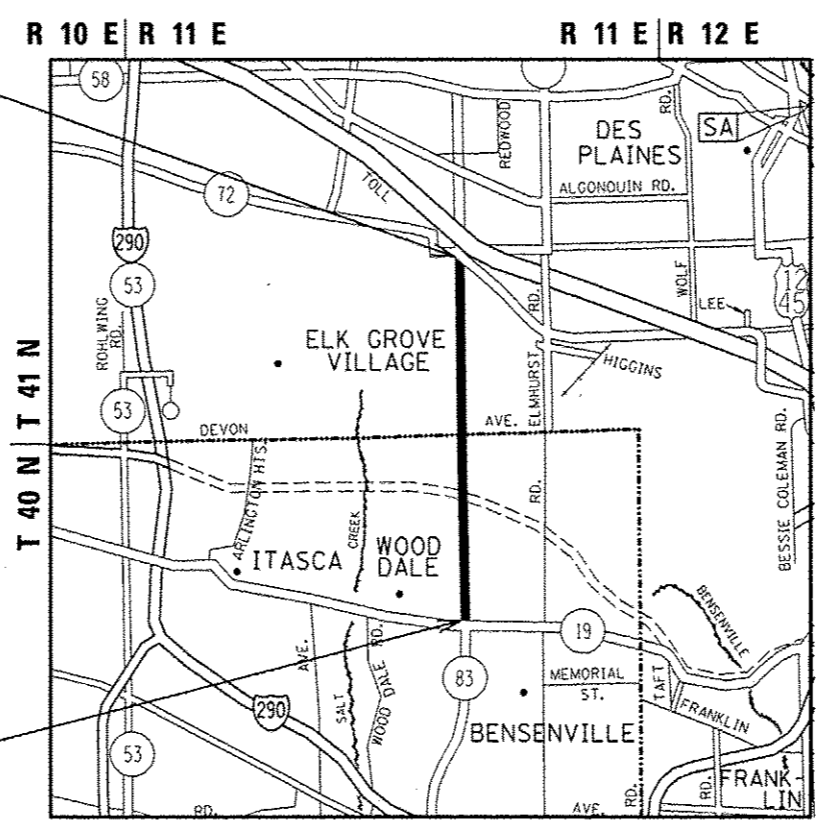

OMISSION
STA. 1186 + 40 TO
STA. 1196 + 20

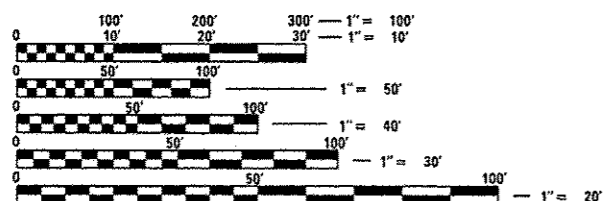

FULL SIZE PLANS HAVE BEEN PREPARED USING STANDARD
ENGINEERING SCALES. REDUCED SIZED PLANS WILL NOT
CONFORM TO STANDARD SCALES. IN MAKING MEASUREMENTS
ON REDUCED PLANS, THE ABOVE SCALES MAY BE USED.

PROJECT BEGINS
STA. 1056 + 51

J.U.L.I.E.
JOINT UTILITY LOCATION INFORMATION FOR EXCAVATION
1-800-892-0123
OR 811

ELK GROVE AND ADDISON TOWNSHIP

GROSS LENGTH = 22249 FT. = 4.21 MILE
NET LENGTH = 20326 FT. = 3.85 MILE

PROJECT ENGINEER: DANIEL WILGREEN (847) 705-4240
PROJECT MANAGER: KEN ENG (847) 705-4247

CONTRACT NO. 60N49

STATE OF ILLINOIS
DEPARTMENT OF TRANSPORTATION
DIVISION OF HIGHWAYS

SUBMITTED February 14, 2013
John Fiat, DEPUTY DIRECTOR OF HIGHWAYS, REGION ENGINEER
March 22, 2013
John D. Baranzelli, PE, acting ENGINEER OF DESIGN AND ENVIRONMENT
March 22, 2013
Omer Osman, PE, DIRECTOR OF HIGHWAYS, CHIEF ENGINEER

**PRINTED BY THE AUTHORITY
OF THE STATE OF ILLINOIS**