

WORK SHALL MEET THE REQUIREMENTS OF THE SPECIAL PROVISION, "TRAFFIC SIGNAL SPECIFICATIONS FOR DETECTOR LOOP REPLACEMENT AND/OR INSTALLATION ON ROADWAY GRINDING, RESURFACING AND PATCHING OPERATIONS". SPECIAL ATTENTION MUST BE MADE TO THE SECTIONS "INSPECTION OF CONSTRUCTION" AND "DETECTOR LOOP REPLACEMENT" FOR INSTALLATION AND INSPECTION REQUIREMENTS. LOOP REPLACEMENT WORK THAT DOES NOT MEET THE CONTRACT REQUIREMENTS SHALL NOT BE PAID. WORK NECESSARY TO COMPLETE THE LOOP REPLACEMENT WORK MAY BE ASSIGNED BY THE ENGINEER TO IDOT'S ELECTRICAL MAINTENANCE CONTRACTOR (EMC); ALL RELATED COSTS WILL BE THE RESPONSIBILITY OF THE CONTRACTOR.

TRAFFIC SIGNAL LEGEND

- SIGNAL HEAD WITH BACKPLATE
- SIGNAL HEAD
- GALVANIZED STEEL CONDUIT IN TRENCH OR PUSHED
- DETECTOR LOOP
- VEHICLE DETECTOR, NON COMPENSATED MAGNETIC TYPE
- RACEWAY FOR MAGNETIC DETECTOR, TYPE I OR TYPE II

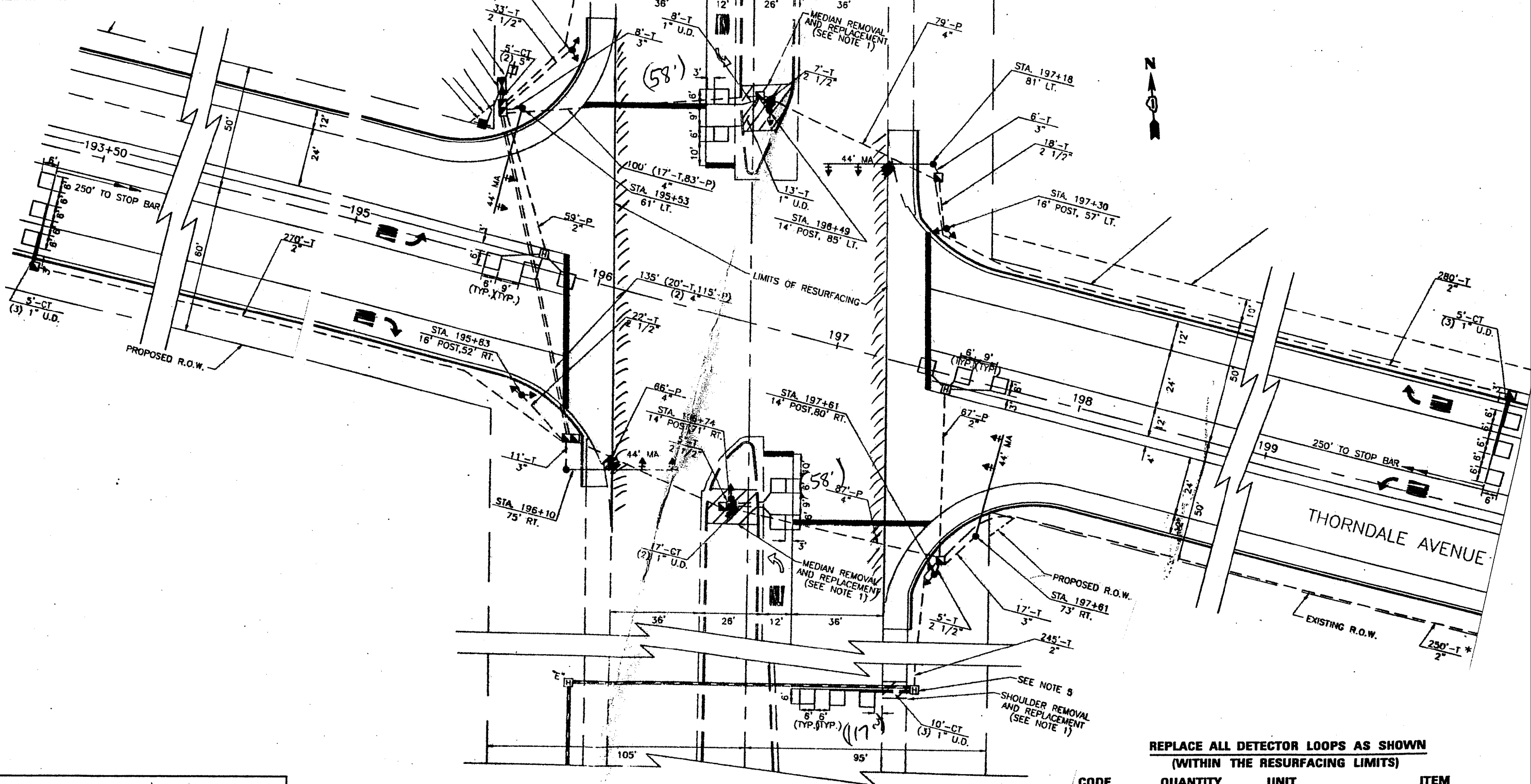
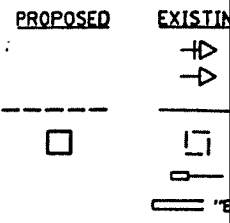

THIS PLAN IS FOR THE SOLE PURPOSE OF DETECTOR LOOP REPLACEMENTS ONLY

REPLACE ALL DETECTOR LOOPS AS SHOWN (WITHIN THE RESURFACING LIMITS)

CODE	QUANTITY	UNIT	ITEM
88600600	350	FOOT	DETECTOR LOOP, REPLACEMENT

FILE NAME =	USER NAME = rechenbachr1	DESIGNED -	REVISED -
et:\pw\work\p1dot\rechenbachr1\d0315650	DJ131911-sh1-plan.dgn	DRAWN -	REVISED -
\$MODELNAME\$	PLOT SCALE = 100.0000' / 1"	CHECKED -	REVISED -
	PLOT DATE = 2/14/2013	DATE -	REVISED -

STATE OF ILLINOIS
DEPARTMENT OF TRANSPORTATION

DISTRICT ONE - DETECTOR LOOP REPLACEMENT
IL ROUTE 83 AT THORNDALE AVE.

SCALE: SHEET OF SHEETS STA. TO STA.

F.A.P. RTE.	SECTION	COUNTY	TOTAL SHEETS	SHEET NO.
344	540R-RS-2	DUPAGE&COOK	49	33

CONTRACT NO. 60N49
ILLINOIS FED. AID PROJECT