

IMPROVEMENT BEGINS
STA. 115+83

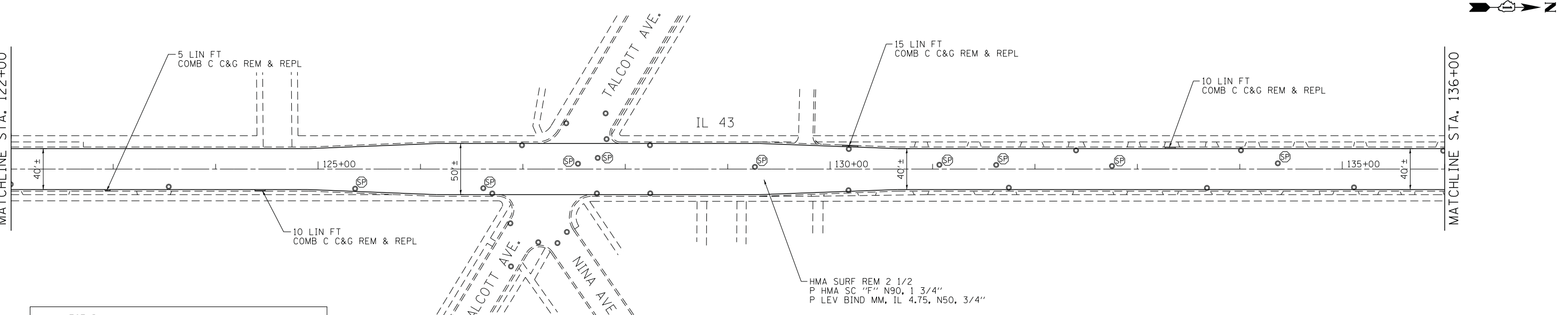
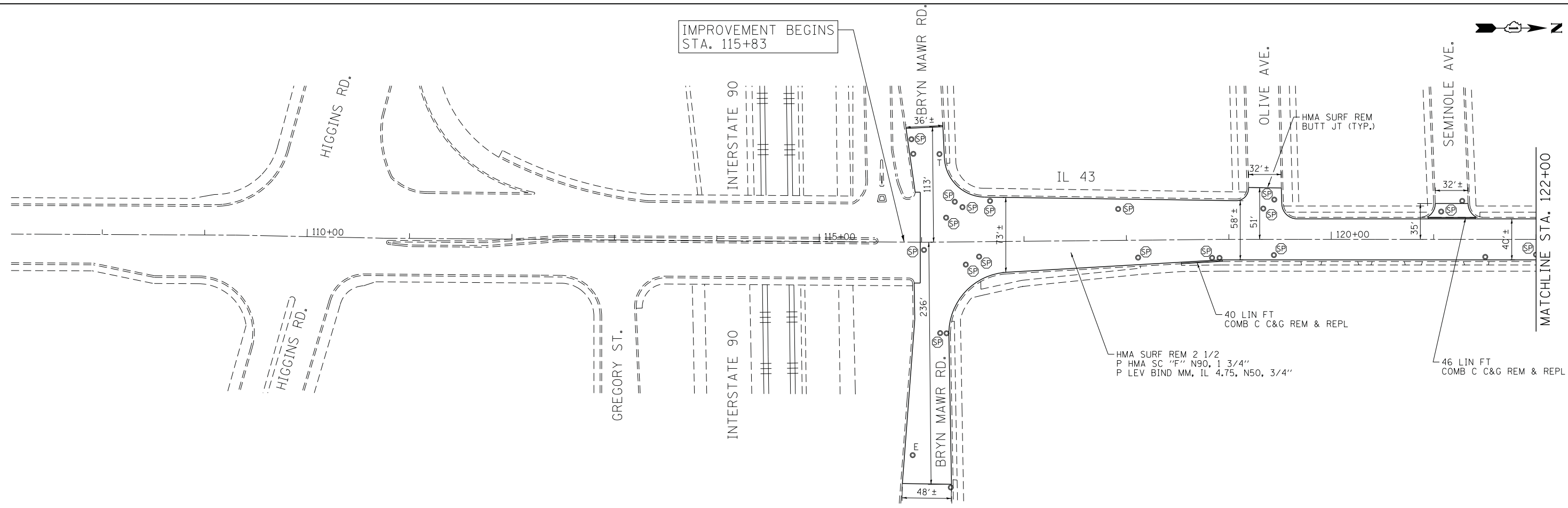

LEGEND

- EXISTING INLET
- EXISTING CATCH BASIN
- EXISTING MANHOLE
- E ELECTRIC
- T TELEPHONE (ADJUSTMENTS PERFORMED BY OTHERS)
- G GAS (ADJUSTMENTS PERFORMED BY OTHERS)
- ⊙ SP FRAMES AND LIDS TO BE ADJUSTED, SPECIAL
- ⊙ ADJ FRAMES AND LIDS TO BE ADJUSTED

COMPANY NAME: HRGreen
 PROJECT CONTACT: [Redacted]
 DATE PLOTTED: 2/6/2013 9:20:15 PM
 FILE NAME: 86100196_15-plan-01.dgn
 PLOT DRIVER: pafcah
 PEN TABLE: standard-trans.tbl



USER NAME = spenel	DESIGNED - CMH	REVISED -
PLOT SCALE = 1"=50'	DRAWN - SMP	REVISED -
PLOT DATE = 2/6/2013	CHECKED - TEH	REVISED -
	DATE - 2/6/13	REVISED -

**STATE OF ILLINOIS
DEPARTMENT OF TRANSPORTATION**

**ROADWAY PLAN
ILLINOIS ROUTE 43 (IL RTE. 72 TO OAKTON ST.)**

SCALE: 1"=50' SHEET NO. 1 OF 6 SHEETS STA. 115+83 TO STA. 136+00

F.A. RTE.	SECTION	COUNTY	TOTAL SHEETS	SHEET NO.
348	2011-080-RS	COOK	44	9
FED. ROAD DIST. NO. ILLINOIS FED. AID PROJECT			CONTRACT NO. 60R07	

86100196_15
 86100196_15-plan-01.dgn