

MATCHLINE "O" SEE SHEET 8 OF 13 FOR CONTINUATION

MATCHLINE "I" SEE SHEET 5 OF 13 FOR CONTINUATION

MATCHLINE "J" SEE SHEET 7 OF 13 FOR CONTINUATION

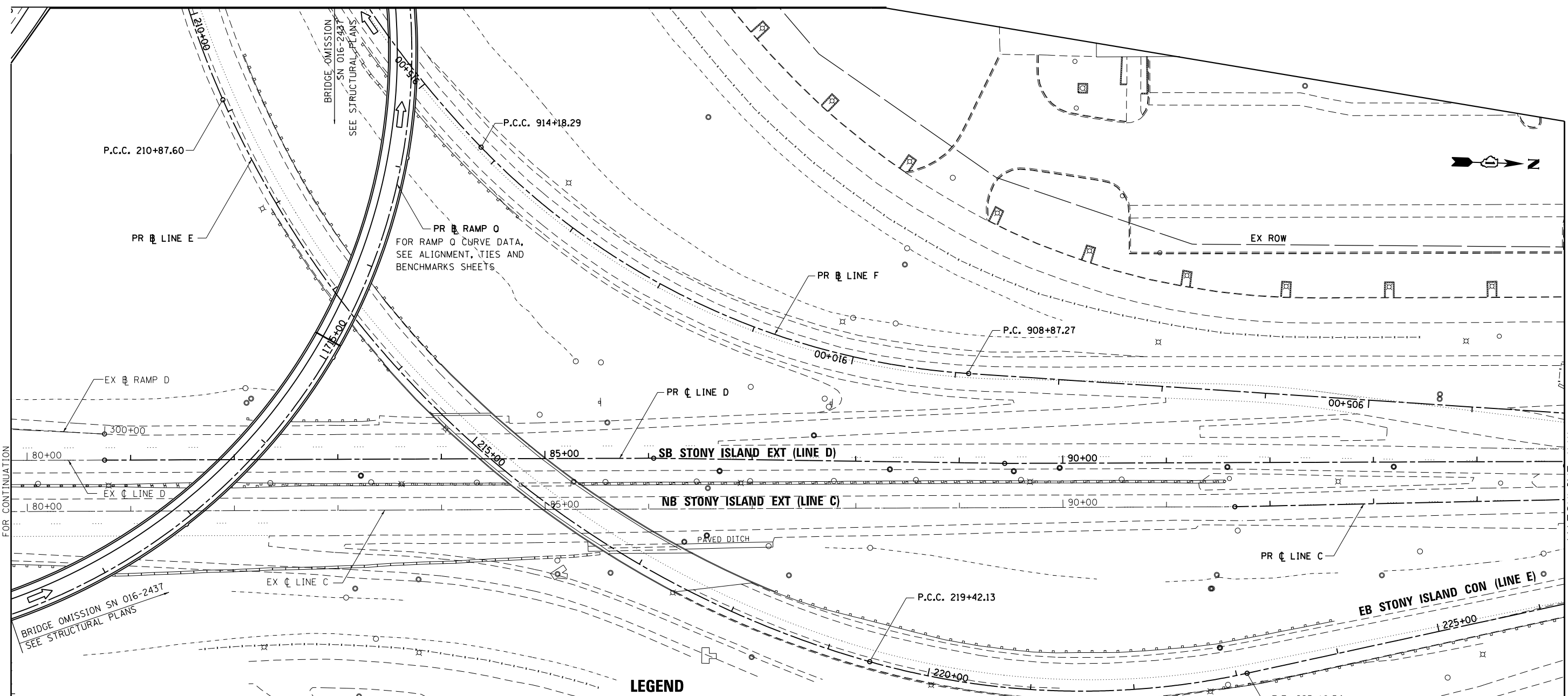

LEGEND

- ① STABILIZED SUBBASE - HOT-MIX ASPHALT, 4 1/2"
- ② AGGREGATE BASE COURSE, TYPE B (6")
- ③ HOT-MIX ASPHALT BASE COURSE, 10 1/4"
- ④ POLYMERIZED LEVELING BINDER (MACHINE METHOD), IL-4.75, N50, 3/4" & VARIES
- ⑤ POLYMERIZED HMA SURFACE COURSE, MIX 'F', N90, 1 3/4"
- ⑥ PCC PAVEMENT, 10 1/4" (JOINTED)
- ⑦ AGGREGATE SHOULDERS, TYPE B 6"
- ⑧ PORTLAND CEMENT CONCRETE SHOULDERS 10 1/4"
- ⑨ TEMPORARY PAVEMENT, (11 1/2")
 - HOT-MIX ASPHALT SURFACE COURSE, MIX 'F', N90, 2"
 - HOT-MIX ASPHALT BINDER COURSE, IL-19.0, N90, 9 1/2"
- ⑩ TEMPORARY PAVEMENT, (10")
 - HOT-MIX ASPHALT SURFACE COURSE, MIX 'D', N70, 2"
 - HOT-MIX ASPHALT BINDER COURSE, IL-19.0, N70, 8"
- ⑪ CLASS SI CONCRETE (OUTLET)
- ⑫ CONCRETE CURB, TYPE B
- ⑬ COMBINATION CONCRETE CURB & GUTTER, TY. B-6.18
- ⑭ CONCRETE MEDIAN SURFACE, 4"
- ⑮ CONCRETE MEDIAN, TY. SB
- ⑯ STEEL PLATE BEAM GUARDRAIL, TY. A, 6FT. POSTS
- ⑰ TRAFFIC BARRIER TERMINAL, TY. 2
- ⑱ TRAFFIC BARRIER TERMINAL, TY. 5
- ⑲ TRAFFIC BARRIER TERMINAL, TY. 6
- ⑳ TEMPORARY CONCRETE BARRIER (INSTALL ONLY)
- ㉑ CHAIN LINK FENCE, 4'
- ㉒ TRAFFIC BARRIER TERMINAL, TY. 1 (SPECIAL) TANGENT

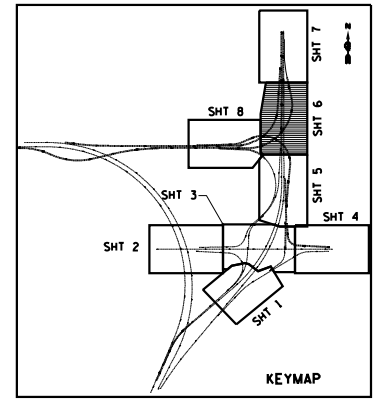

BOWMAN, BARRETT & ASSOCIATES INC.
CONSULTING ENGINEERS
Chicago, Illinois
312.228.0100
www.bbandainc.com

NOTE: SEE PROPOSED DRAINAGE PLANS FOR PAVEMENT PATCHING LOCATIONS NECESSARY TO INSTALL PROPOSED STORM SEWERS

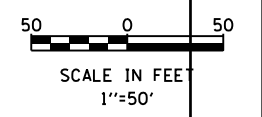

FILE NAME =	USER NAME = default	DESIGNED -	REVISED -	STATE OF ILLINOIS DEPARTMENT OF TRANSPORTATION	PROPOSED PLAN STONY ISLAND EXTENSION		F.A.I. RTE. 94	SECTION 2012-060-BR	COUNTY COOK	TOTAL SHEETS 285	SHEET NO. 46
#FILE#	PLOT SCALE = #SCALE#	DRAWN - JMC	REVISED -		SCALE: 1"=50'	SHEET NO. 6 OF 13 SHEETS	STA. TO STA.	CONTRACT NO. 60V61		ILLINOIS FED. AID PROJECT	
	PLOT DATE = 12/7/2012	CHECKED - RGR	REVISED -								
		DATE - 11/08/2012	REVISED -								

S:\1072-05-CADD\1060\61_Sheets\1060\61-shk-plan-06.dgn