

**SECTION AA**  
**EMBANKMENT FILL UNDER STRUCTURE 2439**  
**AT DORCHESTER AVE**  
 STA 926+75 (LINE F)

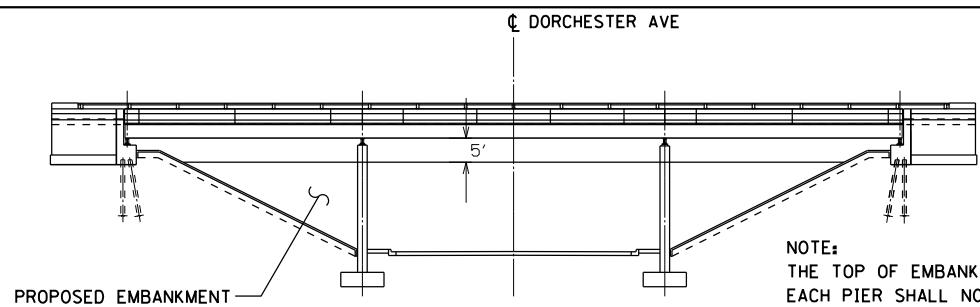

**SECTION BB**  
**STRUCTURE 2439 ELEVATION**

NOTE:  
 THE TOP OF EMBANKMENT ELEVATION ON EITHER SIDE OF EACH PIER SHALL NOT VARY BY MORE THAN 1, (ONE), FOOT AT ANY TIME DURING EMBANKMENT PLACEMENT.

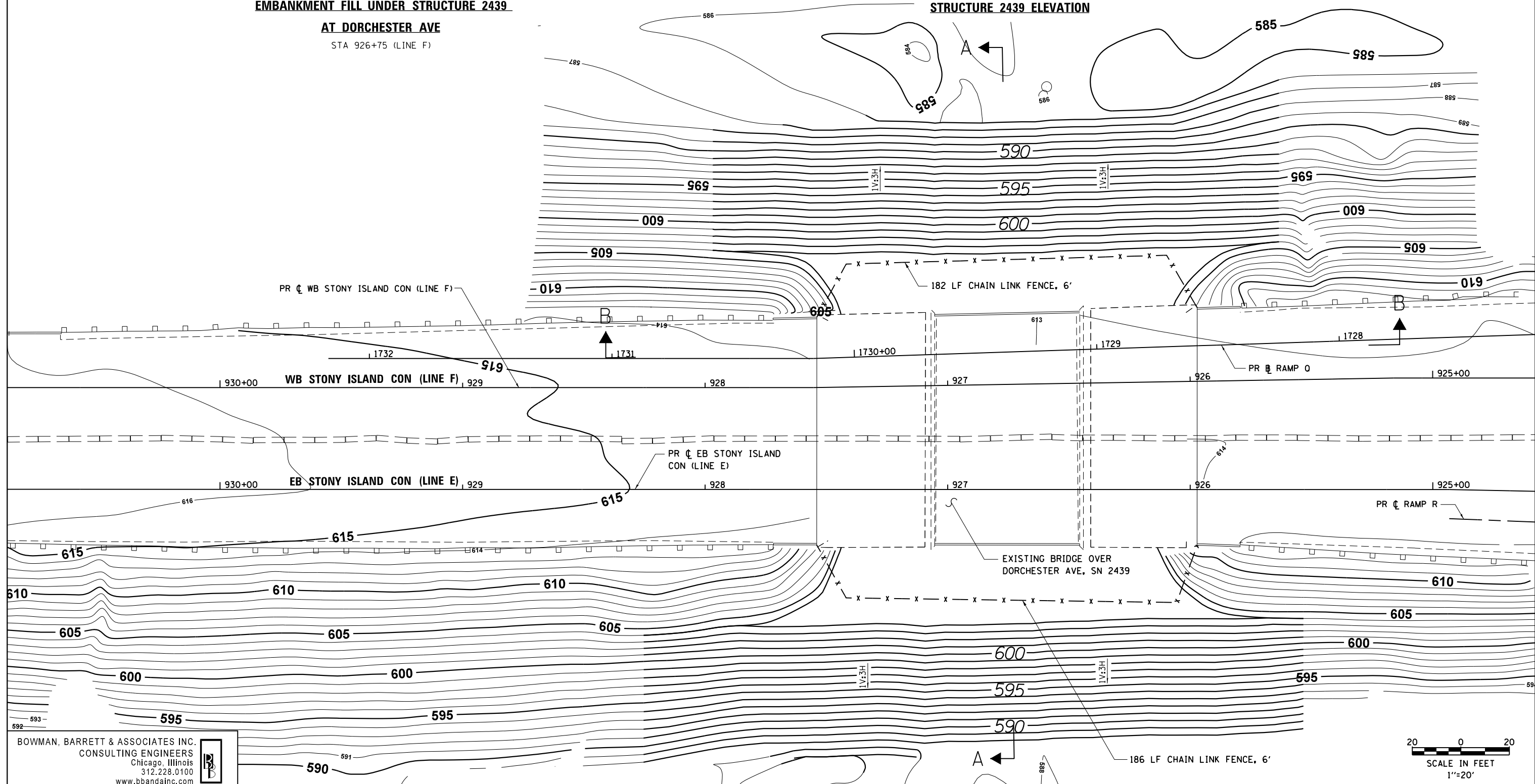

BOWMAN, BARRETT & ASSOCIATES INC.  
 CONSULTING ENGINEERS  
 Chicago, Illinois  
 312.228.0100  
 www.bbandainc.com

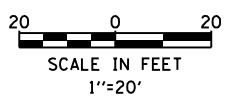

FILE NAME =	USER NAME = default	DESIGNED -	REVISED -	<b>STATE OF ILLINOIS DEPARTMENT OF TRANSPORTATION</b>	<b>PROPOSED PLAN EMBANKMENT FILL AT SN 2439</b>			F.A.I. RTE. 94	SECTION 2012-060-BR	COUNTY COOK	TOTAL SHEETS 285	SHEET NO. 51
*FILEL*		DRAWN - JMG	REVISED -		SCALE: 1" = 20'	SHEET NO. 11 OF 13 SHEETS	STA.	TO STA.	CONTRACT NO. 60V61			
		CHECKED - RGR	REVISED -		ILLINOIS FED. AID PROJECT							
		DATE - 11/08/2012	REVISED -									