

LEGEND:

- ⊥ TRAFFIC CONTROL SIGN
- ➔ TRAFFIC FLOW
- DRUM WITH MONO-DIRECTIONAL STEADY BURNING LIGHT (SEE MOT GENERAL NOTES FOR DRUM SPACING)
- ▨ WORKZONE
- ▩ TEMPORARY PAVEMENT
- ⊥ TYPE III BARRICADE
- Ⓐ WET REFLECTIVE TEMPORARY TAPE TYPE III, 4 INCH, WHITE
- Ⓑ WET REFLECTIVE TEMPORARY TAPE TYPE III, 4 INCH, YELLOW
- Ⓒ WET REFLECTIVE TEMPORARY TAPE TYPE III, 24 INCH, WHITE

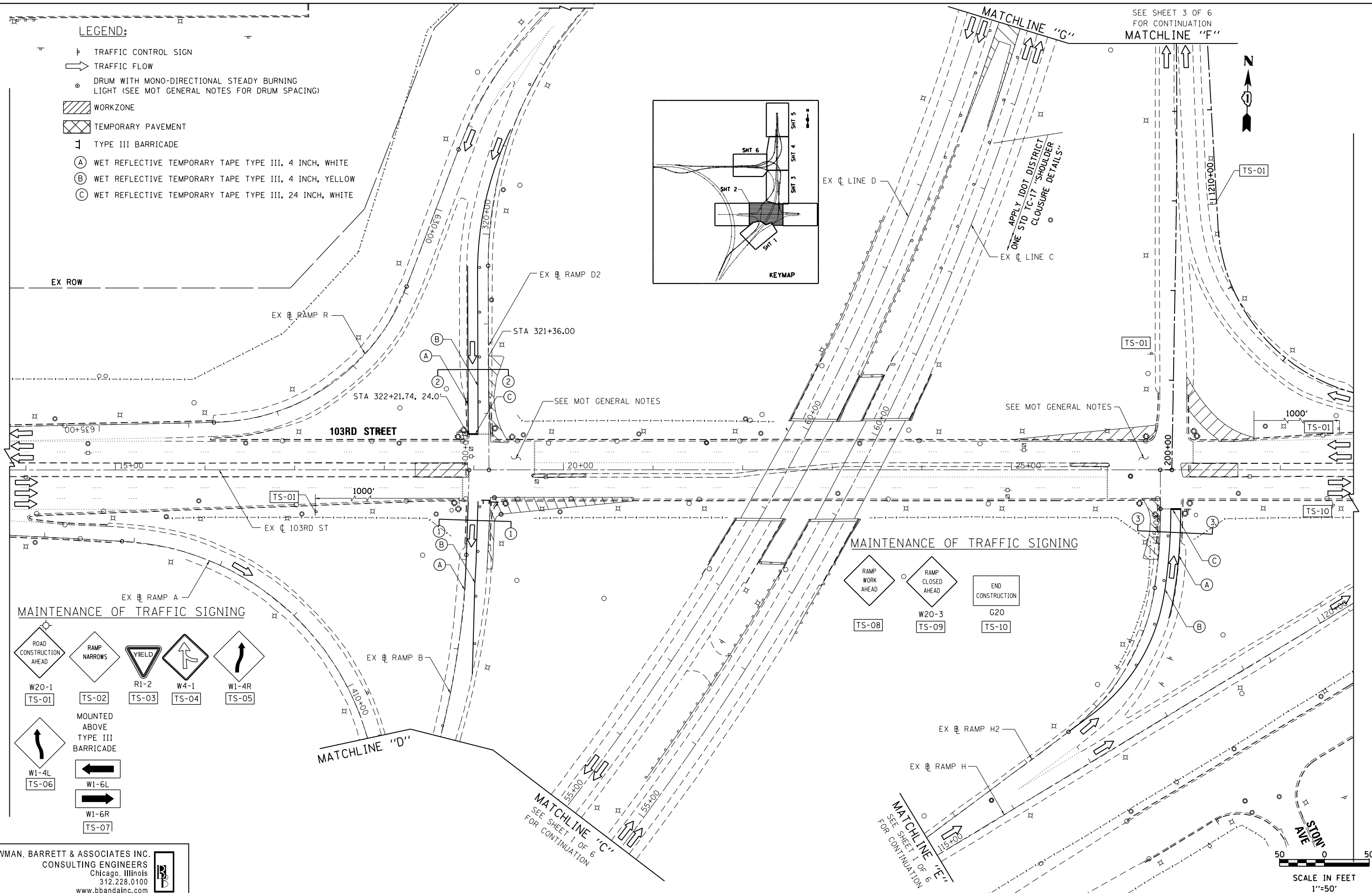
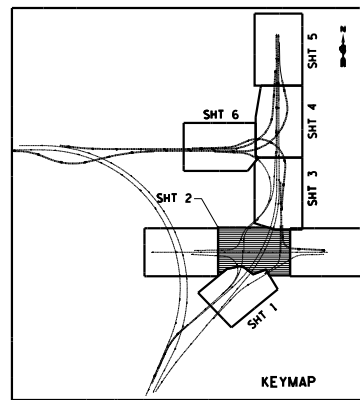

SEE SHEET 3 OF 6 FOR CONTINUATION
MATCHLINE "F"

MATCHLINE "G"



MAINTENANCE OF TRAFFIC SIGNING

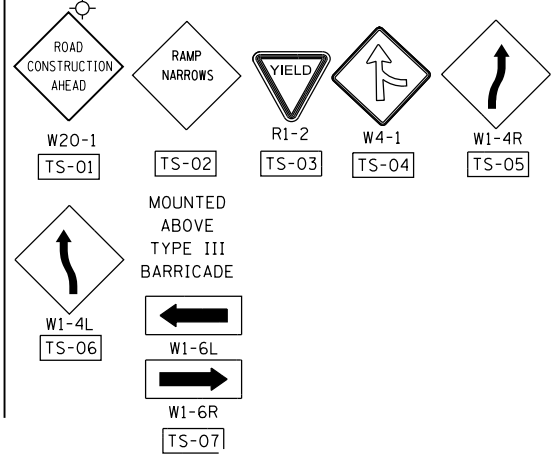

MAINTENANCE OF TRAFFIC SIGNING

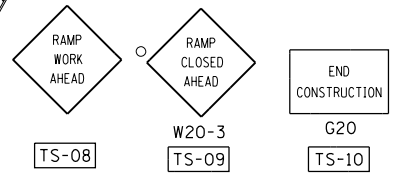

BOWMAN, BARRETT & ASSOCIATES INC.
CONSULTING ENGINEERS
Chicago, Illinois
312.228.0100
www.bbandainc.com

FILE NAME =	USER NAME = default	DESIGNED - OC	REVISED -
*FILEL\$		DRAWN - OC	REVISED -
	PLOT SCALE = *SCALE*	CHECKED -	REVISED -
	PLOT DATE = 1/4/2013	DATE - 11/08/2012	REVISED -

**STATE OF ILLINOIS
DEPARTMENT OF TRANSPORTATION**

**MAINTENANCE OF TRAFFIC - STAGE 1
103RD STREET**

SCALE: 1"=50' SHEET NO. 2 OF 7 SHEETS STA. TO STA.

F.A.I. RTE.	SECTION	COUNTY	TOTAL SHEETS	SHEET NO.
94	2012-060-BR	COOK	285	59
CONTRACT NO. 60V61				
ILLINOIS FED. AID PROJECT				

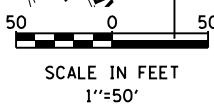

S:\1072\05_CADD\1060\61_Sheets\1060\61-sh1-Stage 1.dwg