

12/6/2012 9:30:58 AM p:\projects\3010_stony_island_feeder - bbe\project_work\disciplines\traffic_signals\sheet\0160J12-sht-ts-01.dgn

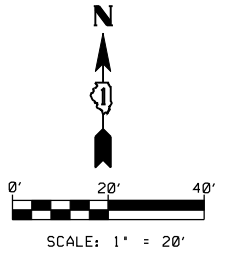
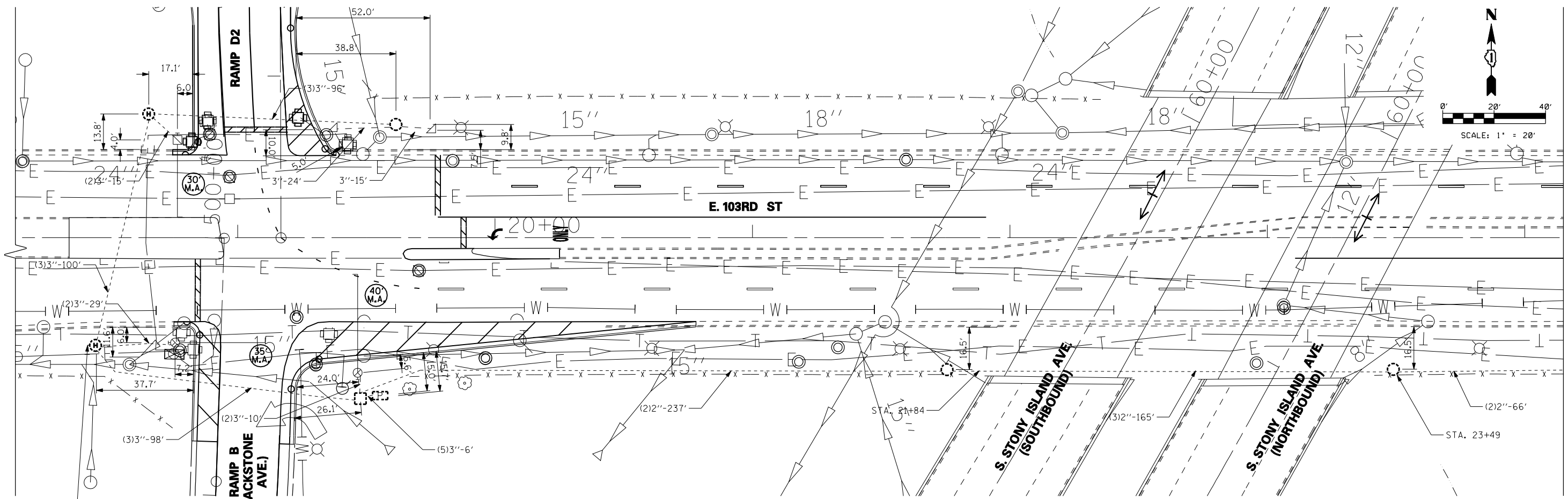

MATCHLINE STA. 24+15
SEE SHEET TS-8

FOUNDATION AND CONDUIT PLAN
1" = 20'

CONSTRUCTION NOTES

1. ALL FOUNDATIONS TO BE INSTALLED PER DRAWINGS #828 AND #888
2. FOR CODE SHEET SEE DRAWING #826
3. CONDUITS SHALL BE SCHEDULE 40 UNDER SIDEWALK OR PARKWAY AND SCHEDULE 80 UNDER PAVEMENT UNLESS OTHERWISE SPECIFIED.
4. NON SIGNAL UTILITY WORK SHOWN FOR REFERENCE ONLY.
5. INSTALL POWER AND FIBER OPTIC CABLES IN SEPARATE CONDUITS BETWEEN RAMP SIGNALS.
6. CONTROLLER SHALL BE ATC WITH FIBER OPTIC INTERFACE AND MODEM.

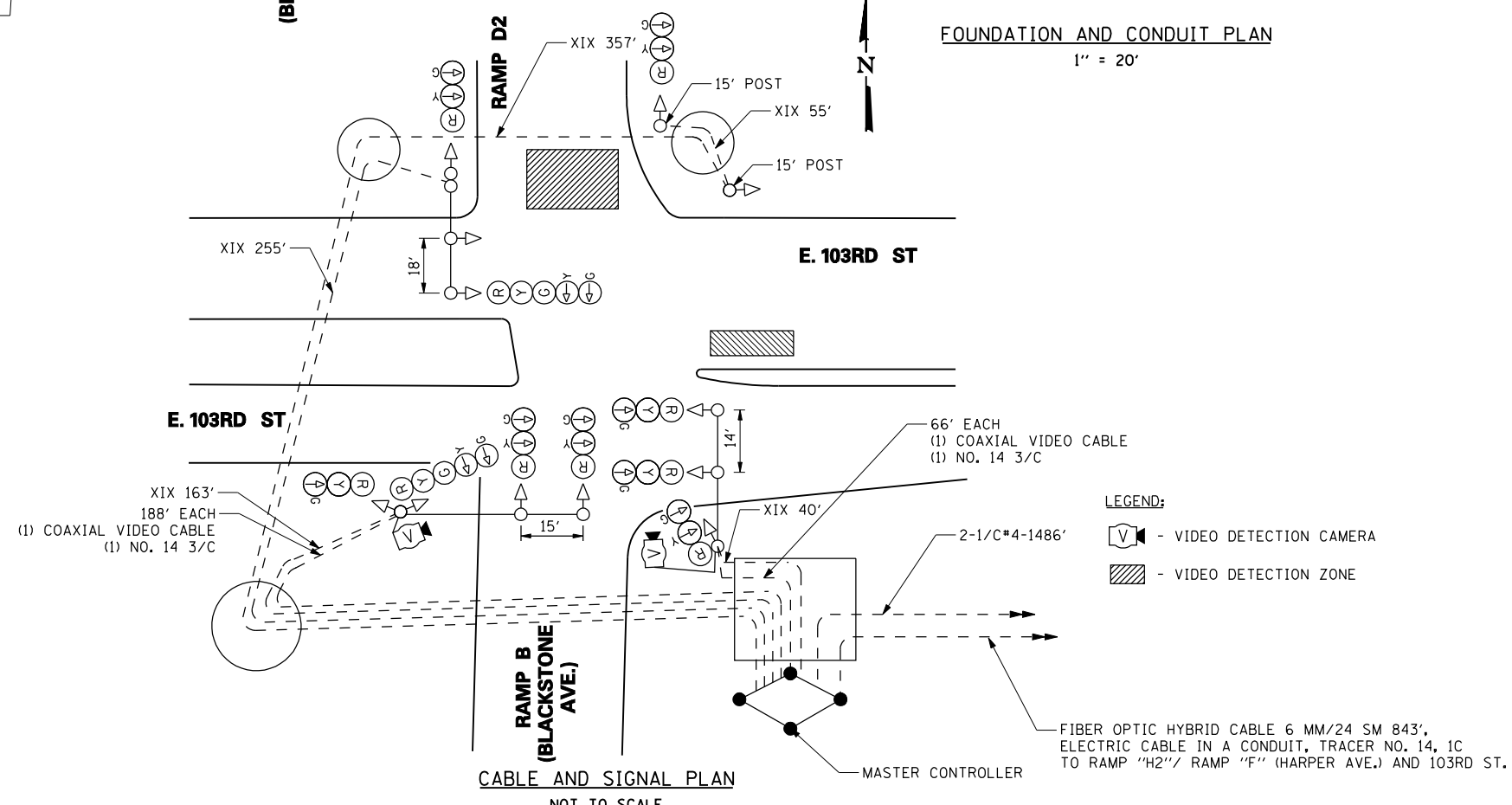

LEGEND:

- VIDEO DETECTION CAMERA
- VIDEO DETECTION ZONE

CABLE AND SIGNAL PLAN
NOT TO SCALE

DWG. NO.
22884
-1
DATE: 08/03/2012

USER NAME = sadhikari	DESIGNED - SA	REVISED -
	DRAWN - SA	REVISED -
PLOT SCALE = 50.000' / IN.	CHECKED - BKS	REVISED -
PLOT DATE = 12/6/2012	DATE - 12/07/2012	REVISED -



STATE OF ILLINOIS
DEPARTMENT OF TRANSPORTATION

TRAFFIC CONTROL SIGNAL PLAN
103RD ST. & STONY ISLAND AVE. RAMP B /RAMP D2
SCALE: AS NOTED SHEET NO. 1 OF 4 SHEETS STA. TO STA.

F.A.I. RTE.	SECTION	COUNTY	TOTAL SHEETS	SHEET NO.
94	2012-060-BR	COOK	285	126
CONTRACT NO. 60V61			ILLINOIS FED. AID PROJECT	