

3/4/7/26 PM

2/27/2013

S:\1072_05_CADD\Structure\1_SN_0162437_CADD_Sheets\0162437-60J12-019-SP03.dgn

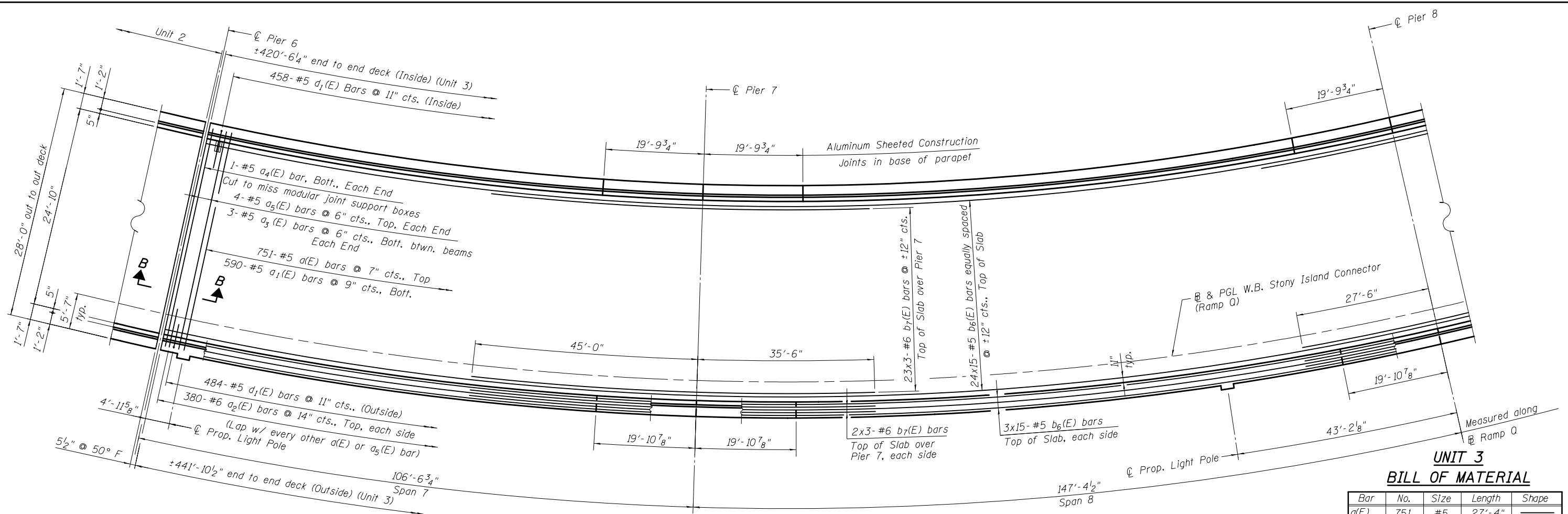

PARTIAL PLAN
(Unit 3)

MIN. BAR LAP
#5 = 3'-3"
#6 = 3'-10"

*** Deep fillet reinforcement bars. See Sheet S-24

UNIT 3
BILL OF MATERIAL

Bar	No.	Size	Length	Shape
a(E)	751	#5	27'-4"	—
a1(E)	590	#5	27'-0"	—
a2(E)	760	#6	6'-6"	—
a3(E)	18	#5	8'-3"	U
a4(E)	2	#5	21'-6"	—
a5(E)	8	#5	27'-4"	—
a6(E)	8	#5	1'-6"	—
*** a8(E)	147	#4	4'-0"	U
b6(E)	450	#5	32'-6"	—
b7(E)	81	#6	29'-5"	—
b8(E)	135	#6	31'-10"	—
b9(E)	384	#5	30'-8"	—
*** b13(E)	12	#4	25'-8"	—
d(E)	942	#5	6'-10"	D
d1(E)	942	#5	7'-6"	L
d2(E)	9	#6	5'-1"	—
d3(E)	18	#6	8'-11"	U
e(E)	42	#4	16'-8"	—
e1(E)	32	#4	12'-7"	—
e2(E)	28	#4	18'-2"	—
e5(E)	63	#4	16'-0"	—
e6(E)	63	#4	17'-1"	—
e8(E)	64	#4	19'-6"	—
e10(E)	42	#4	17'-10"	—
e11(E)	28	#4	15'-0"	—
e13(E)	6	#4	26'-0"	—
e16(E)	14	#4	23'-4"	—
e17(E)	8	#4	28'-9"	—
e22(E)	4	#8	12'-7"	—
e23(E)	6	#8	28'-2"	—
e24(E)	8	#8	25'-9"	—
e26(E)	8	#8	19'-6"	—
e27(E)	8	#8	31'-1"	—
e28(E)	6	#8	25'-4"	—
x(E)	42	#5	6'-4"	U

CONT.
BILL OF MATERIAL

Reinforcement Bars, Epoxy Coated	Pound	106,240
Concrete Superstructure	Cu. Yd.	482.0
Bridge Deck Grooving	Sq. Yd.	1,094
Protective Coat	Sq. Yd.	1,622

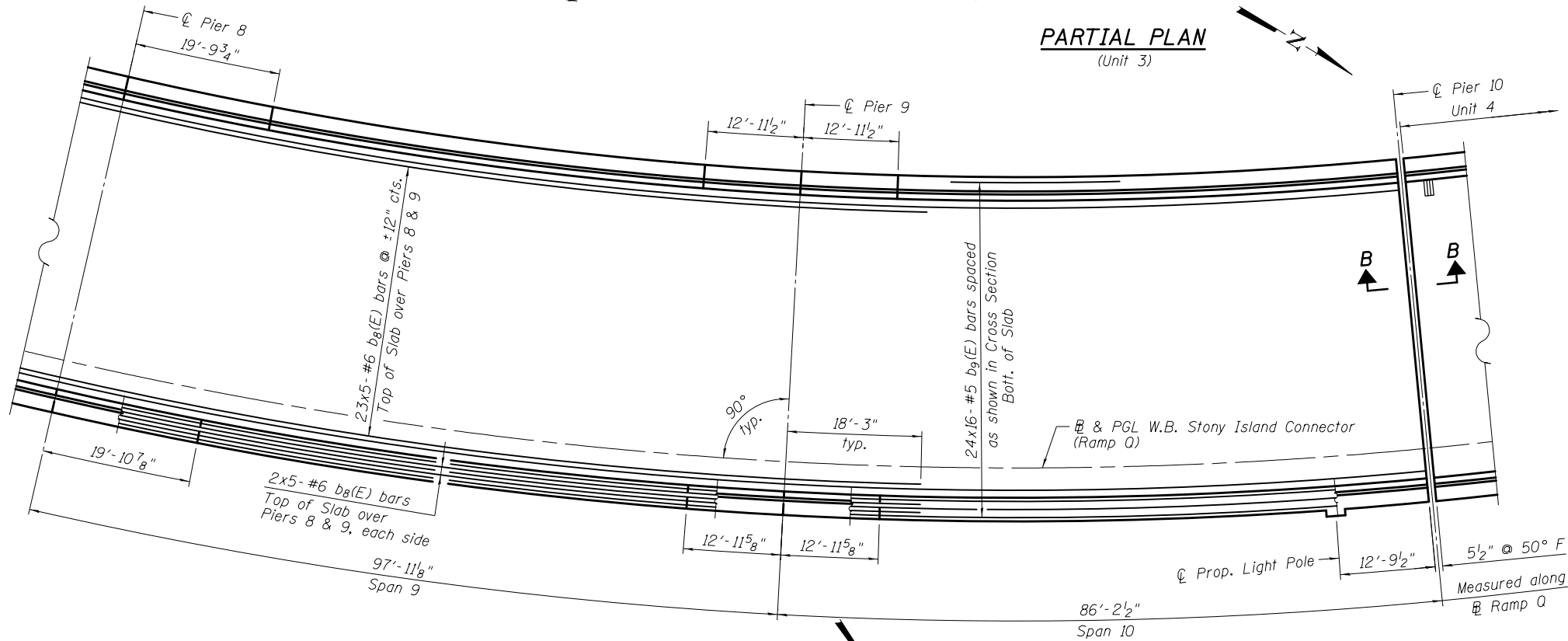

PARTIAL PLAN
(Unit 3)

BOWMAN, BARRETT & ASSOCIATES INC.
CONSULTING ENGINEERS
Chicago, Illinois
312.228.0100
www.bbainc.com

USER NAME =	DESIGNED - IYL	REVISED -
PLOT SCALE =	CHECKED - BAK	REVISED -
PLOT DATE = 02/11/2013	DRAWN - MTR	REVISED -
	CHECKED - IYL	REVISED -

STATE OF ILLINOIS
DEPARTMENT OF TRANSPORTATION

SUPERSTRUCTURE PLAN III
STRUCTURE NO. 016-2437

SHEET NO. S-19 OF S-83 SHEETS

F.A.I. RTE.	SECTION	COUNTY	TOTAL SHEETS	SHEET NO.
94	2012-060-BR	COOK	285	182

CONTRACT NO. 60V61
ILLINOIS FED. AID PROJECT