

BAR NO.	SIZE	LENGTH	SHAPE
a	209 #6	27'-4"	U
a1	418 #6	26'-0"	U
a2	418 #6	4'-0"	U
b1	370 #5	27'-3"	U
b9	56 #6	40'-0"	U
b3	154 #6	34'-0"	U
b11	16 #8	14'-2"	U
b12	16 #5	14'-2"	U
b20	16 #8	34'-0"	U
b35	24 #5	22'-9"	U
b21	8 #8	34'-9"	U
b36	12 #5	24'-9"	U
d	524 #4	4'-6"	L
d1	524 #5	3'-7"	L
d2	4 #6	9'-3"	L
d3	6 #6	3'-10"	L
s	108 #6	6'-0"	U

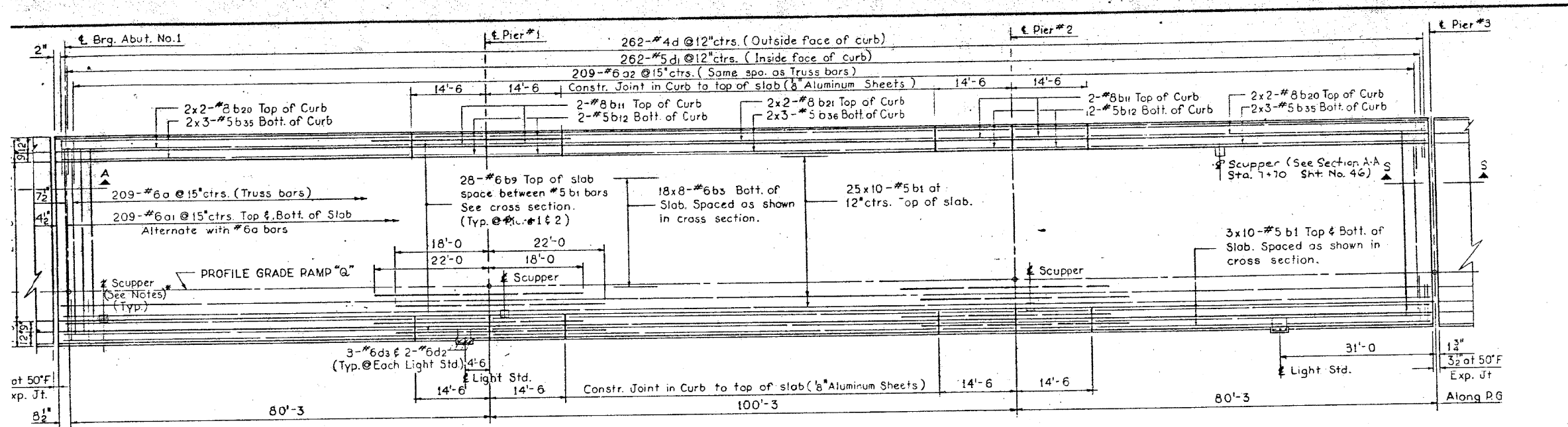

PLAN SPAN I THRU 3

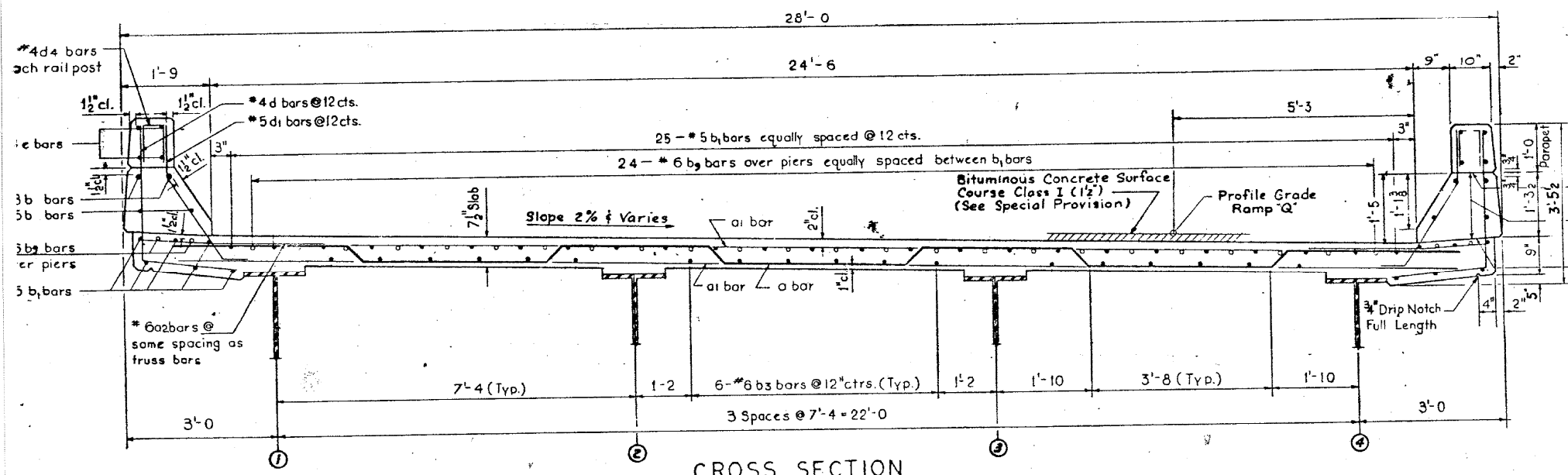

CROSS SECTION

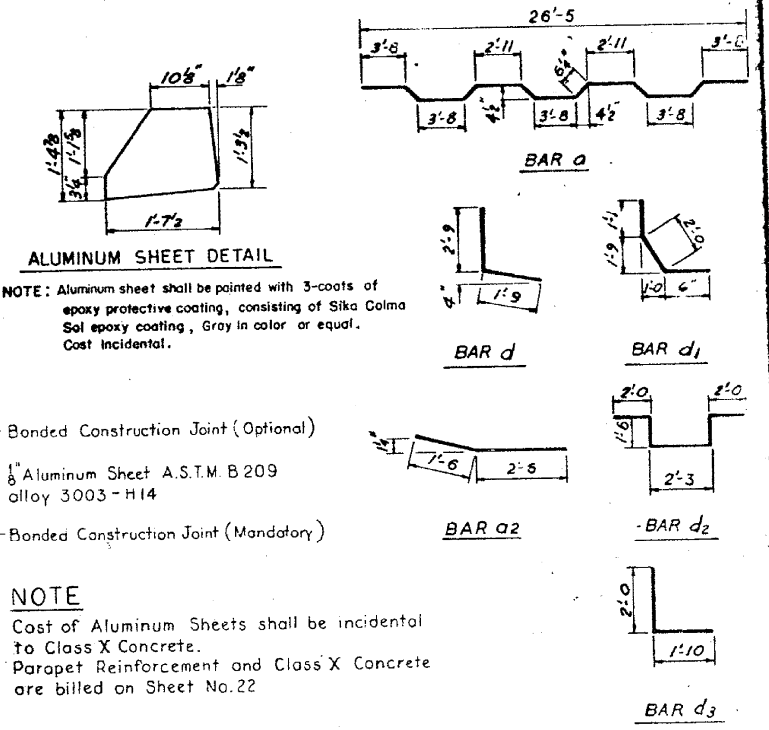

NOTE
Cost of Aluminum Sheets shall be incidental to Class X Concrete.
Parapet Reinforcement and Class X Concrete are billed on Sheet No.22

For Continuation of Slab See Sheet No.19
For Bottom of Slab Elevations See Sheet No.12
For Parapet Plan and Details See Sheet No.22
For Section A-A See Sheet No.17
For Section S-S See Sheet No.25
For Light Std. and miscellaneous Slab Details See Sheet No.25
For Scupper Details, Location and Additional Slab Reinforcement See Sheet No.46
Bars Marked thus 18x8-#6ctrs. indicate 18 lines of bars with 8 lengths per line.
For Deck Drain Details see sheet No.25
For Deck Surfacing Detail see sheet No.25

ITEM	UNIT	TOTAL
REINFORCEMENT BARS	LB.	57,291
CLASS X CONCRETE	C.Y.	225.7
PROTECTIVE COAT	S.Y.	198
BITUMINOUS CONCRETE SURFACE COURSE CLASS I	TON	63.9
COAL TAR INTERLAYER PROTECTIVE COAT	S.Y.	718

DATE	BY	DESCRIPTION

DEPARTMENT OF HIGHWAYS
COOK COUNTY, ILLINOIS

GEORGE W. DUNNE
PRESIDENT BOARD OF COMMISSIONERS

SUPERINTENDENT OF HIGHWAYS

SLAB PLAN SPANS I THRU 3
STONY ISLAND CONNECTOR TO FAI 94
RAMP Q STRUCTURE

KNOERLE, BENDER, STONE & ASSOCIATES INC.
CONSULTING ENGINEERS
CHICAGO, ILLINOIS

PROJECT: EBU 246(77)

SCALE: 1/4" = 1'-0"

APPROVED: [Signature]

FAI Route No: 122
COUNTY HWY. Route No: 174 A
Sheet No: 18
Total Sheets: 109
Drawing No:

2/26/03 PM

12/7/2012

SA:1072_05-CADD/Structural/SN_0162437-CADD Sheets/062437-60J12-065-F102.dgn

BOWMAN, BARRETT & ASSOCIATES INC.
CONSULTING ENGINEERS
Chicago, Illinois
312.228.0100
www.bbainc.com

USER NAME =	DESIGNED -	REVISED -
PLOT SCALE =	CHECKED - BAK	REVISED -
PLOT DATE = 11/08/2012	DRAWN -	REVISED -
	CHECKED -	REVISED -

STATE OF ILLINOIS
DEPARTMENT OF TRANSPORTATION

EXISTING PLANS (FOR INFORMATION ONLY)
STRUCTURE NO. 016-2437

SHEET NO. S-65 OF S-83 SHEETS

F.A.I. RTE.	SECTION	COUNTY	TOTAL SHEETS	SHEET NO.
94	2012-060-BR	COOK	285	228

CONTRACT NO. 60V61
ILLINOIS FED. AID PROJECT