

PAVEMENT MARKING LEGEND

- | | |
|--|---|
| ① 4" WHITE LANE LINE (30' SKIP 10' DASH) | ⑧ 8" WHITE - LETTERS AND SYMBOLS |
| ② 6" WHITE DOTTED LINE (6' SKIP 2' DASH) | ⑨ 12" YELLOW - RT. 45 DIAGONAL @ 30' C-C (MEDIAN) |
| ③ 4" SOLID WHITE LINE | ⑩ 12" YELLOW - RT. 45 DIAGONAL @ 70' C-C (MEDIAN) |
| ④ 4" SOLID YELLOW LINE | ⑪ CROSSWALK PAVEMENT MARKING 12" WIDE @ 6" APART (SOLID WHITE) |
| ⑤ 4" DOUBLE YELLOW LINE 11" C-C | ⑫ CROSSWALK PAVEMENT MARKING (6' LONGITUDINAL BARS) 12" WIDE AT 90 DEGREES 2" APART (SOLID WHITE) |
| ⑥ 6" WHITE LINE | ⑬ 4" YELLOW LINES 5-1/2' C-C |
| ⑦ 24" WHITE - SOLID (STOP BAR) | |

NOTE

PAVEMENT MARKING SHALL BE THERMOPLASTIC OF THE EXTRUDED TYPE AND SHOULD BE PLACED IN ACCORDANCE WITH THE DISTRICT ONE "TYPICAL PAVEMENT MARKING DETAILS".
 RAISED REFLECTIVE PAVEMENT MARKERS SHALL BE IN ACCORDANCE WITH THE DISTRICT ONE "TYPICAL APPLICATION RAISED REFLECTIVE PAVEMENT MARKERS DETAILS".

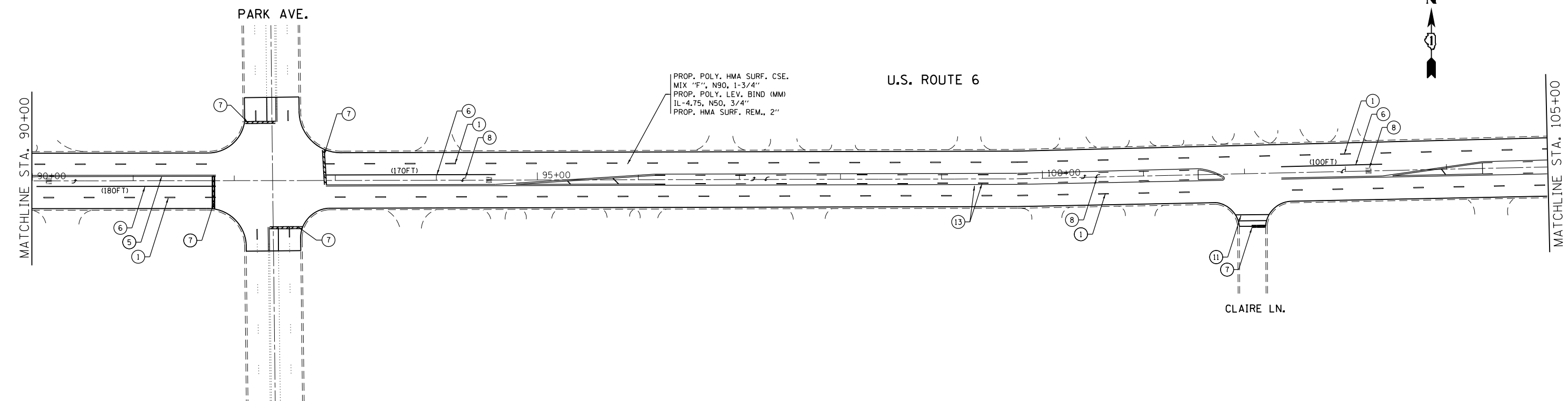

FILE NAME =	USER NAME = bigate000	DESIGNED -	REVISED -
ct:\pw\work\p1dot\bigate000\d0331360\011913-sh-t-plan.dgn		DRAWN -	REVISED -
	PLOT SCALE = 100.0000' / in.	CHECKED -	REVISED -
MODELNAME	PLOT DATE = 2/15/2013	DATE -	REVISED -

STATE OF ILLINOIS
DEPARTMENT OF TRANSPORTATION

ROADWAY AND PAVEMENT MARKING PLAN
U.S. ROUTE 6 (UNION AVE. - I-94)

SCALE: 1"=50' SHEET OF SHEETS STA. TO STA.

F.A.P. RTE.	SECTION	COUNTY	TOTAL SHEETS	SHEET NO.
351	(539 & 3339) RS-1	COOK	32	8
CONTRACT NO. 60W17				
ILLINOIS FED. AID PROJECT				