

NO.	DATE	BY	REVISION

NO.	DATE	BY	REVISION

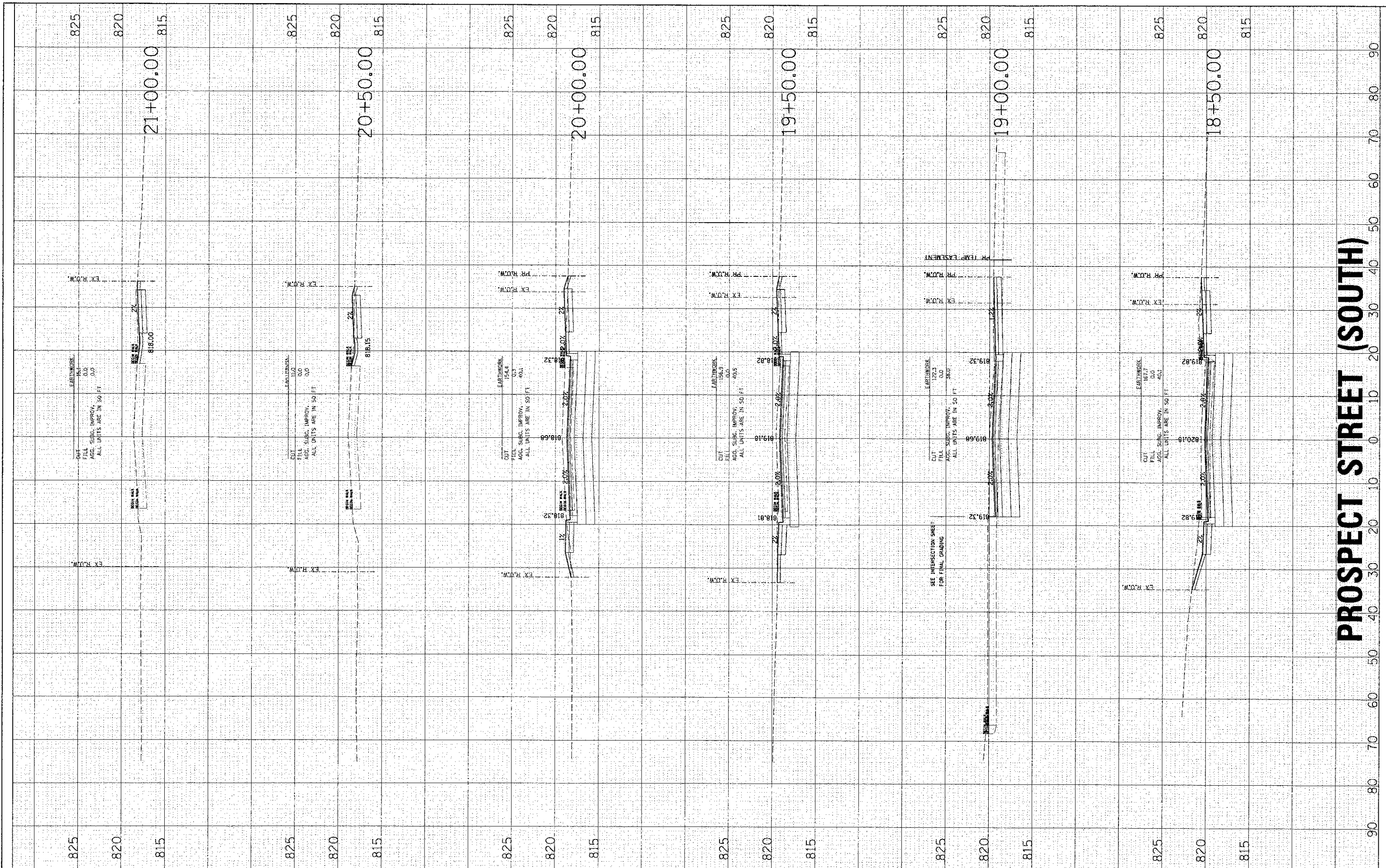

**PROSPECT STREET (SOUTH)**

**HRGreen.com**  
 Illinois Professional Design Firm  
 #194-001322

USER NAME = sperral	DESIGNED -	REVISED -
PLOT SCALE =	DRAWN -	REVISED -
PLOT DATE = 2/13/2013	CHECKED -	REVISED -
	DATE -	REVISED -

**STATE OF ILLINOIS  
 DEPARTMENT OF TRANSPORTATION**

**CROSS SECTIONS**

SCALE: 10H:5V SHEET NO. 5 OF 7 SHEETS STA. 18+50.00 TO STA. 21+00.00

F.A.D. RTE. 40B7	SECTION 98-00024-00-WR	COUNTY McHENRY	TOTAL SHEETS 115	SHEET NO. 101
CONTRACT NO. 63532				
FED. ROAD DIST. NO. ILLINOIS FED. AID PROJECT				

DATE	BY
SURVEYED	
PLOTTED	
NOTE BOOK	
AREAS CHECKED	

DATE	BY
SURVEYED	
PLOTTED	
NOTE BOOK	
AREAS CHECKED	

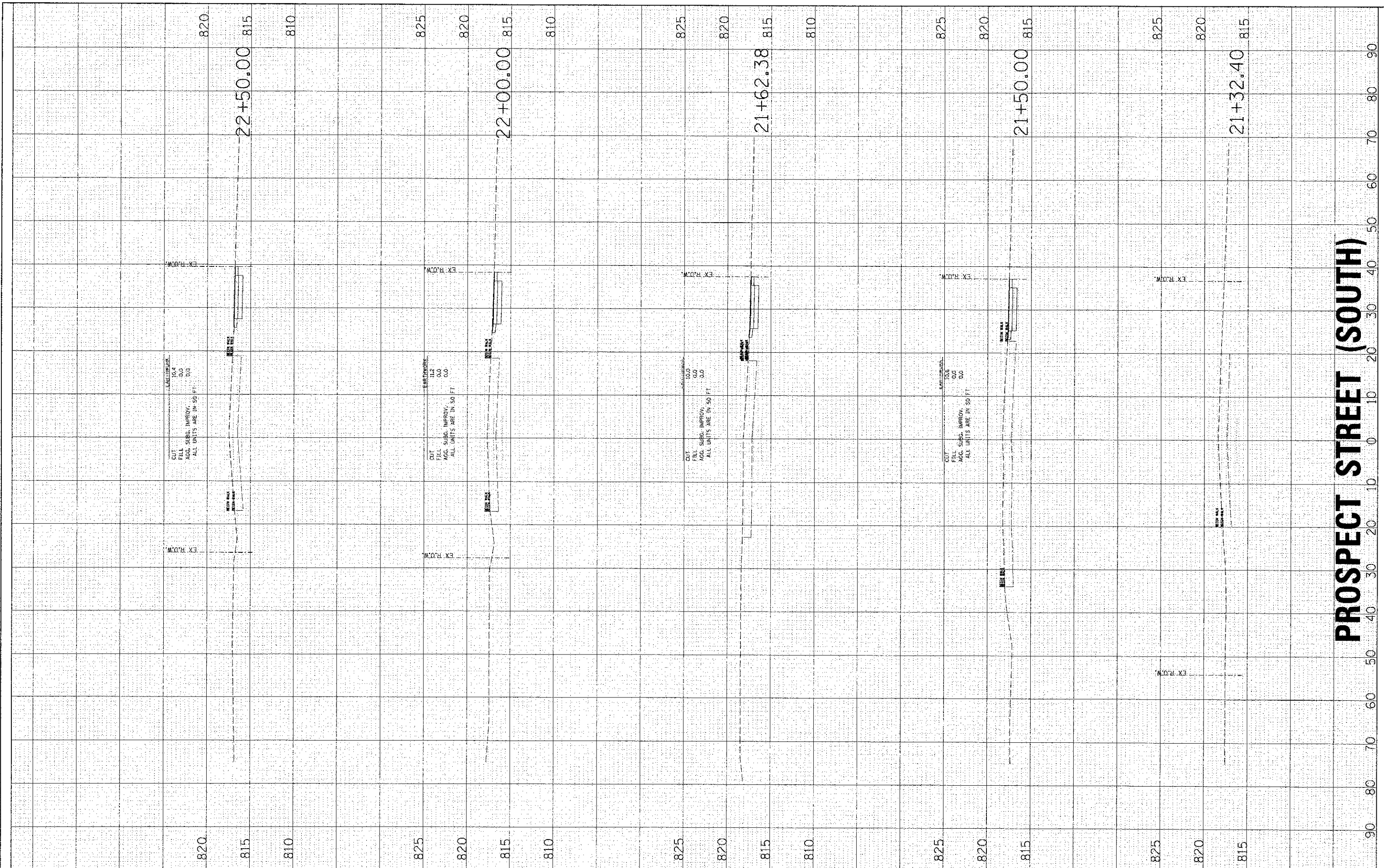

**PROSPECT STREET (SOUTH)**

**HRGreen.com**  
 Illinois Professional Design Firm  
 #184-001322

USER NAME = spornal
DESIGNED -
DRAWN -
CHECKED -
DATE -
PLOT SCALE =
PLOT DATE = 2/13/2013

REVISED -
REVISED -
REVISED -
REVISED -

**STATE OF ILLINOIS  
 DEPARTMENT OF TRANSPORTATION**

**CROSS SECTIONS**

SCALE: 10H:5V SHEET NO. 6 OF 7 SHEETS STA. 21+32.40 TO STA. 22+50.00

F.A.D. RTE. 4087	SECTION 98-00024-00-WR	COUNTY McHENRY	TOTAL SHEETS 115	SHEET NO. 102
CONTRACT NO. 63532				
FED. ROAD DIST. NO. ILLINOIS FED. AID PROJECT				

FINAL SURVEY	BY	DATE
SURVEYED		
PLOTTED		
NOTE BOOK		
AREAS		
AREAS CHECKED		
NO.		

ORIGINAL SURVEY	BY	DATE
SURVEYED		
PLOTTED		
NOTE BOOK		
AREAS		
AREAS CHECKED		
NO.		

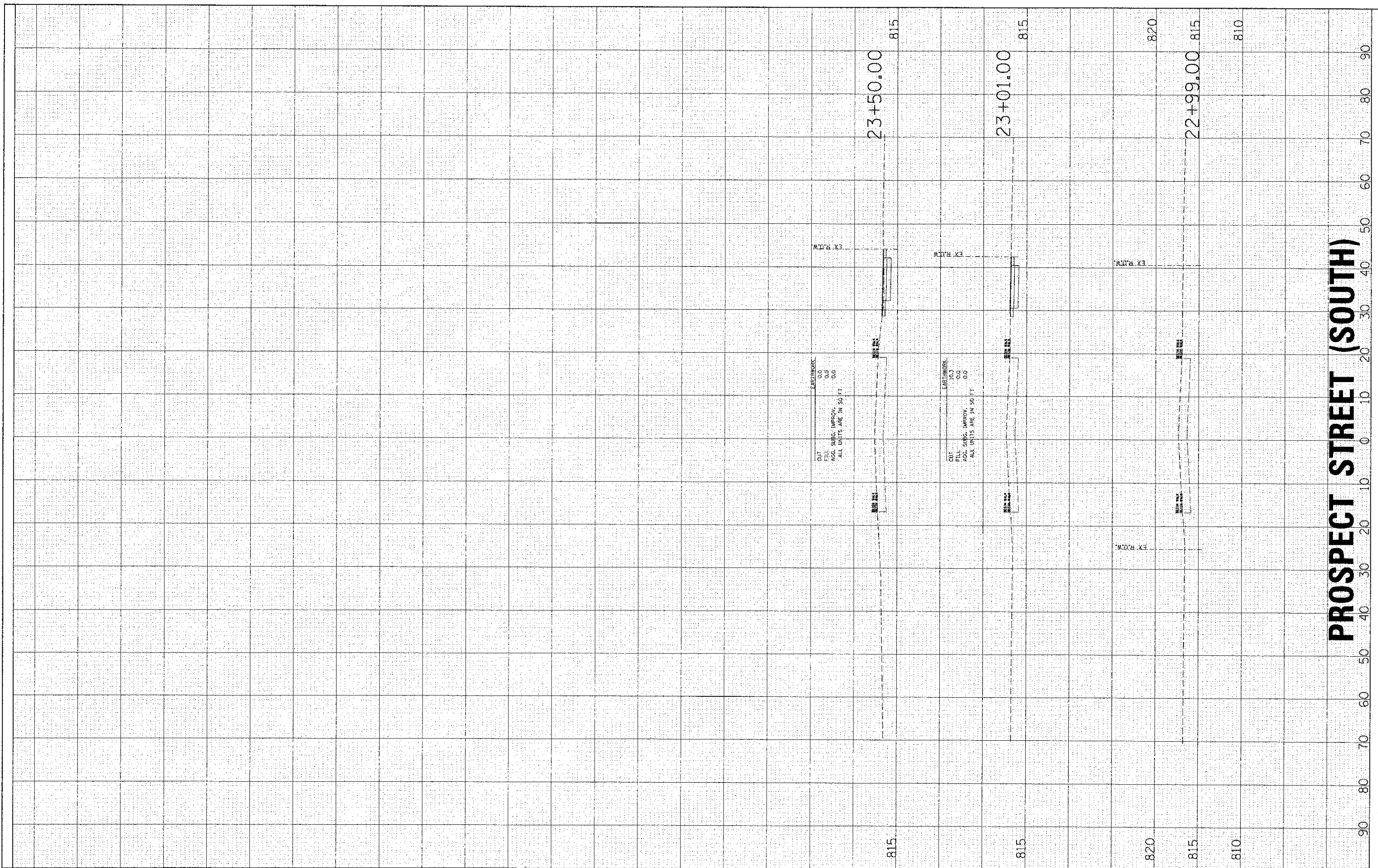

**HRGreen.com**  
 Illinois Professional Design Firm  
 # 194-001322

USER NAME = sperral
PLOT SCALE =
PLOT DATE = 2/13/2013

DESIGNED -	REVISED -
DRAWN -	REVISED -
CHECKED -	REVISED -
DATE -	REVISED -

**STATE OF ILLINOIS  
 DEPARTMENT OF TRANSPORTATION**

CROSS SECTIONS		
SCALE: 10H:5V	SHEET NO. 7 OF 7 SHEETS	STA. 22+99.00 TO STA. 23+50.00

F.A.D. RTE.	SECTION	COUNTY	TOTAL SHEET SHEETS: NO.
4087	98-00024-00-WR	MCHENRY	115 103
FED. ROAD DIST. NO. ; ILLINOIS FED. AID PROJECT			CONTRACT NO. 63532

FINAL SURVEY PLOTTED DATE: \_\_\_\_\_ BY: \_\_\_\_\_  
 NOTE BOOK AREAS CHECKED: \_\_\_\_\_

ORIGINAL SURVEY PLOTTED DATE: \_\_\_\_\_ BY: \_\_\_\_\_  
 NOTE BOOK AREAS CHECKED: \_\_\_\_\_

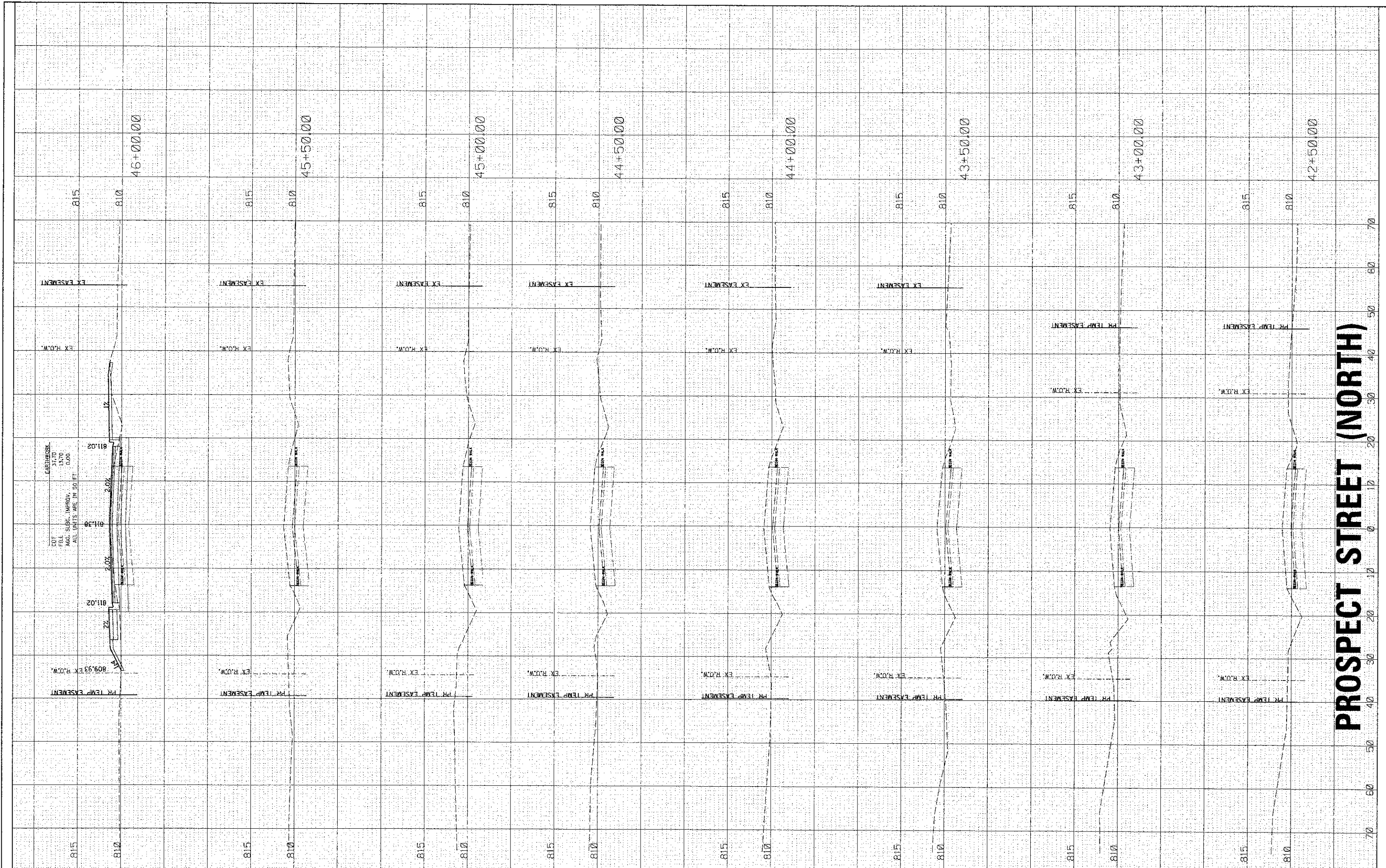

**PROSPECT STREET (NORTH)**

**HRGreen.com**  
 Illinois Professional Design Firm  
 #184-001322

USER NAME = spornal  
 PLOT SCALE =  
 PLOT DATE = 2/13/2013

DESIGNED -  
 DRAWN -  
 CHECKED -  
 DATE -

REVISED -  
 REVISED -  
 REVISED -  
 REVISED -

**STATE OF ILLINOIS  
 DEPARTMENT OF TRANSPORTATION**

**CROSS SECTIONS**

SCALE: 10H:5V SHEET NO. 1 OF 5 SHEETS STA. TO STA.

F.A.U. RTE.	SECTION	COUNTY	TOTAL SHEETS	SHEET NO.
4087	98-00024-00-WR	McHENRY	115	104
CONTRACT NO. 63532			ILLINOIS FED. AID PROJECT	

FINAL SURVEY	BY	DATE
SURVEYED		
PLOTTED		
TEMPLATE		
NOTE BOOK		
AREAS CHECKED		

ORIGINAL SURVEY	BY	DATE
SURVEYED		
PLOTTED		
TEMPLATE		
NOTE BOOK		
AREAS CHECKED		

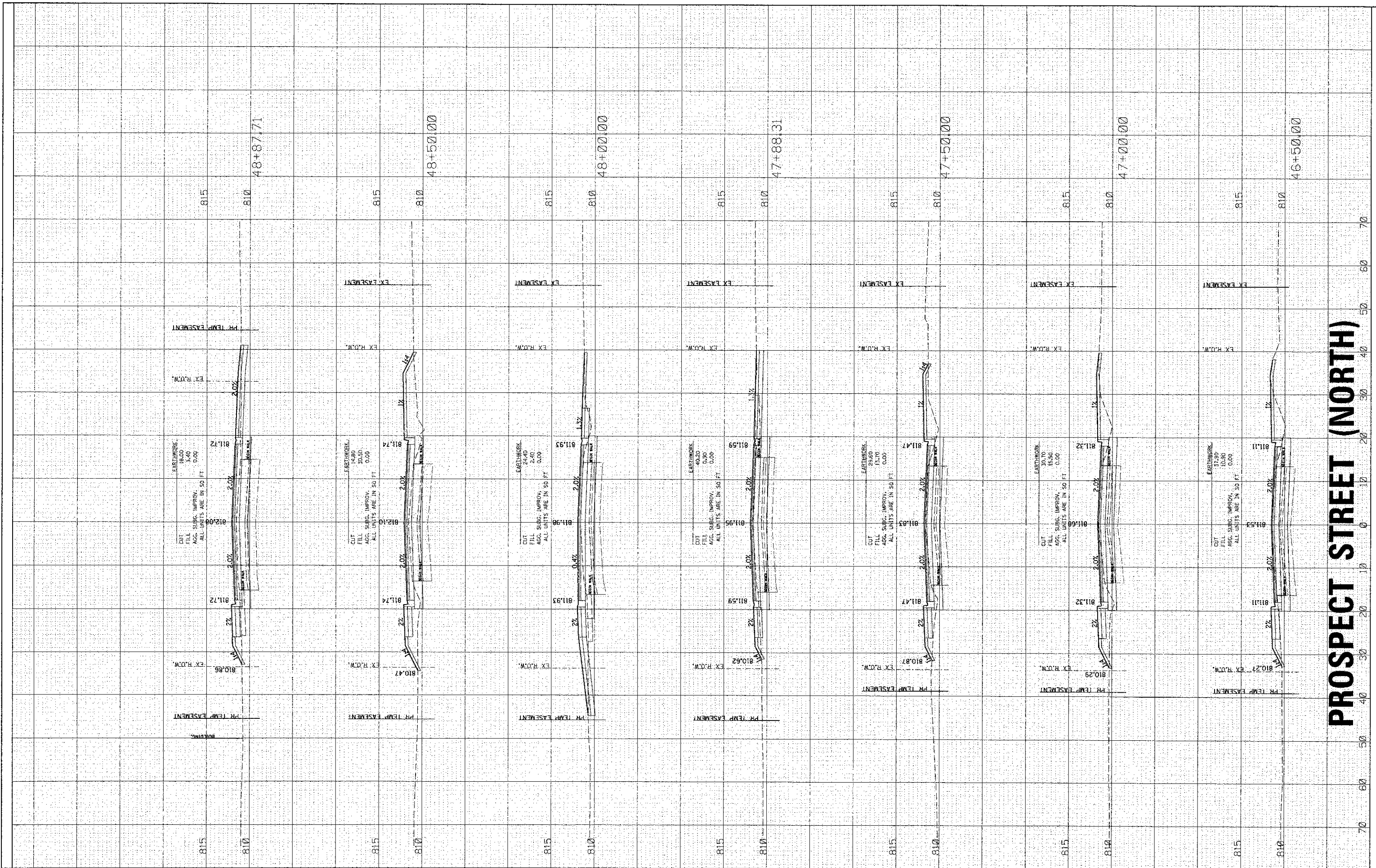

# PROSPECT STREET (NORTH)

**HRGreen.com**  
 Illinois Professional Design Firm  
 #184-01327

USER NAME = spenal	DESIGNED -	REVISED -
PLOT SCALE =	DRAWN -	REVISED -
PLOT DATE = 2/13/2013	CHECKED -	REVISED -
	DATE -	REVISED -

**STATE OF ILLINOIS**  
**DEPARTMENT OF TRANSPORTATION**

<b>CROSS SECTIONS</b>		
SCALE: 10H:5V	SHEET NO. 2 OF 5 SHEETS	STA. TO STA.

F.A.U. RTE. 4087	SECTION 98-00024-00-WR	COUNTY MCHENRY	TOTAL SHEETS 115	SHEET NO. 105
FED. ROAD DIST. NO. ILLINOIS FED. AID PROJECT		CONTRACT NO. 63532		

DATE	
BY	
FINAL SURVEY	
NOTED	
PLANNED	
AS BUILT	
NO.:	

DATE	
BY	
ORIGINAL SURVEY	
NOTED	
PLANNED	
AS BUILT	
NO.:	

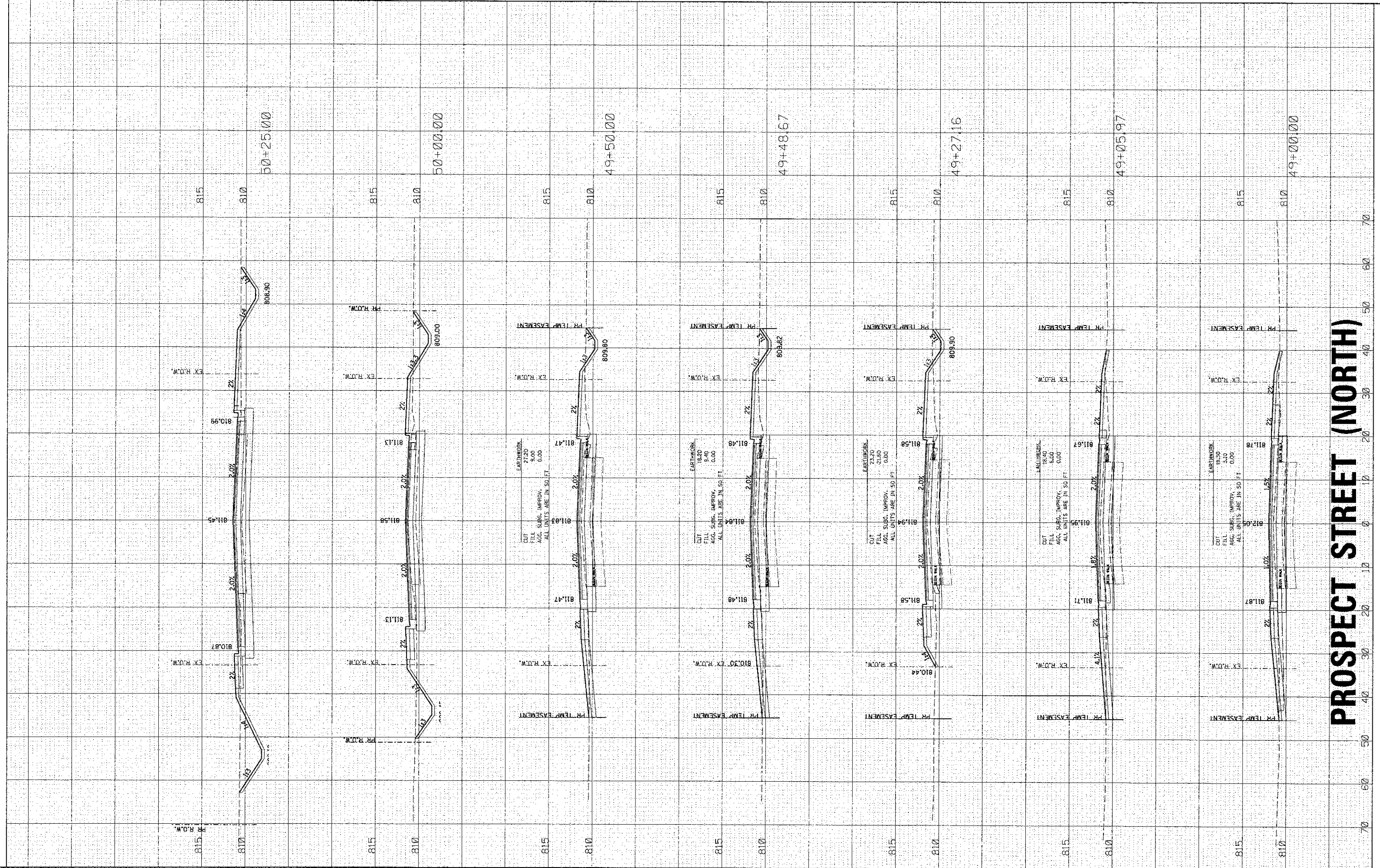

# PROSPECT STREET (NORTH)

HRGreen.com Illinois Professional Design Firm #104-001322	USER NAME = sperral	DESIGNED -	REVISED -
	PLOT SCALE =	DRAWN -	REVISED -
	PLOT DATE = 2/13/2013	CHECKED -	REVISED -
		DATE -	REVISED -

STATE OF ILLINOIS DEPARTMENT OF TRANSPORTATION	SCALE: 10H:5V	SHEET NO. 3 OF 5 SHEETS	STA. TO STA.
---	---------------	-------------------------	--------------

F.A.A. RTE. 4087	SECTION 98-00024-00-WR	COUNTY McHENRY	TOTAL SHEETS 115	SHEET NO. 106
FED. ROAD DIST. NO. ILLINOIS		FED. AID PROJECT		

<b>CROSS SECTIONS</b>				
SCALE: 10H:5V	SHEET NO. 3 OF 5 SHEETS	STA. TO STA.		

BY	DATE
SURVEYED	
PLOTTED	
NOTE BOOK	
AREAS CHECKED	

BY	DATE
SURVEYED	
PLOTTED	
NOTE BOOK	
AREAS CHECKED	

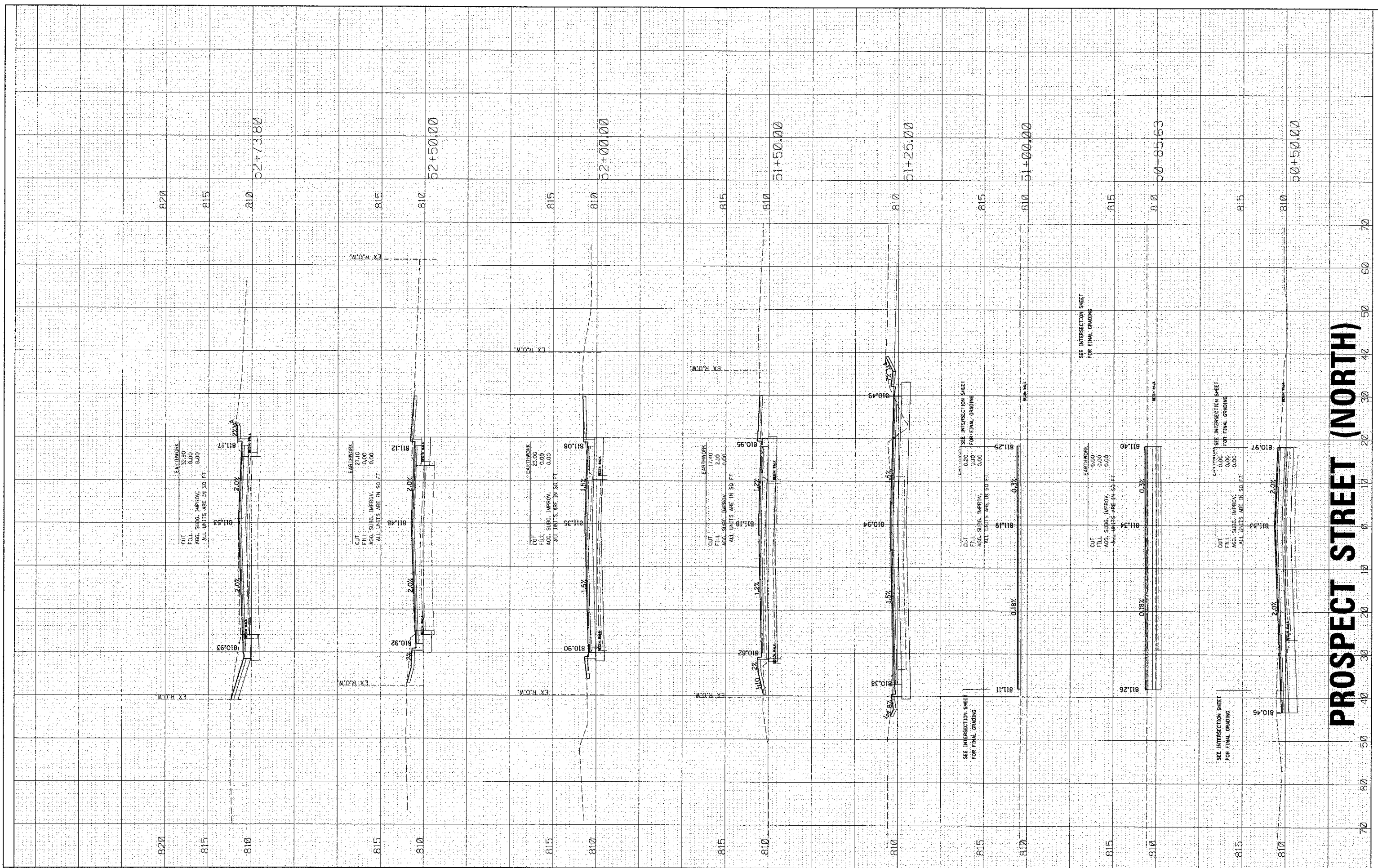

# PROSPECT STREET (NORTH)

HRGreen.com  
Illinois Professional Design Firm  
#184-001322

USER NAME = spenal
PLOT SCALE =
PLOT DATE = 2/13/2013

DESIGNED -	REVISED -
DRAWN -	REVISED -
CHECKED -	REVISED -
DATE -	REVISED -

**STATE OF ILLINOIS  
DEPARTMENT OF TRANSPORTATION**

**CROSS SECTIONS**

SCALE: 10H:5V    SHEET NO. 4 OF 5 SHEETS    STA.    TO STA.

F.A.L. RTE.	SECTION	COUNTY	TOTAL SHEETS	SHEET NO.
4087	98-00024-00-WR	McHENRY	115	107
CONTRACT NO. 63532				
FED. ROAD DIST. NO. ILLINOIS FED. AID PROJECT				

FINAL SURVEY	DATE
SURVEYED	
PLOTTED	
TEMPLATE	
NOTE BOOK	
AREAS CHECKED	
NO.	

ORIGINAL SURVEY	DATE
SURVEYED	
PLOTTED	
TEMPLATE	
NOTE BOOK	
AREAS CHECKED	
NO.	

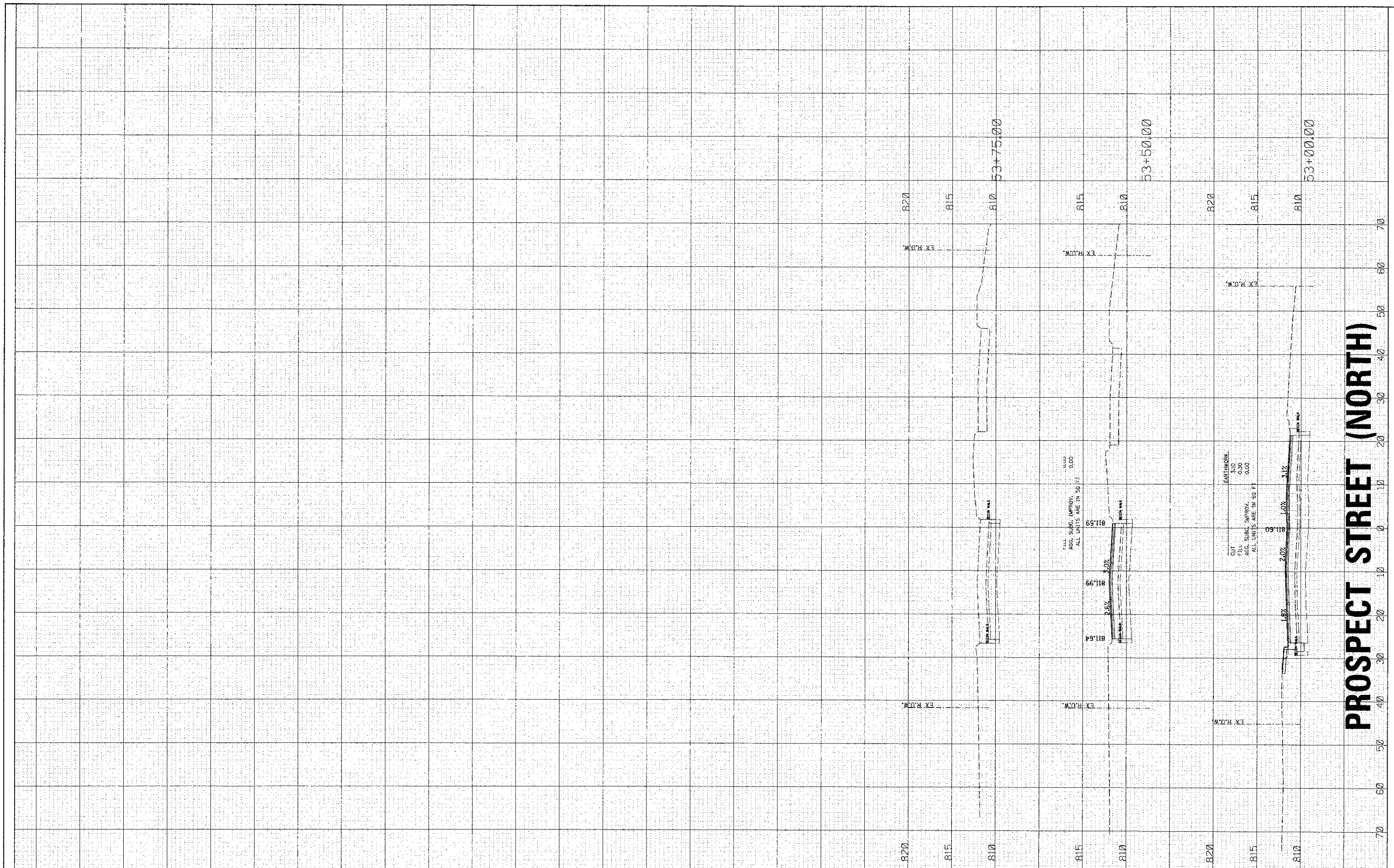

**HRGreen**  
 Illinois Professional Design Firm  
 #184-C01322

USER NAME = sperral	DESIGNED -	REVISED -
PLOT SCALE =	DRAWN -	REVISED -
PLOT DATE = 2/13/2013	CHECKED -	REVISED -
	DATE -	REVISED -

**STATE OF ILLINOIS  
 DEPARTMENT OF TRANSPORTATION**

**CROSS SECTIONS**

SCALE: 10H:5V    SHEET NO. 5 OF 5 SHEETS    STA.    TO STA.

F.A.H. RTE.	SECTION	COUNTY	TOTAL SHEETS NO.	SHEET NO.
4087	98-00024-00-WR	McHENRY	115	108
FED. ROAD DIST. NO. ILLINOIS FED. AID PROJECT			CONTRACT NO. 63532	



BY	DATE
SURVEYED	
PLOTTED	
TEMPLATE	
NOTE BOOK	
AREAS CHECKED	

BY	DATE
SURVEYED	
PLOTTED	
TEMPLATE	
NOTE BOOK	
AREAS CHECKED	

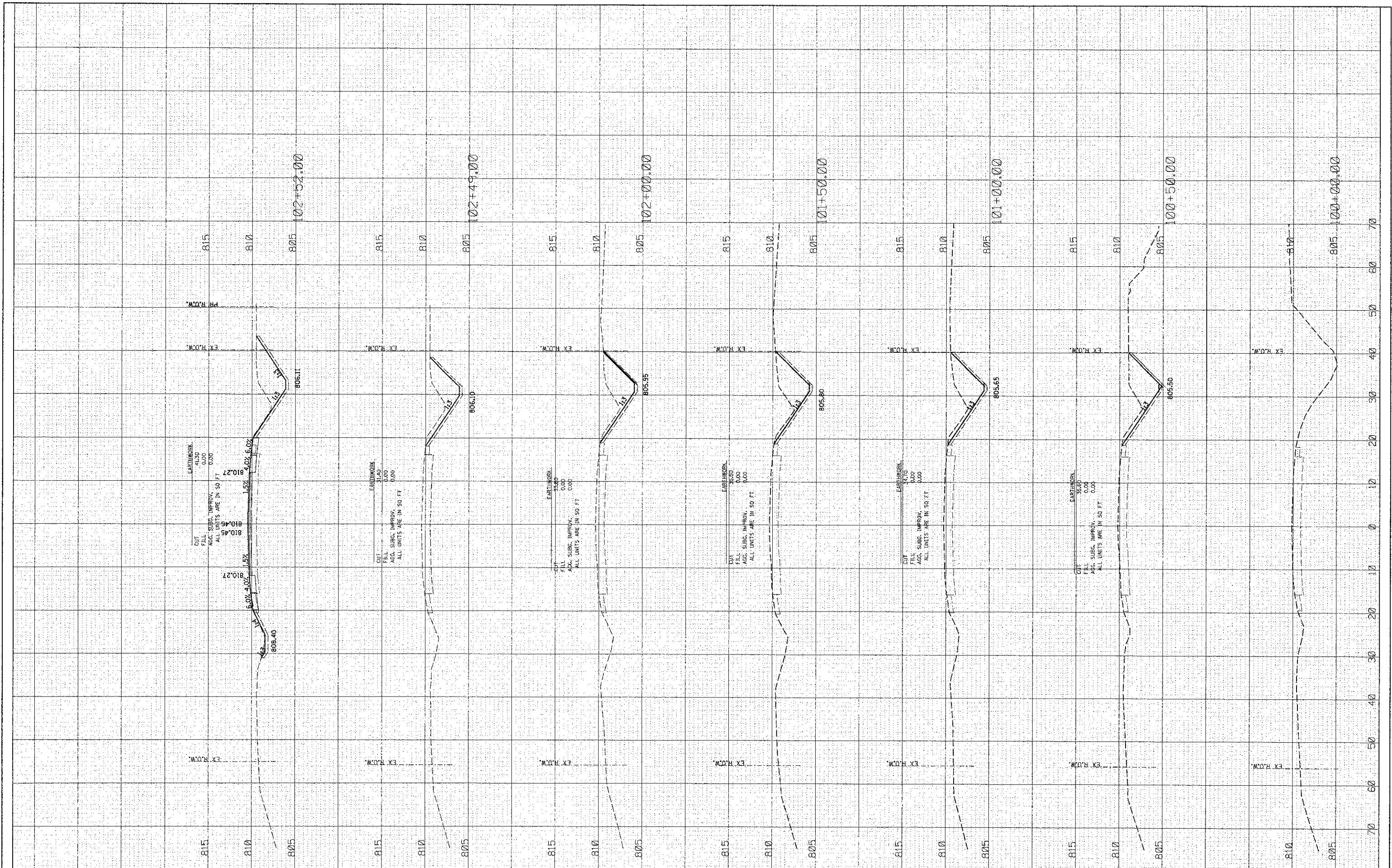

**HRGreen.com**  
 Illinois Professional Design Firm  
 #184-001322  
**HRGreen**

USER NAME = spenal	DESIGNED -	REVISED -
PLOT SCALE =	DRAWN -	REVISED -
PLOT DATE = 2/13/2013	CHECKED -	REVISED -
	DATE -	REVISED -

**STATE OF ILLINOIS  
 DEPARTMENT OF TRANSPORTATION**

**CROSS SECTIONS  
 ILLINOIS ROUTE 176**

SCALE: 10H:5V    SHEET NO. 1 OF 7 SHEETS    STA.    TO STA.

F.A.U. RTE. 4087	SECTION 98-00024-00-WR	COUNTY MCHENRY	TOTAL SHEETS 115	SHEET NO. 109
FED. ROAD DIST. NO. ILLINOIS FED. AID PROJECT			CONTRACT NO. 63532	

FINAL SURVEY	DATE
SURVEYED	
PLOTTED	
NOTE BOOK	
AREAS CHECKED	

ORIGINAL SURVEY	DATE
SURVEYED	
PLOTTED	
NOTE BOOK	
AREAS CHECKED	

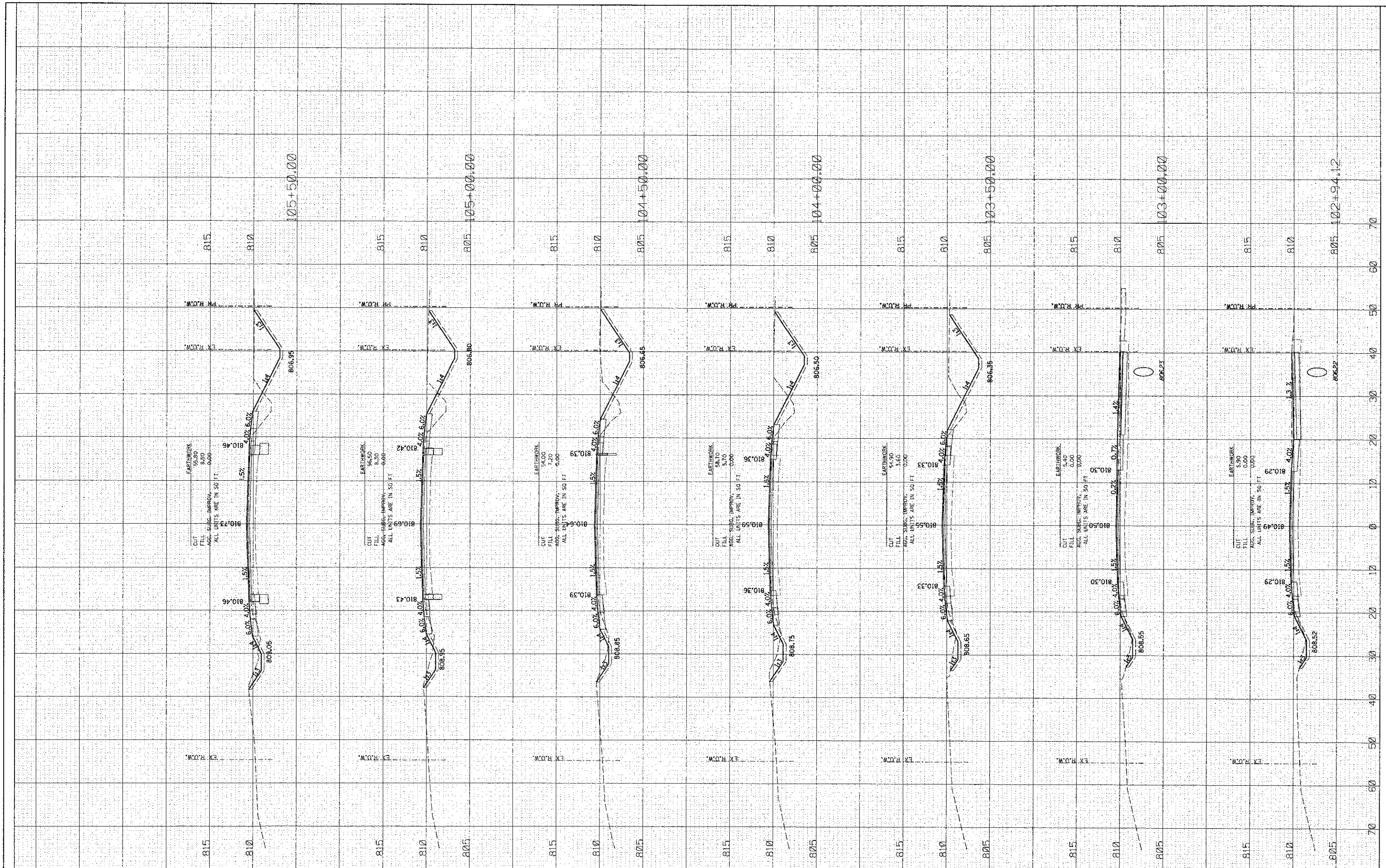

**HRGreen.com**  
 Illinois Professional Design Firm  
 #194-001322

USER NAME = sporne1	DESIGNED -	REVISED -
PLOT SCALE =	DRAWN -	REVISED -
PLOT DATE = 2/13/2013	CHECKED -	REVISED -
	DATE -	REVISED -

**STATE OF ILLINOIS  
 DEPARTMENT OF TRANSPORTATION**

<b>CROSS SECTIONS ILLINOIS ROUTE 176</b>		
SCALE: 10H:5V	SHEET NO. 2 OF 7 SHEETS	STA. TO STA.

F.A.M. RTE. 4087	SECTION 98-00024-00-WR	COUNTY MCHENRY	TOTAL SHEETS 115	SHEET NO. 110
CONTRACT NO. 63532				
FED. ROAD DIST. NO. ILLINOIS FED. AID PROJECT				

DATE: \_\_\_\_\_ BY: \_\_\_\_\_  
 SURVEYED: \_\_\_\_\_  
 PLOTTED: \_\_\_\_\_  
 NOTE BOOK: \_\_\_\_\_  
 TEMPLATE: \_\_\_\_\_  
 AREAS CHECKED: \_\_\_\_\_

DATE: \_\_\_\_\_ BY: \_\_\_\_\_  
 SURVEYED: \_\_\_\_\_  
 PLOTTED: \_\_\_\_\_  
 NOTE BOOK: \_\_\_\_\_  
 TEMPLATE: \_\_\_\_\_  
 AREAS CHECKED: \_\_\_\_\_

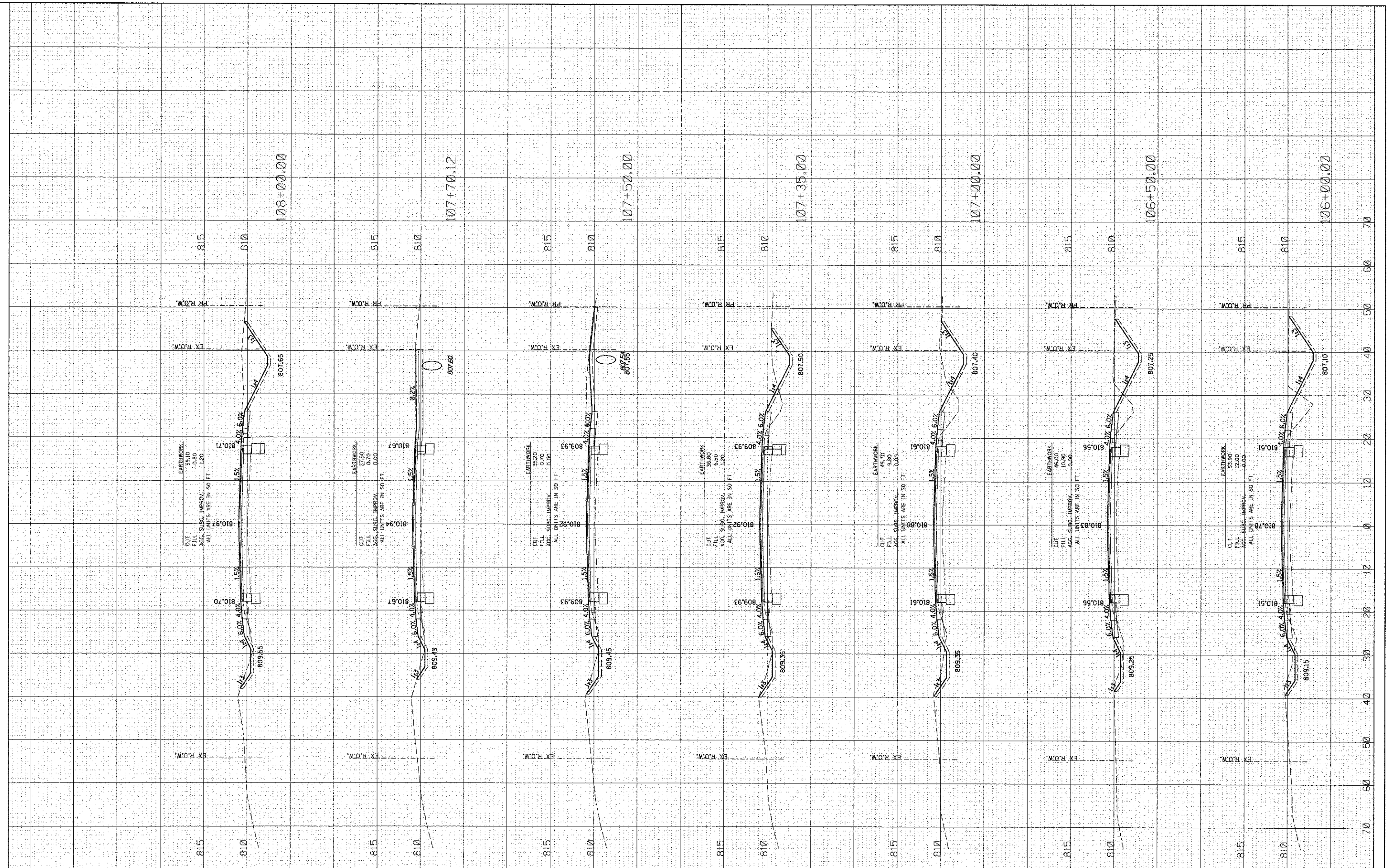

**HRGreen.com**  
 Illinois Professional Design Firm  
 #194-001322

USER NAME = spa-nal  
 PLOT SCALE =  
 PLOT DATE = 2/13/2013

DESIGNED -  
 DRAWN -  
 CHECKED -  
 DATE -

REVISED -  
 REVISED -  
 REVISED -  
 REVISED -

**STATE OF ILLINOIS  
 DEPARTMENT OF TRANSPORTATION**

**CROSS SECTIONS  
 ILLINOIS ROUTE 176**  
 SCALE: 10H:5V SHEET NO. 3 OF 7 SHEETS STA. TO STA.

F.A.W. RTE.	SECTION	COUNTY	TOTAL SHEETS
4087	98-00024-00-WR	MCHENRY	115 111
FED. ROAD DIST. NO. ILLINOIS FED. AID PROJECT			CONTRACT NO. 63532

FINAL SURVEY	BY	DATE
PLOTTED		
NOTE BOOK		
AREAS CHECKED		

ORIGINAL SURVEY	BY	DATE
PLOTTED		
NOTE BOOK		
AREAS CHECKED		

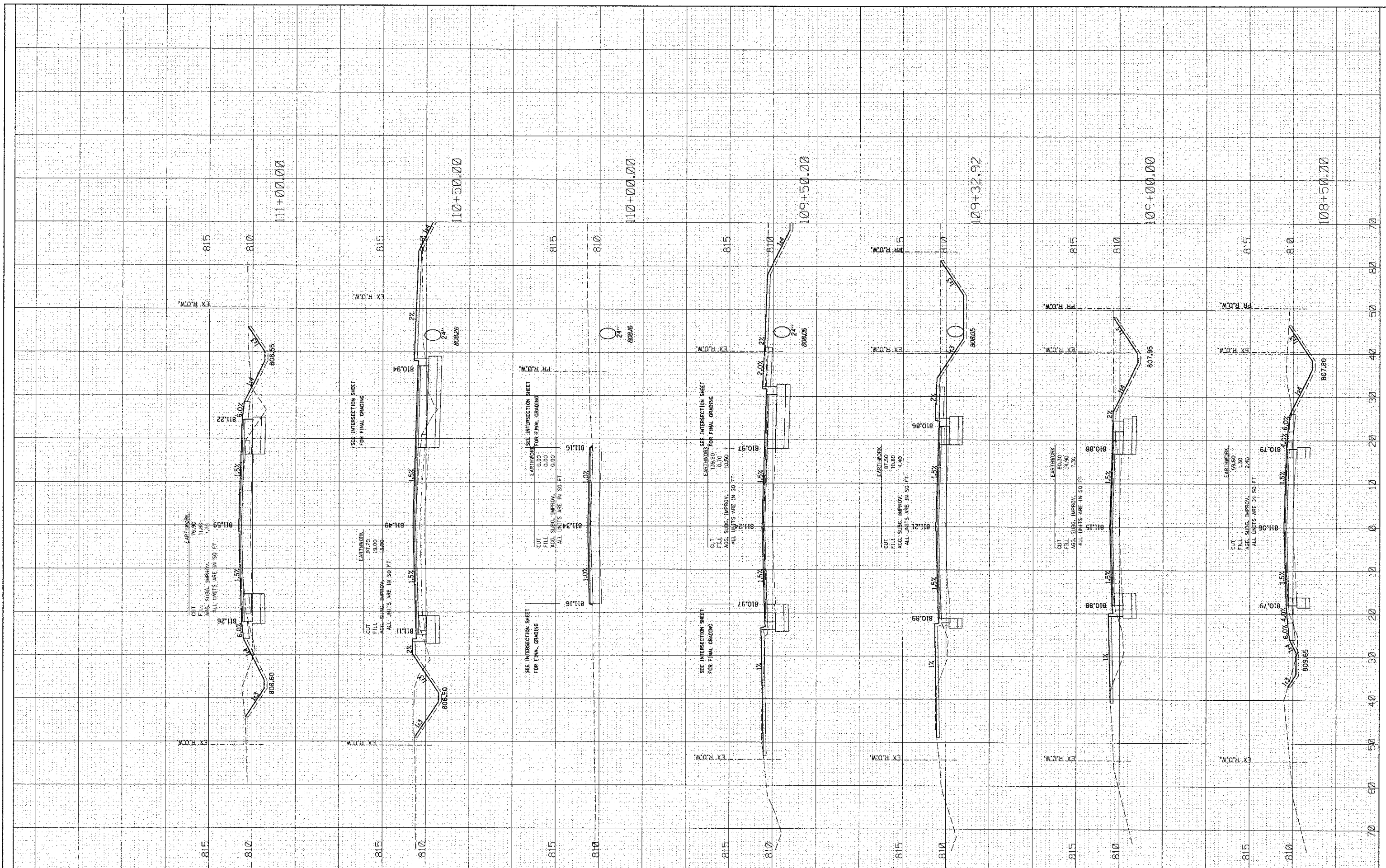

**HRGreen.com**  
 Illinois Professional Design Firm  
 #104-051322

USER NAME = sperna1
PLOT SCALE =
PLOT DATE = 2/13/2013

DESIGNED -	REVISED -
DRAWN -	REVISED -
CHECKED -	REVISED -
DATE -	REVISED -

**STATE OF ILLINOIS  
 DEPARTMENT OF TRANSPORTATION**

<b>CROSS SECTIONS ILLINOIS ROUTE 176</b>	
SCALE: 10H:5V	SHEET NO. 4 OF 7 SHEETS
STA.	TO STA.

F.A.J. RIE. 4087	SECTION 98-00024-00-WR	COUNTY McHENRY	TOTAL SHEETS 115	SHEET NO. 112
CONTRACT NO. 63532				
FED. ROAD DIST. NO. ILLINOIS FED. AID PROJECT				

FINAL SURVEY	DATE
PLOTTED	
NOTE BOOK	
AREAS CHECKED	

ORIGINAL SURVEY	DATE
PLOTTED	
NOTE BOOK	
AREAS CHECKED	

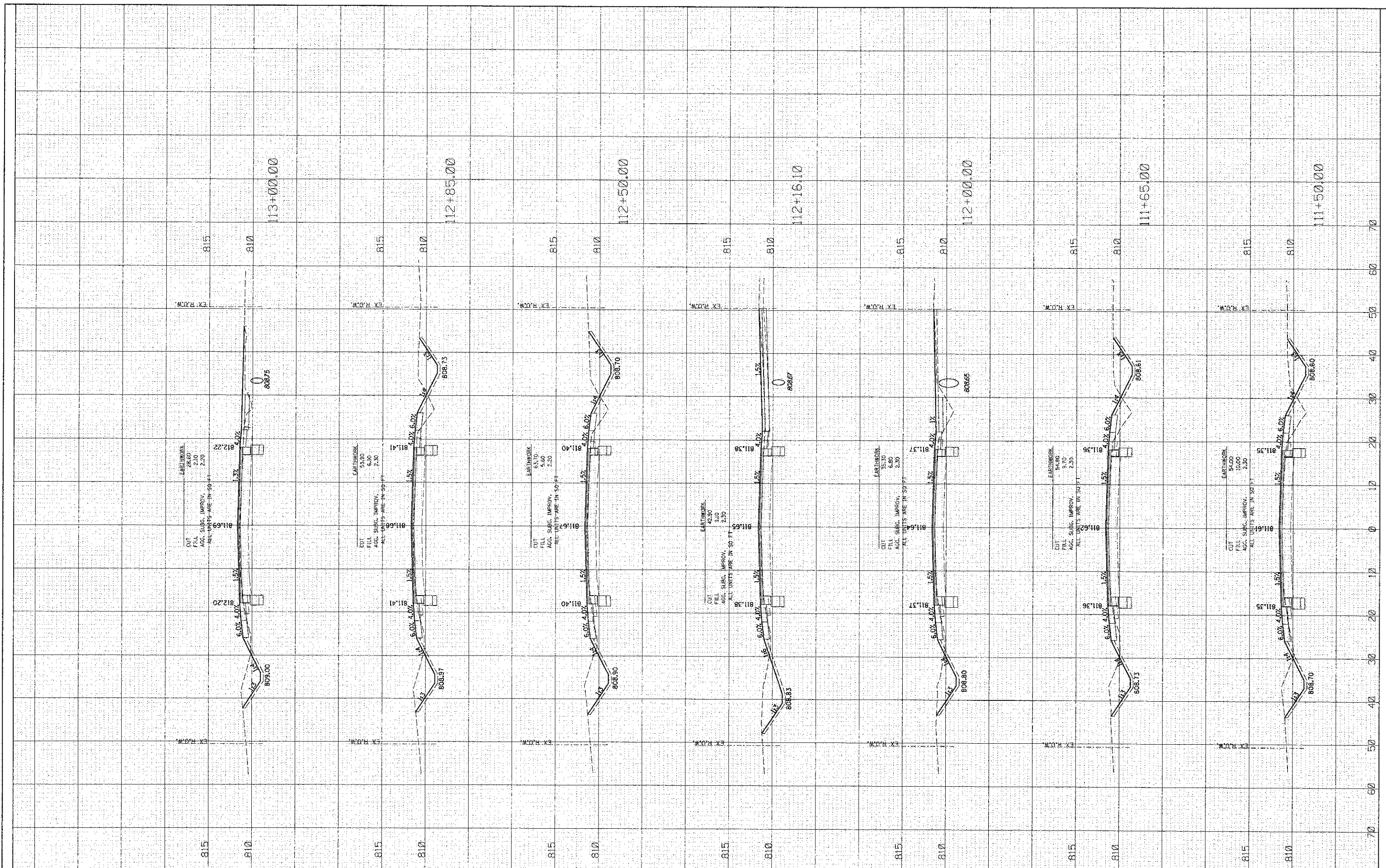

**HRGreen.com**  
 Illinois Professional Design Firm  
 # 164-001322

USER NAME = opora1  
 PLOT SCALE =  
 PLOT DATE = 2/13/2013

DESIGNED -	REVISED -
DRAWN -	REVISED -
CHECKED -	REVISED -
DATE -	REVISED -

**STATE OF ILLINOIS  
 DEPARTMENT OF TRANSPORTATION**

**CROSS SECTIONS  
 ILLINOIS ROUTE 176**

SCALE: 10H:5V    SHEET NO. 5 OF 7 SHEETS    STA.    TO STA.

F.A.W. RTE.	SECTION	COUNTY	TOTAL SHEETS	SHEET NO.
4087	98-00024-00-WR	McHENRY	115	113
FED. ROAD DIST. NO.			CONTRACT NO. 63532	
ILLINOIS FED. AID PROJECT				

DATE	
BY	
FINAL SURVEY	SURVEYED
NOTE BOOK NO.	PLOTTED
	TEMPLATE
	AREAS CHECKED

DATE	
BY	
ORIGINAL SURVEY	SURVEYED
NOTE BOOK NO.	PLOTTED
	TEMPLATE
	AREAS CHECKED

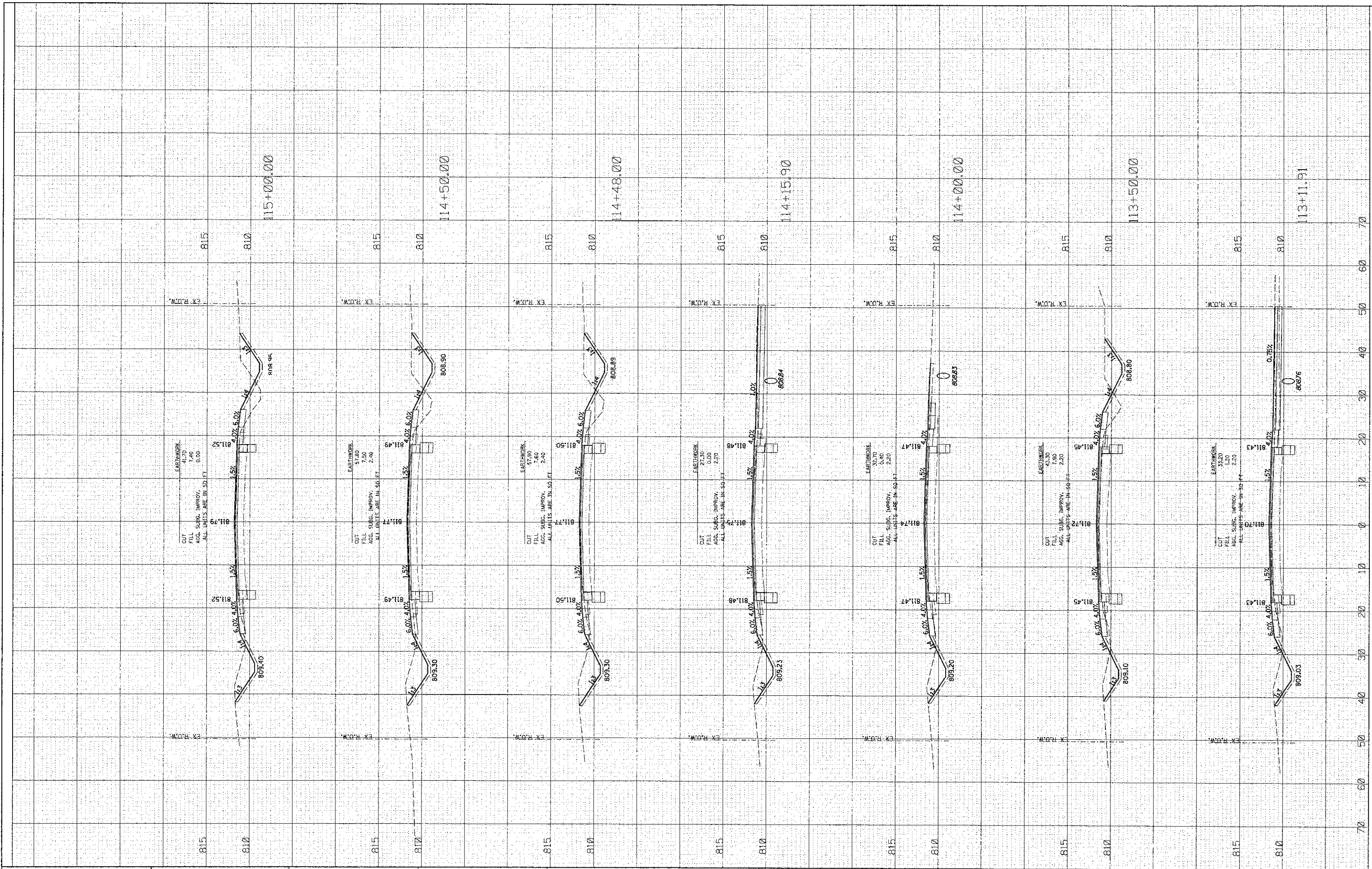

USER NAME = spernal	DESIGNED -	REVISED -
PLOT SCALE =	DRAWN -	REVISED -
PLOT DATE = 2/13/2013	CHECKED -	REVISED -
	DATE -	REVISED -

**STATE OF ILLINOIS  
DEPARTMENT OF TRANSPORTATION**

**CROSS SECTIONS  
ILLINOIS ROUTE 176**

SCALE: 10H=5V SHEET NO. 6 OF 7 SHEETS STA. TO STA.

F.A.U. RTE.	SECTION	COUNTY	TOTAL SHEETS	SHEET NO.
4097	98-00024-00-WR	MCHENRY	115	114
CONTRACT NO. 63532				
FED. ROAD DIST. NO. ILLINOIS FED. AID PROJECT				

FINAL	DATE
SURVEY	
PLOTTED	
NOTE BOOK	
AREAS CHECKED	

ORIGINAL	DATE
SURVEY	
PLOTTED	
NOTE BOOK	
AREAS CHECKED	

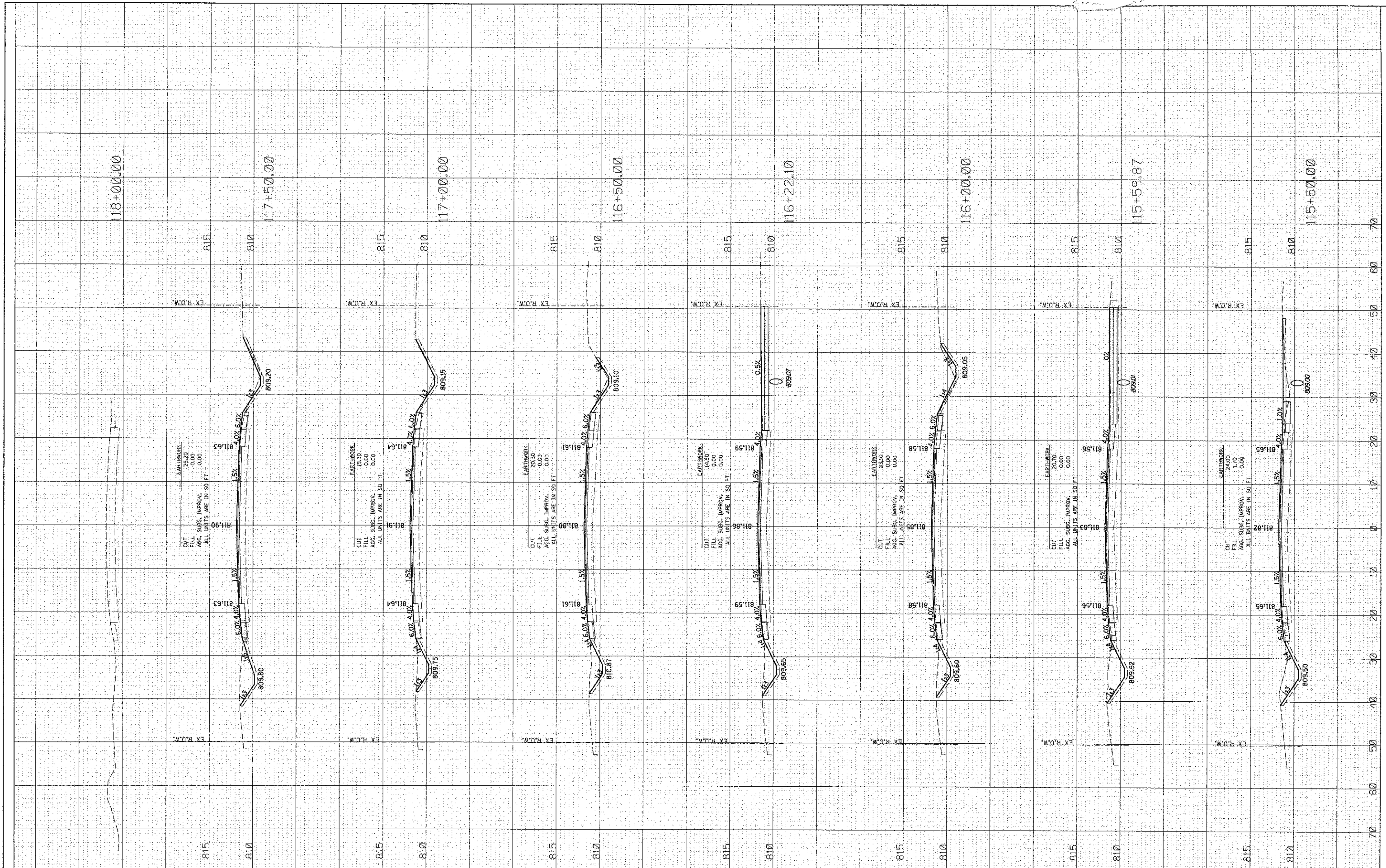

**HRGreen.com**  
 Illinois Professional Design Firm  
 #184-001322

USER NAME = spornal
PLOT SCALE =
PLOT DATE = 2/13/2013

DESIGNED -	REVISED -
DRAWN -	REVISED -
CHECKED -	REVISED -
DATE -	REVISED -

**STATE OF ILLINOIS  
DEPARTMENT OF TRANSPORTATION**

**CROSS SECTIONS  
ILLINOIS ROUTE 176**

SCALE: 10H:5V	SHEET NO. 7 OF 7 SHEETS	STA. TO STA.
---------------	-------------------------	--------------

F.A.I. RTE. 4087	SECTION 98-00024-00-WR	COUNTY MCHENRY	TOTAL SHEETS 115	SHEET NO. 115
FED. ROAD DIST. NO. ILLINOIS FED. AID PROJECT			CONTRACT NO. 63532	