

F.A.P. RTE.	SECTION	COUNTY	TOTAL SHEETS	SHEET NO.
361	06-00214-18-RP	KANE	451	1
		ILLINOIS	CONTRACT NO. 63598	

STATE OF ILLINOIS
DEPARTMENT OF TRANSPORTATION
DIVISION OF HIGHWAYS

**PROPOSED PLANS
FOR FEDERAL AID HIGHWAY**

FAP 361 IL RTE 25 (STEARNS ROAD)
SOUTH OF STEARNS RD TO DUNHAM RD
ROADWAY WIDENING, RECONSTRUCTION
& BRIDGE REPLACEMENT
SECTION 06-00214-18-RP
PROJECT HPP-1527(037)
KANE COUNTY

C-91-230-12

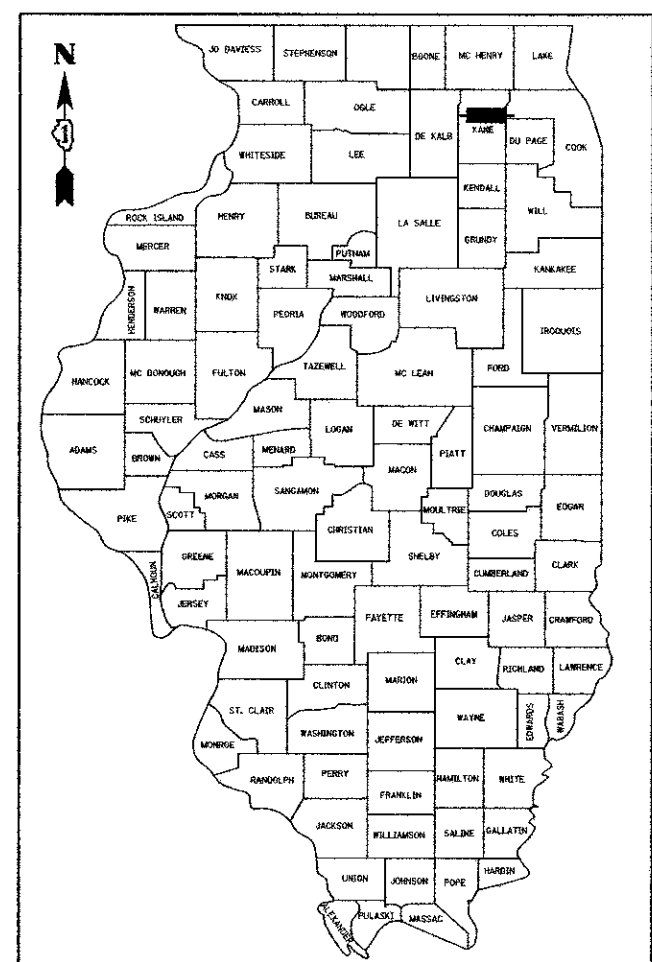

LOCATION OF SECTION INDICATED THUS: - [shaded box] -

FOR INDEX OF SHEETS, SEE SHEET NO. 2
FOR LIST OF STATE STANDARDS, SEE SHEET NO. 2

DESIGN DESIGNATION AND TRAFFIC DATA

2020 ADT VEHICLES	
IL 25	= 16,000
STEARNS RD	= 32,000
DUNHAM RD	= 35,000
GILBERT ST	= 9,000
DESIGN SPEED	= SEE SHEET 2
POSTED SPEED	= SEE SHEET 2
FUNCTIONAL CLASSIFICATION: OTHER PRINCIPAL ARTERIAL	

THIS PROJECT IS LOCATED IN
ST. CHARLES TOWNSHIP IN
UNINCORPORATED KANE COUNTY

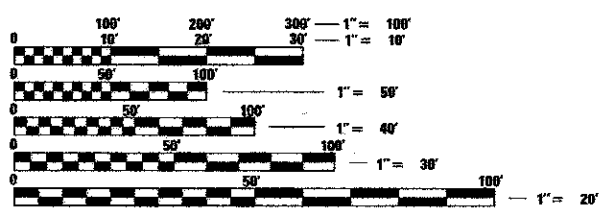

FULL SIZE PLANS HAVE BEEN PREPARED USING STANDARD ENGINEERING SCALES. REDUCED SIZED PLANS WILL NOT CONFORM TO STANDARD SCALES. IN MAKING MEASUREMENTS ON REDUCED PLANS, THE ABOVE SCALES MAY BE USED.

J.U.L.I.E.
JOINT UTILITY LOCATION INFORMATION FOR EXCAVATION
1-800-892-0123
OR 811

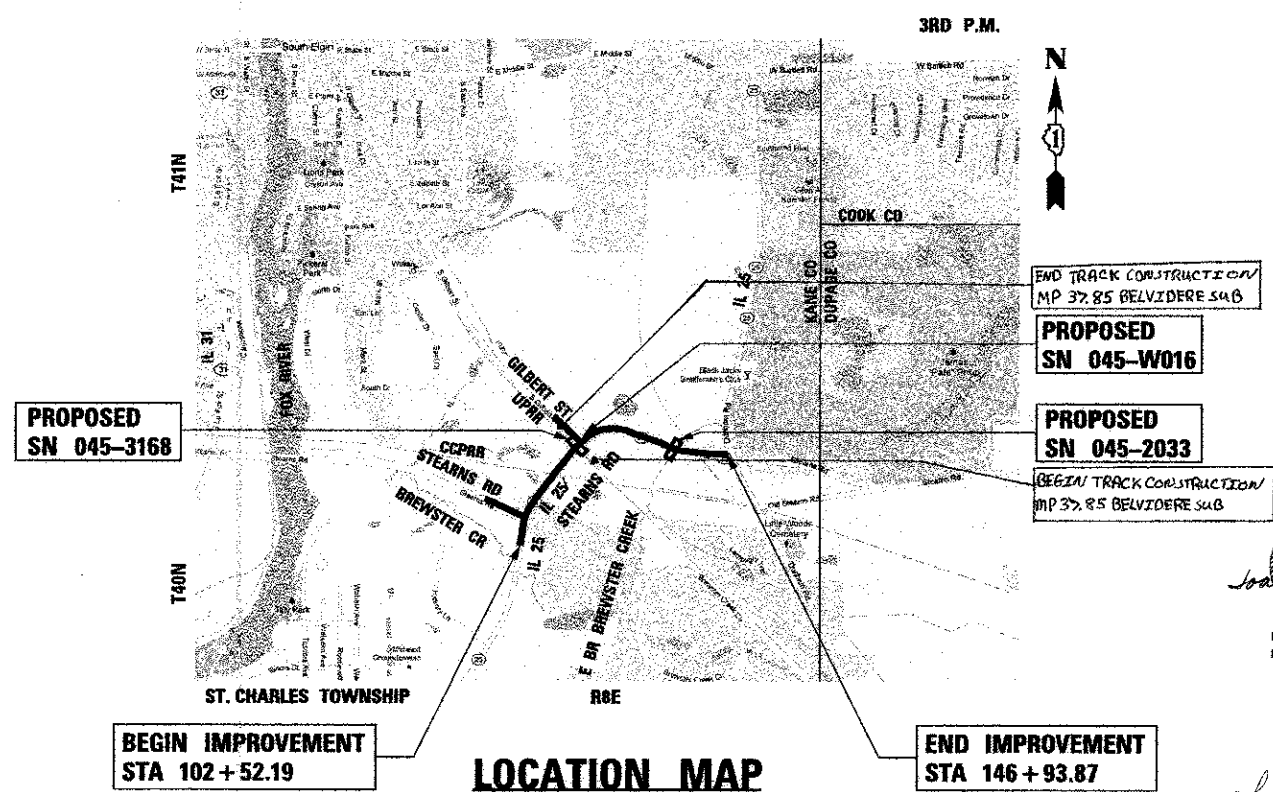

LOCATION MAP

SCALE: NTS

GROSS LENGTH = 4,441.68 FT. = 0.841 MILE
NET LENGTH = 4,441.68 FT. = 0.841 MILE

3RD P.M.



END TRACK CONSTRUCTION
MP 37.85 BELVIDERE SUB
PROPOSED
SN 045-W016
PROPOSED
SN 045-2033
BEGIN TRACK CONSTRUCTION
MP 37.85 BELVIDERE SUB

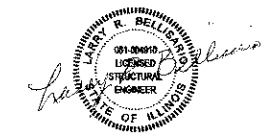

EXPIRATION DATE 11-30-2014
DATE 12-06-12

STATE OF ILLINOIS
DEPARTMENT OF TRANSPORTATION
DIVISION OF HIGHWAYS

APPROVED DECEMBER 12, 2012

[Signature]
KANE COUNTY ENGINEER

PASSED JANUARY 14, 2013

[Signature]
DISTRICT 1 ENGINEER OF LOCAL ROADS AND STREETS

RELEASING FOR BID
BASED ON LIMITED
REVIEW

JANUARY 14, 2013
[Signature]
DEPUTY DIRECTOR OF HIGHWAYS, REGION 1 ENGINEER

PRINTED BY THE AUTHORITY
OF THE STATE OF ILLINOIS

PROGRAM AND OFFICE ENGINEER: CHARLES F. RIDDLE, PE; (847)705-4406, SCHAUMBURG, IL

CONTRACT NO. 63598