

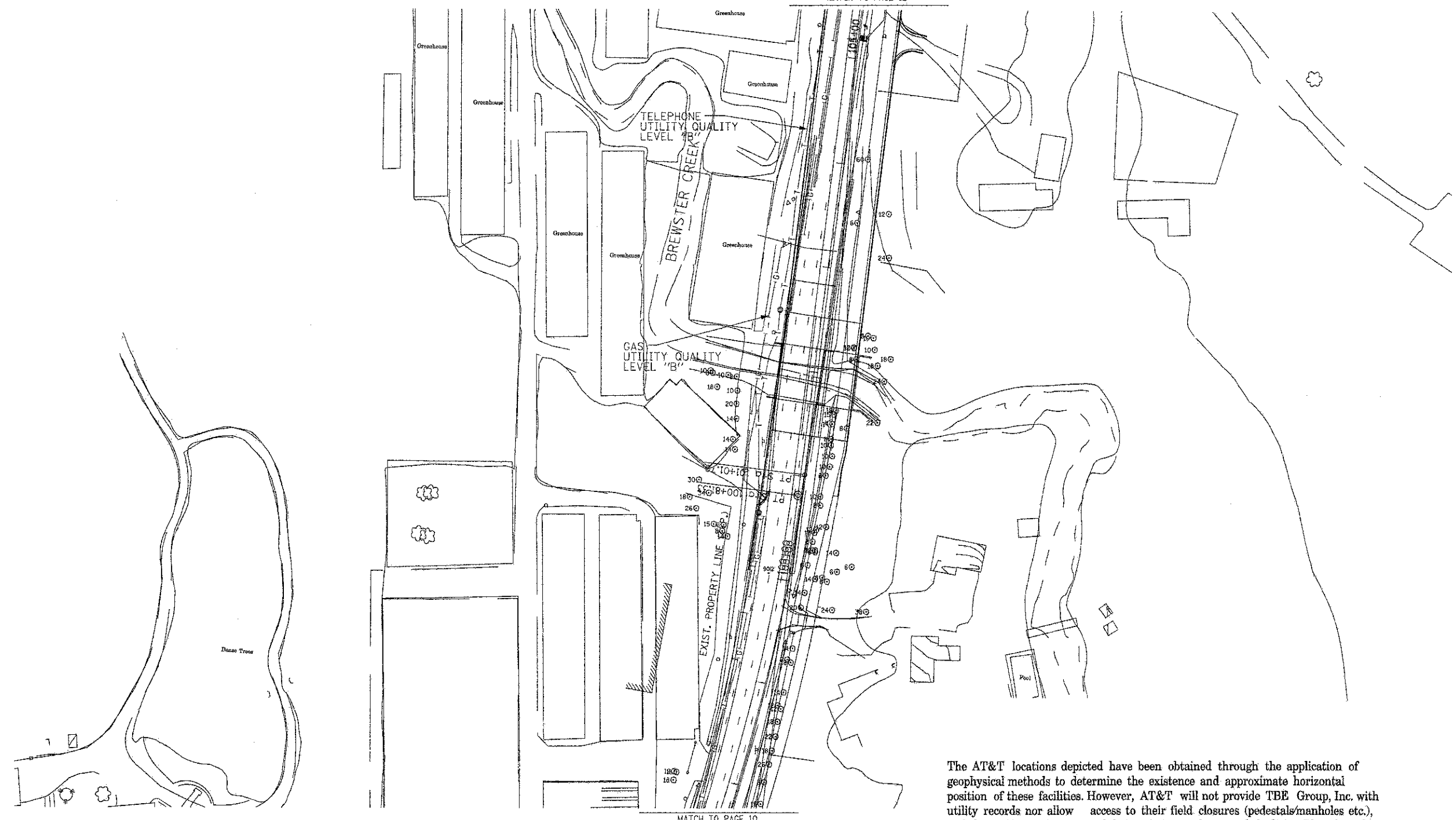

MATCH TO PAGE 12



MATCH TO PAGE 10

The AT&T locations depicted have been obtained through the application of geophysical methods to determine the existence and approximate horizontal position of these facilities. However, AT&T will not provide TBE Group, Inc. with utility records nor allow access to their field closures (pedestals/manholes etc.), to help verify the locations of their existing underground facilities. Therefore, TBE is unable to verify the completeness of the AT&T locations depicted in accordance with the CIASCE Standard 38-02.

205 W. WACKER DRIVE  
SUITE 1020  
CHICAGO, IL 60606  
(312) 704-1970

—●—●—●—●—●—	FORCE MAIN
—CTV—CTV—	CABLE TV
—T—T—	TELEPHONE
—G—G—	GAS
—E—E—	ELECTRIC
—W—W—	WATER
—FO—FO—	FIBER OPTIC
—●—	TBE TEST HOLE

Utilities shown in color on these plans as depicted in the legend have been investigated by TBE Group, Inc in accordance with SUE industry Standards. All other information shown has been provided to TBE Group, Inc by others. TBE's SUE field investigation was performed from 3/24/08 to 6/13/08. Changes to utilities after this date may have been made and therefore may result in variances from this plan. Consideration should be given to updating this plan if deemed advisable prior to final design and construction.

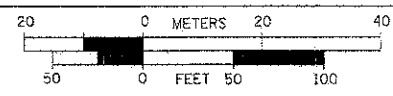

- Utility Quality Level "A" : Test Hole
- Utility Quality Level "B" : Designating
- Utility Quality Level "C" : Research with Survey
- Utility Quality Level "D" : Records Research

**TBE GROUP, INC.**  
CIVIL ENGINEERING • TRANSPORTATION • ENVIRONMENTAL  
• PLANNING • UTILITY ENGINEERING/LOCATING

Checked By: *[Signature]*  
Date: 1-8-09

TBE Job No. IL09500274,  
284, 285, 286, 288  
SUE Plan Page: 11 of 21

FILE NAME =	USER NAME =	DESIGNED <i>EG, JP, SW</i>	REVISED
#FILE#		DRAWN <i>KLC</i>	REVISED
	PLOT SCALE =	CHECKED <i>RLC</i>	REVISED
	PLOT DATE = #DATE#	DATE <i>6/16/08</i>	REVISED

**STATE OF ILLINOIS  
DEPARTMENT OF TRANSPORTATION  
AND KANE COUNTY HIGHWAY DEPT.**

**STEARNS ROAD CORRIDOR**

SCALE:	SHEET NO.	STA.	TO STA.
--------	-----------	------	---------

F.A.P. RTE.	SECTION	COUNTY	TOTAL SHEETS	SHEET NO.
361	06-00214-18-RP	KANE/DUPAGE	451	157
CONTRACT NO.			63598	
FED. ROAD DIST. NO. ILLINOIS Job No.:				