

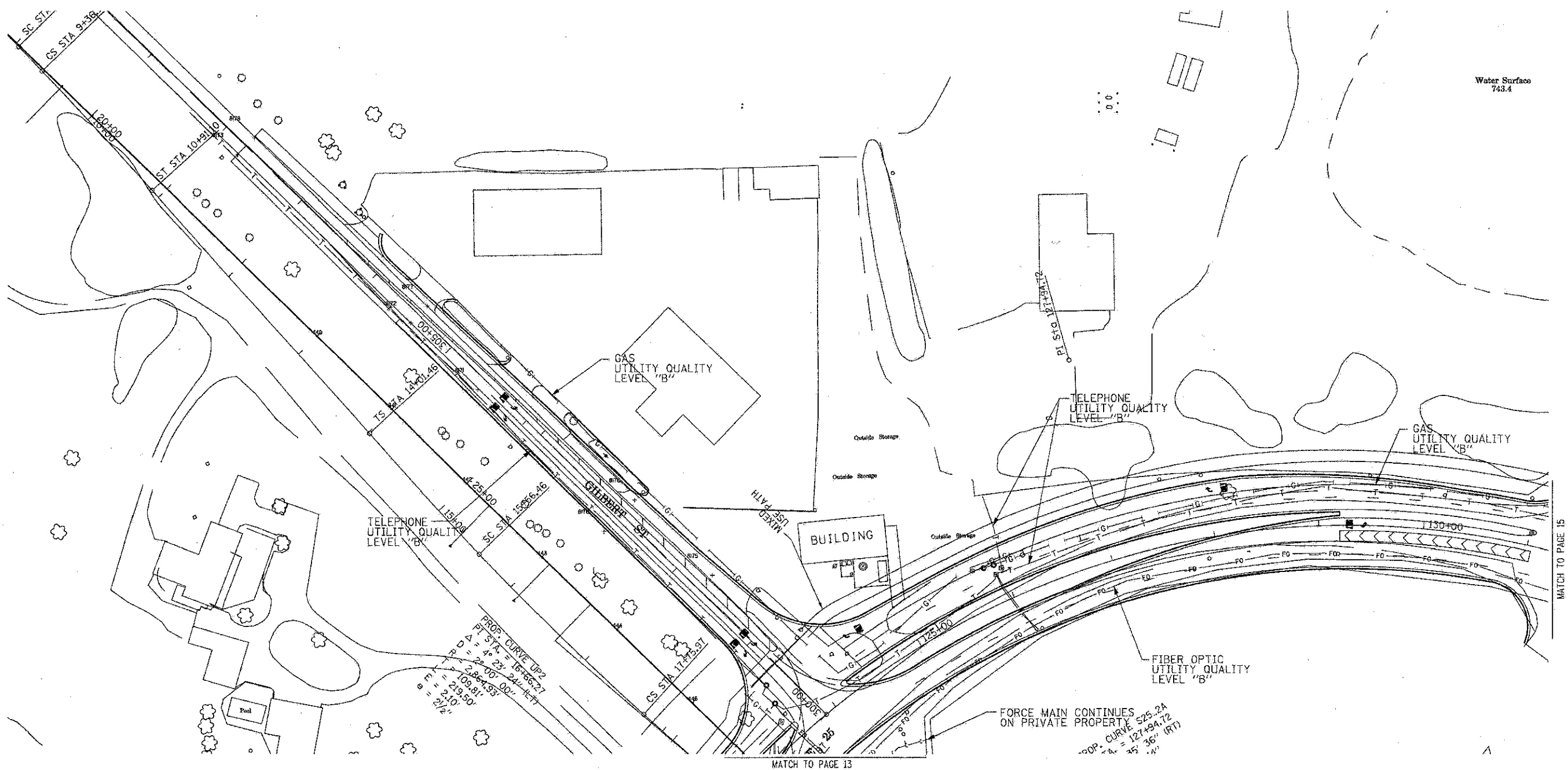

Water Surface  
743.4

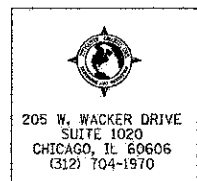

The AT&T locations depicted have been obtained through the application of geophysical methods to determine the existence and approximate horizontal position of these facilities. However, AT&T will not provide TBE Group, Inc. with utility records nor allow access to their field closures (pedestals/manholes etc.), to help verify the locations of their existing underground facilities. Therefore, TBE is unable to verify the completeness of the AT&T locations depicted in accordance with the CI/ASCE Standard 38-02.



- FORCE MAIN
- CTV— CABLE TV
- T— TELEPHONE
- G— GAS
- E— ELECTRIC
- W— WATER
- FO— FIBER OPTIC
- TBE TEST HOLE

Utilities shown in color on these plans as depicted in the legend have been investigated by TBE Group, Inc. in accordance with SUE Industry Standards. All other information shown has been provided to TBE Group, Inc. by others. TBE's SUE field investigation was performed from 3/24/08 to 6/13/08. Changes to utilities after this date may have been made and therefore may result in variances from this plan. Consideration should be given to updating this plan if deemed advisable prior to final design and construction.

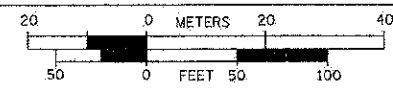

**TBE GROUP, INC.**  
CIVIL ENGINEERING • TRANSPORTATION • ENVIRONMENTAL  
• PLANNING • UTILITY ENGINEERING/LOCATING

- Utility Quality Level "A" : Test Hole
- Utility Quality Level "B" : Designating
- Utility Quality Level "C" : Research with Survey
- Utility Quality Level "D" : Records Research

Checked By: RLC  
Date: 6-19-08

TBE Job No. IL09500274,  
284, 285, 286, 288  
SUE Plan Page: 14 of 21

FILE NAME =	USER NAME =	DESIGNED <u>EG, JP, SW</u>	REVISED
OFFICE #	PLOT SCALE =	DRAWN <u>KLC</u>	REVISED
	PLDT DATE = #DATE#	CHECKED <u>RLC</u>	REVISED
		DATE <u>6/16/08</u>	REVISED

STATE OF ILLINOIS  
DEPARTMENT OF TRANSPORTATION  
AND KANE COUNTY HIGHWAY DEPT.

**STEARNS ROAD CORRIDOR**  
SCALE: SHEET NO. STA. TO STA.

F.A.P. R.T.S.	SECTION	COUNTY	TOTAL SHEETS	SHEET NO.
361	06-00214-18-RP	KANE/DuPAGE	451	160
CONTRACT NO. 63598				
FED. ROAD DIST. NO. ILLINOIS Job No.				