

TRAFFIC SIGNAL LEGEND

	PROPOSED	EXISTING
CONTROLLER		
SERVICE INSTALLATION		
SIGNAL HEAD		
SIGNAL HEAD WITH BACKPLATE		
SIGNAL HEAD PEDESTRIAN		
SIGNAL POST		
MAST ARM ASSEMBLY AND POLE, STEEL		
MAST ARM ASSEMBLY AND POLE, ALUMINUM		
HANDHOLE		
HEAVY DUTY HANDHOLE		
DOUBLE HANDHOLE		
G.S. CONDUIT IN TRENCH OR PUSHED		
PEDESTRIAN PUSHBUTTON DETECTOR		
DETECTOR LOOP		
CAST IRON JUNCTION BOX		
COMMON TRENCH		
UNIT DUCT		
UNINTERRUPTIBLE POWER SUPPLY		
TELEPHONE CONNECTION		

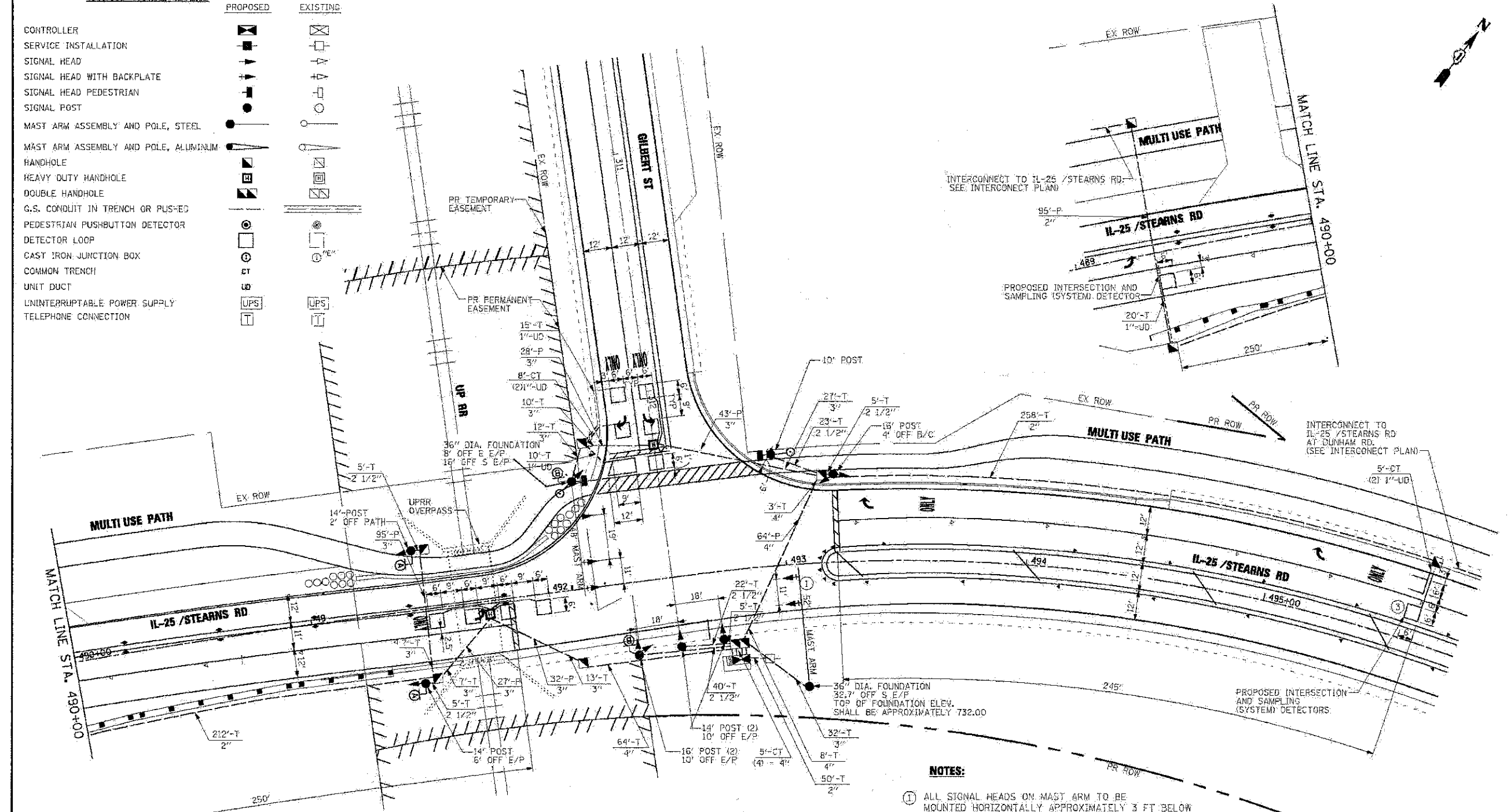

NOTES:

- ALL SIGNAL HEADS ON MAST ARM TO BE MOUNTED HORIZONTALLY APPROXIMATELY 3 FT. BELOW MAST ARM. INSTALLATION AND REQUIRED BRACKETS FOR SAID HORIZONTAL MOUNTING IS INCIDENTAL TO SIGNAL HEAD, LED, MAST ARM MOUNTED.
- ALL DETECTOR LOOPS, TYPE I SHALL BE SAW CUT AND INSTALLED PRIOR TO THE PLACEMENT OF THE SURFACE COURSE ASPHALT.
- THE SYSTEM DETECTOR LOOP EAST OF THE INTERSECTION SHALL BE PREFORMED DETECTOR LOOPS (PLACED WITHIN THE PCC PAVEMENT) PER IDOT DISTRICT 1 SPECIAL PROVISIONS.

FOR INFORMATION ONLY

RESTORATION OF WORK AREA. RESTORATION OF THE TRAFFIC SIGNAL WORK AREA SHALL BE INCIDENTAL TO THE RELATED PAY ITEM SUCH AS FOUNDATION, CONDUIT, HANDHOLE, TRENCH AND BACKFILL, ETC., AND NO EXTRA COMPENSATION SHALL BE ALLOWED. ALL ROADWAY SURFACES SUCH AS SHOULDERS, MEDIANS, SIDEWALKS, PAVEMENT, ETC. SHALL BE REPLACED IN KIND. ALL DAMAGE TO MOVED LAWNS SHALL BE REPLACED WITH AN APPROVED SOD, AND ALL DAMAGE TO UNMOVED FIELDS SHALL BE SEEDED IN ACCORDANCE WITH STANDARD SPECIFICATIONS 252 AND 250 RESPECTIVELY.

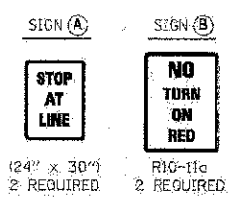

REVISED MAST ARM LENGTH, SIGNAL HEAD PLACEMENT, AND OTHER REVISIONS PER IDOT COMMENTS. THIS DRAWING (REV. 02/01/10) SUPERCEDES ALL PREVIOUS DRAWINGS.

FILE NAME = #FILES#	USER NAME = #USER#	DESIGNED - MPM	REVISED	KANE COUNTY DIVISION OF TRANSPORTATION	TRAFFIC SIGNAL INSTALLATION PLAN IL RTE. 25 / STEARNS RD. AT GILBERT ST.	F.A. RTE. 361	SECTION 06-00214-18-BR	COUNTY KANE/DUPAGE	TOTAL SHEETS 545	SHEET NO. 260	CONTRACT NO. 63074
PLOT SCALE = #SCALE#	DRAWN - VLM	CHECKED - GHT	REVISED			SCALE:	SHEET NO. OF SHEETS STA. TO STA.	750' ROAD DIST. NO.	ILLINOIS FED. AID PROJECT		
PLOT DATE = 2/15/2010	DATE - 3/31/09	REVISED	REVISED								

FILE NAME =	DESIGNED - BC	REVISED -
...AQ183599-shr-IL25-Gil-ex ts-plan.dgn	DRAWN - TMB	REVISED -
USER NAME = sbank	CHECKED - MPM	REVISED -
PLOT DATE = 1/18/2013	DATE - 01/18/2013	REVISED -



STATE OF ILLINOIS
DIVISION OF TRANSPORTATION

EXISTING TRAFFIC SIGNAL PLAN
IL 25/STEARNS RD AT GILBERT ST

SCALE: 1"=20' SHEET NO. 20 OF 49 SHEETS STA. TO STA.

F.A.P. RTE. 361	SECTION 06-00214-18-RP	COUNTY KANE	TOTAL SHEETS 451	SHEET NO. 231
CONTRACT NO. 63598				