

NOTE:
THE TRAFFIC SIGNAL CONTROLLER EQUIPMENT FOR THIS PROJECT SHALL BE "SIEMENS (EAGLE)" TO MATCH THE ADJACENT SYSTEM.

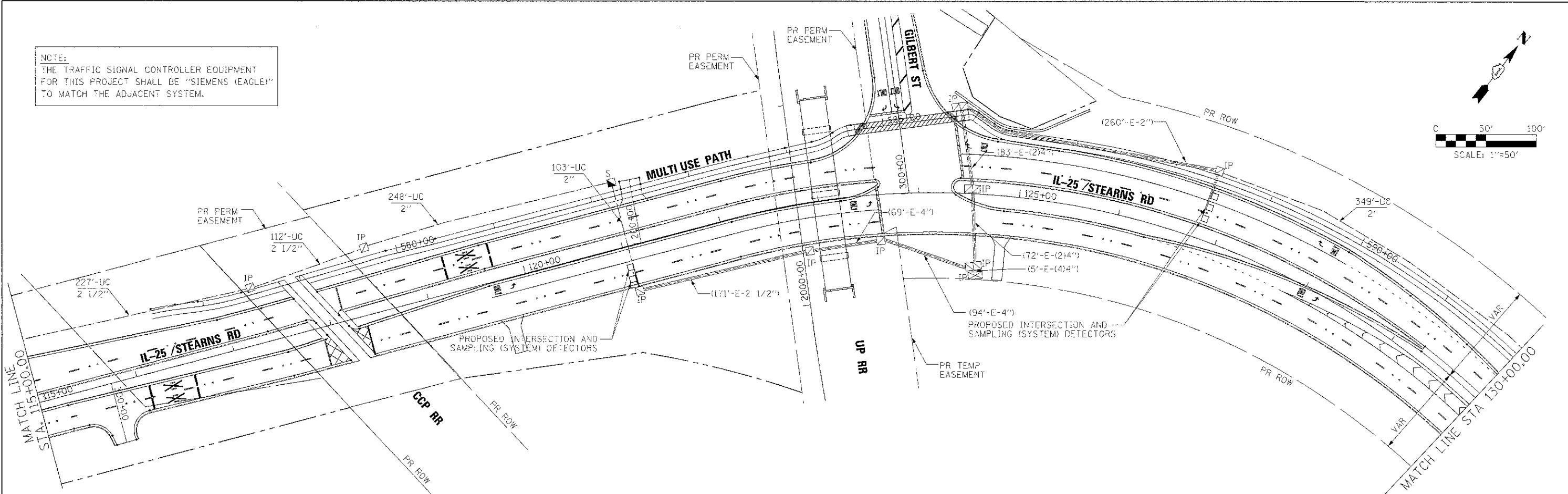

RESTORATION OF WORK AREA. RESTORATION OF THE TRAFFIC SIGNAL WORK AREA SHALL BE INCIDENTAL TO THE RELATED PAY ITEM SUCH AS FOUNDATION, CONDUIT, HANDHOLE, TRENCH AND BACKFILL, ETC., AND NO EXTRA COMPENSATION SHALL BE ALLOWED. ALL ROADWAY SURFACES SUCH AS SHOULDERS, MEDIANS, SIDEWALKS, PAVEMENT, ETC. SHALL BE REPLACED IN KIND. ALL DAMAGE TO MOVED LAWNS SHALL BE REPLACED WITH AN APPROVED SOG, AND ALL DAMAGE TO UNMOVED FIELDS SHALL BE SEEDD IN ACCORDANCE WITH STANDARD SPECIFICATIONS 252 AND 250 RESPECTIVELY.

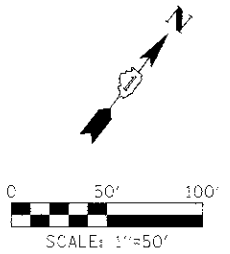
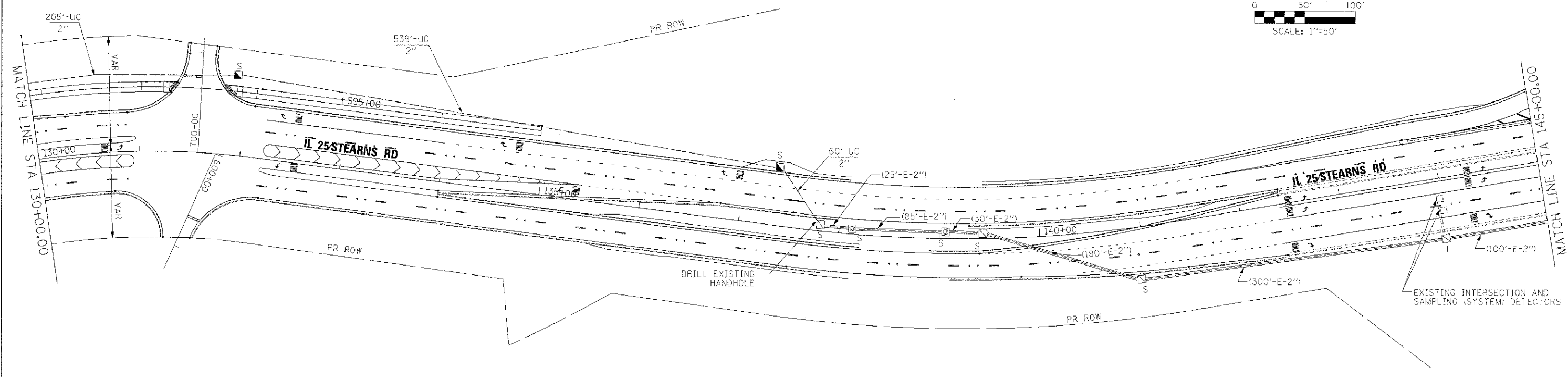
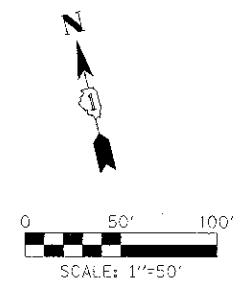

FILE NAME =	DESIGNED - BC	REVISED -
...\\0183598-enc-stas-Inter-Carr-02.dwg	DRAWN - TMB	REVISED -
USER NAME = tblank	CHECKED - MPM	REVISED -
PL3: DATE = 1/18/2013	DATE - 01/18/2013	REVISED -



STATE OF ILLINOIS
DIVISION OF TRANSPORTATION

INTERCONNECT PLAN
IL 25 - STEARNS RD TO IL 25/DUNHAM RD - SHEET 2 OF 3

SCALE: 1"=50' | SHEET NO. 42 OF 49 SHEETS | STA. TO STA.

F.A.P. RTE.	SECTION	COUNTY	TOTAL SHEETS	SHEET NO.
361	06-00214-18-RP	KANE	451	253
CONTRACT NO. 63598				ILLINOIS FDOT AID PROJECT