

**GENERAL NOTES**

- Specifications for Design: American Railroad Engineering Association Manual-1969, Superstructure-Chapter 15; Substructure-Chapter 8; Live loading-Cooper E72 plus steam impact.
- Specifications for material and workmanship: A.R.E.A. for Structural Steel-Standard Specifications for Road and Bridge Construction; State of Illinois Department of Transportation, Division of Highway, July 2, 1973, for concrete, high strength steel bolts and all other material, except those covered by special provisions.
- High strength steel bolts shall be used for all field connections unless noted otherwise.
- Class K concrete shall be used throughout.
- The main load carrying member components subject to the Supplemental Requirements for Notch Toughness are the flanges, webs, and splice plates of the steel girders or wide flange beams.
- For painting see special provision.

**DESIGN MOMENTS, SHEARS, AND REACTIONS**

	MOMENT	SHEAR	REACTION
D.L.	228,000 ft.-lb.	14,700 lb.	14,700 lb.
L.L.	750,250 ft.-lb.	74,550 lb.	74,550 lb.
IMP.	518,000 ft.-lb.	31,000 lb.	31,000 lb.
TOTAL	1,496,250 ft.-lb.	120,250 lb.	120,250 lb.

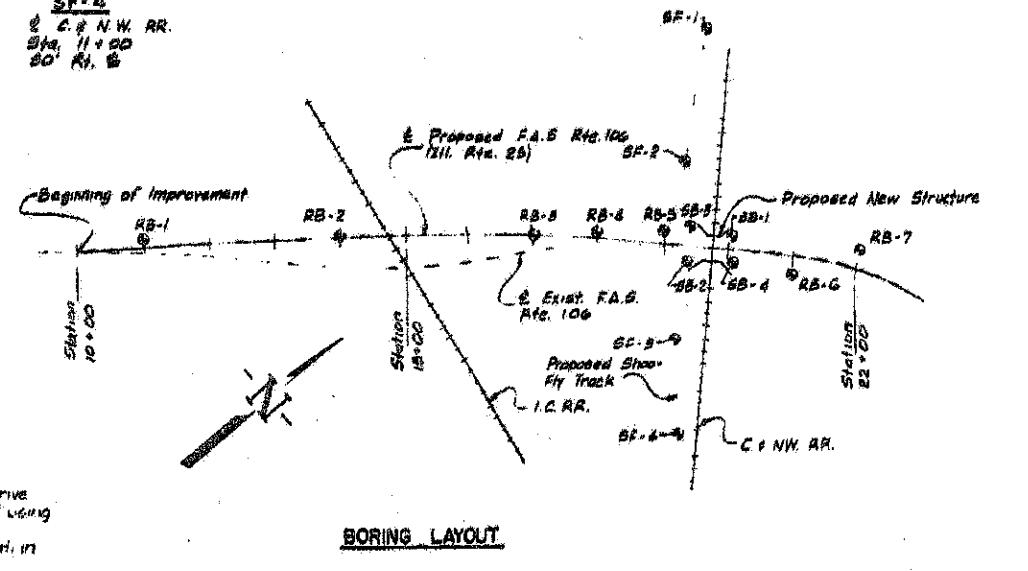

**LEGEND**

N = Number of blows required to drive 2" O.D. split spoon sampler 12" using 140 lb weight falling 50"

Qu = Unclassified compressive strength, in tons per square foot

W = Natural water content (% of dry weight)

SB = Structure Boring

SF = Show-Fly Boring

RB = Roadway Boring (Soil Survey)

**BORINGS & GENERAL NOTES**  
**C. & N.W. RY. OVER F.A.S. RTE. 106**  
**C.H. ROUTE 15 (ILL. RTE. 25)**  
**SECTION 49-SB-1**  
**KANE COUNTY, ILLINOIS**

WALTER E. HANSON COMPANY  
 STRUCTURAL ENGINEERS  
 CONSULTANTS

100925  
 Oct. 18, 1971

FILE NAME =	USER NAME =	DESIGNED = JLS	REVISED =
EXIST. PLANS: 892.dgn	PILOT SCALE =	CHECKED = LRB	REVISED =
	PILOT DATE = 12/13/2012	DRAWN = RMG	REVISED =
		CHECKED = LRB	REVISED =

X:\1000205\10074\Engineering\Documents\Phase\_II\NSL\045\_3168\UPRR-Bridge\Plans\Exist.Plans\_002.dgn 3/13/45 PM