

DATE	3/17/2013
SUPPLIER	
NO. OF SHEETS	409
NO. OF SHEETS CHECKED	
NO.	

DATE	
BY	
ORIGINAL	
SURVEY	
NOTE BOOK	
PLANS CHECKED	

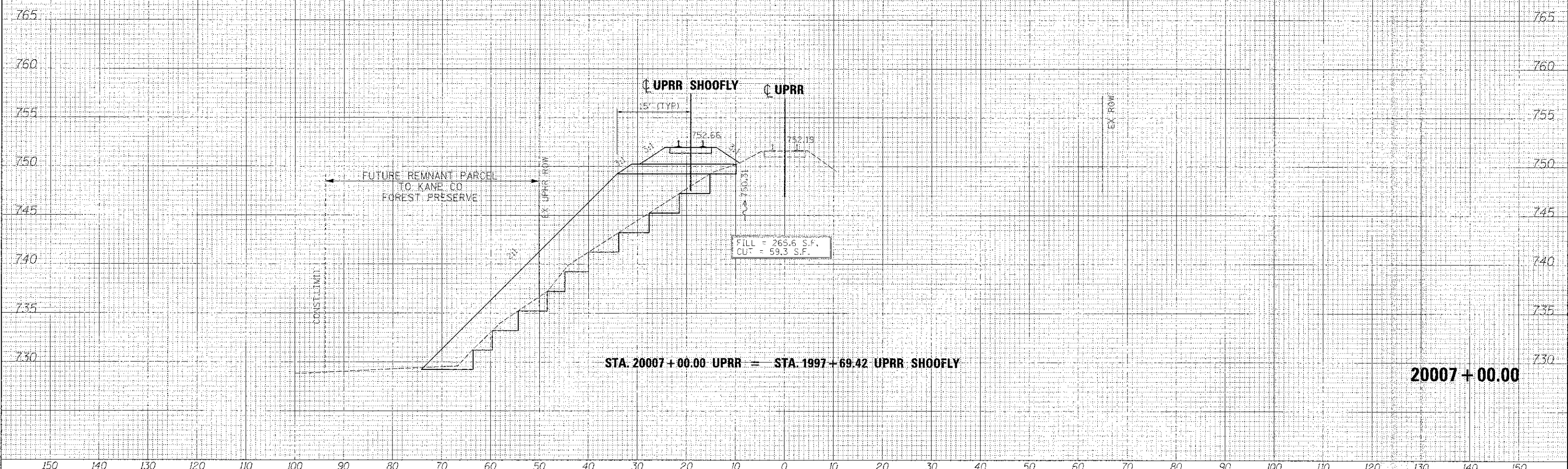

FILE NAME =	DESIGNED - AFS	REVISED -
...\\d163398-3\UPRR-S-C-xsec.dgn	DRAWN - TMB	REVISED -
USER NAME = tblank	CHECKED - JMM	REVISED -
PLCT DATE = 1/17/2013	DATE - 01/18/2013	REVISED -



STATE OF ILLINOIS
DIVISION OF TRANSPORTATION

CROSS SECTIONS
UPRR SHOOFLY

F.A.P. RTE.	SECTION	COUNTY	TOTAL SHEETS	SHEET NO.
361	06-06214-18-RP	KANE	451	409
CONTRACT NO. 63598				

SCALE: H 1"=10', V 1"=5' SHEET NO. 7 OF 20 SHEETS STA. 20007+00.00 TO STA. 20007+00.00

ILLINOIS FED. AID PROJECT