

STATE OF ILLINOIS  
DEPARTMENT OF TRANSPORTATION  
DIVISION OF HIGHWAYS

**PLANS FOR PROPOSED  
FEDERAL AID HIGHWAY**

**FAU ROUTE 1019 (RIDGELAND AVENUE)  
VICTORIA DRIVE TO 151ST STREET  
RESURFACING  
PROJECT No.: M-4003(149)  
CITY OF OAK FOREST  
SECTION No.: 11-00098-00-RS  
COOK COUNTY  
JOB No: C-91-167-13**

FOR INDEX OF SHEETS, SEE SHEET NO. 2

FOR INDEX OF HIGHWAY STANDARDS, SEE SHEET NO. 2

PROJECT LOCATED IN THE CITY OF OAK FOREST

F.A.U. RTE. 1019	SECTION 11-00098-00-RS	COUNTY COOK	TOTAL SHEETS 15	SHEET NO. 1
STA.		TO STA.		
FED. ROAD DIST. NO.	ILLINOIS	FED AID PROJECT		

CONTRACT NO. 63795

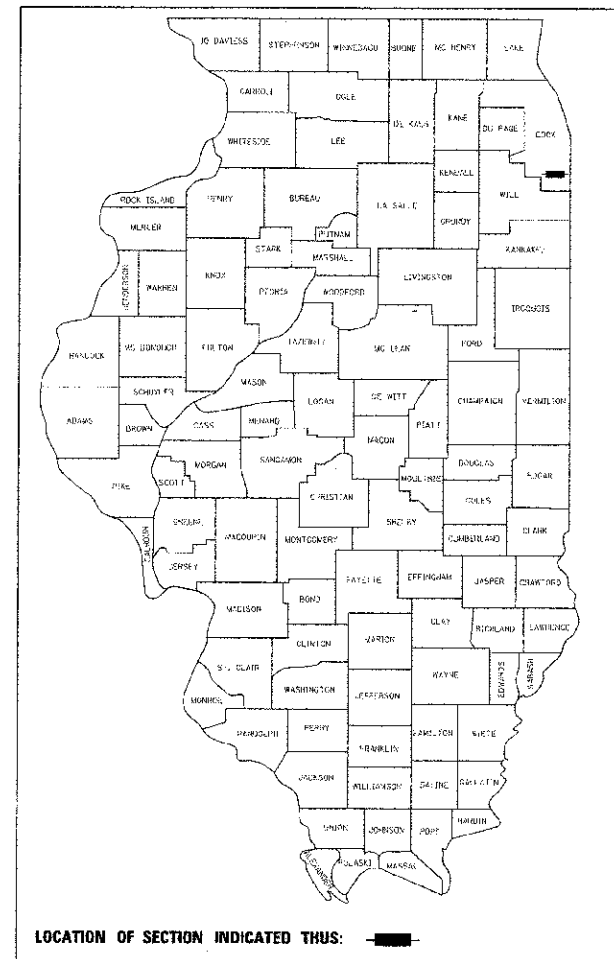

**FAU 1019 RIDGELAND AVENUE  
PROJECT ENDS STA 36+21**

**TRAFFIC DATA**

RIDGELAND AVENUE  
POSTED SPEED LIMIT = 20 MPH  
2011 ADT = 3,800 VPD

**DESIGN DESIGNATION  
COLLECTOR**

**FAU 1019 RIDGELAND AVENUE  
PROJECT BEGINS STA 10+38**

BAXTER & WOODMAN, INC.  
STATE OF ILLINOIS - PROFESSIONAL DESIGN FIRM  
LICENSE NO. - 184-001121 - EXPIRES 4/30/2013

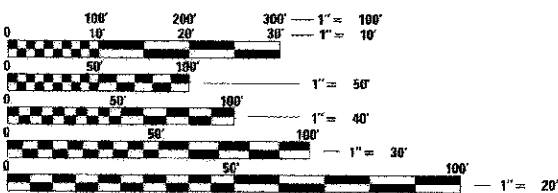

FULL SIZE PLANS HAVE BEEN PREPARED USING STANDARD  
ENGINEERING SCALES. REDUCED SIZED PLANS WILL NOT  
CONFORM TO STANDARD SCALES. IN MAKING MEASUREMENTS  
ON REDUCED PLANS, THE ABOVE SCALES MAY BE USED.

J.U.L.I.E. DESIGN STAGE REQUEST  
DIG. No. X2790922

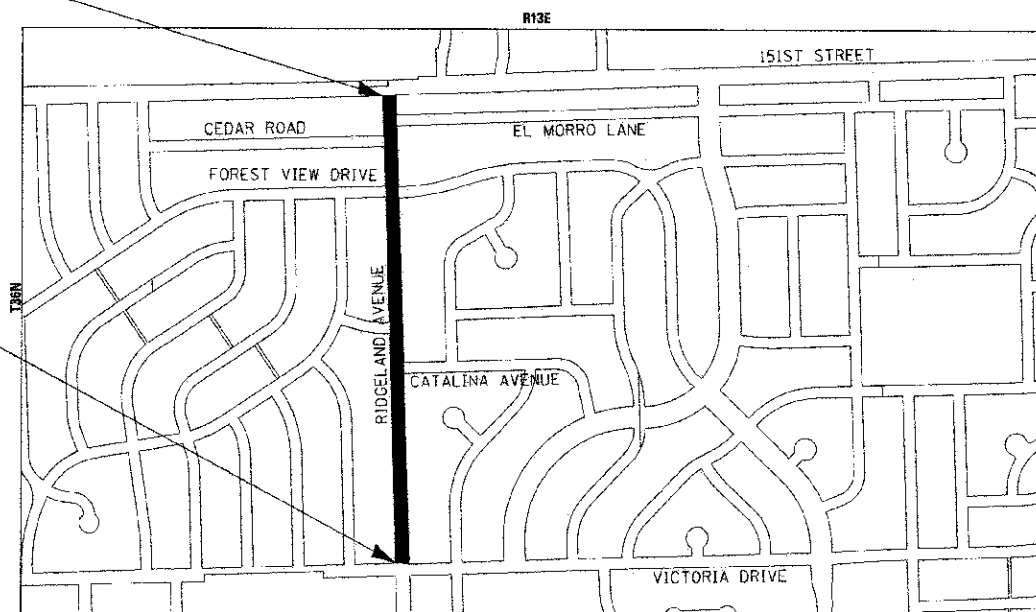

3RD PRINCIPAL MERIDIAN  
LOCATION MAP  
(NOT TO SCALE)  
BREMEN TOWNSHIP  
GROSS LENGTH OF IMPROVEMENT = 2,583 LF OR 0.489 MILES  
NET LENGTH OF IMPROVEMENT = 2,583 LF OR 0.489 MILES

**Call Before You Dig**  
**JULIE**  
ILLINOIS ONE CALL SYSTEM  
CONTACT JULIE AT 811 OR 800-892-0123  
WITH THE FOLLOWING:  
COUNTY = COOK  
CITY-TWNSHP. = OAK FOREST-BREMEN  
SEC. & 1/4 SEC. NO. =  
48 HOURS (2 working days) BEFORE YOU DIG

CONTRACT NO. 63795



PROFESSIONAL ENGINEER  
REGISTERED PROFESSIONAL ENGINEER  
OF ILLINOIS  
PROJECT MANAGER  
"LICENSE EXPIRES 11-30-13"

STATE OF ILLINOIS  
DEPARTMENT OF TRANSPORTATION  
DIVISION OF HIGHWAYS

APPROVED January 30 2013  
CITY ADMINISTRATOR Shay Jarber

PASSED February 25 2013  
DISTRICT 1 ENGINEER OF LOCAL ROADS & STREETS C. J. Holt

RELEASING FOR BID  
BASED ON LIMITED REVIEW February 27 2013  
DEPUTY DIRECTOR OF HIGHWAYS, REGION 1 ENGINEER John Fortman

**PRINTED BY THE AUTHORITY  
OF THE STATE OF ILLINOIS**



SUMMARY OF QUANTITIES				CONSTRUCTION TYPE CODE 0005	CONSTRUCTION TYPE CODE 0031
ITEM NO.	ITEMS	UNIT	TOTAL QUANTITY	QUANTITY	QUANTITY
20200100	EARTH EXCAVATION	CU YD	65	65	0
35101600	AGGREGATE BASE COURSE, TYPE B 4"	SQ YD	584	584	0
40600200	BITUMINOUS MATERIALS (PRIME COAT)	TON	4	4	0
40600300	AGGREGATE (PRIME COAT)	TON	21	21	0
40600400	MIXTURE FOR CRACKS, JOINTS, AND FLANGEWAYS	TON	5	5	0
40600827	POLYMERIZED LEVELING BINDER (MACHINE METHOD), IL-4.75, N50	TON	421	421	0
40600982	HOT-MIX ASPHALT SURFACE REMOVAL - BUTT JOINT	SQ YD	93	93	0
40603335	HOT-MIX ASPHALT SURFACE COURSE, MIX "D" N50	TON	842	842	0
42400200	PORTLAND CEMENT CONCRETE SIDEWALK 5 INCH	SQ FT	5,258	5,258	0
42400800	DETECTABLE WARNINGS	SQ FT	112	112	0
44000158	HOT-MIX ASPHALT SURFACE REMOVAL, 2 1/4"	SQ YD	10,023	10,023	0
44000600	SIDEWALK REMOVAL	SQ FT	5,493	5,493	0
44201696	CLASS D PATCHES, TYPE IV, 4 INCH	SQ YD	1,114	1,114	0
60234200	INLETS, TYPE A, TYPE I FRAME, OPEN LID	EACH	6	6	0

\* INDICATES ITEM COVERED BY SPECIAL PROVISION  
# INDICATES SPECIALTY ITEM

COPYRIGHT © 2012 BY BAXTER & WOODMAN, INC.  
 STATE OF ILLINOIS PROFESSIONAL DESIGN FIRM  
 415 E. WASHINGTON ST., SUITE 200, CHICAGO, IL 60601  
 TEL: (312) 467-2000 FAX: (312) 467-2001  
 WWW.BAXTERANDWOODMAN.COM



DESIGNED - TMS	REVISED -
DRAWN - KAH	REVISED -
CHECKED - JJF	REVISED -
DATE - 01-29-13	FILE - 110565-SHT-GenNotes.sht

**STATE OF ILLINOIS  
DEPARTMENT OF TRANSPORTATION**

**SUMMARY OF QUANTITIES**

SCALE: NONE

STA. TO STA.

F.A.U. RTE.	SECTION	COUNTY	TOTAL SHEETS	SHEET NO.
1019	11-00098-00-RS	COOK	15	3
CONTRACT NO. 63795				
FED. ROAD DIST. NO. ILLINOIS FED. AID PROJECT				

**SUMMARY OF QUANTITIES**

ITEM NO.	ITEMS	UNIT	TOTAL QUANTITY	CONSTRUCTION TYPE CODE	CONSTRUCTION TYPE CODE
				0005	0031
				QUANTITY	QUANTITY
60260100	INLETS TO BE ADJUSTED	EACH	11	11	0
60406100	FRAMES AND LIDS, TYPE 1, CLOSED LID	EACH	5	5	0
60500060	REMOVING INLETS	EACH	6	6	0
67100100	MOBILIZATION	LSUM	1	1	0
70102620	TRAFFIC CONTROL AND PROTECTION, STANDARD 701501	LSUM	1	1	0
70102640	TRAFFIC CONTROL AND PROTECTION, STANDARD 701801	LSUM	1	1	0
70300100	SHORT TERM PAVEMENT MARKING	FOOT	2,646	2,646	0
70301000	WORK ZONE PAVEMENT MARKING REMOVAL	SQ FT	294	294	0
# 72000100	SIGN PANEL - TYPE 1	SQ FT	7	7	0
# 72900100	METAL POST - TYPE A	FOOT	38	38	0
# 78000600	THERMOPLASTIC PAVEMENT MARKING - LINE 12"	FOOT	66	66	0
# 78000650	THERMOPLASTIC PAVEMENT MARKING - LINE 24"	FOOT	159	159	0
# A2002916	TREE, CELTIS OCCIDENTALIS (COMMON HACKBERRY), 2" CALIPER, BALLED AND BURLAPPED	EACH	6	0	6
# A2006820	TREE, QUERCUS MUEHLENBERGII (CHINKAPIN OAK), 2-1/2" CALIPER, BALLED AND BURLAPPED	EACH	16	0	16

\* INDICATES ITEM COVERED BY SPECIAL PROVISION  
 # INDICATES SPECIALTY ITEM

COPYRIGHT © 2011 BY BAXTER & WOODMAN, INC. ALL RIGHTS RESERVED. THIS DOCUMENT IS THE PROPERTY OF BAXTER & WOODMAN, INC. AND IS NOT TO BE REPRODUCED OR TRANSMITTED IN ANY FORM OR BY ANY MEANS, ELECTRONIC OR MECHANICAL, INCLUDING PHOTOCOPYING, RECORDING, OR BY ANY INFORMATION STORAGE AND RETRIEVAL SYSTEM. WITHOUT THE WRITTEN PERMISSION OF BAXTER & WOODMAN, INC.



DESIGNED - TWS	REVISED -
DRAWN - KAR	REVISED -
CHECKED - JUF	REVISED -
DATE - 01-29-13	FILE 110565-SHT-CenNo-es.sht

**STATE OF ILLINOIS  
 DEPARTMENT OF TRANSPORTATION**

**SUMMARY OF QUANTITIES**

SCALE: STA. TO STA.

F.A.I. R.T.E. 1019	SECTION 11-00096-CO-RS	COUNTY COOK	TOTAL SHEETS 15	SHEET NO. 4
CONTRACT NO. 63795				
FED. ROAD DIST. NO. ILLINOIS FED. AID PROJECT				

SUMMARY OF QUANTITIES				CONSTRUCTION TYPE CODE 0005	CONSTRUCTION TYPE CODE 0031
ITEM NO.	ITEMS	UNIT	TOTAL QUANTITY	QUANTITY	QUANTITY
# A2006920	TREE, QUERCUS PALUSTRIS (PIN OAK), 2-1/2" CALIPER, BALLED AND BURLAPPED	EACH	7	0	7
# A2008320	TREE, TILIA TOMENTOSA (SILVER LINDEN), 2-1/2" CALIPER, BALLED AND BURLAPPED	EACH	5	0	5
# A2008517	TREE, ULMUS JAPONICA X WILSONIANA MORTON (ACCOLADE ELM), 2-1/2" CALIPER, BALLED AND BURLAPPED	EACH	9	0	9
# A2008519	TREE, ULMUS MORTON GLOSSY (TRIUMPH ELM), 2-1/2" CALIPER, BALLED AND BURLAPPED	EACH	8	0	8
# B0237345	TREE, PYRUS CALLERYANA CLEVELAND (CLEVELAND SELECT CALLERY PEAR), 2" CALIPER, TREE FORM, BALLED AND BURLAPPED	EACH	10	0	10
# B2004116	TREE, MALUS PRAIRIFIRE (PRAIRIFIRE CRABAPPLE), 2" CALIPER, TREE FORM, BALLED AND BURLAPPED	EACH	2	0	2
# B2005413	TREE, PRUNUS VIRGINIANA SCHUBERT (CANADA RED CHOKECHERRY), 1-3/4" CALIPER, TREE FORM, BALLED AND BURLAPPED	EACH	7	0	7
* X4021000	TEMPORARY ACCESS (PRIVATE ENTRANCE)	EACH	38	38	0
* X6026050	SANITARY MANHOLES TO BE ADJUSTED	EACH	6	6	0
* X6030310	FRAMES AND LIDS TO BE ADJUSTED (SPECIAL)	EACH	8	8	0
* XX003435	PORTLAND CEMENT CONCRETE DRIVEWAY REMOVAL AND REPLACEMENT	SQ YD	736	736	0
* # XX007278	PARKWAY RESTORATION	SQ YD	1,156	1,156	0
* Z0004562	COMBINATION CONCRETE CURB AND GUTTER REMOVAL AND REPLACEMENT	FOOT	2,010	2,010	0
* Z0030850	TEMPORARY INFORMATION SIGNING	SQ FT	51.4	51.4	0

\* INDICATES ITEM COVERED BY SPECIAL PROVISION  
# INDICATES SPECIALTY ITEM

Copyright © 2013 by PAXTER & WOODMAN, INC.  
 STATE OF ILLINOIS  
 CONTRACT NO. 11-00098-00-RS  
 DATE: 01-29-13  
 FILE: 110565-SHT-GenNotes.sht



DESIGNED - IMS	REVISED -
DRAWN - KAR	REVISED -
CHECKED - JJF	REVISED -
DATE - 01-29-13	FILE - 110565-SHT-GenNotes.sht

STATE OF ILLINOIS  
DEPARTMENT OF TRANSPORTATION

SUMMARY OF QUANTITIES

SCALE:

STA. TO STA.

F.A.D. RTE. 1019	SECTION 11-00098-00-RS	COUNTY COOK	TOTAL SHEETS 15	SHEET NO. 5
CONTRACT NO. 63795				
FED. ROAD DIST. NO. ILLINOIS FED. AID PROJECT				

TABLE OF TREE SPECIES AND PLANTING LOCATION				
ADDRESS	STREET	SPECIES	SIZE	NOTES
RIDGELAND - WEST PARKWAY				
15100	Ridgeland	Red Chokecherry	1-3/4"	
15100	Ridgeland	Red Chokecherry	1-3/4"	
6401	Cedar	Red Chokecherry	1-3/4"	Ridgeland side
6400	Forestview	Accolade Elm	2-1/2"	Ridgeland side
6400	Forestview	Triumph Elm	2-1/2"	Ridgeland side
15220	Ridgeland	Pin Oak	2-1/2"	
15226	Ridgeland	Chinkapin Oak	2-1/2"	
15232	Ridgeland	Chinkapin Oak	2-1/2"	
15238	Ridgeland	Triumph Elm	2-1/2"	
15244	Ridgeland	Triumph Elm	2-1/2"	
15250	Ridgeland	Triumph Elm	2-1/2"	
15256	Ridgeland	Red Chokecherry	1-3/4"	
15264	Ridgeland	Red Chokecherry	1-3/4"	
15264	Ridgeland	Crabapple	2"	
15264	Ridgeland	Hackberry	2"	
15300	Ridgeland	Crabapple	2"	
15300	Ridgeland	Hackberry	2"	
15300	Ridgeland	Cleveland Select Pear	2"	
15330	Ridgeland	Cleveland Select Pear	2"	
15336	Ridgeland	Cleveland Select Pear	2"	
15354	Ridgeland	Hackberry	2"	
15400	Ridgeland	Silver Linden	2 1/2"	
15410	Ridgeland	Hackberry	2"	
15428	Ridgeland	Accolade Elm	2-1/2"	
15432	Ridgeland	Accolade Elm	2-1/2"	
15438	Ridgeland	Accolade Elm	2-1/2"	
15444	Ridgeland	Chinkapin Oak	2-1/2"	
15448	Ridgeland	Chinkapin Oak	2-1/2"	
15452	Ridgeland	Pin Oak	2-1/2"	
15456	Ridgeland	Chinkapin Oak	2-1/2"	
15460	Ridgeland	Chinkapin Oak	2-1/2"	
15460	Ridgeland	Cleveland Select Pear	2"	

TABLE OF TREE SPECIES AND PLANTING LOCATION				
ADDRESS	STREET	SPECIES	SIZE	NOTES
RIDGELAND - EAST PARKWAY				
15101	Ridgeland	Red Chokecherry	1-3/4"	
15101	Ridgeland	Cleveland Select Pear	2"	
15101	Ridgeland	Cleveland Select Pear	2"	
15101	Ridgeland	Pin Oak	2-1/2"	
15115	Ridgeland	Chinkapin Oak	2-1/2"	
15115	Ridgeland	Pin Oak	2-1/2"	
15127	Ridgeland	Chinkapin Oak	2-1/2"	
15135	Ridgeland	Chinkapin Oak	2-1/2"	
15145	Ridgeland	Chinkapin Oak	2-1/2"	
15145	Ridgeland	Pin Oak	2-1/2"	
15145	Ridgeland	Chinkapin Oak	2-1/2"	
15201	Ridgeland	Accolade Elm	2-1/2"	
15201	Ridgeland	Triumph Elm	2-1/2"	
15201	Ridgeland	Accolade Elm	2-1/2"	
15221	Ridgeland	Pin Oak	2-1/2"	
15227	Ridgeland	Chinkapin Oak	2-1/2"	
15233	Ridgeland	Chinkapin Oak	2-1/2"	
15241	Ridgeland	Accolade Elm	2-1/2"	
15249	Ridgeland	Accolade Elm	2-1/2"	
15255	Ridgeland	Accolade Elm	2-1/2"	
15301	Ridgeland	Silver Linden	2-1/2"	
15307	Ridgeland	Silver Linden	2-1/2"	
15315	Ridgeland	Cleveland Select Pear	2"	
15323	Ridgeland	Cleveland Select Pear	2"	
15329	Ridgeland	Red Chokecherry	1-3/4"	
15401	Ridgeland	Silver Linden	2-1/2"	
15409	Ridgeland	Hackberry	2"	
15413	Ridgeland	Silver Linden	2-1/2"	
15419	Ridgeland	Hackberry	2"	
15431	Ridgeland	Triumph Elm	2-1/2"	
15437	Ridgeland	Triumph Elm	2-1/2"	
15441	Ridgeland	Triumph Elm	2-1/2"	
15443	Ridgeland	Chinkapin Oak	2-1/2"	
15449	Ridgeland	Pin Oak	2-1/2"	
15455	Ridgeland	Chinkapin Oak	2-1/2"	
15461	Ridgeland	Chinkapin Oak	2-1/2"	
15467	Ridgeland	Cleveland Select Pear	2"	
15467	Ridgeland	Cleveland Select Pear	2"	

TOTAL: 70

CLASS D PATCHES, TYPE IV, 6"					
STATION	TO STATION	LT/RT	LENGTH (FT)	WIDTH (FT)	AREA (SQ YD)
10+38	10+61	FW	23.0	33	84.3
10+94	11+38	LT	44.0	7	34.2
10+94	11+38	RT	44.0	7	34.2
11+95	12+68	RT	73.0	7	56.8
12+20	12+68	LT	48.0	7	37.3
14+08	14+43	RT	35.0	7	27.2
16+61	18+07	RT	146.0	12	194.7
20+22	20+97	LT	75.0	7	58.3
21+16	21+53	LT	37.0	7	28.8
22+07	23+06	LT	99.0	7	77.0
23+88	25+02	LT	114.0	7	88.7
25+90	26+35	RT	45.0	12	60.0
31+40	31+62	CL	22.0	7	17.1
32+99	33+24	FW	25.0	33	91.7
34+39	35+00	FW	61.0	33	223.7

TOTAL: 1114

FRAMES AND LIDS TO BE ADJUSTED (SPECIAL)	
STATION	LT/RT
18+65	CL
21+06	CL
23+26	CL
29+35	CL
29+86	8' LT
30+91	33' LT
32+58	LT CL
36+08	CL LT

TOTAL: 8

SANITARY MANHOLES TO BE ADJUSTED	
STATION	LT/RT
12+24	RT
13+24	RT
30+84	LT
31+10	RT
33+80	RT CL
34+30	LT

TOTAL: 6

INLETS TO BE ADJUSTED		
STATION	LT/RT	NOTES
23+43	LT	
26+15	LT	
26+15	RT	
28+86	LT	
28+86	RT	
29+35	RT	
29+86	LT	3' DIAMETER FRAME
29+86	RT	3' DIAMETER FRAME
30+48	LT	
31+16	LT	
33+80	LT	

TOTAL: 11

INLETS, TYPE A, TYPE 1 FRAME, OPEN LID	
STATION	LT/RT
18+65	LT
18+65	RT
21+09	LT
22+97	LT
23+19	LT
33+25	LT

TOTAL: 6

REMOVING INLETS	
STATION	LT/RT
18+65	LT
18+65	RT
21+09	LT
22+97	LT
23+19	LT
33+25	LT

TOTAL: 6

COPYRIGHT © 2008 BY BAXTER & WOODMAN, INC. ... PROFESSIONAL ENGINEERING ... LICENSE NO. 0197701 ...



DESIGNED - TMS	REVISED -
DRAWN - KAP	REVISED -
CHECKED - JLF	REVISED -
DATE - 01-29-13	FILE - 110565-SHT-GenNotes.sh*

STATE OF ILLINOIS  
DEPARTMENT OF TRANSPORTATION

SCHEDULE OF MATERIALS

F.A.U. NO.	SECTION	COUNTY	TOTAL SHEETS	SHEET NO.
1019	1-00098-00-R5	COOK	15	6

CONTRACT NO. 63795  
FED. ROAD DIST. NO. ILLINOIS FED. AID PROJECT

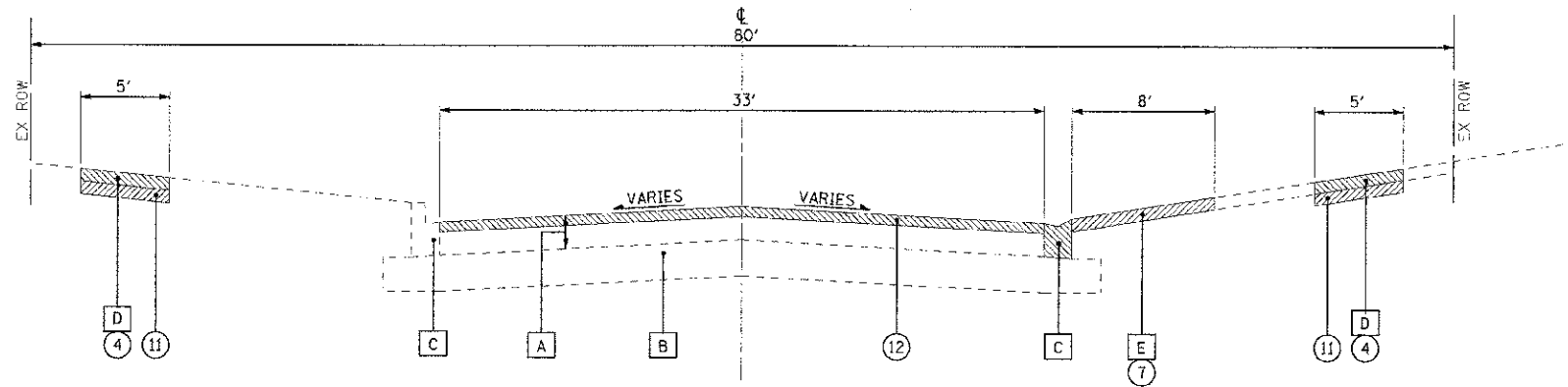

**EXISTING TYPICAL SECTION**  
RIDGELAND AVENUE STA 10+38 TO STA 36+21

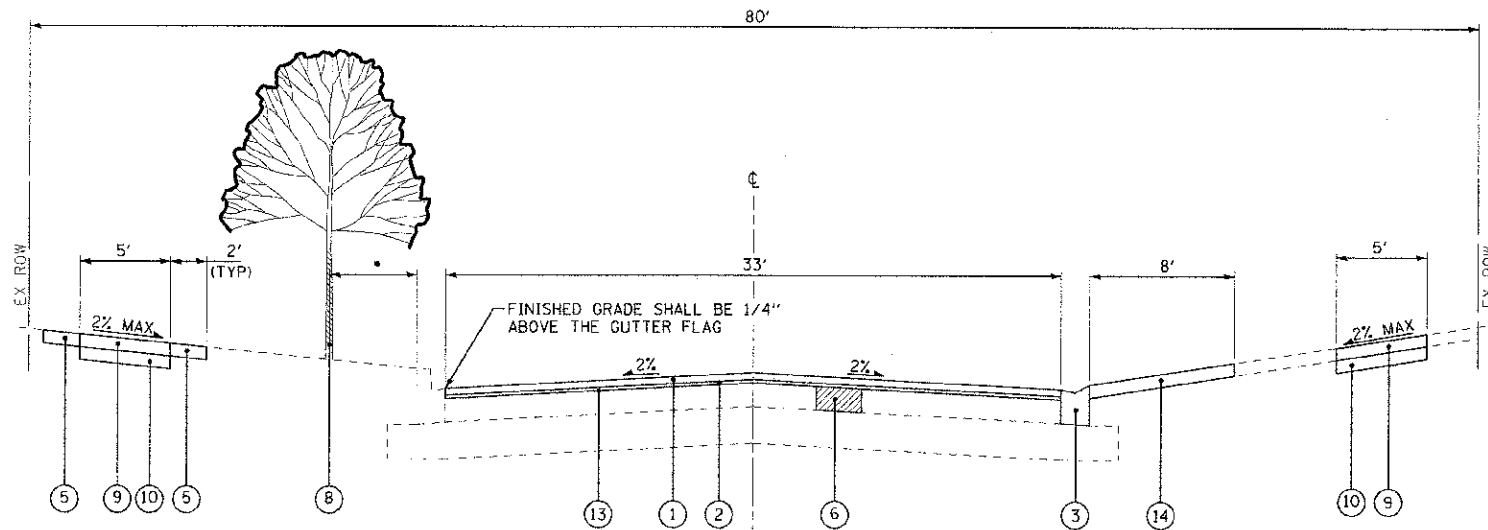

**PROPOSED TYPICAL SECTION**  
RIDGELAND AVENUE STA 10+38 TO STA 36+21

**LEGEND**

**EXISTING**

- A** HOT-MIX ASPHALT PAVEMENT
- B** AGGREGATE BASE COURSE
- C** COMBINATION CONCRETE CURB AND GUTTER
- D** SIDEWALK
- E** DRIVEWAY

**PROPOSED**

- 1** HOT-MIX ASPHALT SURFACE COURSE, MIX "D", N50 - 1 1/2"
- 2** POLYMERIZED LEVELING BINDER (MACHINE METHOD), N50 - 3/4"
- 3** COMBINATION CONCRETE CURB AND GUTTER REMOVAL AND REPLACEMENT (AS DETERMINED BY THE ENGINEER)
- 4** SIDEWALK REMOVAL (AS DETERMINED BY THE ENGINEER)
- 5** PARKWAY RESTORATION (AS DETERMINED BY THE ENGINEER)
- 6** CLASS D PATCHES - 4" (AS DETERMINED BY THE ENGINEER)
- 7** DRIVEWAY PAVEMENT REMOVAL (AS DETERMINED BY THE ENGINEER)
- 8** TREE
- 9** PCC SIDEWALK, 5-INCH
- 10** AGGREGATE BASE COURSE, TYPE B, 4"
- 11** EARTH EXCAVATION
- 12** HOT-MIX ASPHALT SURFACE REMOVAL, 2 1/4"
- 13** BITUMINOUS MATERIALS (PRIME COAT)
- 14** PCC DRIVEWAY PAVEMENT, 6"

**HOT-MIX ASPHALT MIXTURE REQUIREMENTS**

NOTE: CONTRACTOR SHALL MILL BEFORE PATCHING

MIX TYPE	AIR VOIDS @ Ndes
<b>PAVEMENT RESURFACING</b>	
HOT-MIX ASPHALT SURFACE COURSE, MIX "D", N50 (IL 9.5mm), 1 1/2"	4% @ 50 GYR
POLYMERIZED LEVELING BINDER (MACHINE METHOD), IL-4.75, N50, 3/4"	3.5% @ 50 GYR
<b>PATCHING</b>	
CLASS D PATCHES HOT-MIX ASPHALT BINDER, IL 19mm, N70, 4" (2 LIFTS)	4% @ 70 GYR

THE UNIT WEIGHT USED TO CALCULATE ALL HOT-MIX ASPHALT SURFACE MIXTURE QUANTITIES IS 112LB/SY-IN.

THE "AC TYPE" FOR POLYMERIZED HMA MIXES SHALL BE "SBS/SBR PG 76-22" AND FOR NON-POLYMERIZED HMA THE "AC TYPE" SHALL BE "PG 64-22" UNLESS MODIFIED BY DISTRICT ONE SPECIAL PROVISIONS. FOR "PERCENT OF RAP" SEE DISTRICT ONE SPECIAL PROVISIONS.

FOR USE OF RECYCLED MATERIALS SEE SPECIAL PROVISIONS.

CONTRACT NO. 11-00098-00-RS  
 DRAWN BY: KAR  
 CHECKED BY: JJF  
 DATE: 01-29-13  
 FILE: 110565-SHT-TypSec.sht  
 PROJECT: RIDGELAND AVENUE  
 COUNTY: COOK  
 DISTRICT: 1  
 SHEET NO.: 7  
 TOTAL SHEETS: 15  
 CONTRACT NO.: 63795



DESIGNED - TMS	REVISED -
DRAWN - KAR	REVISED -
CHECKED - JJF	REVISED -
DATE - 01-29-13	FILE - 110565-SHT-TypSec.sht

**STATE OF ILLINOIS**  
**DEPARTMENT OF TRANSPORTATION**

**TYPICAL SECTIONS AND  
HMA MIXTURE REQUIREMENTS**

SCALE: NONE

STA. TO STA.

F.A.M. RTE.	SECTION	COUNTY	TOTAL SHEETS	SHEET NO.
1019	11-00098-00-RS	COOK	15	7
CONTRACT NO. 63795				

FED. ROAD DIST. NO. ILLINOIS FED. AID PROJECT

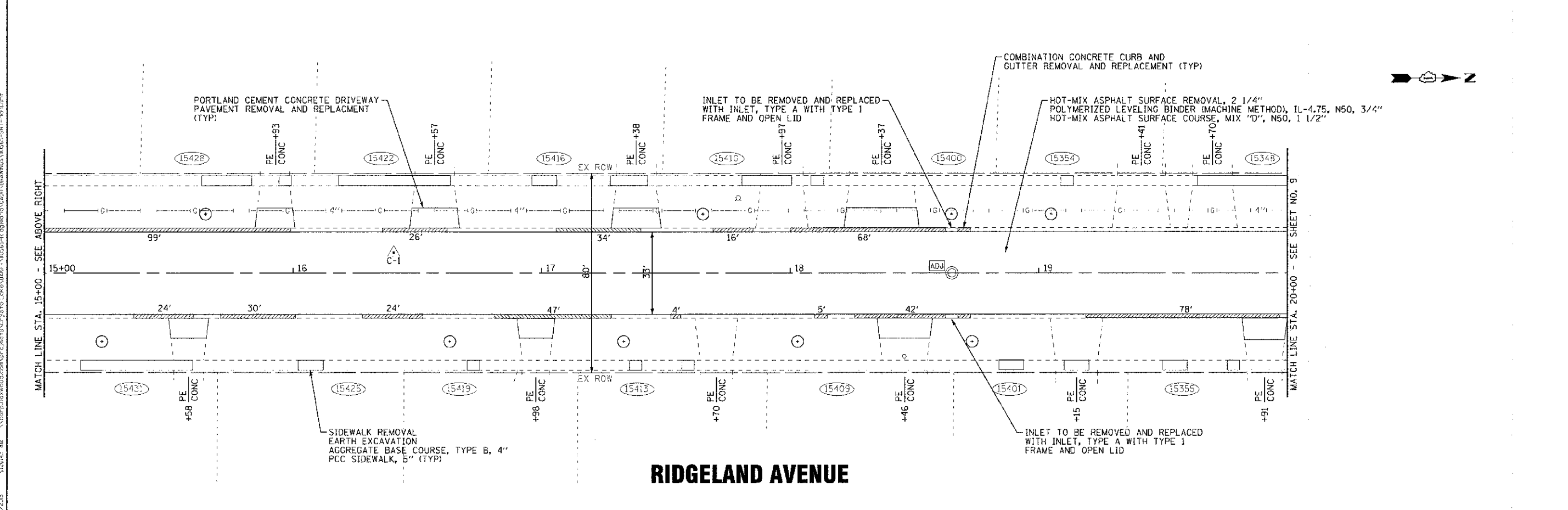
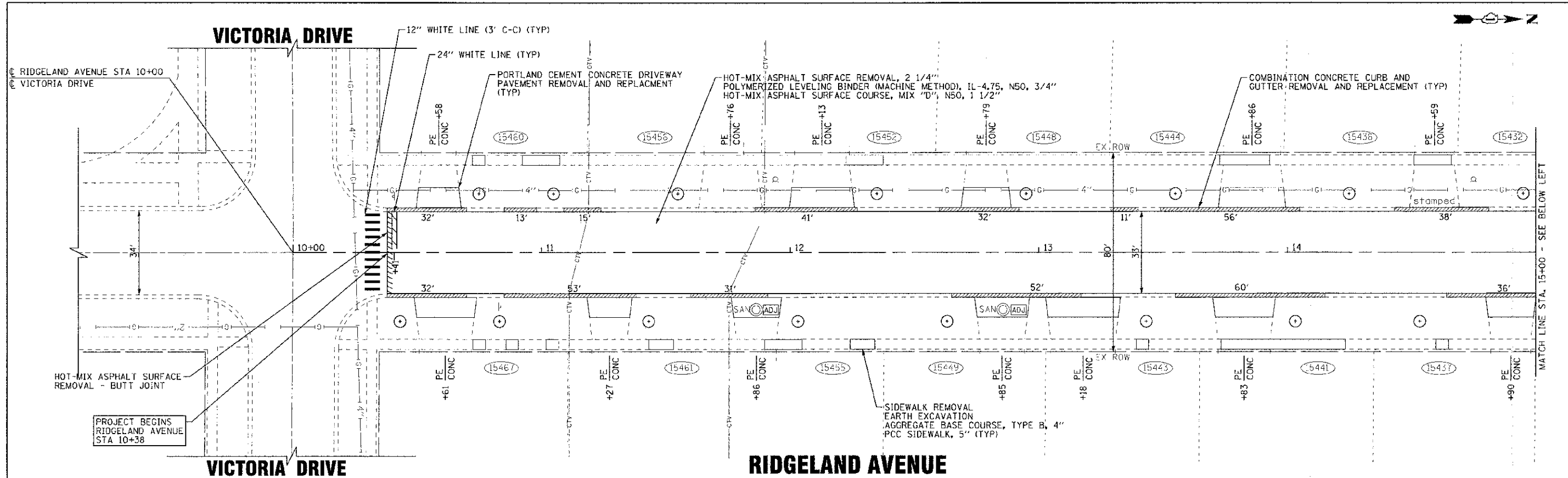

CONTRACT NO. 100 BY BAXTER & WOODRICK, INC.  
 STATE OF ILLINOIS PROFESSIONAL ENGINEERING  
 LICENSE NO. 184-00191 - EXPIRES 12/31/2011  
 2/2/2013



DESIGNED - TMS	REVISED -
DRAWN - KAR	REVISED -
CHECKED - JWF	REVISED -
DATE - 01-29-13	FILE - 110565-SHT-Plan1.sh1

**STATE OF ILLINOIS**  
**DEPARTMENT OF TRANSPORTATION**

**RIDGELAND AVENUE PLAN**  
 SCALE: 1" = 20'  
 STA. 10+00 TO STA. 20+00

F.A.U. RTE. 1019	SECTION 11-00098-00-RS	COUNTY COOK	TOTAL SHEETS 15	SHEET NO. 8
CONTRACT NO. 63795				
FED. ROAD DIST. NO. [ILLINOIS] FED. AID PROJECT				



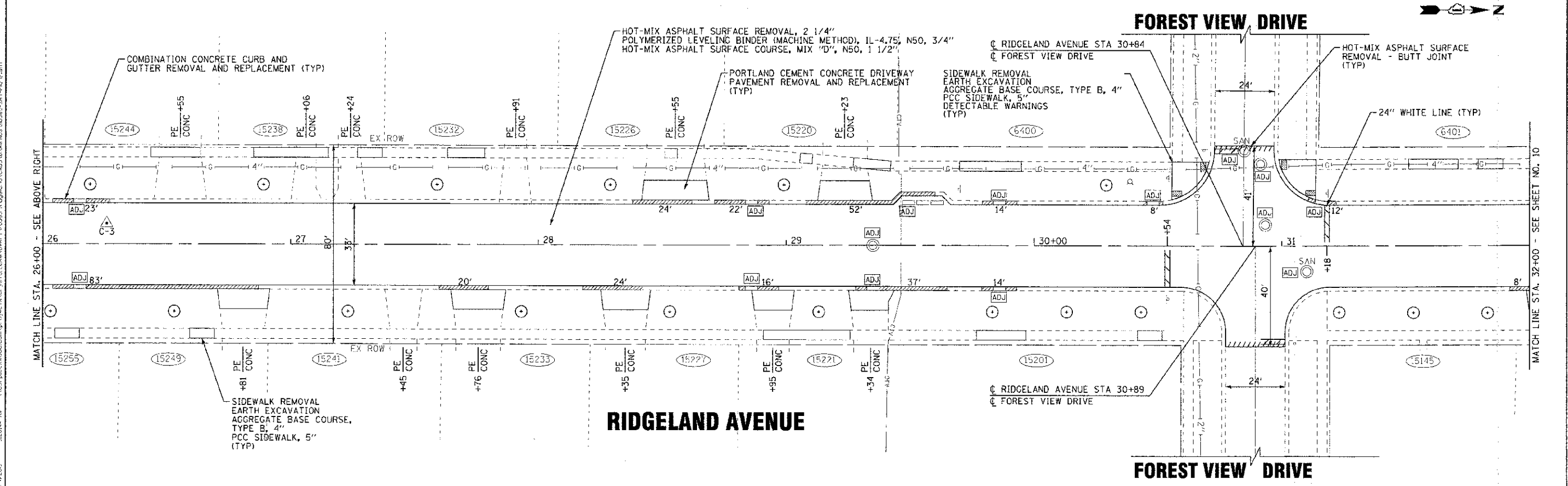
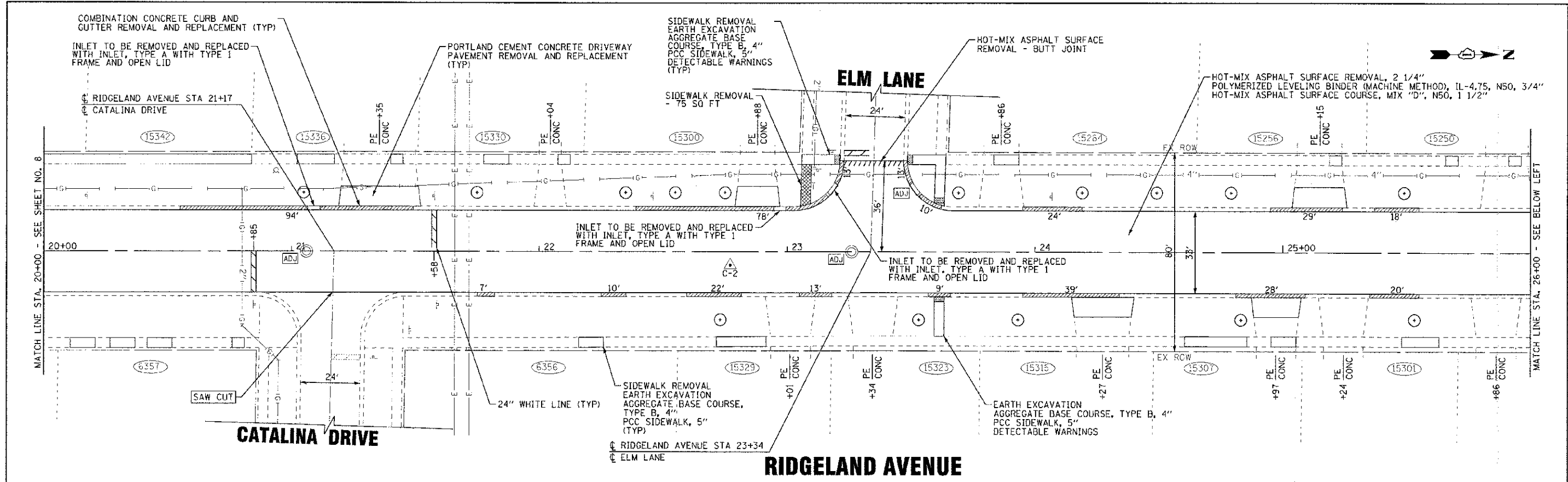

	DESIGNED - TMS	REVISED -	<b>STATE OF ILLINOIS</b> <b>DEPARTMENT OF TRANSPORTATION</b>	<b>RIDGELAND AVENUE PLAN</b>	F.A.U. R.T.E.	SECTION	COUNTY	TOTAL SHEETS	SHEET NO.
	DRAWN - KAR	REVISED -			1019	11-00098-00-RS	COOK	15	9
	CHECKED - JLF	REVISED -			CONTRACT NO. 63795				
	DATE - 01-29-13	FILE - 110565-SHT-Plan2.sht			FED. ROAD DIST. NO. ILLINOIS FED. AID PROJECT				

CONTRACT NO. 63795  
 STATE OF ILLINOIS  
 DEPARTMENT OF TRANSPORTATION  
 RIDGELAND AVENUE  
 CONTRACT NO. 63795  
 SHEET NO. 9  
 DATE: 01-29-13  
 FILE: 110565-SHT-Plan2.sht

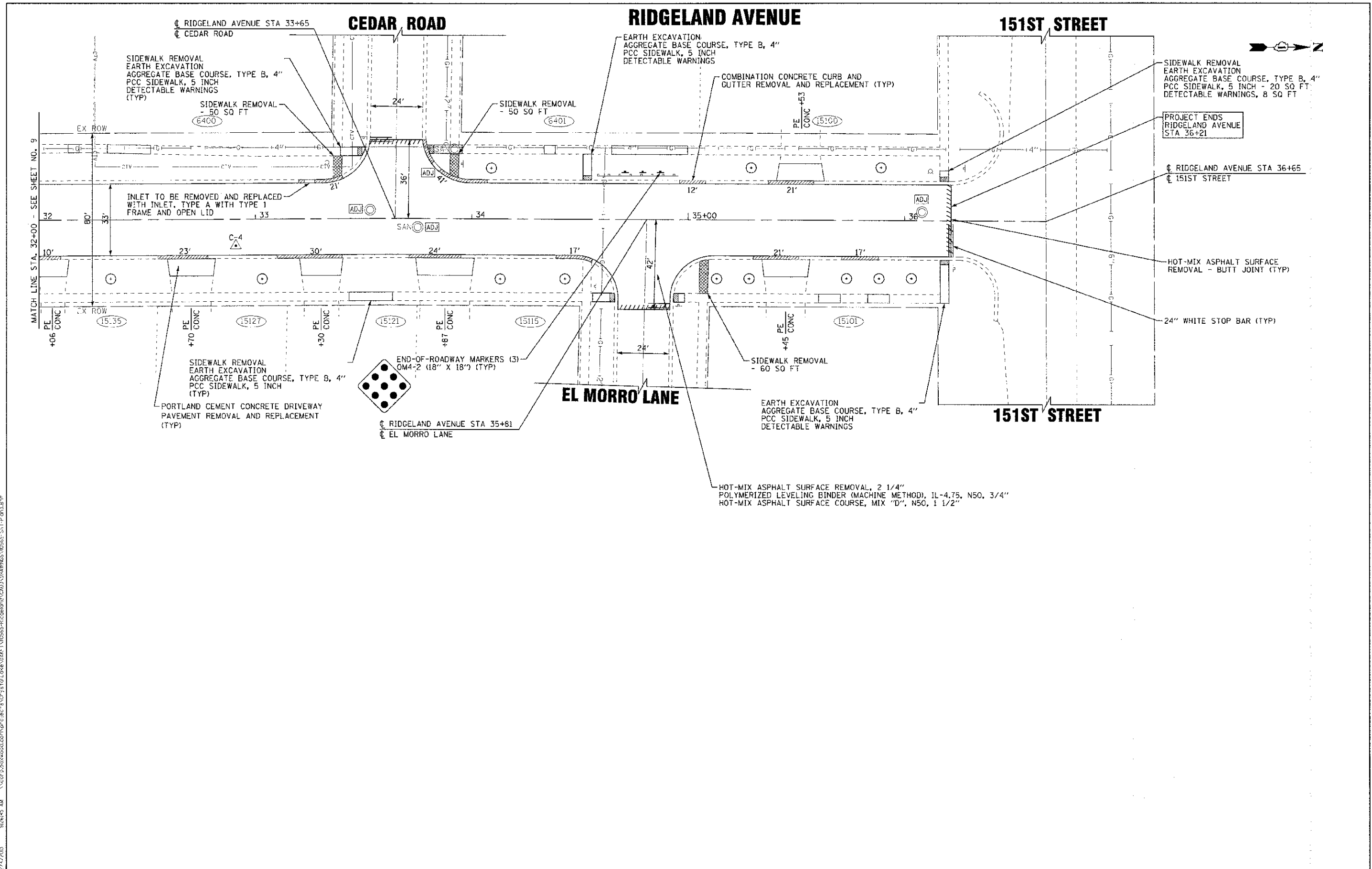

COPYRIGHT © 2012 BY BAXTER & WOODMAN, P.C.  
 STATE OF ILLINOIS - PROFESSIONAL DESIGN FIRM  
 LICENSE NO. 084-000011-00000000-00000000-00000000-00000000  
 2/2/2012 10:54:51 AM



DESIGNED - TMS	REVISED -
DRAWN - KAR	REVISED -
CHECKED - JUF	REVISED -
DATE 01-29-13	FILE 110565-SHT-Plan3.sht

**STATE OF ILLINOIS**  
**DEPARTMENT OF TRANSPORTATION**

**RIDGELAND AVENUE PLAN**  
 SCALE: 1" = 20'  
 STA. 32+00 TO STA. 36+65

P.A.U. RTE. 1019	SECTION 11-00098-00-RS	COUNTY COOK	TOTAL SHEETS 15	SHEET NO. 10
FED. ROAD DIST. NO. ILLINOIS/FED. AID PROJECT			CONTRACT NO. 63795	

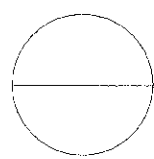
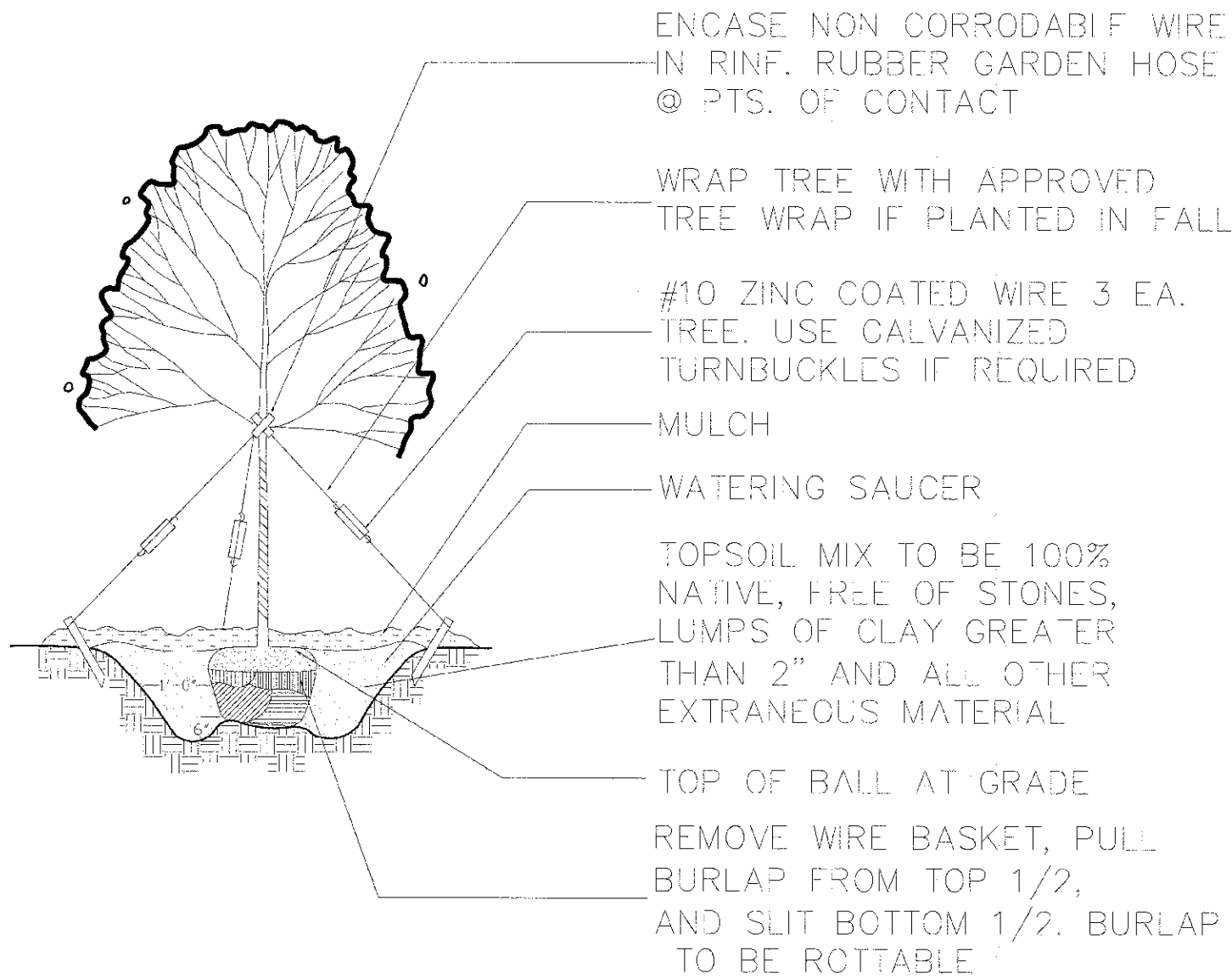

DECIDUOUS TREE

NOT TO SCALE

COPYRIGHT © 2003 BY BAXTER & WOODMAN, INC.  
 STATE OF ILLINOIS PROFESSIONAL DESIGNER  
 LICENSE NO. 18-00077, EXPIRES 4/30/2008  
 358603 Pa  
 I:\Projects\110565-SHT-Details.sht



DESIGNED - TMS	REVISED -
DRAWN - KAR	REVISED -
CHECKED - JJF	REVISED -
DATE - 01-29-13	FILE - 110565-SHT-Details.sht

STATE OF ILLINOIS  
DEPARTMENT OF TRANSPORTATION

MISCELLANEOUS DETAILS

SCALE: STA. TO STA.

F.A.J. RTE.	SECTION	COUNTY	TOTAL SHEETS	SHEET NO.
1019	11-0009R-00-RS	COOK	15	11
FED. ROAD DIST. NO.			ILLINOIS FED. AID PROJECT	
			CONTRACT NO. 63795	

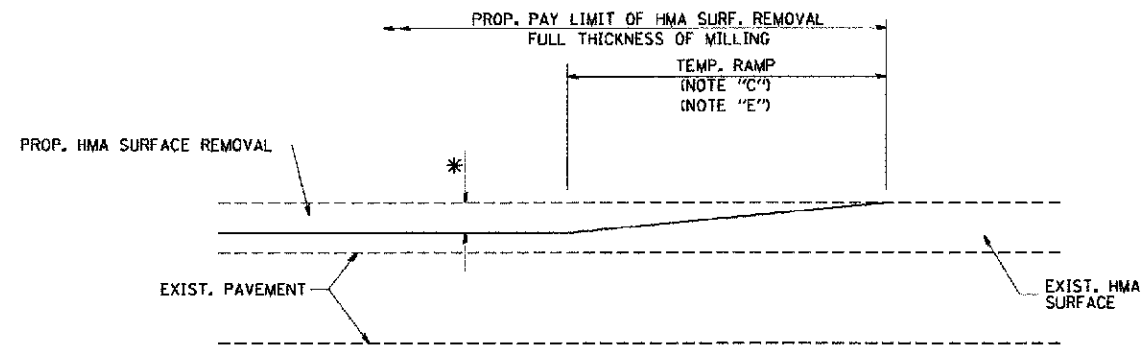

MILLED TEMPORARY RAMP  
(FOR BUTT JOINT AND HMA TAPER SEE DETAIL BELOW)

**OPTION 1**

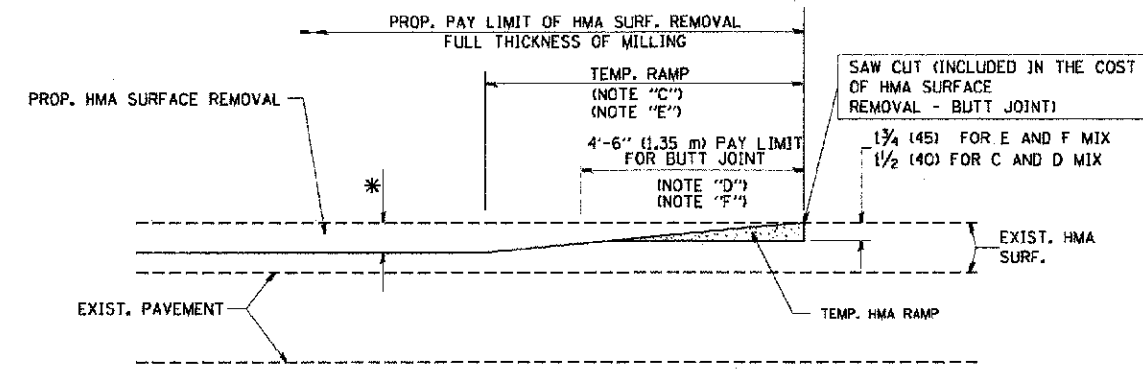

HMA CONSTRUCTED TEMPORARY RAMP  
(FOR BUTT JOINT AND HMA TAPER SEE DETAIL BELOW)

**OPTION 2**  
**TYPICAL TEMPORARY RAMP**

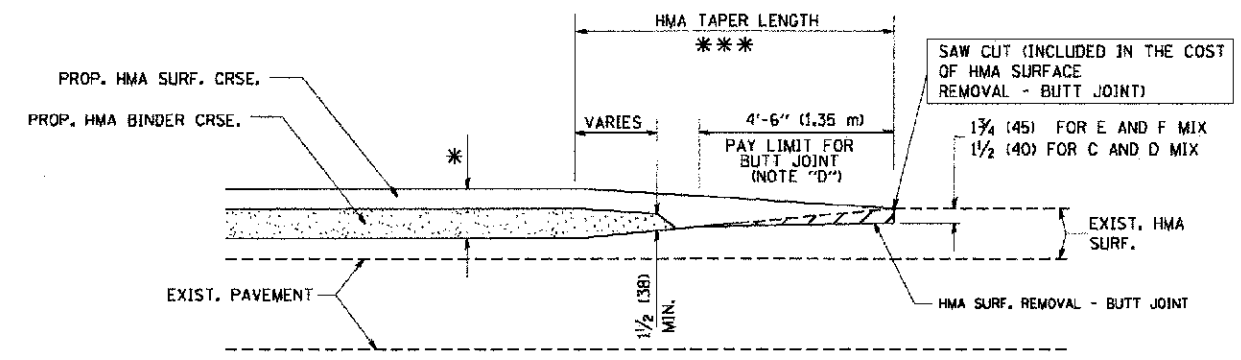

**BUTT JOINT AND HMA TAPER**  
**TYPICAL BUTT JOINT AND HMA TAPER FOR MILLING AND RESURFACING**

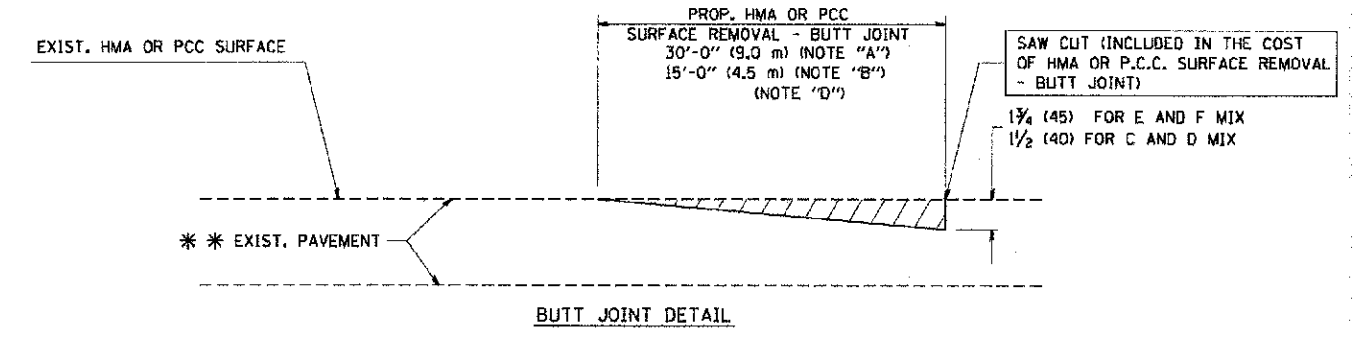

**BUTT JOINT DETAIL**

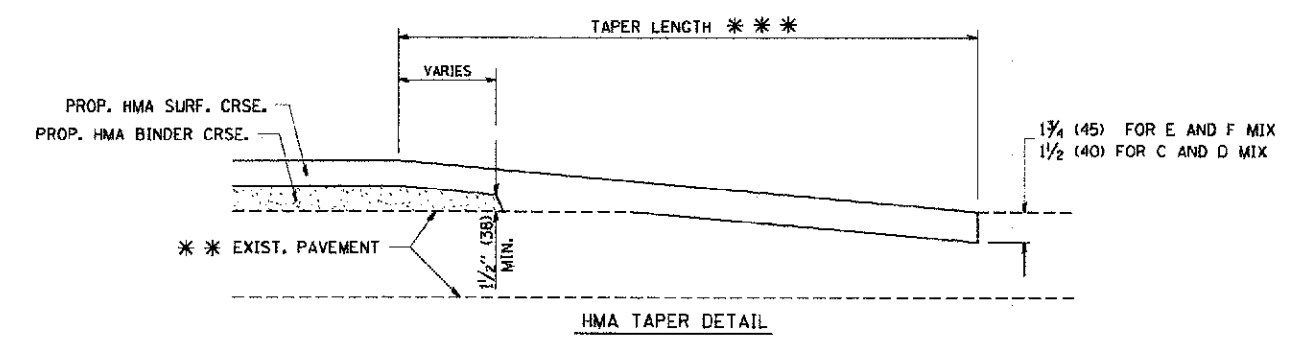

**HMA TAPER DETAIL**

**TYPICAL BUTT JOINT AND HMA TAPER FOR RESURFACING ONLY**

\*\*\* PC CONCRETE, HMA OR HMA RESURFACED PAVEMENT.

**NOTES**

- A: MAINLINE ROADWAYS AND MAJOR SIDE ROADS.
  - B: MINOR SIDE ROADS.
  - C: THE TEMP. RAMP SHALL BE CONSTRUCTED IMMEDIATELY UPON REMOVAL OF THE EXISTING HMA SURFACE.
  - D: THE BUTT JOINT SHALL BE CONSTRUCTED IMMEDIATELY PRIOR TO PLACING THE PROPOSED HMA COURSES.
  - E: TAPER THE TEMP. RAMP AT A RATE OF 3'-0" (900 mm) PER 1 INCH (25 mm) OF MILLING THICKNESS.
  - F: INSTALLATION AND REMOVAL OF THE 4'-6" (1.35 m) TEMP. RAMP IS INCLUDED IN COST OF HMA SURFACE REMOVAL - BUTT JOINT
  - G: SEE ARTICLE 406.08 AND 406.14 OF THE STANDARD SPECIFICATIONS FOR "HMA AND/OR PCC SURFACE REMOVAL, BUTT JOINT".
- \* SEE TYPICAL SECTIONS FOR MILLING THICKNESS.
- \*\*\* 20'-0" (6.1 m) PER 1 (25) RESURFACING (NOTE "A")  
10'-0" (3.0 m) PER 1 (25) RESURFACING (NOTE "B")

**BASIS OF PAYMENT:**

THE BUTT JOINT WILL BE PAID FOR AT THE CONTRACT UNIT PRICE PER SQUARE YARD (SQUARE METER) FOR "HOT-MIX ASPHALT SURFACE REMOVAL - BUTT JOINT" OR FOR "PORTLAND CEMENT CONCRETE SURFACE REMOVAL - BUTT JOINT".

ALL DIMENSIONS ARE IN INCHES (MILLIMETERS) UNLESS OTHERWISE SHOWN.

COPYRIGHT © 2011 BY BAXTER & WOODMAN, INC. ...  
 STATE OF ILLINOIS - PROFESSIONAL DESIGN FIRM  
 500 N. LAKE STREET, SUITE 200  
 DECATUR, IL 62521  
 618/281-1234

FILE NAME = W:\distant\22x34\bd32.dgn	USER NAME = ggg...robot	DESIGNED - M. DE YONG	REVISED - R. SHAH 10-25-94
PLOT SCALE = 5/8" = 1' IN.	CHECKED -	DRAWN -	REVISED - A. ABBAS 03-21-97
PLOT DATE = 1/4/2008	DATE = 06-13-90	CHECKED -	REVISED - M. GOMEZ 04-06-01
			REVISED - R. BORO 01-01-07

**STATE OF ILLINOIS**  
**DEPARTMENT OF TRANSPORTATION**

<b>BUTT JOINT AND HMA TAPER DETAILS</b>			
SCALE: NONE	SHEET NO. 1	OF 1 SHEETS	STA. TO STA.

F.A.I. RTE. 1019	SECTION 11-00098-00-RS	COUNTY COOK	TOTAL SHEETS 15	SHEET NO. 17
BD400-05 BD32		CONTRACT NO. 63795		
FED. ROAD DIST. NO. 1 ILLINOIS FED. AID PROJECT				

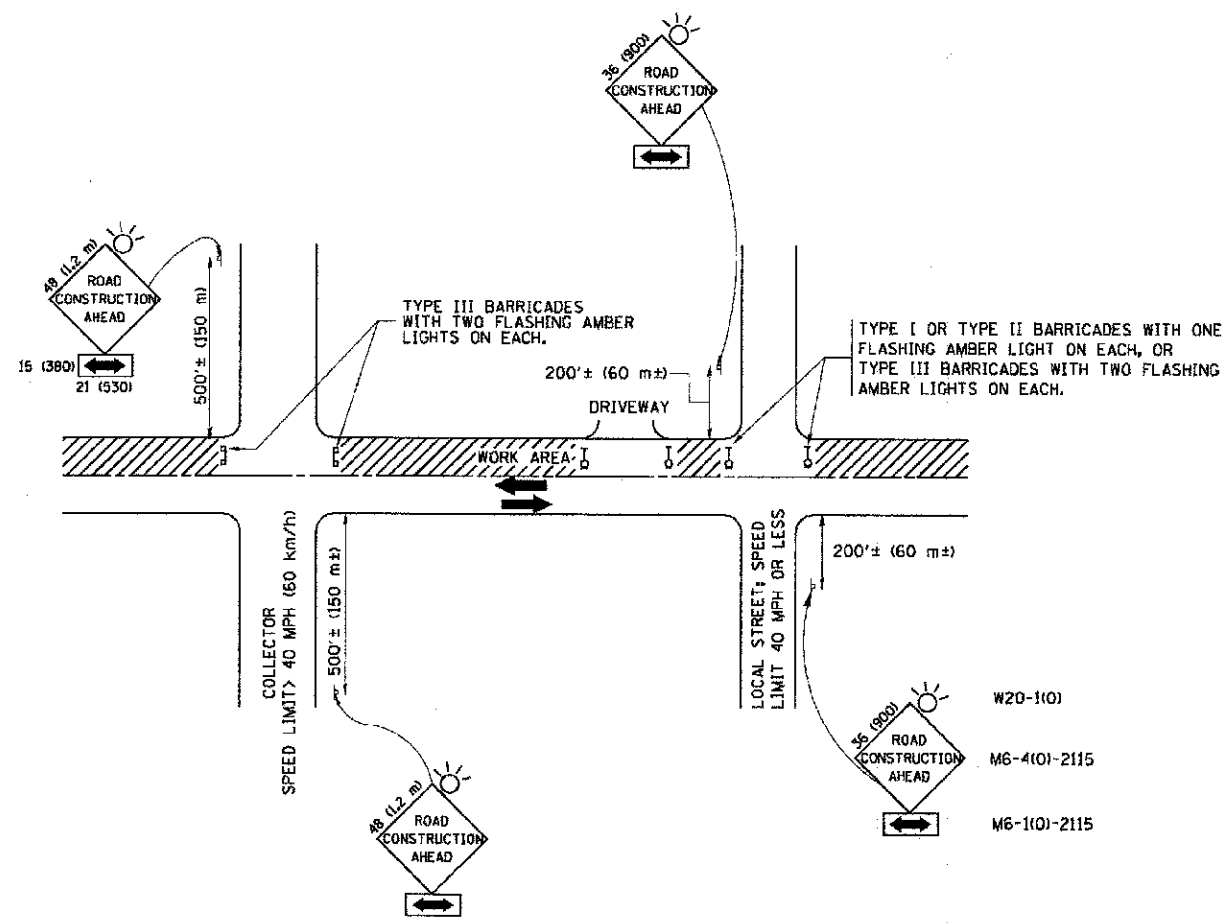

TRAFFIC CONTROL AND PROTECTION FOR SIDE ROADS, INTERSECTIONS, AND DRIVEWAYS

NOTES:

- A. FOR NO LANE RESTRICTION ON THE SIDE ROAD OR DRIVEWAYS
  - 1. SIDE ROAD WITH A SPEED LIMIT OF 40 MPH (60 km/h) OR LESS AS SHOWN ON THE DRAWING AND AS DIRECTED BY THE ENGINEER:
    - a) ONE ROAD CONSTRUCTION AHEAD SIGN 36 x 36 (900x900) WITH A FLASHER AND FLAG MOUNTED ON IT APPROXIMATELY 200' (60 m) IN ADVANCE OF THE MAIN ROUTE.
    - b) THE CLOSED PORTION OF THE MAIN ROUTE SHALL BE PROTECTED BY BLOCKING WITH TYPE I, TYPE II OR TYPE III BARRICADES, 1/3 OF THE CROSS SECTION OF THE CLOSED PORTION.
  - 2. SIDE ROAD WITH A SPEED LIMIT GREATER THAN 40 MPH (60 km/h) AS SHOWN ON THE DRAWING AND AS DIRECTED BY THE ENGINEER:
    - a) ONE ROAD CONSTRUCTION AHEAD SIGN 48 x 48 (1,2 m x 1,2 m) WITH A FLASHER MOUNTED ON IT APPROXIMATELY 500' (150 m) IN ADVANCE OF THE MAIN ROUTE.
    - b) THE CLOSED PORTION OF THE MAIN ROUTE SHALL BE PROTECTED BY BLOCKING WITH TYPE III BARRICADES, 1/2 OF THE CROSS SECTION OF THE CLOSED PORTION.
  - 3. WHEN THE SIDE ROAD LIES BETWEEN THE BEGINNING OF THE MAINLINE SIGNING AND THE WORK ZONE, A SINGLE HEADED ARROW (M6-1) SHALL BE USED IN LIEU OF THE DOUBLE HEADED ARROW (M6-4).
- B. FOR A LANE CLOSURE ON A SIDE ROAD OR DRIVEWAY:
  - USE APPLICABLE PORTIONS OF THE TYPICAL APPLICATION OF TRAFFIC CONTROL DEVICES (STD. 701601, STD. 701606 OR THE APPROPRIATE STANDARD). THE SPACING OF SIGNS AND BARRICADES SHALL BE ADJUSTED FOR FIELD CONDITIONS AS DIRECTED BY THE ENGINEER. THE DIRECTIONAL ARROW SHALL BE COVERED OR REMOVED WHEN NO LONGER CONSISTENT WITH THE SIDE ROAD LANE CLOSURE.
- C. ADVANCE WARNING SIGNS ARE TO BE OMITTED ON DRIVEWAY UNLESS OTHERWISE NOTED.
- D. THE TRAFFIC CONTROL AND PROTECTION FOR SIDE ROADS, INTERSECTIONS, AND DRIVEWAYS SHALL BE INCIDENTAL TO THE COST OF SPECIFIED TRAFFIC CONTROL STANDARDS OR ITEMS.

All dimensions are in millimeters (inches) unless otherwise shown.

CONTROL BY: BARTER & WICHMAN, INC.  
 STATE OF ILLINOIS - PROFESSIONAL DESIGN FIRM  
 LICENSE NO. - BR-00021 - EXPIRES 4/20/2013  
 ADDRESS: 1000 N. WASHINGTON ST., SUITE 100, CHICAGO, IL 60610  
 TEL: 312.467.1000 FAX: 312.467.1001  
 WWW: WWW.BARTERANDWICHMAN.COM

FILE NAME =	USER NAME = goglionabt	DESIGNED - LHA	REVISED - J. OBERLE 10-18-95
#\data\22x34\1018.dgn		DRAWN -	REVISED - A. HOUSEH 03-06-96
	PLT SCALE = 50,000 / 1 IN.	CHECKED -	REVISED - A. HOUSEH 10-15-96
	PLT DATE = 1/4/2008	DATE - 06-09	REVISED - T. RAMNACHER 01-06-00

STATE OF ILLINOIS  
DEPARTMENT OF TRANSPORTATION

TRAFFIC CONTROL AND PROTECTION FOR  
SIDE ROADS, INTERSECTIONS, AND DRIVEWAYS  
SCALE: NONE SHEET NO. 1 OF 1 SHEETS STA. TO STA.

F.A.U. R.T.E.	SECTION	COUNTY	TOTAL SHEETS	SHEET NO.
1019	11-00098-00-R5	COOK	15	13
TC-10			CONTRACT NO. 63795	
FED. ROAD DIST. NO. 1 (ILLINOIS) FED. AID PROJECT				

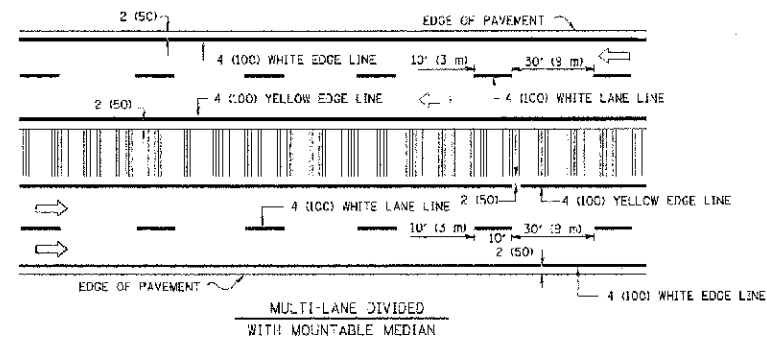
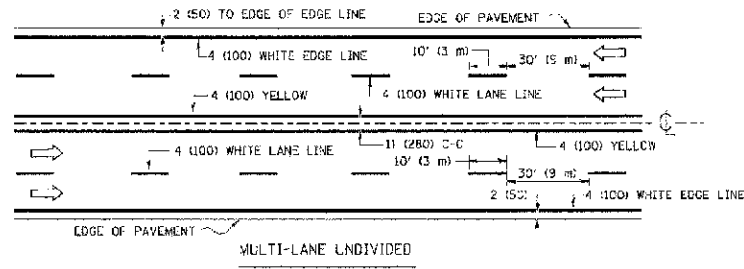
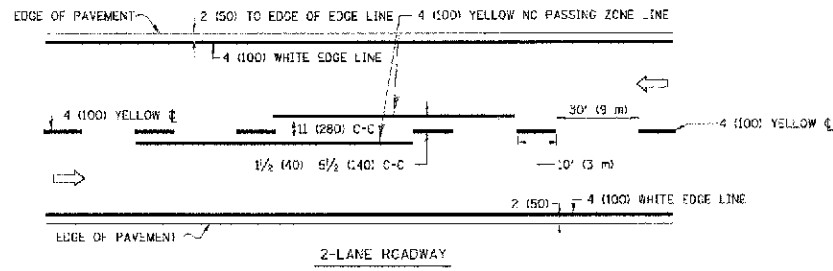

NOTE: MEDIANS WITH BARRIER CURB DO NOT REQUIRE AN EDGE LINE

TYPICAL LANE AND EDGE LINE MARKING

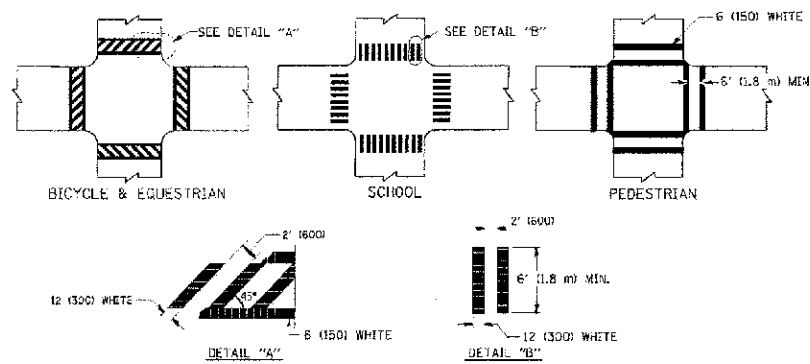

TYPICAL CROSSWALK MARKING

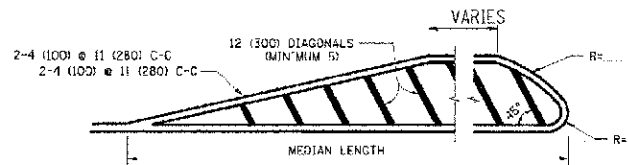
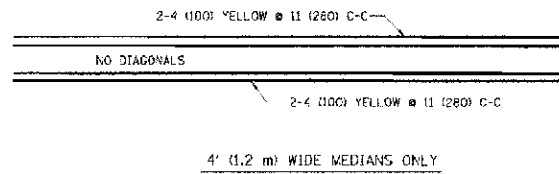

FOR MEDIAN LENGTHS WHERE DIAGONAL SPACING CANNOT BE ATTAINED, USE 5 (FIVE) EQUALLY SPACED DIAGONAL LINES.  
DIAGONAL LINE SPACING: 50' (15 m) C-C (LESS THAN 30MPH (50 km/h))  
75' (25 m) C-C 30MPH (50 km/h) TO 45MPH (70 km/h)  
150' (45 m) C-C (MORE THAN 45MPH (70 km/h))

MEDIANS OVER 4' (1.2 m) WIDE

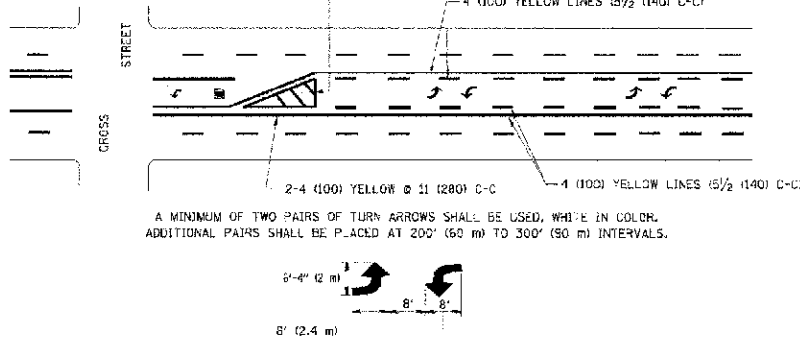

A MINIMUM OF TWO PAIRS OF TURN ARROWS SHALL BE USED, WHITE IN COLOR. ADDITIONAL PAIRS SHALL BE PLACED AT 200' (60 m) TO 300' (90 m) INTERVALS.

MEDIAN WITH TWO-WAY LEFT TURN LANE

TYPICAL PAINTED MEDIAN MARKING

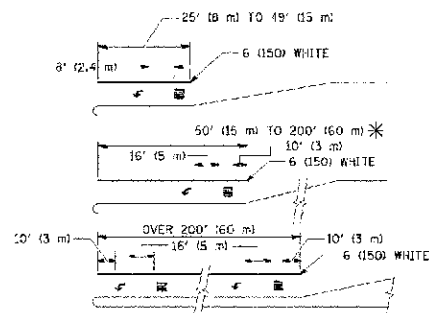

FULL SIZE LETTERS 8' (2.4 m) AND ARROWS SHALL BE USED.  
AREA = 15.6 SQ. FT. (1.5 m<sup>2</sup>) ONLY AREA = 20.8 SQ. FT. (1.9 m<sup>2</sup>)

\* TURN LANES IN EXCESS OF 400' (120 m) IN LENGTH MAY HAVE AN ADDITIONAL SET OF ARROW - "ONLY" INSTALLED MIDWAY BETWEEN THE OTHER TWO SETS OF ARROW - "ONLY".

TYPICAL LEFT (OR RIGHT) TURN LANE

TYPICAL TURN LANE MARKING

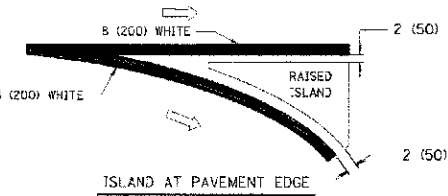
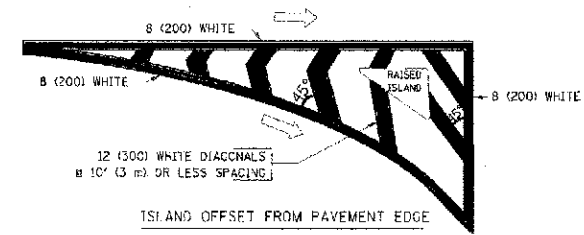

TYPICAL ISLAND MARKING

TYPE OF MARKING	WIDTH OF LINE	PATTERN	COLOR	SPACING / REMARKS
CENTERLINE ON 2 LANE PAVEMENT	4 (100)	SKIP-DASH	YELLOW	10' (3 m) LINE WITH 30' (9 m) SPACE
CENTERLINE ON MULTI-LANE UNDIVIDED PAVEMENT	2 @ 4 (100)	SOLID	YELLOW	11 (280) C-C
NO PASSING ZONE LINES FOR ONE DIRECTION FOR BOTH DIRECTIONS	4 (100); 2 @ 4 (100)	SOLID SOLID	YELLOW YELLOW	5/2 (140) C-C FROM SKIP-DASH CENTERLINE. OMIT SKIP-DASH CENTERLINE BETWEEN.
LANE LINES	4 (100); 5 (125) ON FREEWAYS	SKIP-DASH SKIP-DASH	WHITE WHITE	10' (3 m) LINE WITH 30' (9 m) SPACE
DOTTED LINES (EXTENSIONS OF CENTER, LANE OR TURN LANE MARKINGS)	SAME AS LINE BEING EXTENDED	SKIP-DASH	SAME AS LINE BEING EXTENDED	2' (600) LINE WITH 6' (1.8 m) SPACE
EDGE LINES	4 (100)	SOLID	YELLOW-LEFT WHITE-RIGHT*	OUTLINE MOUNTABLE MEDIANS IN YELLOW. EDGE LINES ARE NOT USED NEXT TO BARRIER CURB
TURN LANE MARKINGS	6 (150) LINE; FULL SIZE LETTERS & SYMBOLS 8' (2.4m)	SOLID	WHITE	SEE TYPICAL TURN LANE MARKING DETAIL
TWO WAY LEFT TURN MARKING	2 @ 4 (100) EACH DIRECTION 8' (2.4m) LEFT ARROW	SKIP-DASH AND SOLID IN PAIRS	YELLOW WHITE	10' (3 m) LINE WITH 30' (9 m) SPACE FOR SKIP-DASH 5/2 (140) C-C BETWEEN SOLID LINE AND SKIP-DASH LINE SEE TYPICAL TWO-WAY LEFT TURN MARKING DETAIL
CROSSWALK LINES (PEDESTRIAN) A. DIAGONALS (BIKE & EQUESTRIAN) B. LONGITUDINAL BARS (SCHOOL)	2 @ 6 (150) 12 (300) @ 45° 12 (300) @ 90°	SOLID SOLID SOLID	WHITE WHITE WHITE	NOT LESS THAN 6' (1.8 m) APART 2' (600) APART SEE TYPICAL CROSSWALK MARKING DETAILS.
STOP LINES	24 (600)	SOLID	WHITE	PLACE 4' (1.2 m) IN ADVANCE OF AND PARALLEL TO CROSSWALK, IF PRESENT. OTHERWISE, PLACE AT DESIRED STOPPING POINT, PARALLEL TO CROSSROAD CENTERLINE, WHERE POSSIBLE
PAINTED MEDIANS	2 @ 4 (100) WITH 12 (300) DIAGONALS @ 45° NO DIAGONALS USED FOR 4' (1.2 m) WIDE MEDIANS	SOLID	YELLOW; TWO WAY TRAFFIC WHITE; ONE WAY TRAFFIC	11 (280) C-C FOR THE DOUBLE LINE SEE TYPICAL PAINTED MEDIAN MARKING.
GORE MARKING AND CHANNELIZING LINES	8 (200) WITH 12 (300) DIAGONALS @ 45°	SOLID	WHITE	DIAGONALS: 15' (4.5 m) C-C (LESS THAN 30MPH (50 km/h)) 20' (6 m) C-C 30MPH (50 km/h) TO 45MPH (70 km/h) 30' (9 m) C-C (OVER 45MPH (70 km/h))
RAILROAD CROSSING	24 (600) TRANSVERSE LINES; "RR" 15 6' (1.8 m) LETTERS; 16 (400) LINE FOR "X"	SOLID	WHITE	SEE STATE STANDARD 780001 AREA OF: "R"=3.6 SQ. FT. (0.33 m <sup>2</sup> ) EACH "X"=54.0 SQ. FT. (5.0 m <sup>2</sup> )
SHOULDER DIAGONALS	12 (300) @ 45°	SOLID	WHITE - RIGHT YELLOW - LEFT	50' (15 m) C-C (LESS THAN 30MPH (50 km/h)) 75' (25 m) C-C (30 MPH (50 km/h) TO 45MPH (70 km/h)) 150' (45 m) C-C (OVER 45MPH (70 km/h))

FOR FURTHER DETAILS ON PAVEMENT MARKING REFER TO STANDARD SPECIFICATIONS FOR ROAD AND BRIDGE CONSTRUCTION AND STATE STANDARD 780001.

All dimensions are in inches (m)/meters unless otherwise shown.

CONTRACT © 2001 BY BAXTER & WOODMAN, INC.  
 ALL RIGHTS RESERVED. THIS DRAWING IS THE PROPERTY OF BAXTER & WOODMAN, INC. AND IS NOT TO BE REPRODUCED OR TRANSMITTED IN ANY FORM OR BY ANY MEANS, ELECTRONIC OR MECHANICAL, WITHOUT PERMISSION IN WRITING FROM BAXTER & WOODMAN, INC.  
 LICENSE NO. 08-200217, EXPIRES 4/30/2015  
 1107 WEST LAKE DRIVE, SUITE 100, DEERFIELD, IL 60015  
 708.439.7200

DESIGNED - EVERS	REVISION - T. RAMMACHER 10-27-94
DRAWN	REVISION - C. JUCIUS 09-09-09
CHECKED -	REVISION -
DATE 03-19-90	REVISION -

STATE OF ILLINOIS  
DEPARTMENT OF TRANSPORTATION

DISTRICT ONE  
TYPICAL PAVEMENT MARKINGS

F.A.U. SECTION	COUNTY	TOTAL SHEETS	SHEET NO.
1019 11-00098-00-R5	COOK	15	14
TC-13		CONTRACT NO. 63795	
FED. ROAD DIST. NO. 1 ILLINOIS FED. AID PROJECT			

SCALE: NONE SHEET NO. 1 OF 1 SHEETS STA. TO STA.

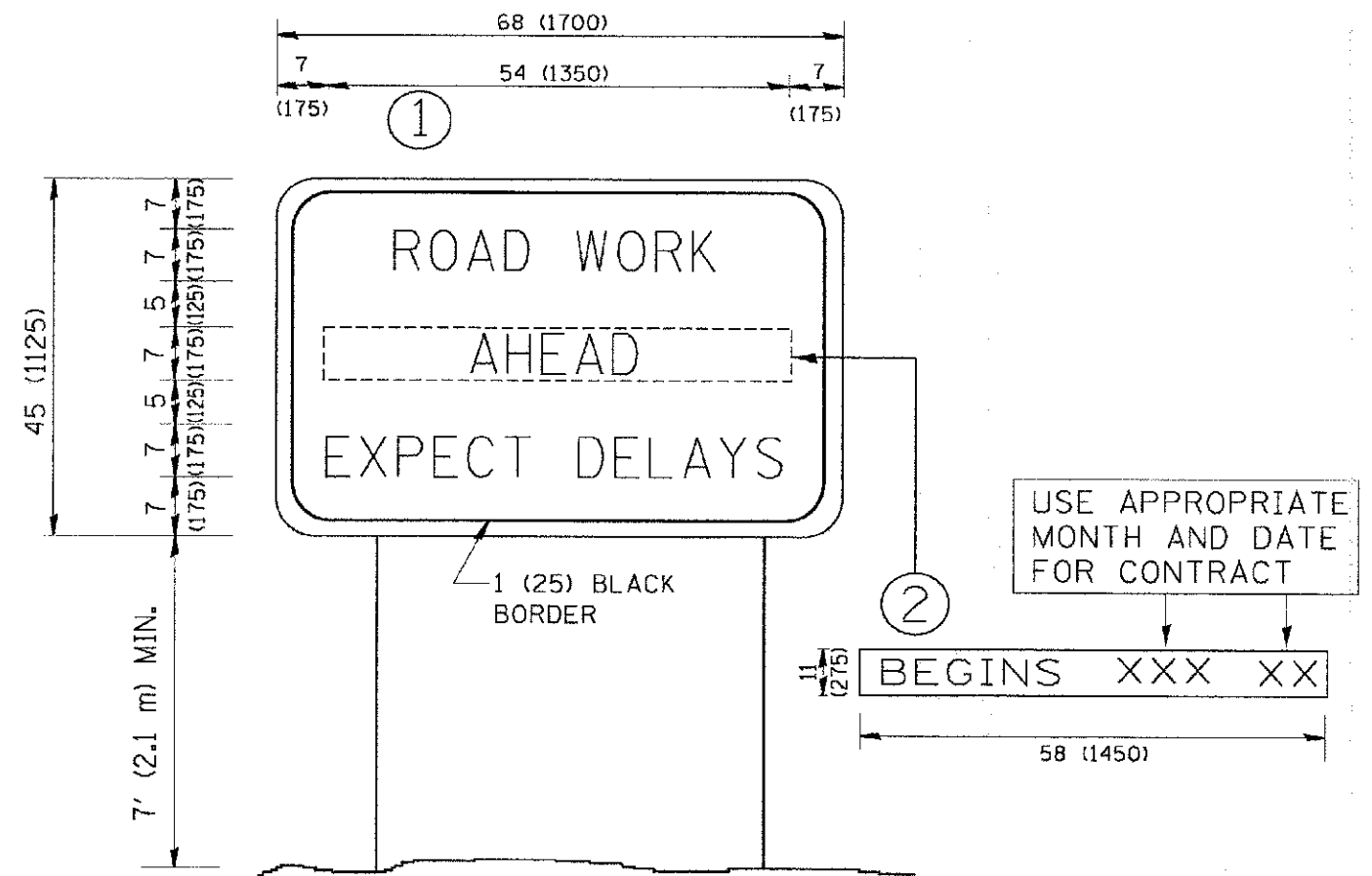

**NOTES:**

1. USE BLACK LETTERING ON ORANGE BACKGROUND.
2. ERECT SIGNS IN ADVANCE OF THE LOCATION FOR THE "ROAD CONSTRUCTION AHEAD" SIGN AT LOCATIONS AS DIRECTED BY THE ENGINEER.
3. ERECT SIGN ① WITH INSTALLED PANEL ② ONE WEEK PRIOR TO THE START OF CONSTRUCTION.
4. REMOVE PANEL ② SOON AFTER THE START OF CONSTRUCTION.
5. SEE SPECIAL PROVISION FOR "TEMPORARY INFORMATION SIGNING" FOR ADDITIONAL INFORMATION.
6. ONE SIGN ASSEMBLY EQUALS 25.70 SQ. FT. (2.3 SQ. M.)
7. SHALL BE PAID FOR AS TEMPORARY INFORMATION SIGNING.

ALL DIMENSIONS ARE IN INCHES (MILLIMETERS) UNLESS OTHERWISE SHOWN.

PROJECT # 2011 BY BAXTER & WOODMAN, INC. ... \projects\2011\2011-09-15\2011-09-15.dwg  
 USER: gregg...  
 PLOT SCALE: 1/4" = 1'-0"  
 PLOT DATE: 1/4/2008

FILE NAME = #distateh\22x34\to22.dgn	USER NAME = gregg	DESIGNED -	REVISED - R. MIRS 09-15-97	<b>STATE OF ILLINOIS DEPARTMENT OF TRANSPORTATION</b>	<b>ARTERIAL ROAD INFORMATION SIGN</b>			F.A.U. RTE. 1019	SECTION 11-00096-CO-RS	COUNTY COOK	TOTAL SHEETS 15	SHEET NO. 15
	PLOT SCALE = 08.000 1/4 IN.	DRAWN -	REVISED - R. MIRS 12-11-97		SCALE: NONE	SHEET NO. 1 OF 1 SHEETS	STA.	TO STA.	<b>TC-22</b>		<b>CONTRACT NO. 63795</b>	
	PLOT DATE = 1/4/2008	CHECKED -	REVISED - T. RAMMACHER 02-02-99		FED. ROAD DIST. NO. 1 ILLINOIS FED. AID PROJECT							
		DATE -	REVISED - C. JACIUS 01-31-07									