

STATE OF ILLINOIS
DEPARTMENT OF TRANSPORTATION
DIVISION OF HIGHWAYS

**PLANS FOR PROPOSED
FEDERAL AID HIGHWAY**

F. A. I. E. NO.	SECTION	COUNTY	TOTAL SHEETS	SHEET NO.
1066	13-00063-00-RS	COOK	10	1
STA. 10+00		TO STA. 124+00		
FED. ROAD DIST. NO.		ILLINOIS	FED. AID PROJECT M-4003(115)	

CONTRACT #63801

INDEX OF SHEETS

1. COVER SHEET
2. SUMMARY OF QUANTITIES & GENERAL NOTES
3. TYPICAL CROSS SECTIONS
- 4.-5. PAVEMENT PLAN
- 6.-7. STRIPING PLAN
- 8.-10. IDOT CONSTRUCTION DETAILS

HIGHWAY STANDARDS

- | | |
|-----------|--|
| 000001-06 | STANDARD SYMBOLS, ABBREVIATIONS AND PATTERNS |
| 424001-07 | PERPENDICULAR CURB RAMPS |
| 424011-01 | CORNER PARALLEL CURB RAMPS |
| 424016-01 | MID BLOCK CURB RAMPS |
| 424021-01 | DEPRESSED CORNER |
| 442201-03 | CLASS C AND D PATCHES |
| 606001-05 | CONCRETE CURB TYPE B AND COMBINATION CONCRETE CURB AND GUTTER |
| 701501-06 | URBAN LANE CLOSURE, 2L, 2W, UNDIVIDED |
| 701801-05 | LANE CLOSURE, MULTILANE 1W OR 2W CROSSWALK OR SIDEWALK CLOSURE |
| 701901-02 | TRAFFIC CONTROL DEVICES |
| 720001-01 | SIGN PANEL MOUNTING DETAILS |
| 720006-03 | SIGN PANEL ERECTION DETAILS |
| 729001-01 | APPLICATIONS OF TYPE A & B METAL POSTS (FOR SIGNS & MARKERS) |
| 780001-03 | TYPICAL PAVEMENT MARKINGS |

**FAU 1066 (DEPOT AVENUE & 110TH STREET)
FAU 1581 (111TH STREET) TO FAU 2955 (OAK PARK AVENUE)
RESURFACING
PROJECT NO.: M-4003 (115)
SECTION NO.: 13-00063-00-RS
VILLAGE of WORTH
COOK COUNTY
JOB NO.:C-91-115-13**

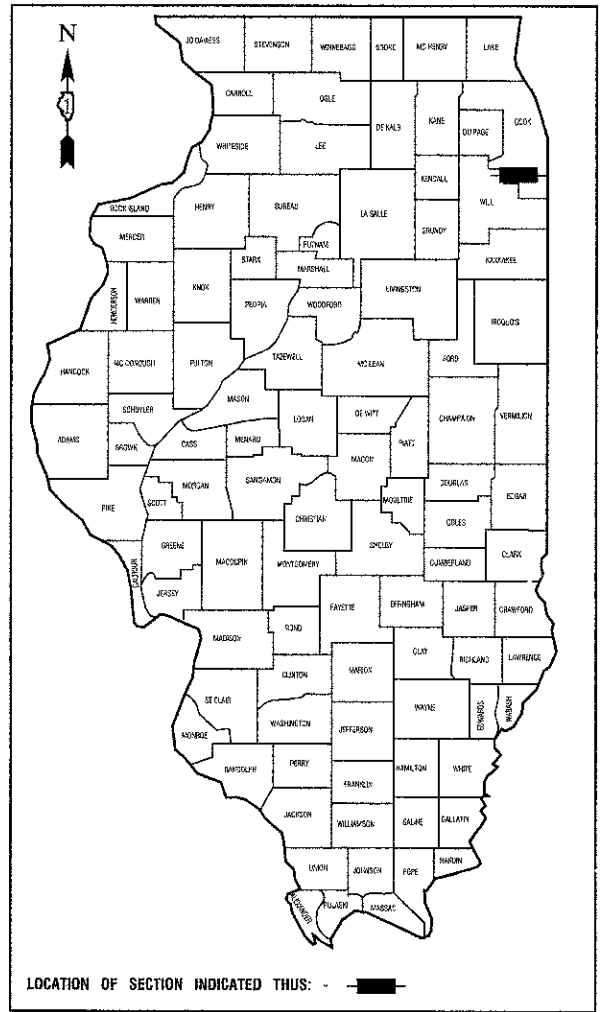

DEPOT AVENUE / 110TH STREET

2010 ADT -	3,100
2030 ADT -	3,100
POSTED SPEED LIMIT -	25 mph
DESIGN SPEED LIMIT -	25 mph
STREET CLASSIFICATION -	URBAN COLLECTOR

SCALES

PLAN -	1"=50'
PROFILE HORIZ. -	1"=50'
PROFILE VERT. -	1"=5'
CROSS SECTIONS -	1"=10'

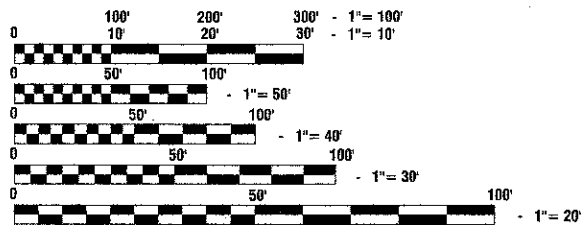

FULL SIZE PLANS HAVE BEEN PREPARED USING STANDARD ENGINEERING SCALES, REDUCED SIZED PLANS WILL NOT CONFORM TO STANDARD SCALES, IN MAKING MEASUREMENTS ON REDUCED PLANS, THE ABOVE SCALES MAY BE USED.

J. U. L. I. E.
JOINT UTILITY LOCATION INFORMATION FOR EXCAVATION
1-800-892-0123 or 811

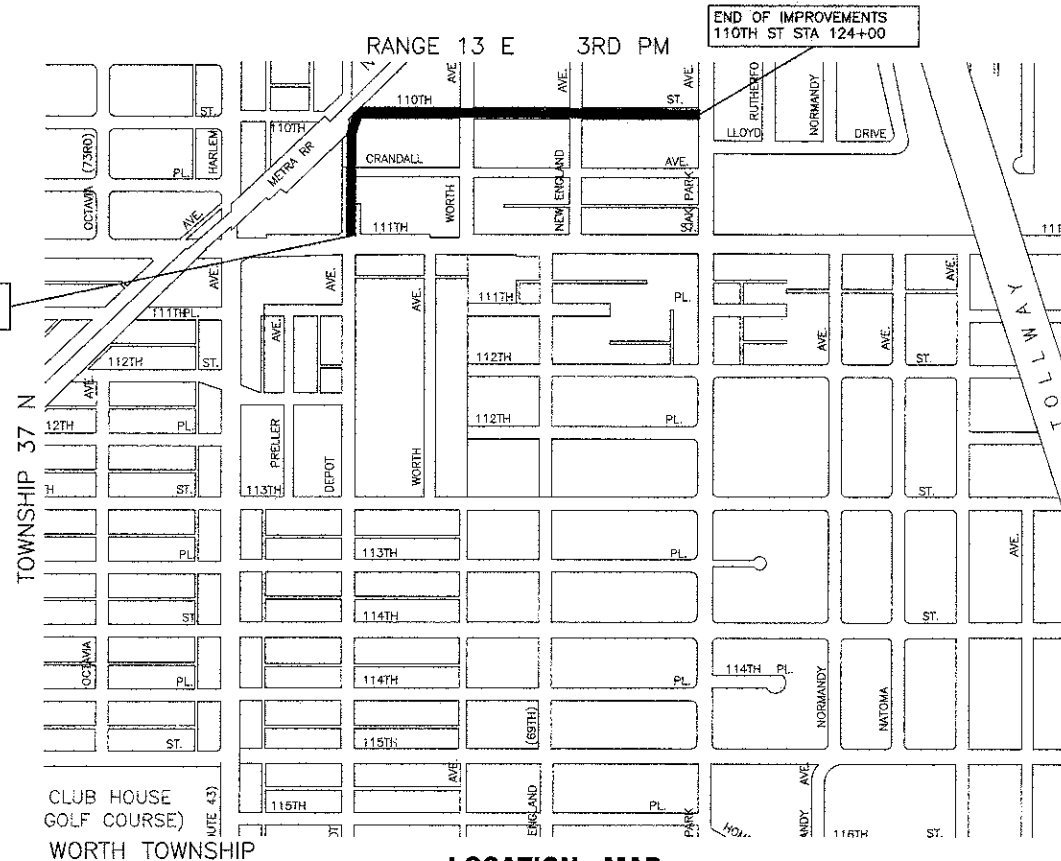

GROSS LENGTH=2,380 FEET=0.45 MILES
NET LENGTH=2,380 FEET=0.45 MILES

PROGRAM AND OFFICE ENGINEER: CHARLES F. RIDDLE, P.E. (847)-705-4406, SCHAUMBURG, IL
CONSULTANTS: ROBINSON ENGINEERING, LTD. 708-331-6700

CONTRACT NO. 63801

STATE OF ILLINOIS DEPARTMENT OF TRANSPORTATION
DIVISION OF HIGHWAYS

Approved: Randy Kalka 1-31-13
President, Village of Worth

Passed: FEBRUARY 28, 2013
C. J. Holt
District 1 Engineer of Local Roads & Streets

Released for Bid Based on Limited Review: February 27, 2013
John Fortman
Deputy Director of Highways, Region 1 Engineer

PRINTED BY THE AUTHORITY OF THE STATE OF ILLINOIS

PREPARED BY OR UNDER THE DIRECT SUPERVISION OF:
Michael Spolar
2/1/2013

LICENSE EXPIRES: 11/30/13

GENERAL NOTES

1. BEFORE STARTING ANY EXCAVATION THE CONTRACTOR SHALL CALL "J.U.L.I.E." AT (800) 892-0123 OR 811 AND (312) 744-7000 FOR FIELD LOCATIONS OF BURIED ELECTRIC, TELEPHONE AND GAS UTILITIES. (48 HOUR NOTIFICATION REQUIRED)
2. UTILITIES INDICATED ON THE PLANS ARE PROVIDED FOR THE CONTRACTOR'S USE AND ARE BASED UPON INFORMATION AVAILABLE AT THE TIME OF THE ADVERTISEMENT FOR BIDS. THE OWNER AND ENGINEER DO NOT GUARANTEE THE ACCURACY OF UTILITY INFORMATION.
3. IT SHALL BE THE CONTRACTOR'S RESPONSIBILITY TO VERIFY ALL DIMENSIONS AND CONDITIONS EXISTING IN THE FIELD PRIOR TO CONSTRUCTION AND ORDERING OF MATERIALS.
4. THE THICKNESS OF HMA MIXTURE STATED IN THE SPECIFICATIONS IS THE NOMINAL THICKNESS. DEVIATIONS FROM THE NOMINAL THICKNESS WILL BE PERMITTED WHEN SUCH DEVIATIONS OCCUR DUE TO IRREGULARITIES IN THE EXISTING SURFACE OR BASE ON WHICH THE HMA SURFACE IS PLACED.
5. ACCESS TO DRIVEWAYS SHALL BE MAINTAINED AT ALL TIMES BY LIMITING CURB AND GUTTER REPAIR TO ONE-HALF THE DRIVEWAY WIDTH AT ONE TIME AS WELL AS TEMPORARY AGGREGATE. ANY TEMPORARY AGGREGATE REQUIRED SHALL BE CONSIDERED INCIDENTAL TO THE RELATED PAY ITEM IT IS NEEDED FOR WHEN DIRECTED BY THE ENGINEER.
6. THE REMOVAL AND/OR REPLACEMENT OF ANY DRIVEWAYS, PAVEMENT, CURB, SIDEWALK, ETC. SHALL BE ACCOMPLISHED BY MEANS OF A SAW CUT JOINT, AT THE DIRECTION OF THE ENGINEER. THIS WORK WILL NOT BE PAID FOR SEPARATELY, BUT SHALL BE INCLUDED IN THE UNIT PRICE FOR THE VARIOUS ITEMS.
7. ANY LOOSE MATERIAL DEPOSITED IN THE FLOW LINE OF DITCHES, GUTTERS OR OTHER DRAINAGE STRUCTURES SHALL BE REMOVED BY THE END OF EACH DAY BY THE CONTRACTOR AT THEIR EXPENSE.
8. ANY AND ALL DAMAGE TO PCC DRIVEWAYS AS A RESULT OF ADJACENT CURB AND GUTTER REMOVAL AND REPLACEMENT SHALL BE REPAIRED TO THE SATISFACTION OF THE ENGINEER AT NO ADDITIONAL COST.
9. IT IS THE CONTRACTOR'S SOLE RESPONSIBILITY TO COORDINATE WITH THE METRA RAILROAD WHENEVER ACTIVITY IS WITHIN 25 FEET OF THE RAILROAD ROW. THE CONTRACTOR SHALL RETAIN FLAGMEN EMPLOYED AND DESIGNATED BY THE METRA RAILROAD TO MONITOR ON-COMING TRAIN TRAFFIC, AND ADVISE CONTRACTOR PERSONNEL, WHEN ACTIVITY ON OR NEAR THE RAILROAD RIGHT-OF-WAY MAY PROCEED. THIS ITEM WILL BE PAID FOR ACCORDING TO ARTICLE 107.12 AND WILL BE REIMBURSED ACCORDING TO ARTICLE 109.05.

* - INDICATES SPECIALTY ITEMS
 ~ - INDICATES SPECIAL PROVISIONS

SUMMARY OF QUANTITIES					CONSTRUCTION TYPE CODE
S.I.	CODE NO.	PAY ITEM	UNIT	QUAN	0005
	20200100	EARTH EXCAVATION	CU YD	75	75
~	21101615	TOPSOIL FURNISH AND PLACE, 4"	SQ YD	157	157
	25200200	SUPPLEMENTAL WATERING	UNIT	5	5
	28000510	INLET FILTERS	EACH	6	6
	40600100	BITUMINOUS MATERIALS (PRIME COAT)	GALLON	1415	1415
	40600300	AGGREGATE (PRIME COAT)	TON	28	28
	40600525	LEVELING BINDER (MACHINE METHOD), N50	TON	396	396
	40603335	HOT-MIX ASPHALT SURFACE COURSE, MIX "D", N50	TON	596	596
	42300200	PORTLAND CEMENT CONCRETE DRIVEWAY PAVEMENT, 6 INCH	SQ YD	120	120
	42400200	PORTLAND CEMENT CONCRETE SIDEWALK 5 INCH	SQ FT	1225	1225
~	42400800	DETECTABLE WARNINGS	SQ FT	112	112
	44000158	HOT-MIX ASPHALT SURFACE REMOVAL, 2 1/4"	SQ YD	7074	7074
	44000200	DRIVEWAY PAVEMENT REMOVAL	SQ YD	68	68
	44000600	SIDEWALK REMOVAL	SQ FT	505	505
	44201717	CLASS D PATCHES, TYPE II, 6 INCH	SQ YD	89	89
	44201721	CLASS D PATCHES, TYPE III, 6 INCH	SQ YD	115	115
	44201723	CLASS D PATCHES, TYPE IV, 6 INCH	SQ YD	498	498
	60250200	CATCH BASINS TO BE ADJUSTED	EACH	6	6
	60255500	MANHOLES TO BE ADJUSTED	EACH	12	12
	60266600	VALVE BOXES TO BE ADJUSTED	EACH	3	3
	48101200	AGGREGATE SHOULDERS, TYPE B	TON	200	200
	67100100	MOBILIZATION	L SUM	1	1

* - INDICATES SPECIALTY ITEMS
 ~ - INDICATES SPECIAL PROVISIONS

SUMMARY OF QUANTITIES					CONSTRUCTION TYPE CODE
S.I.	CODE NO.	PAY ITEM	UNIT	QUAN	0005
	70102620	TRAFFIC CONTROL AND PROTECTION, STANDARD 701501	L SUM	1	1
	70102640	TRAFFIC CONTROL AND PROTECTION, STANDARD 701801	L SUM	1	1
	72000100	SIGN PANEL - TYPE I	SQ FT	42	42
	72900100	METAL POST - TYPE A	FOOT	60	60
*	78000200	THERMOPLASTIC PAVEMENT MARKING - LINE 4"	FOOT	1100	1100
*	78000400	THERMOPLASTIC PAVEMENT MARKING - LINE 6"	FOOT	480	480
*	78000600	THERMOPLASTIC PAVEMENT MARKING - LINE 12"	FOOT	36	36
*	78000650	THERMOPLASTIC PAVEMENT MARKING - LINE 24"	FOOT	92	92
~	* X2520650	SODDING, SALT TOLERANT (SPECIAL)	SQ YD	157	157
~	XX008200	STABILIZED DRIVEWAY PAVEMENT	SQ YD	180	180
~	Z0004542	HOT-MIX ASPHALT REMOVAL (SPECIAL)	SQ YD	180	180
~	Z0004544	HOT-MIX ASPHALT DRIVEWAY PAVEMENT REMOVAL	SQ YD	132	132
~	Z0004562	COMBINATION CURB AND GUTTER REMOVAL AND REPLACEMENT	FOOT	350	350
~	* Z0048665	RAILROAD PROTECTIVE LIABILITY INSURANCE	L SUM	1	1
~	Z0004522	HOT-MIX ASPHALT DRIVEWAY PAVEMENT, 6"	SQ YD	132	132

FILE NAME = 11417-QUAN-01 - IDOT P01

USER NAME =	DESIGNED -- MRS	REVISED --
CHECKED -- PKB	REVISIONS --	
PLOT SCALE =	DRAWN -- MED	REVISED --
PLOT DATE = 02-01-13	CHECKED -- AG	REVISIONS --

STATE OF ILLINOIS
 DEPARTMENT OF TRANSPORTATION

DEPOT AVENUE AND 110TH STREET
 STREET RESURFACING
 SUMMARY OF QUANTITIES

SCALE: SHEET NO. 2 OF 10 SHEETS STA. TO STA.

FAU RTE	SECTION	COUNTY	TOTAL SHEETS	SHEET NO.
1086	13-00053-00-RS	COOK	10	2
CONTRACT NO. 63801				
FED. ROAD DIST. NO. 1 ILLINOIS FED. AID PROJECT M-4003(115)				

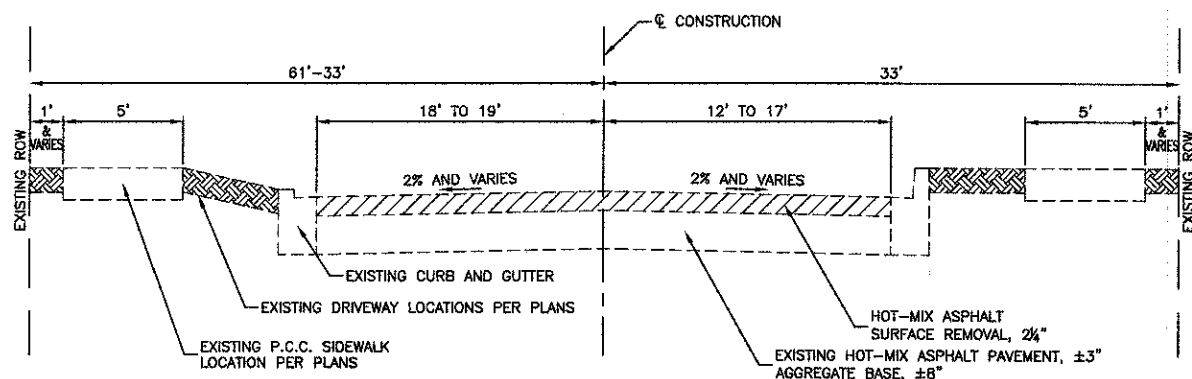

EXISTING TYPICAL SECTION

DEPOT AVENUE & 110TH STREET
STA 100+24 TO STA 107+00

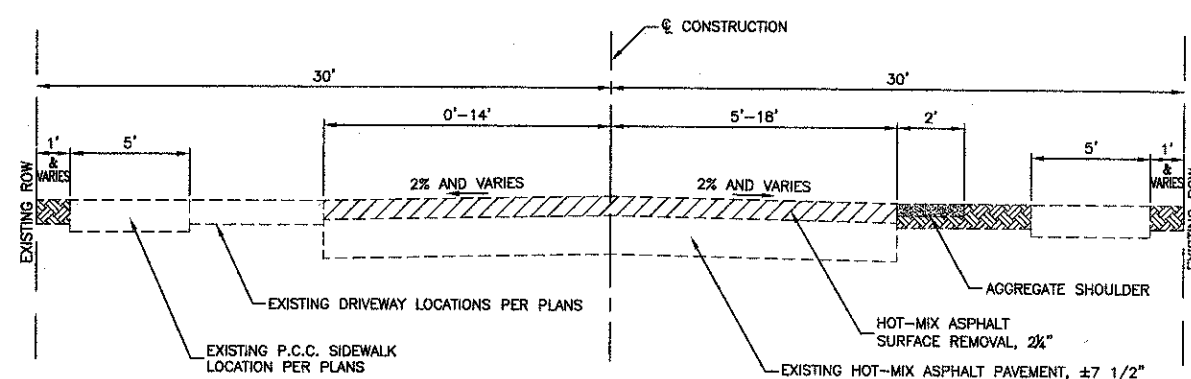

EXISTING TYPICAL SECTION

DEPOT AVENUE & 110TH STREET
STA 107+00 TO STA 124+00

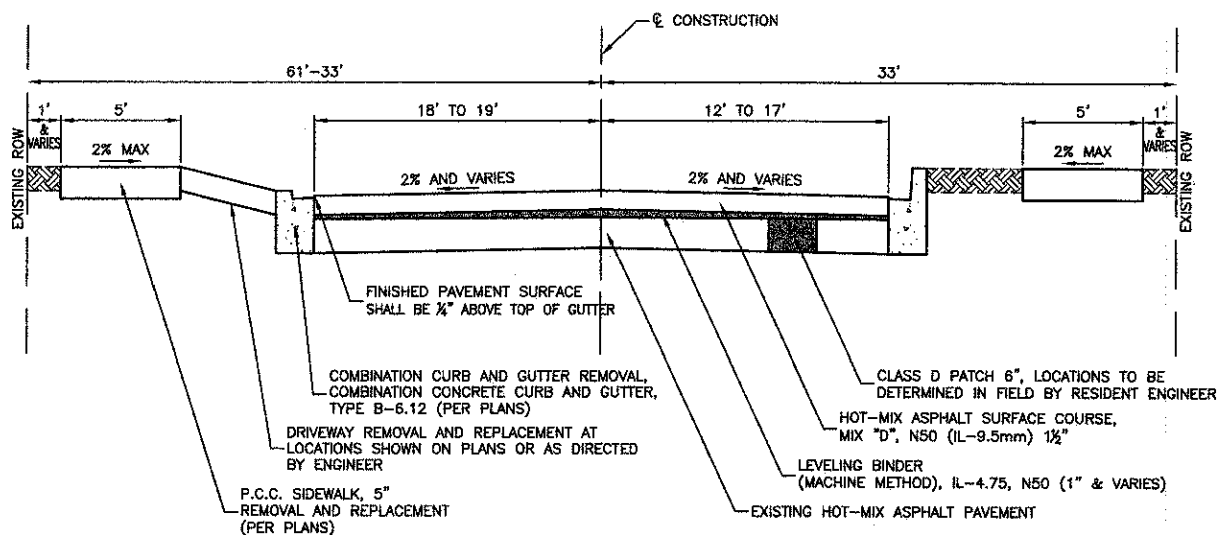

PROPOSED TYPICAL SECTION

DEPOT AVENUE & 110TH STREET
STA 100+24 TO STA 107+00

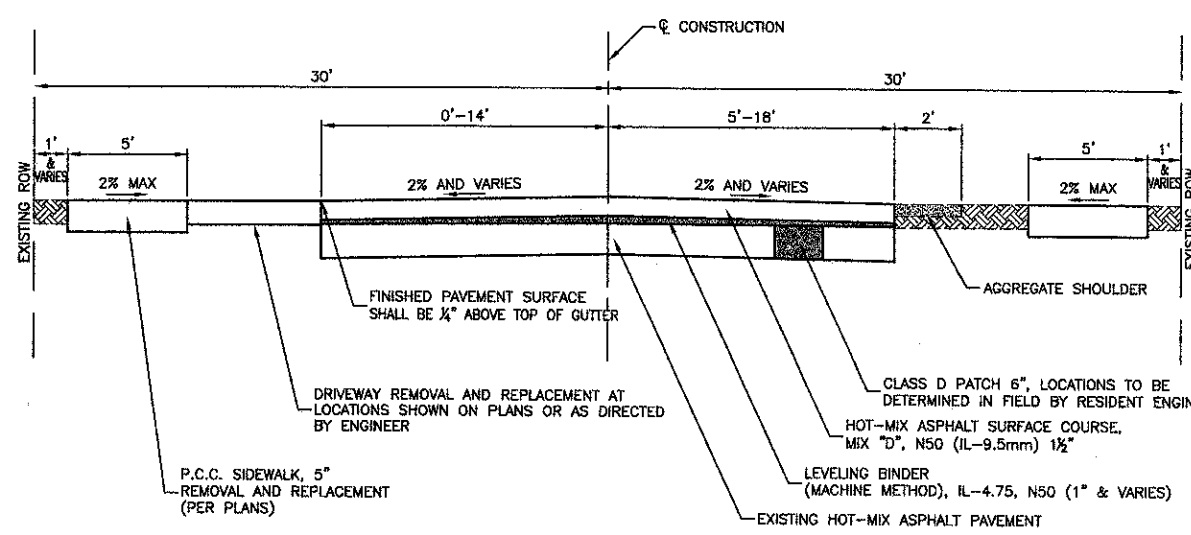

PROPOSED TYPICAL SECTION

DEPOT AVENUE & 110TH STREET
STA 107+00 TO STA 124+00

HOT-MIX ASPHALT MIXTURE REQUIREMENTS

MIXTURE TYPE	AIR VOIDS
RESURFACING	
HOT MIX ASPHALT SURFACE COURSE, MIX "D", N50(IL-9.5mm); 1 1/2"	4% @ 50 Gyr.
LEVELING BINDER (MACHINE METHOD), IL-4.75, N50, (1")	4% @ 50 Gyr.
DRIVEWAYS - COMMERCIAL	
HOT MIX ASPHALT SURFACE COURSE, MIX "D", N50 (IL-9.5mm); 2"	4% @ 50 Gyr.
HOT MIX ASPHALT BINDER COURSE, N50 (IL-19.0mm); 4"	4% @ 50 Gyr.
DRIVEWAYS - RESIDENTIAL	
HOT MIX ASPHALT SURFACE COURSE, MIX "D", N50 (IL-9.5mm); 2 1/2"	4% @ 50 Gyr.
PATCHING	
CLASS D PATCHES, TYPE I, II, III, IV (HMA BINDER IL-19.0mm), 6" (IN 2 LIFTS)	4% @ 70 Gyr.

NOTES:

1. THE UNIT WEIGHT USED TO CALCULATE ALL HOT-MIX ASPHALT SURFACE MIXTURE QUANTITIES IS 112 LBS/SY/IN.
2. THE "AC TYPE" FOR POLYMERIZED HMA MIXES SHALL BE "SBS/SBR PG 70-22" AND FOR NON-POLYMERIZED HMA THE "AC" TYPE SHALL BE "PG 64-22" UNLESS MODIFIED BY DISTRICT ONE SPECIAL PROVISIONS. FOR "PERCENT OF RAP" SEE DISTRICT ONE SPECIAL PROVISIONS.

FILE NAME = 11417-TYPX-01 - IDOT P01

USER NAME =	DESIGNED - MRS	REVISED -
	CHECKED - PKB	REVISED -
PLOT SCALE =	DRAWN - MED	REVISED -
PLOT DATE = 02-01-13	CHECKED - AG	REVISED -

STATE OF ILLINOIS
DEPARTMENT OF TRANSPORTATION

DEPOT AVENUE AND 110TH STREET
STREET RESURFACING
TYPICAL CROSS SECTIONS

F.A.U. RTE.	SECTION	COUNTY	TOTAL SHEETS	SHEET NO.
1066	13-00063-00-RS	COOK	10	3
CONTRACT NO. 63801				
FED. ROAD DIST. NO. 1 ILLINOIS FED. AID PROJECT M-4003(115)				

SCALE: SHEET NO. 3 OF 10 SHEETS STA. TO STA.

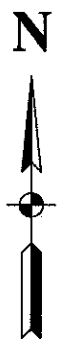
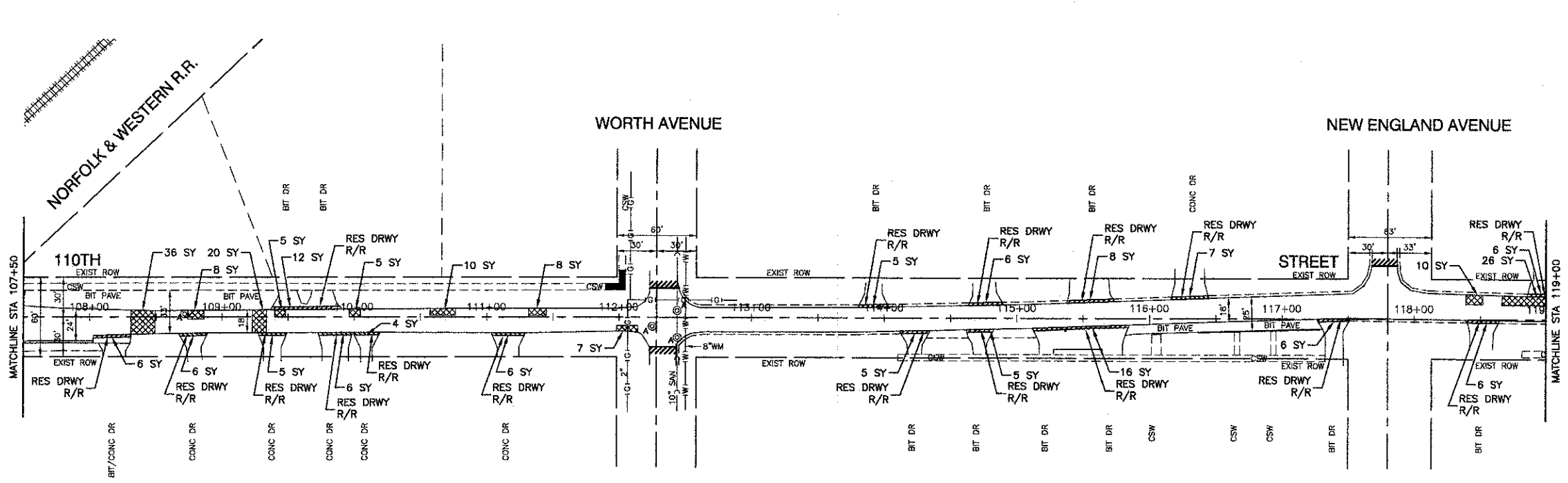
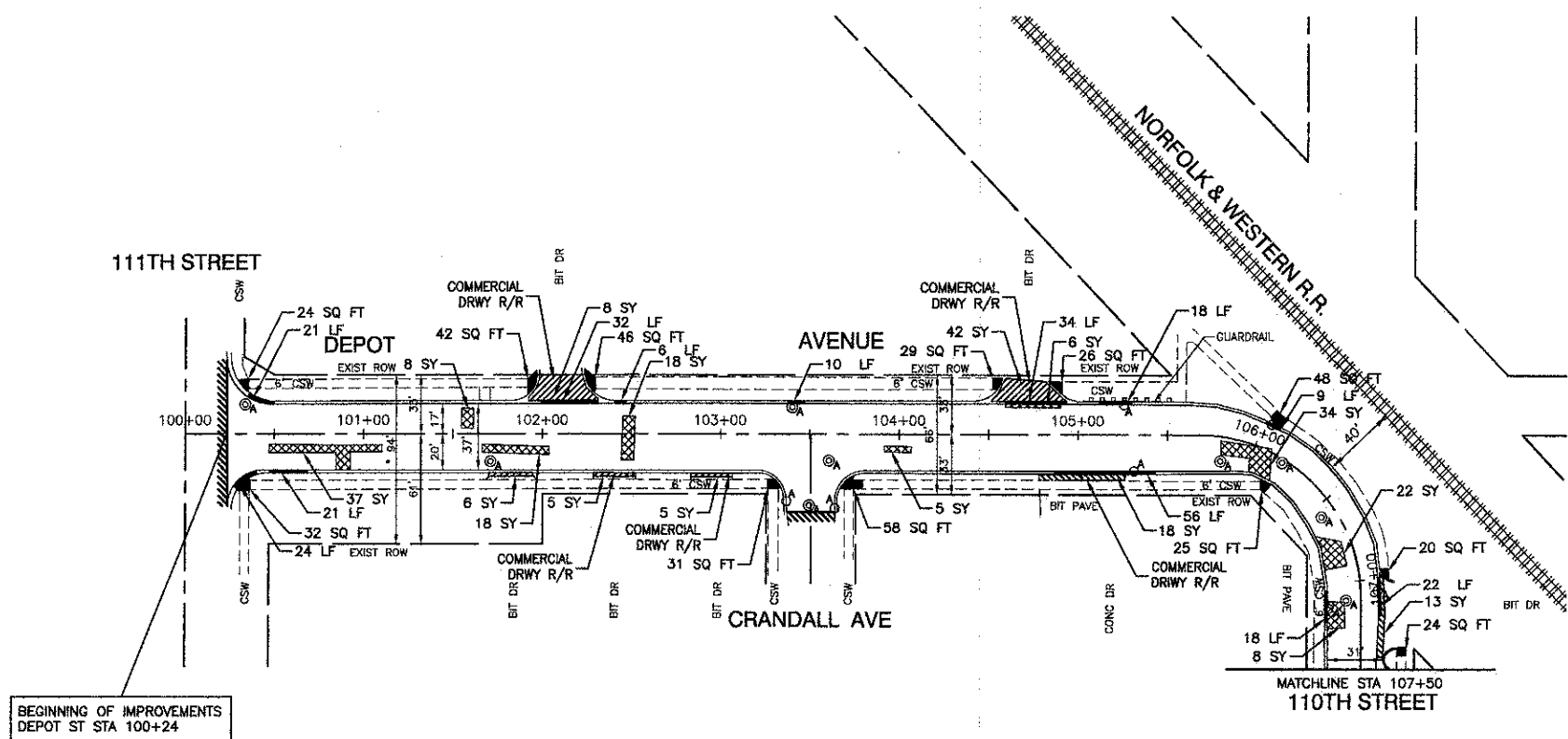

LEGEND

	HMA PAVEMENT REPAIR
	CONCRETE SIDEWALK REMOVAL AND REPLACEMENT
	BITUMINOUS DRIVEWAY REMOVAL AND REPLACEMENT (COMMERCIAL AND RESIDENTIAL)
	CONCRETE DRIVEWAY REMOVAL AND REPLACEMENT
	BUTT JOINTS
	CURB REMOVAL
	CATCH BASIN TO BE ADJUSTED, MANHOLE TO BE ADJUSTED, VALVE BOX TO BE ADJUSTED, FRAME & LID TO BE ADJUSTED (SPECIAL)

- NOTES:**
1. DETECTABLE WARNINGS ARE TO BE INSTALLED AT LOCATIONS OF SIDEWALK REMOVAL AND REPLACEMENT. CONTRACTOR TO POSITION AND PLACE DETECTABLE WARNINGS AT THE DIRECTION OF THE ENGINEER IN ACCORDANCE WITH ADA REQUIREMENTS.
 2. LIMIT OF CONSTRUCTION ON ALL SIDE STREETS IS THE RADIUS RETURN PLUS 10' BUTT JOINT OR ROW AS NOTED.
 3. ACCESS TO ALL DRIVEWAYS SHALL BE MAINTAINED UPON COMPLETION OF EACH WORKDAY. RESIDENTS SHALL BE NOTIFIED 24 HOURS IN ADVANCE OF WHEN DRIVEWAY REPLACEMENT WILL TAKE PLACE.

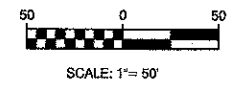

FILE NAME = 11417.PLAN-01 - IDOT.P01

USER NAME =	DESIGNED -- MRS	REVISED --
	CHECKED -- PKB	REVISED --
PLOT SCALE =	DRAWN -- MED	REVISED --
PLOT DATE = 02-01-13	CHECKED -- AG	REVISED --





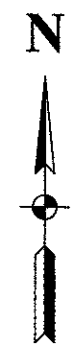
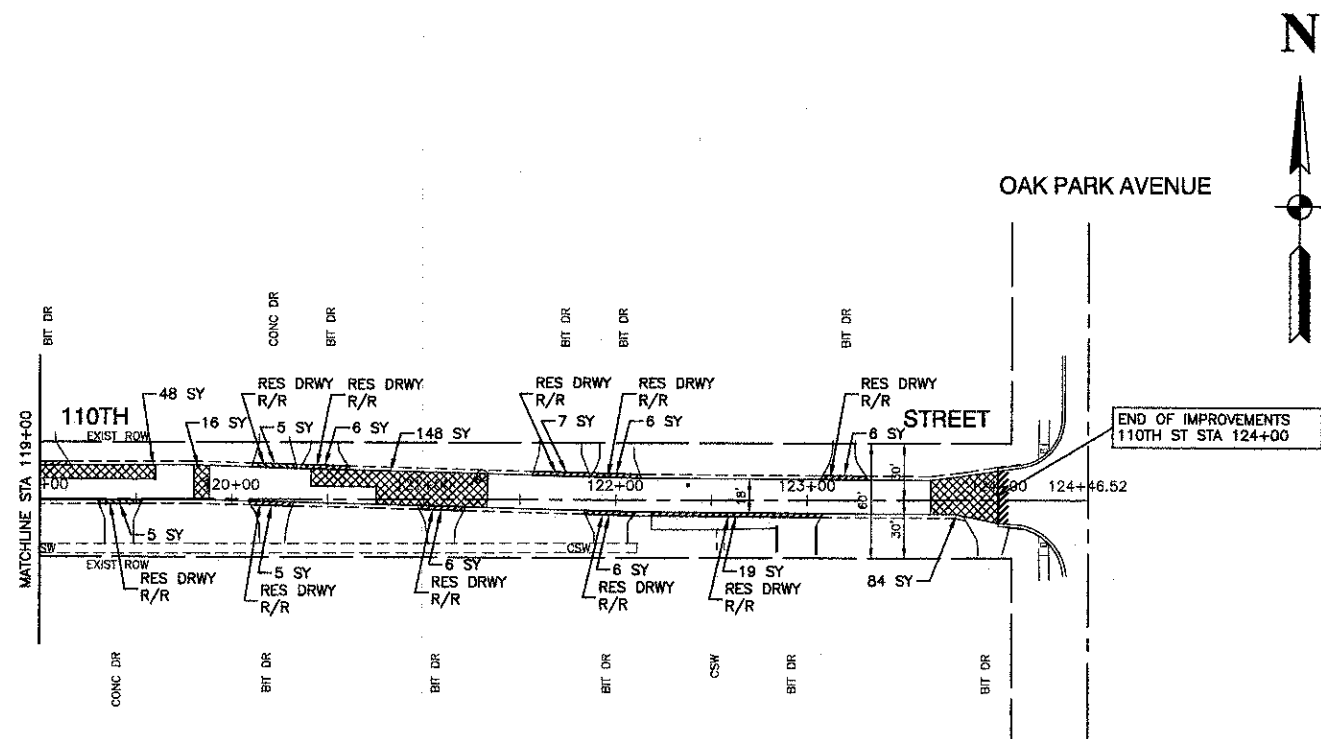

STATE OF ILLINOIS
DEPARTMENT OF TRANSPORTATION

DEPOT AVENUE AND 110TH STREET STREET RESURFACING PAVEMENT PLAN			
SCALE: 1"=50'	SHEET NO. 4	OF 10 SHEETS	STA. TO STA.

F.A.U. RITE	SECTION	COUNTY	TOTAL SHEETS	SHEET NO.
1066	13-00063-00-RS	COOK	10	4
CONTRACT NO. 63801				
FED. ROAD DIST. NO. 1 ILLINOIS FED. AID PROJECT M-4003(115)				



LEGEND

-  HMA PAVEMENT REPAIR
-  CONCRETE SIDEWALK REMOVAL AND REPLACEMENT
-  BITUMINOUS DRIVEWAY REMOVAL AND REPLACEMENT (COMMERCIAL AND RESIDENTIAL)
-  CONCRETE DRIVEWAY REMOVAL AND REPLACEMENT
-  BUTT JOINTS
-  CURB REMOVAL
-  "A" CATCH BASIN TO BE ADJUSTED, MANHOLE TO BE ADJUSTED, VALVE BOX TO BE ADJUSTED, FRAME & LID TO BE ADJUSTED (SPECIAL)

NOTES:

1. DETECTABLE WARNINGS ARE TO BE INSTALLED AT LOCATIONS OF SIDEWALK REMOVAL AND REPLACEMENT. CONTRACTOR TO POSITION AND PLACE DETECTABLE WARNINGS AT THE DIRECTION OF THE ENGINEER IN ACCORDANCE WITH ADA REQUIREMENTS.
2. LIMIT OF CONSTRUCTION ON ALL SIDE STREETS IS THE RADIUS RETURN PLUS 10' BUTT JOINT OR ROW AS NOTED.
3. ACCESS TO ALL DRIVEWAYS SHALL BE MAINTAINED UPON COMPLETION OF EACH WORKDAY. RESIDENTS SHALL BE NOTIFIED 24 HOURS IN ADVANCE OF WHEN DRIVEWAY REPLACEMENT WILL TAKE PLACE.

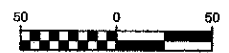

SCALE: 1"=50'

FILE NAME = 11417-PLAN-01 - IDOT P02	USER NAME =	DESIGNED -- MRS	REVISED --	STATE OF ILLINOIS DEPARTMENT OF TRANSPORTATION	DEPOT AVENUE AND 110TH STREET STREET RESURFACING PAVEMENT PLAN				F.A.U RTE. 1068	SECTION 13-00063-00-RS	COUNTY COOK	TOTAL SHEETS 10	SHEET NO. 5
PLOT SCALE =	DRAWN -- MED	CHECKED -- PKB	REVISED --		SCALE: 1"=50'	SHEET NO. 5	OF 10 SHEETS	STA.	TO STA.	CONTRACT NO. 63801			
PLOT DATE = 02-01-13	CHECKED -- AG	REVISED --	REVISED --		FED. ROAD DIST. NO. 1 ILLINOIS FED. AID PROJECT M-4003(115)								

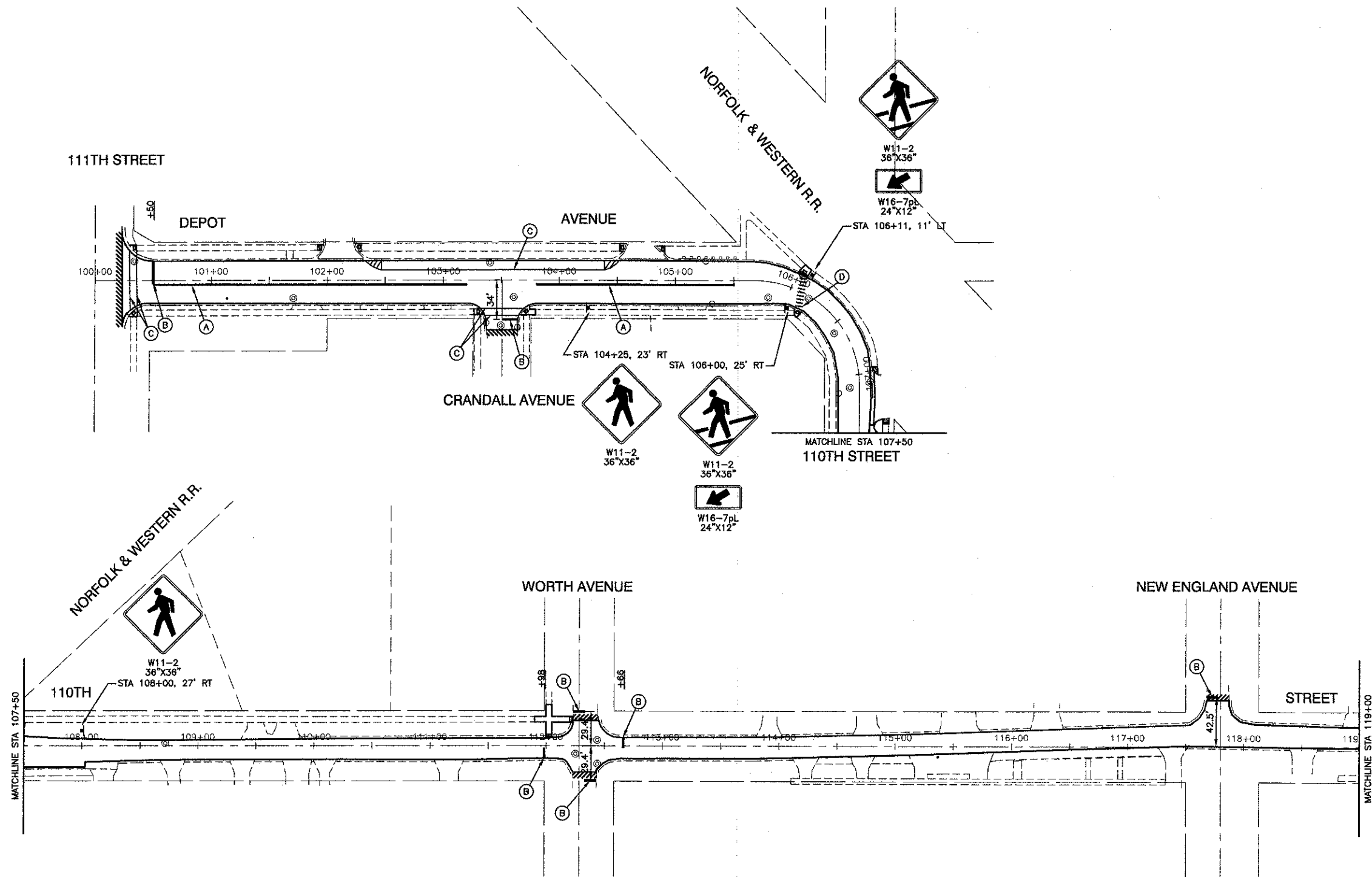
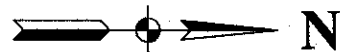

PAVEMENT MARKING LEGEND

- (A) THERMOPLASTIC DOUBLE YELLOW, 4"
- (B) THERMOPLASTIC PAVEMENT MARKING WHITE, 24"
- (C) THERMOPLASTIC PAVEMENT MARKING WHITE, 6"
- (D) THERMOPLASTIC PAVEMENT MARKING WHITE, 12"
- ☒ TRAFFIC SIGN

FILE NAME = 11417-PMK3-01 - IDOT P01

USER NAME =	DESIGNED -- MRS	REVISED --
PLOT SCALE =	CHECKED -- PKB	REVISED --
PLOT DATE = 02-01-13	DRAWN -- MED	REVISED --
	CHECKED -- AG	REVISED --

**STATE OF ILLINOIS
DEPARTMENT OF TRANSPORTATION**

DEPOT AVENUE AND 110TH STREET STREET RESURFACING PAVEMENT MARKING & SIGNING			
SCALE: 1"=50'	SHEET NO. 6 OF 10 SHEETS	STA.	TO STA.

F.A.U. RTE.	SECTION	COUNTY	TOTAL SHEETS	SHEET NO.
1068	13-00063-00-RS	COOK	10	6
CONTRACT NO. 63801				
FED. ROAD DIST. NO. 1 ILLINOIS FED. AID PROJECT M-4003(115)				

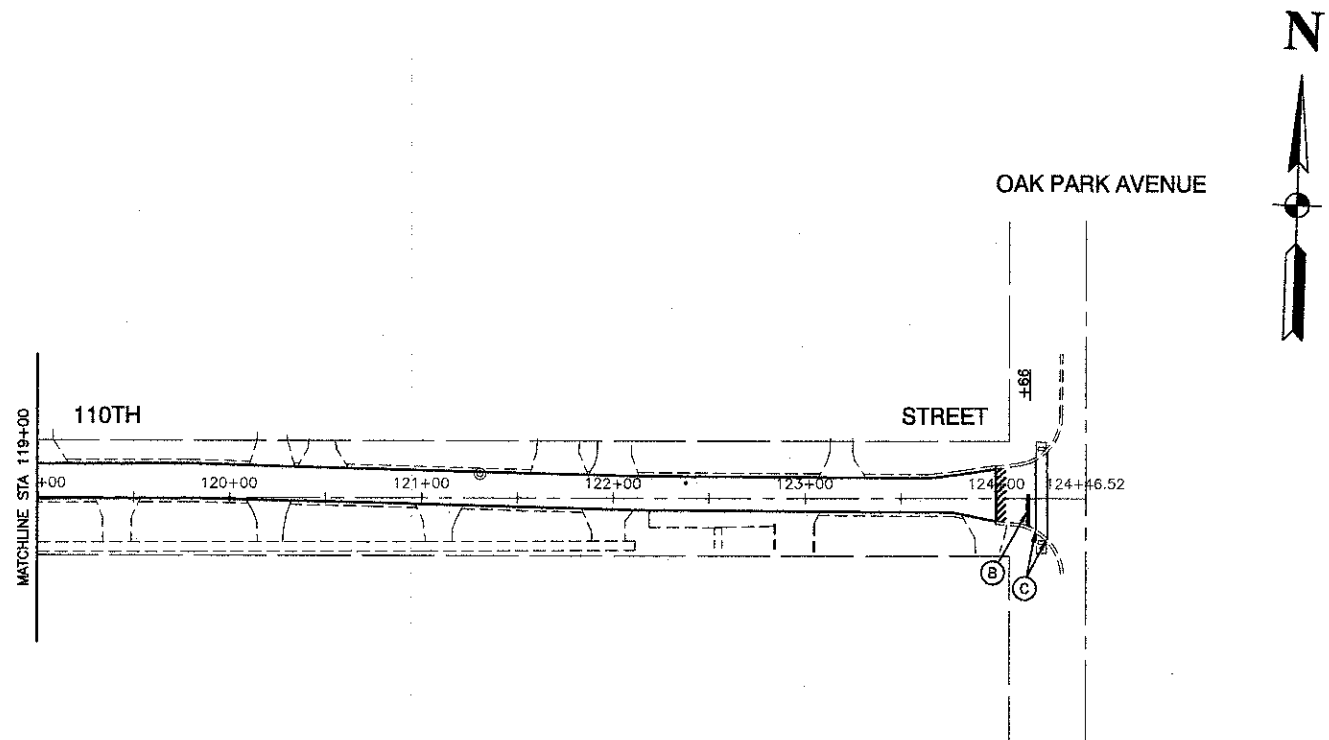

PAVEMENT MARKING LEGEND

- (A) THERMOPLASTIC DOUBLE YELLOW, 4"
- (B) THERMOPLASTIC PAVEMENT MARKING WHITE, 24"
- (C) THERMOPLASTIC PAVEMENT MARKING WHITE, 6"
- (D) THERMOPLASTIC PAVEMENT MARKING WHITE, 12"
- ☐ TRAFFIC SIGN

FILE NAME = 11417-PMKG-01 - IDOT P02	USER NAME =	DESIGNED -- MRS	REVISED --	STATE OF ILLINOIS DEPARTMENT OF TRANSPORTATION	DEPOT AVENUE AND 110TH STREET STREET RESURFACING PAVEMENT MARKING & SIGNING				F.A.U. RTE.	SECTION	COUNTY	TOTAL SHEETS	SHEET NO.
	PLOT SCALE =	DRAWN -- MED	REVISED --						1086	13-00063-00-RS	COOK	10	7
	PLOT DATE = 02-01-13	CHECKED -- AG	REVISED --		SCALE: 1"=50'	SHEET NO. 7	OF 10 SHEETS	STA.	TO STA.	CONTRACT NO. 63801			
									FED. ROAD DIST. NO. 1 ILLINOIS FED. AID PROJECT M-4003(11B)				

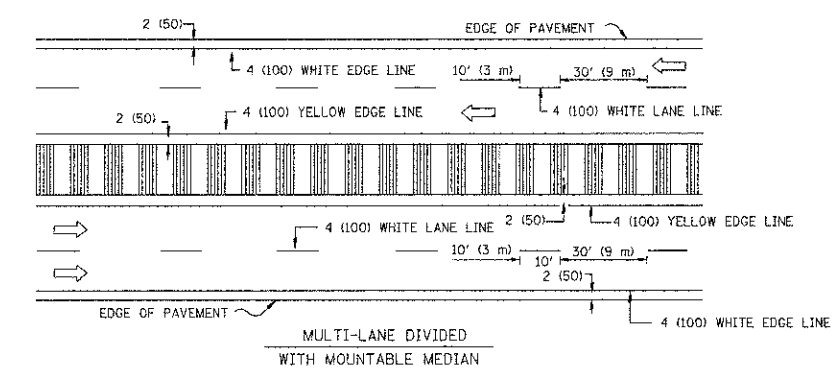
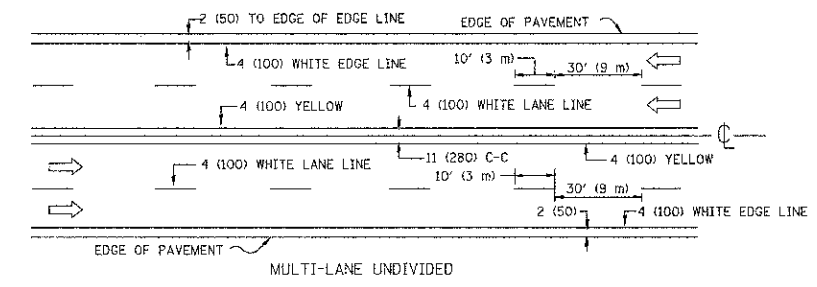
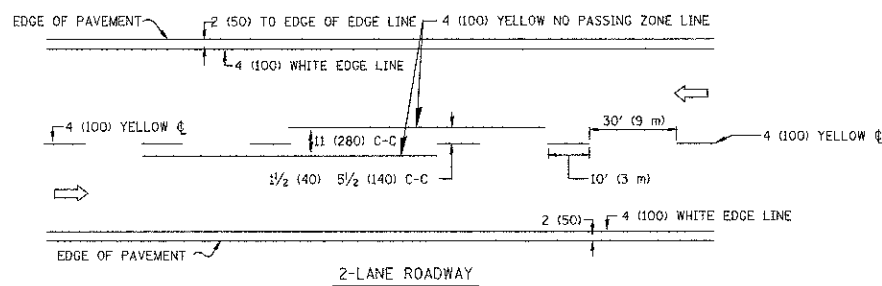

NOTE: MEDIANS WITH BARRIER CURB DO NOT REQUIRE AN EDGE LINE

TYPICAL LANE AND EDGE LINE MARKING

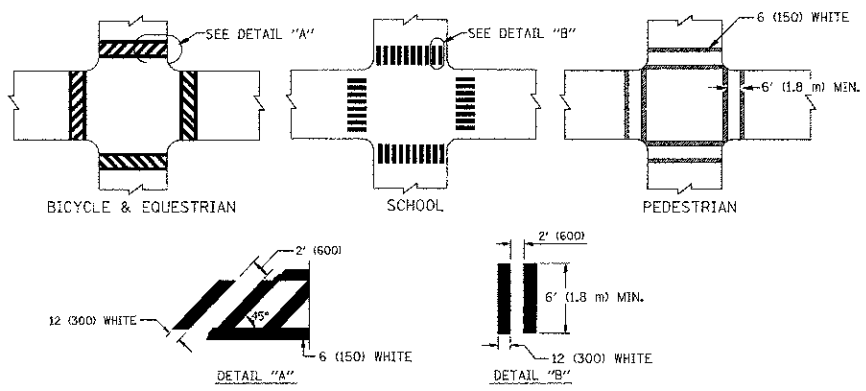

TYPICAL CROSSWALK MARKING

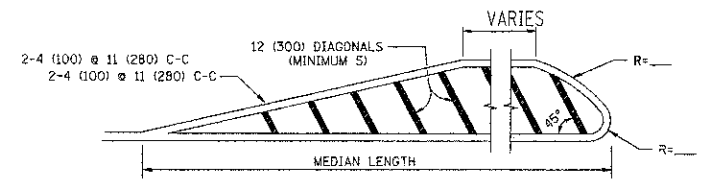
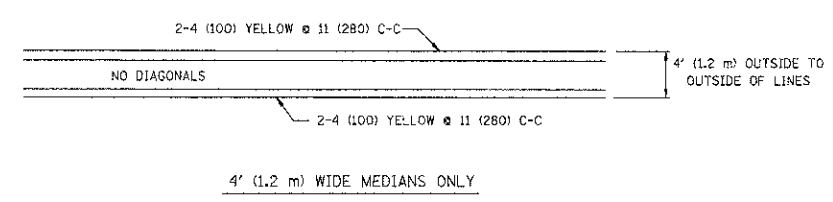

FOR MEDIAN LENGTHS WHERE DIAGONAL SPACING CANNOT BE ATTAINED, USE 5 (FIVE) EQUALLY SPACED DIAGONAL LINES.

DIAGONAL LINE SPACING: 50' (15 m) C-C (LESS THAN 30MPH (50 km/h))
 75' (25 m) C-C 30MPH (50 km/h) TO 45MPH (70 km/h)
 150' (45 m) C-C (MORE THAN 45MPH (70 km/h))

MEDIANS OVER 4' (1.2 m) WIDE

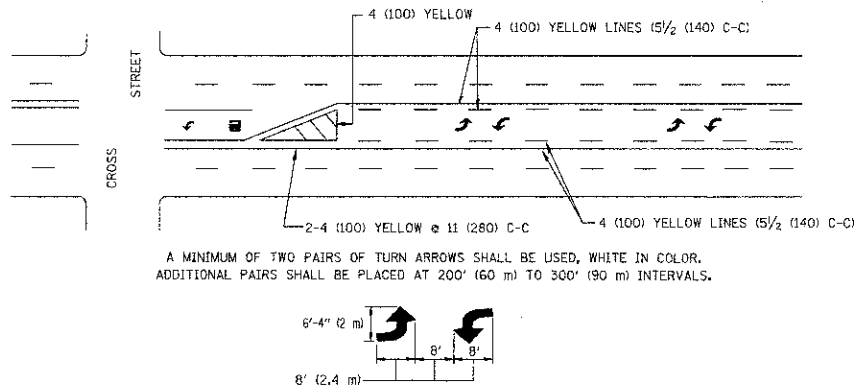

TYPICAL PAINTED MEDIAN MARKING

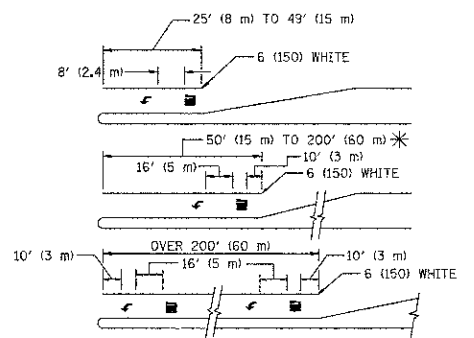

FULL SIZE LETTERS 8' (2.4 m) AND ARROWS SHALL BE USED.
 AREA = 15.6 SQ. FT. (1.5 m²) ONLY AREA = 20.8 SQ. FT. (1.9 m²)

* TURN LANES IN EXCESS OF 400' (120 m) IN LENGTH MAY HAVE AN ADDITIONAL SET OF ARROW - "ONLY" INSTALLED MIDWAY BETWEEN THE OTHER TWO SETS OF ARROW - "ONLY".

TYPICAL LEFT (OR RIGHT) TURN LANE

TYPICAL TURN LANE MARKING

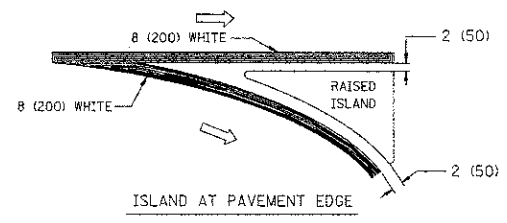
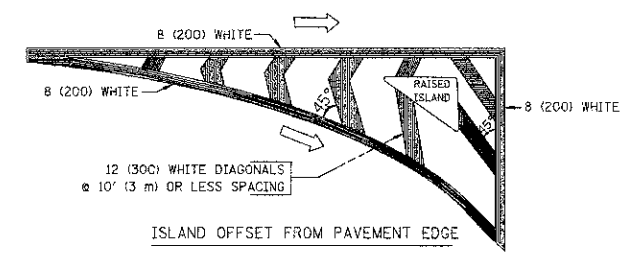

TYPICAL ISLAND MARKING

TYPE OF MARKING	WIDTH OF LINE	PATTERN	COLOR	SPACING / REMARKS
CENTERLINE ON 2 LANE PAVEMENT	4 (100)	SKIP-DASH	YELLOW	10' (3 m) LINE WITH 30' (9 m) SPACE
CENTERLINE ON MULTI-LANE UNDIVIDED PAVEMENT	2 @ 4 (100)	SOLID	YELLOW	11 (280) C-C
NO PASSING ZONE LINES: FOR ONE DIRECTION FOR BOTH DIRECTIONS	4 (100) 2 @ 4 (100)	SOLID SOLID	YELLOW YELLOW	5/2 (140) C-C FROM SKIP-DASH CENTERLINE 11 (280) C-C OMIT SKIP-DASH CENTERLINE BETWEEN
LANE LINES	4 (100) 5 (125) ON FREEWAYS	SKIP-DASH SKIP-DASH	WHITE WHITE	10' (3 m) LINE WITH 30' (9 m) SPACE
DOTTED LINES (EXTENSIONS OF CENTER, LANE OR TURN LANE MARKINGS)	SAME AS LINE BEING EXTENDED	SKIP-DASH	SAME AS LINE BEING EXTENDED	2' (600) LINE WITH 6' (1.8 m) SPACE
EDGE LINES	4 (100)	SOLID	YELLOW-LEFT WHITE-RIGHT	OUTLINE MOUNTABLE MEDIANS IN YELLOW; EDGE LINES ARE NOT USED NEXT TO BARRIER CURB
TURN LANE MARKINGS	6 (150) LINE; FULL SIZE LETTERS & SYMBOLS (8' (2.4m))	SOLID	WHITE	SEE TYPICAL TURN LANE MARKING DETAIL
TWO WAY LEFT TURN MARKING	2 @ 4 (100) EACH DIRECTION 8' (2.4m) LEFT ARROW	SKIP-DASH AND SOLID IN PAIRS	YELLOW WHITE	10' (3 m) LINE WITH 30' (9 m) SPACE FOR SKIP-DASH; 5/2 (140) C-C BETWEEN SOLID LINE AND SKIP-DASH LINE SEE TYPICAL TWO-WAY LEFT TURN MARKING DETAIL
CROSSWALK LINES (PEDESTRIAN) A. DIAGONALS (BIKE & EQUESTRIAN) B. LONGITUDINAL BARS (SCHOOL)	2 @ 6 (150) 12 (300) @ 45° 12 (300) @ 90°	SOLID SOLID SOLID	WHITE WHITE WHITE	NOT LESS THAN 6' (1.8 m) APART 2' (600) APART 2' (600) APART SEE TYPICAL CROSSWALK MARKING DETAILS.
STOP LINES	24 (600)	SOLID	WHITE	PLACE 4' (1.2 m) IN ADVANCE OF AND PARALLEL TO CROSSWALK, IF PRESENT, OTHERWISE, PLACE AT DESIRED STOPPING POINT, PARALLEL TO CROSSROAD CENTERLINE, WHERE POSSIBLE
PAINTED MEDIANS	2 @ 4 (100) WITH 12 (300) DIAGONALS @ 45° NO DIAGONALS USED FOR 4' (1.2 m) WIDE MEDIANS	SOLID	YELLOW; TWO WAY TRAFFIC WHITE; ONE WAY TRAFFIC	11 (280) C-C FOR THE DOUBLE LINE SEE TYPICAL PAINTED MEDIAN MARKING.
GORE MARKING AND CHANNELIZING LINES	8 (200) WITH 12 (300) DIAGONALS @ 45°	SOLID	WHITE	DIAGONALS; 15' (4.5 m) C-C (LESS THAN 30MPH (50 km/h)) 20' (6 m) C-C 30MPH (50 km/h) TO 45MPH (70 km/h) 30' (9 m) C-C (OVER 45MPH (70 km/h))
RAILROAD CROSSING	24 (600) TRANSVERSE LINES; "RR" 15 6" (1.8 m) LETTERS; 16 (400) LINE FOR "X"	SOLID	WHITE	SEE STATE STANDARD 780001 AREA OF: "RR"=3.6 SQ. FT. (0.33 m ²) EACH "X"=54.0 SQ. FT. (5.0 m ²)
SHOULDER DIAGONALS	12 (300) @ 45°	SOLID	WHITE - RIGHT YELLOW - LEFT	50' (15 m) C-C (LESS THAN 30MPH (50 km/h)) 75' (25 m) C-C (30 MPH (50 km/h) TO 45MPH (70 km/h)) 150' (45 m) C-C (OVER 45MPH (70 km/h))

FOR FURTHER DETAILS ON PAVEMENT MARKING REFER TO STANDARD SPECIFICATIONS FOR ROAD AND BRIDGE CONSTRUCTION AND STATE STANDARD 780001.

All dimensions are in inches (millimeters) unless otherwise shown.

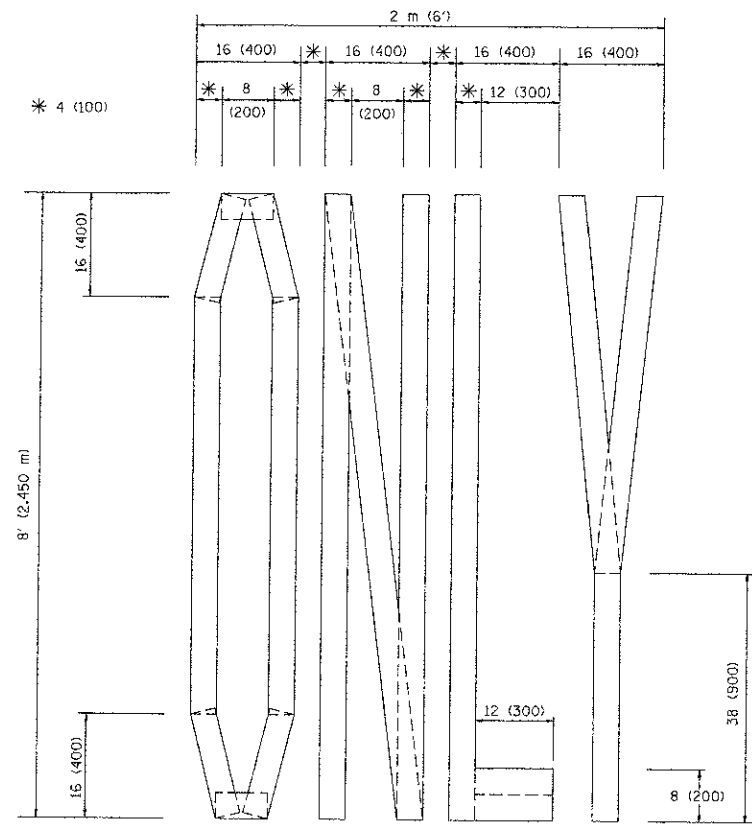

QUANTITY
 4 (100) LINE = 64.1 ft. (19.7 m)
 21.1 sq. ft. (1.97 sq. m)

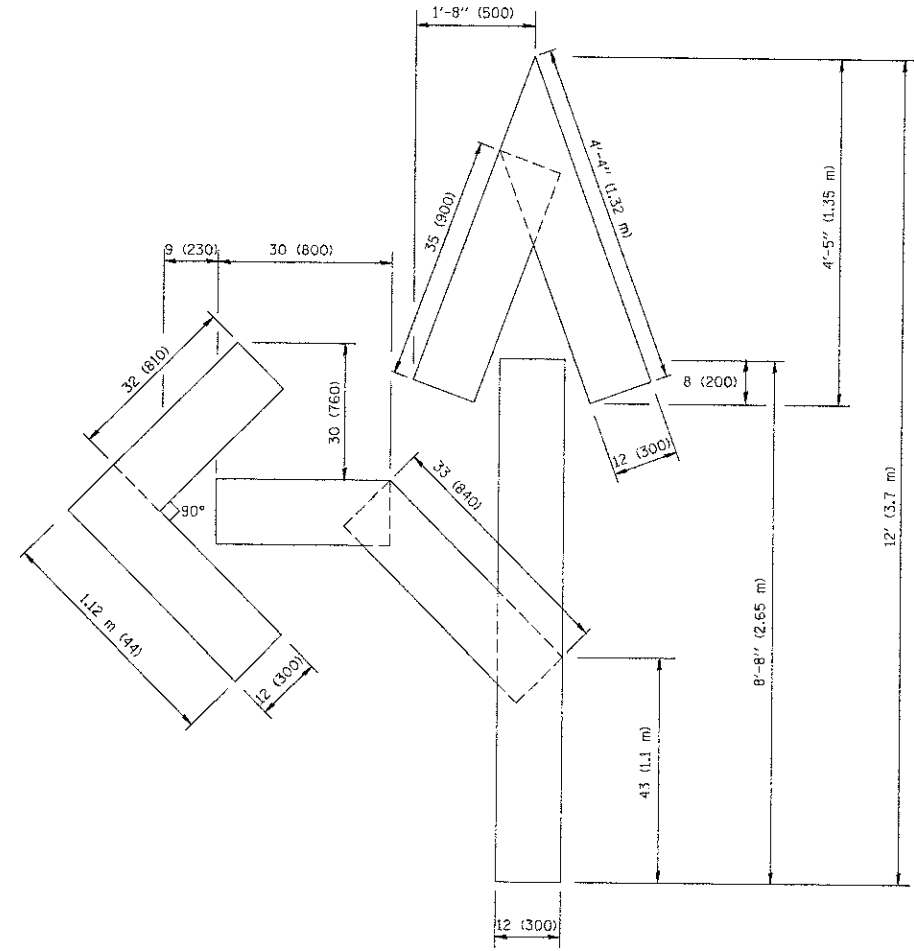

QUANTITY
 4 (100) LINE = 82.5 ft. (25.3 m)
 27.5 sq. ft. (2.53 sq. m)

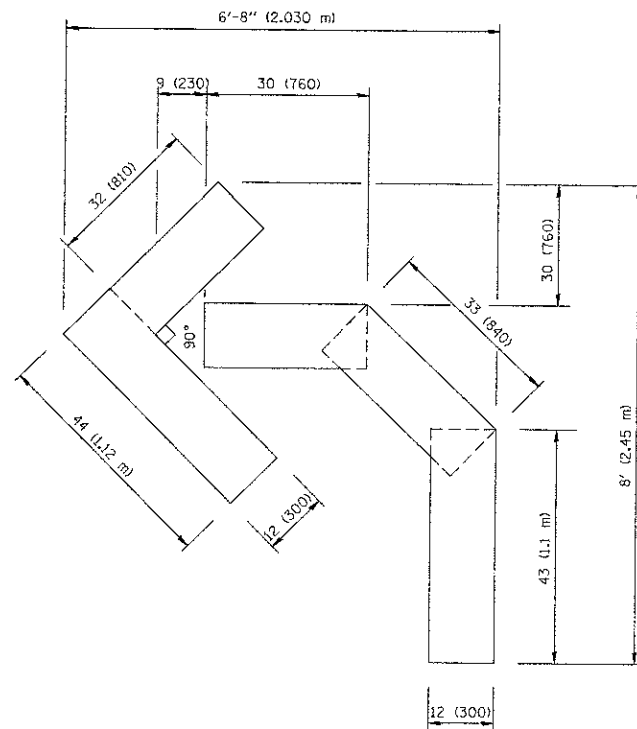

QUANTITY
 4 (100) LINE = 45.5 ft. (13.9 m)
 15.2 sq. ft. (1.39 sq. m)

All dimensions are in inches (millimeters) unless otherwise shown.

FILE NAME = 11417-DTLS-01 - IDOT P01 (2)	USER NAME =	DESIGNED -- EVERS	REVISED -- T. RAMMACHER 10-27-04
	PLOT SCALE =	CHECKED --	REVISED -- C.JUCIUS 09-09-09
	PLOT DATE = 02-01-13	DRAWN --	REVISED --
		CHECKED -- 03-19-90	REVISED --

STATE OF ILLINOIS
 DEPARTMENT OF TRANSPORTATION

PAVEMENT MARKING LETTERS AND SYMBOLS FOR TRAFFIC STAGING			
SCALE:	SHEET NO. 9	OF 10 SHEETS	STA. TO STA.

F.A.U. RTE.	SECTION	COUNTY	TOTAL SHEETS	SHEET NO.
1066	13-00063-00-RS	COOK	10	9
TC-16		CONTRACT NO.		
FED. ROAD DIST. NO. 1 ILLINOIS FED. AID PROJECT M-4003(115)				

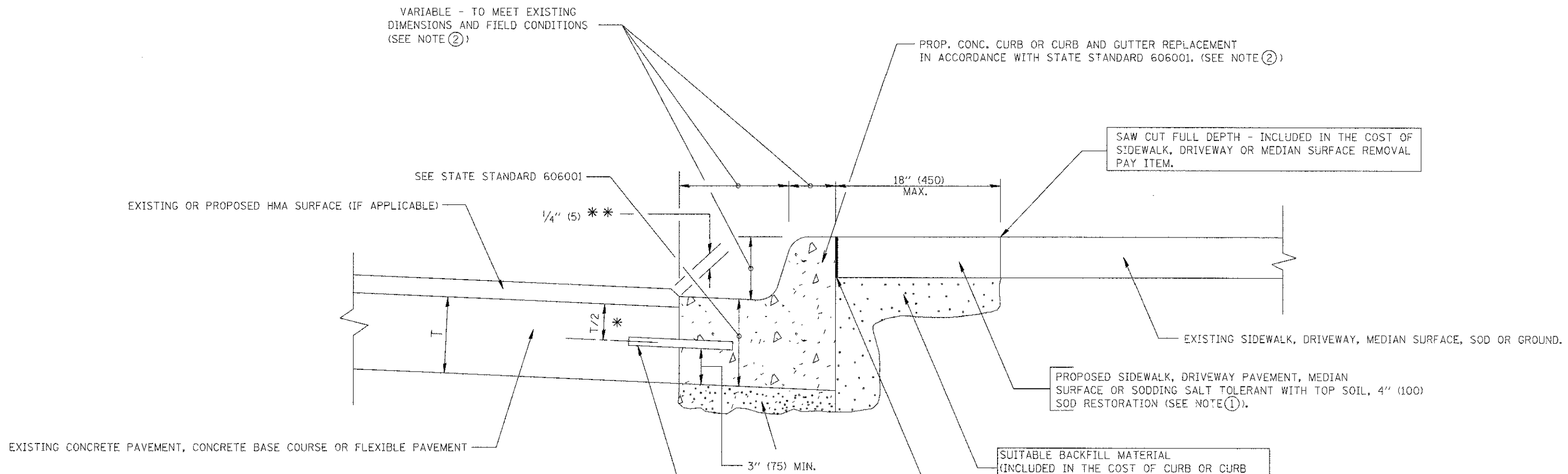

- * 3" (75) MINIMUM FROM TOP AND BOTTOM OF THE CONCRETE PAVEMENT OR BASE COURSE.
- ** IF THE FINAL SURFACE OF THE PAVEMENT IS CONCRETE, THE GUTTER IS TO BE FLUSH WITH THE PAVEMENT.

- NOTE: ① SIDEWALK, DRIVEWAY PAVEMENT OR MEDIAN SURFACE SHALL BE SIMILAR TO THE MATERIAL BEING REMOVED AND WILL BE PAID FOR SEPARATELY.
SODDING, SALT TOLERANT AND TOP SOIL, FURNISH AND PLACE 4" WILL BE PAID FOR SEPARATELY,
- ② FERTILIZER FOR THE PLACEMENT OF THE SOD IS NOT REQUIRED
- ③ CURB OR CURB AND GUTTER REPLACEMENT SHALL MATCH THE SHAPE OF THE EXISTING CURB OR CURB AND GUTTER UNLESS OTHERWISE SPECIFIED.
- ④ FOR CURB OR CURB AND GUTTER REMOVAL AND REPLACEMENT ADJACENT TO FLEXIBLE PAVEMENT DELETE EPOXY COATED TIE BARS.
- ⑤ LONGITUDINAL BARS, IF ENCOUNTERED IN THE EXISTING CURB OR CURB AND GUTTER, ARE NOT TO BE REPLACED. CUTTING AND REMOVING LONGITUDINAL BARS SHALL BE INCLUDED IN THE COST OF CURB OR CURB AND GUTTER REMOVAL AND REPLACEMENT.
- ⑥ THE COST OF HMA SURFACE REMOVAL IN THE EXISTING GUTTER FLAG SHALL BE INCLUDED IN THE COST OF THE CURB AND GUTTER REMOVAL AND REPLACEMENT.
- ⑦ THE REMOVAL AND REPLACEMENT OF THE EXISTING CURB OR CURB AND GUTTER SHALL BE DONE IN ACCORDANCE WITH THE APPLICABLE PORTIONS OF SECTION 440 AND 606 OF THE STANDARD SPECIFICATIONS.
- ⑧ THE LOCATIONS OF REMOVAL AND REPLACEMENT OF EXISTING CURB OR CURB AND GUTTER SHALL BE DETERMINED BY THE RESIDENT ENGINEER AT THE TIME OF CONSTRUCTION.

BASIS OF PAYMENT:
THIS WORK WILL BE PAID FOR AT THE CONTRACT UNIT PRICE PER FOOT (METER) FOR "CURB REMOVAL AND REPLACEMENT" OR "COMBINATION CONCRETE CURB AND GUTTER REMOVAL AND REPLACEMENT".

CURB OR CURB AND GUTTER REMOVAL AND REPLACEMENT

ALL DIMENSIONS ARE IN INCHES (MILLIMETERS) UNLESS OTHERWISE SHOWN.

FILE NAME = 11417-DTLS-01 - IDOT P01 (3)	USER NAME =	DESIGNED - EVERS	REVISED - T. RAMMACHER 10-27-04	STATE OF ILLINOIS DEPARTMENT OF TRANSPORTATION	CURB OR CURB AND GUTTER REMOVAL AND REPLACEMENT	F.A.U. RTE. 1066	SECTION 13-00063-00-RS	COUNTY COOK	TOTAL SHEETS 10	SHEET NO. 10
	PLOT SCALE =	DRAWN -	REVISED - C.JUCIUS 09-09-09			BD600-06 (BD-24)		CONTRACT NO.		
	PLOT DATE = 02-01-13	CHECKED - 03-19-90	REVISED -		SCALE:	SHEET NO. 10 OF 10 SHEETS		STA.	TO STA.	
						FED. ROAD DIST. NO. 1		ILLINOIS		FED. AID PROJECT M-4003(115)