

THE FOLLOWING EXISTING TRAFFIC SIGNAL EQUIPMENT SHALL BE REMOVED BY THE CONTRACTOR, SHALL BECOME THE PROPERTY OF THE CITY OF AURORA AND SHALL BE DELIVERED BY THE CONTRACTOR TO THE CITY'S ELECTRICAL YARD ALONG WITH FIVE (5) COPIES OF A LIST OF EQUIPMENT THAT IS TO REMAIN THE PROPERTY OF THE CITY IN ACCORDANCE WITH THE TRAFFIC SIGNAL SPECIFICATIONS. A LIST OF EQUIPMENT SHALL ALSO BE PROVIDED TO THE CITY'S ENGINEERING DEPARTMENT. THIS WORK SHALL BE INCLUDED IN THE CONTRACT UNIT PRICE FOR REMOVE EXISTING TRAFFIC SIGNAL EQUIPMENT (SEE SCHEDULE OF QUANTITIES FOR REMOVAL ITEMS TO BE PAID FOR SEPARATELY).

- 1 EACH SERVICE INSTALLATION
- 1 EACH TRAFFIC SIGNAL CABINET (COMPLETE)

THE FOLLOWING EXISTING TRAFFIC SIGNAL EQUIPMENT SHALL BE REMOVED BY THE CONTRACTOR, SHALL BECOME THE PROPERTY OF THE CITY OF AURORA AND SHALL BE DELIVERED BY THE CONTRACTOR TO EITHER MR. ERIC GALLT (630-256-3237) OR MR. STEVE ZABURUNOV (630-688-8414) ALONG WITH FIVE (5) COPIES OF A LIST OF EQUIPMENT THAT IS TO REMAIN THE PROPERTY OF THE CITY IN ACCORDANCE WITH THE TRAFFIC SIGNAL SPECIFICATIONS. THIS WORK SHALL BE INCLUDED IN THE CONTRACT UNIT PRICE FOR REMOVE EXISTING TRAFFIC SIGNAL EQUIPMENT.

- 1 EACH TRAFFIC SIGNAL CONTROLLER

DATE	
BY	
REVISION	
NO.	
DESCRIPTION	

DATE	
BY	
REVISION	
NO.	
DESCRIPTION	

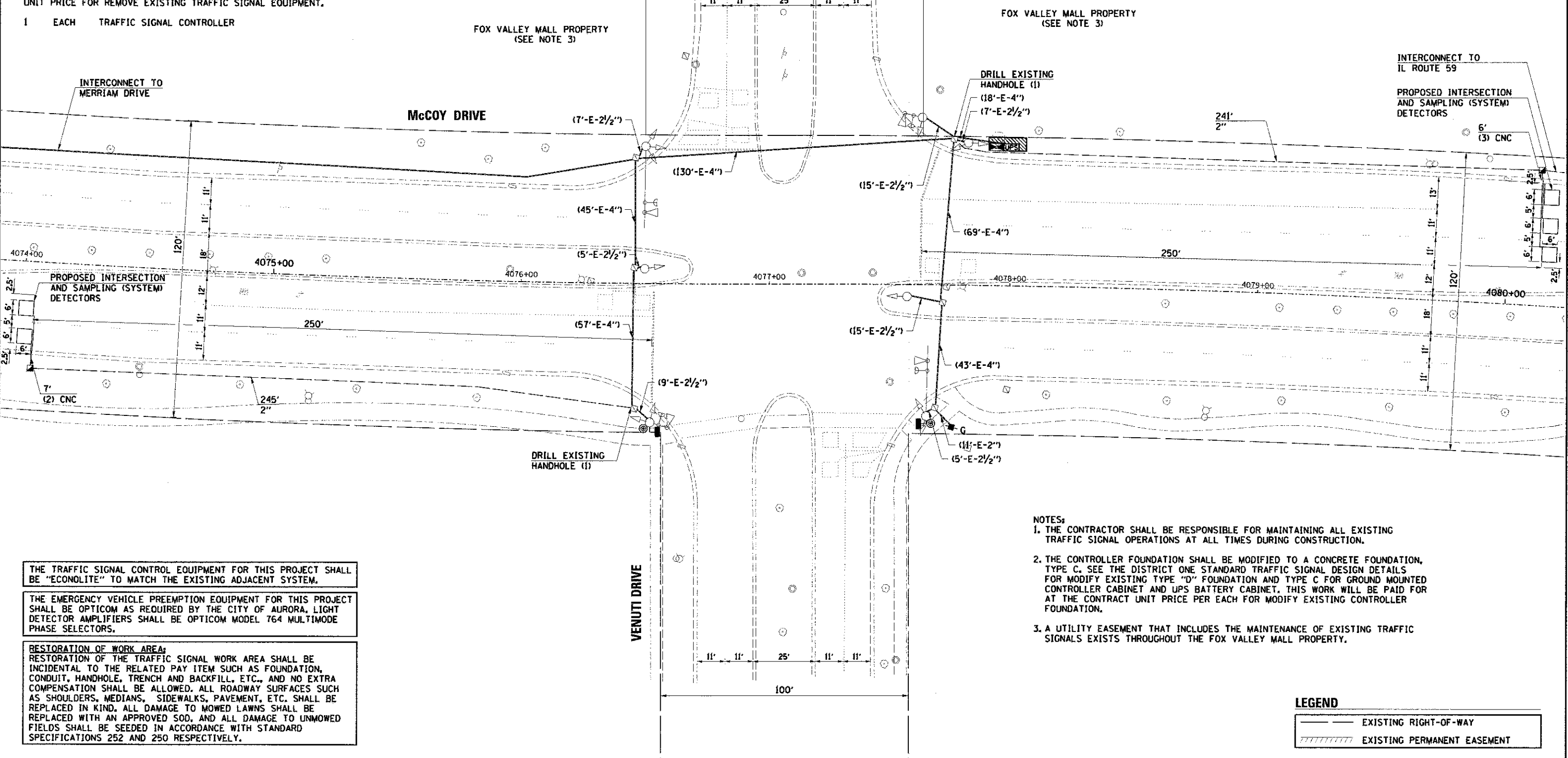

THE TRAFFIC SIGNAL CONTROL EQUIPMENT FOR THIS PROJECT SHALL BE "ECONOLITE" TO MATCH THE EXISTING ADJACENT SYSTEM.

THE EMERGENCY VEHICLE PREEMPTION EQUIPMENT FOR THIS PROJECT SHALL BE OPTICOM AS REQUIRED BY THE CITY OF AURORA. LIGHT DETECTOR AMPLIFIERS SHALL BE OPTICOM MODEL 764 MULTIMODE PHASE SELECTORS.

RESTORATION OF WORK AREA:
 RESTORATION OF THE TRAFFIC SIGNAL WORK AREA SHALL BE INCIDENTAL TO THE RELATED PAY ITEM SUCH AS FOUNDATION, CONDUIT, HANDHOLE, TRENCH AND BACKFILL, ETC., AND NO EXTRA COMPENSATION SHALL BE ALLOWED. ALL ROADWAY SURFACES SUCH AS SHOULDERS, MEDIANS, SIDEWALKS, PAVEMENT, ETC. SHALL BE REPLACED IN KIND. ALL DAMAGE TO MOWED LAWNS SHALL BE REPLACED WITH AN APPROVED SOD, AND ALL DAMAGE TO UNMOWED FIELDS SHALL BE SEEDED IN ACCORDANCE WITH STANDARD SPECIFICATIONS 252 AND 250 RESPECTIVELY.

- NOTES:
1. THE CONTRACTOR SHALL BE RESPONSIBLE FOR MAINTAINING ALL EXISTING TRAFFIC SIGNAL OPERATIONS AT ALL TIMES DURING CONSTRUCTION.
 2. THE CONTROLLER FOUNDATION SHALL BE MODIFIED TO A CONCRETE FOUNDATION, TYPE C. SEE THE DISTRICT ONE STANDARD TRAFFIC SIGNAL DESIGN DETAILS FOR MODIFY EXISTING TYPE "D" FOUNDATION AND TYPE C FOR GROUND MOUNTED CONTROLLER CABINET AND UPS BATTERY CABINET. THIS WORK WILL BE PAID FOR AT THE CONTRACT UNIT PRICE PER EACH FOR MODIFY EXISTING CONTROLLER FOUNDATION.
 3. A UTILITY EASEMENT THAT INCLUDES THE MAINTENANCE OF EXISTING TRAFFIC SIGNALS EXISTS THROUGHOUT THE FOX VALLEY MALL PROPERTY.

LEGEND

	EXISTING RIGHT-OF-WAY
	EXISTING PERMANENT EASEMENT



USER NAME	= MjFeller
DESIGNED	= MJF
REVISOR	=
DATE	= 02/21/2013
FILE NAME	= 690-10.sig89ab_venuti.dgn

CHECKED	= APS
REVISOR	=
DATE	=
FILE NAME	=

STATE OF ILLINOIS
 DEPARTMENT OF TRANSPORTATION

TRAFFIC SIGNAL MODIFICATION PLAN			
McCOY DRIVE AT VENUTI DRIVE			
SCALE:	SHEET NO.	OF SHEETS	STA. TO STA.

F.A.U. RTE.	SECTION	COUNTY	TOTAL SHEETS	SHEET NO.
US 212	11-00297-00-TL	DUPAGE	38	24
2012	CONTRACT NO.			63816
FED. ROAD DIST. NO. ILLINOIS FED. AID PROJECT				