

PLAN	SURVEYED	DATE
	PLOTTED	
	NOTE BOOK	
	FILE NAME	
	FILE NO.	

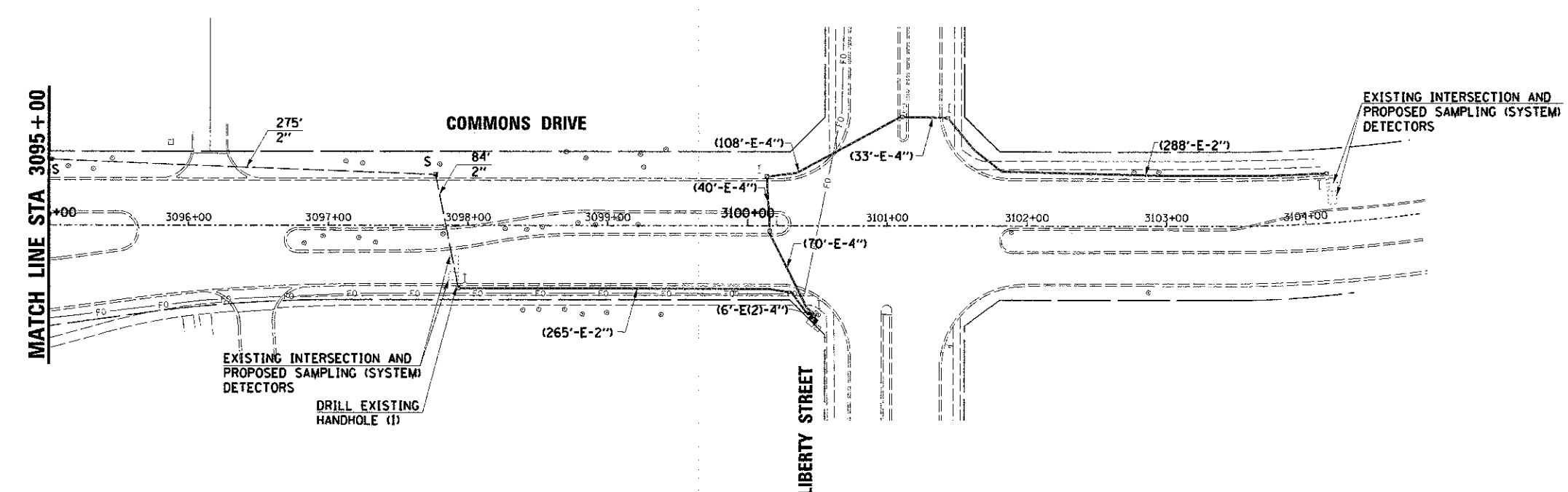

PROFILE	SURVEYED	DATE
	PLOTTED	
	NOTE BOOK	
	FILE NAME	
	FILE NO.	

THE TRAFFIC SIGNAL CONTROL EQUIPMENT FOR THIS PROJECT SHALL BE "ECONOLITE" TO MATCH THE EXISTING ADJACENT SYSTEM.

**RESTORATION OF WORK AREA:**  
 RESTORATION OF THE TRAFFIC SIGNAL WORK AREA SHALL BE INCIDENTAL TO THE RELATED PAY ITEM SUCH AS FOUNDATION, CONDUIT, HANDHOLE, TRENCH AND BACKFILL, ETC., AND NO EXTRA COMPENSATION SHALL BE ALLOWED. ALL ROADWAY SURFACES SUCH AS SHOULDERS, MEDIANS, SIDEWALKS, PAVEMENT, ETC. SHALL BE REPLACED IN KIND. ALL DAMAGE TO MOWED LAWNS SHALL BE REPLACED WITH AN APPROVED SOD, AND ALL DAMAGE TO UNMOWED FIELDS SHALL BE SEEDED IN ACCORDANCE WITH STANDARD SPECIFICATIONS 252 AND 250 RESPECTIVELY.

EXISTING INTERSECTION AND PROPOSED SAMPLING (SYSTEM) DETECTORS  
 DRILL EXISTING HANDHOLE (1)

LEGEND	
-----	EXISTING RIGHT-OF-WAY
-----	EXISTING PERMANENT EASEMENT



USER NAME = MFallon	DESIGNED - MJF	REVISED -
PLCT SCALE =	CHECKED - APS	REVISED -
PLCT DATE = 2/22/2013	DATE - 02/21/2013	REVISED -
FILE NAME = B90_10.sigint03.dgn		REVISED -

STATE OF ILLINOIS  
 DEPARTMENT OF TRANSPORTATION

INTERCONNECT PLAN  
 (SHEET 3 OF 5)

SCALE:	SHEET NO.	OF SHEETS	STA.	TO STA.
--------	-----------	-----------	------	---------

F.A.U. RTE. 1537 4342	SECTION 11-00297-00-TL	COUNTY	TOTAL SHEETS 38	SHEET NO. 30
FED. ROAD DIST. NO.	ILLINOIS FED. AID PROJECT	DUPAGE	CONTRACT NO. 63816	