

# STAGE 2

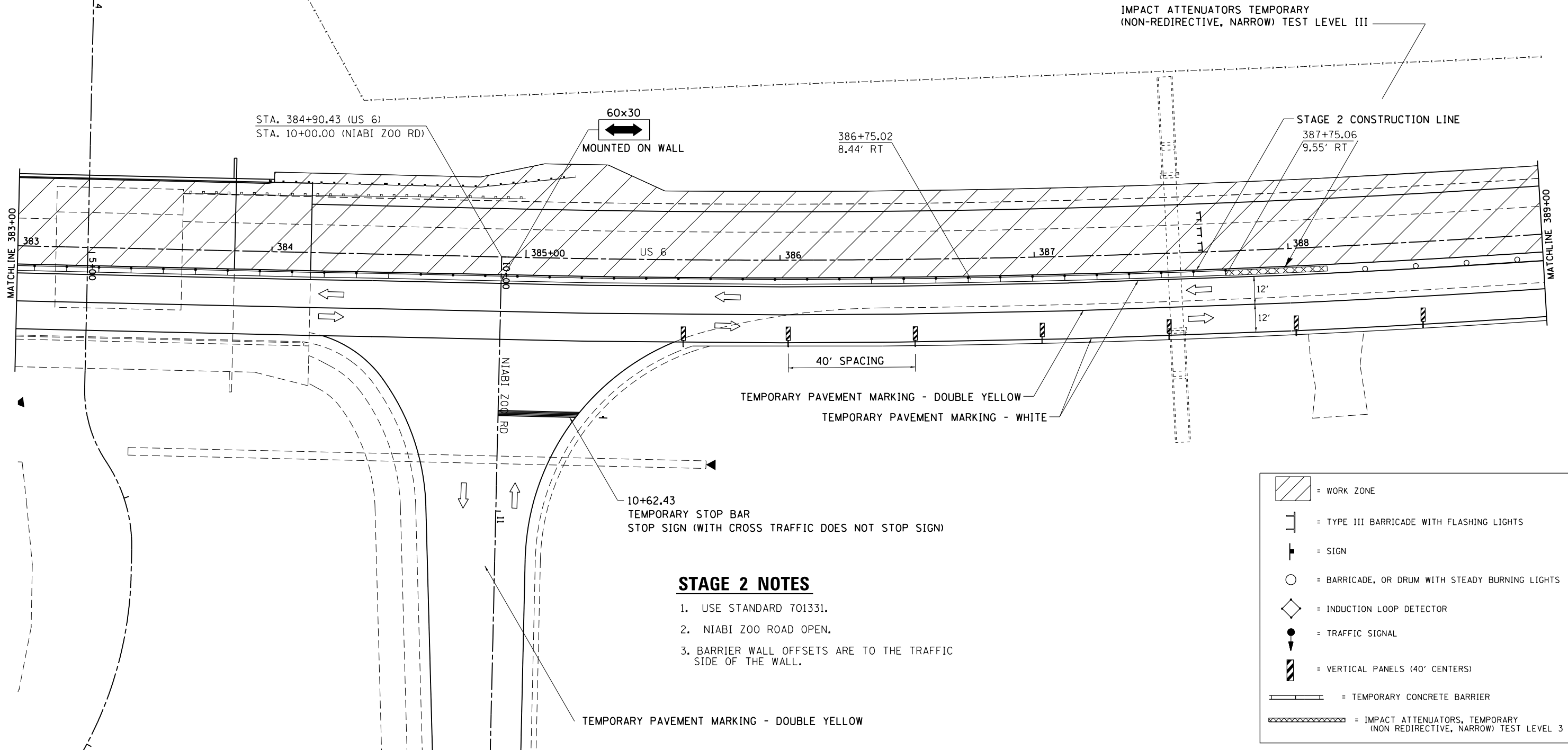

## STAGE 2 NOTES

1. USE STANDARD 701331.
2. NIABI ZOO ROAD OPEN.
3. BARRIER WALL OFFSETS ARE TO THE TRAFFIC SIDE OF THE WALL.

|   |                                      |            |           |
|---|--------------------------------------|------------|-----------|
| FILE NAME =   | USER NAME = renkesw                  | DESIGNED - | REVISED - |
| ct:\pw\work\p\idot\renkesw\dms36691\0205584-sht-staging.dgn |                                      | DRAWN -    | REVISED - |
| Default   | PLOT SCALE = 40.0000' / in.          | CHECKED -  | REVISED - |
|   | PLOT DATE = Wed Dec 19 10:49:19 2012 | DATE -     | REVISED - |

**STATE OF ILLINOIS  
DEPARTMENT OF TRANSPORTATION**

|                |                             |
|----------------|-----------------------------|
| <b>US 6</b>    |                             |
| <b>STAGE 2</b> |                             |
| SCALE: _____   | SHEET _____ OF _____ SHEETS |
| STA. _____     | TO STA. _____               |

|                    |         |             |                           |           |
|--------------------|---------|-------------|---------------------------|-----------|
| F.A.L. RTE.        | SECTION | COUNTY      | TOTAL SHEETS              | SHEET NO. |
| 5789               | 40BR    | ROCK ISLAND | 225                       | 74        |
| CONTRACT NO. 64341 |         |             | ILLINOIS FED. AID PROJECT |           |