

WATER MAIN DETAIL

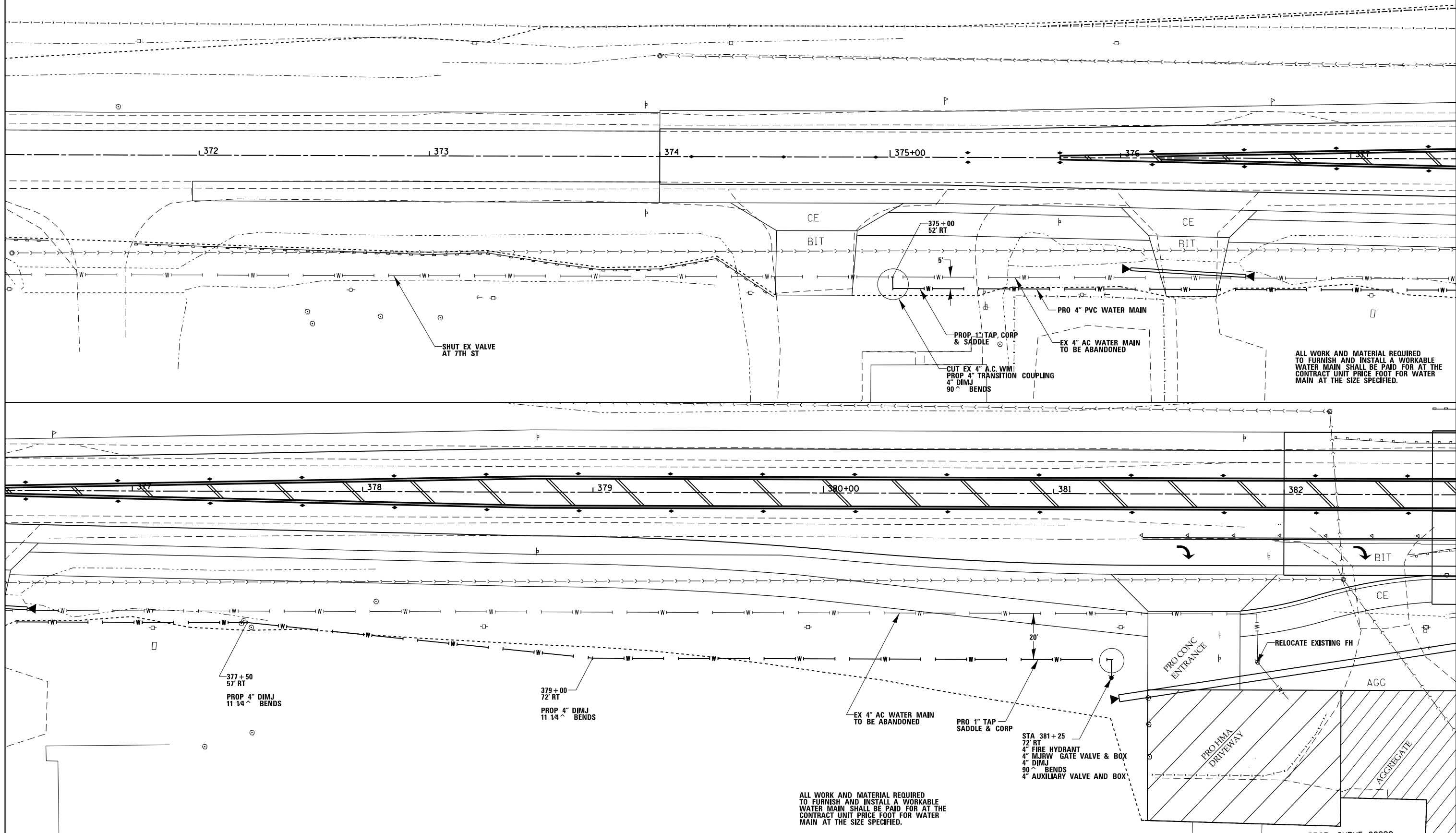

ALL WORK AND MATERIAL REQUIRED TO FURNISH AND INSTALL A WORKABLE WATER MAIN SHALL BE PAID FOR AT THE CONTRACT UNIT PRICE FOOT FOR WATER MAIN AT THE SIZE SPECIFIED.

ALL WORK AND MATERIAL REQUIRED TO FURNISH AND INSTALL A WORKABLE WATER MAIN SHALL BE PAID FOR AT THE CONTRACT UNIT PRICE FOOT FOR WATER MAIN AT THE SIZE SPECIFIED.

FILE NAME =	USER NAME = renkesw	DESIGNED -	REVISED -
ei:\pw\work\p\idot\renkesw\dms36691\0208584-sht-details.dgn		DRAWN -	REVISED -
Default	PLOT SCALE = 40.0000' / in.	CHECKED -	REVISED -
	PLOT DATE = Wed Dec 19 11:19:57 2012	DATE -	REVISED -

**STATE OF ILLINOIS
DEPARTMENT OF TRANSPORTATION**

WATER MAIN DETAIL

SCALE: SHEET OF SHEETS STA. TO STA.

F.A.U. RTE.	SECTION	COUNTY	TOTAL SHEETS	SHEET NO.
5789	40BR	ROCK ISLAND	225	118
CONTRACT NO. 64341				
ILLINOIS FED. AID PROJECT				

PROP. CURVE 88220