

NORTH CURB LINE

| Location | Station | Offset | Theoretical Grade Elevations |
|---------------------------|-----------|--------|------------------------------|
| West end of E. Appr. Slab | 383+85.38 | -27.00 | 575.81 |
| K | 383+95.38 | -27.00 | 575.86 |
| L | 384+05.38 | -27.00 | 575.90 |
| East end of E. Appr. Slab | 384+15.38 | -27.00 | 575.94 |

NORTH EDGE OF ROADWAY

| Location | Station | Offset | Theoretical Grade Elevations |
|---------------------------|-----------|--------|------------------------------|
| West end of E. Appr. Slab | 383+85.38 | -19.00 | 575.98 |
| K | 383+95.38 | -19.00 | 576.02 |
| L | 384+05.38 | -19.00 | 576.07 |
| East end of E. Appr. Slab | 384+15.38 | -19.00 | 576.10 |

NORTH EDGE OF MEDIAN

| Location | Station | Offset | Theoretical Grade Elevations |
|---------------------------|-----------|--------|------------------------------|
| West end of E. Appr. Slab | 383+85.38 | -7.00 | 576.17 |
| K | 383+95.38 | -7.00 | 576.21 |
| L | 384+05.38 | -7.00 | 576.25 |
| East end of E. Appr. Slab | 384+15.38 | -7.00 | 576.29 |

☉ ROADWAY & PROFILE GRADE

| Location | Station | Offset | Theoretical Grade Elevations |
|---------------------------|-----------|--------|------------------------------|
| West end of E. Appr. Slab | 383+85.38 | 0.00 | 576.28 |
| K | 383+95.38 | 0.00 | 576.32 |
| L | 384+05.38 | 0.00 | 576.36 |
| East end of E. Appr. Slab | 384+15.38 | 0.00 | 576.40 |

STAGE CONST. JOINT & SOUTH EDGE OF MEDIAN

| Location | Station | Offset | Theoretical Grade Elevations |
|---------------------------|-----------|--------|------------------------------|
| West end of E. Appr. Slab | 383+85.38 | 7.00 | 576.39 |
| K | 383+95.38 | 7.00 | 576.43 |
| L | 384+05.38 | 7.00 | 576.47 |
| East end of E. Appr. Slab | 384+15.38 | 7.00 | 576.51 |

SOUTH EDGE OF ROADWAY

| Location | Station | Offset | Theoretical Grade Elevations |
|---------------------------|-----------|--------|------------------------------|
| West end of E. Appr. Slab | 383+85.38 | 19.00 | 576.20 |
| K | 383+95.38 | 19.00 | 576.24 |
| L | 384+05.38 | 19.00 | 576.29 |
| East end of E. Appr. Slab | 384+15.38 | 19.00 | 576.32 |

SOUTH EDGE OF RIGHT TURN LANE

| Location | Station | Offset | Theoretical Grade Elevations |
|---------------------------|-----------|--------|------------------------------|
| West end of E. Appr. Slab | 383+85.38 | 31.00 | 575.95 |
| K | 383+95.38 | 31.00 | 575.99 |
| L | 384+05.38 | 31.00 | 576.04 |
| East end of E. Appr. Slab | 384+15.38 | 31.00 | 576.07 |

SOUTH CURB LINE

| Location | Station | Offset | Theoretical Grade Elevations |
|---------------------------|-----------|--------|------------------------------|
| West end of E. Appr. Slab | 383+85.38 | 35.00 | 575.87 |
| K | 383+95.38 | 35.00 | 575.91 |
| L | 384+05.38 | 35.00 | 575.95 |
| East end of E. Appr. Slab | 384+15.38 | 35.00 | 575.99 |

NORTH EDGE OF SIDEWALK

| Location | Station | Offset | Theoretical Grade Elevations |
|---------------------------|-----------|--------|------------------------------|
| West end of E. Appr. Slab | 383+85.38 | 36.58 | 575.83 |
| K | 383+95.38 | 36.58 | 575.88 |
| L | 384+05.38 | 36.58 | 575.92 |
| East end of E. Appr. Slab | 384+15.38 | 36.58 | 575.96 |

**OUTSIDE EDGE OF SOUTH DECK
(Including flared deck)**

| Location | Station | Offset | Theoretical Grade Elevations |
|---------------------------|-----------|--------|------------------------------|
| West end of E. Appr. Slab | 383+85.38 | 47.42 | 575.61 |
| Beginning of Flare | 383+94.21 | 47.42 | 575.65 |
| K | 383+95.38 | 47.69 | 575.64 |
| L | 384+05.38 | 49.99 | 575.65 |
| East end of E. Appr. Slab | 384+15.38 | 52.29 | 575.63 |

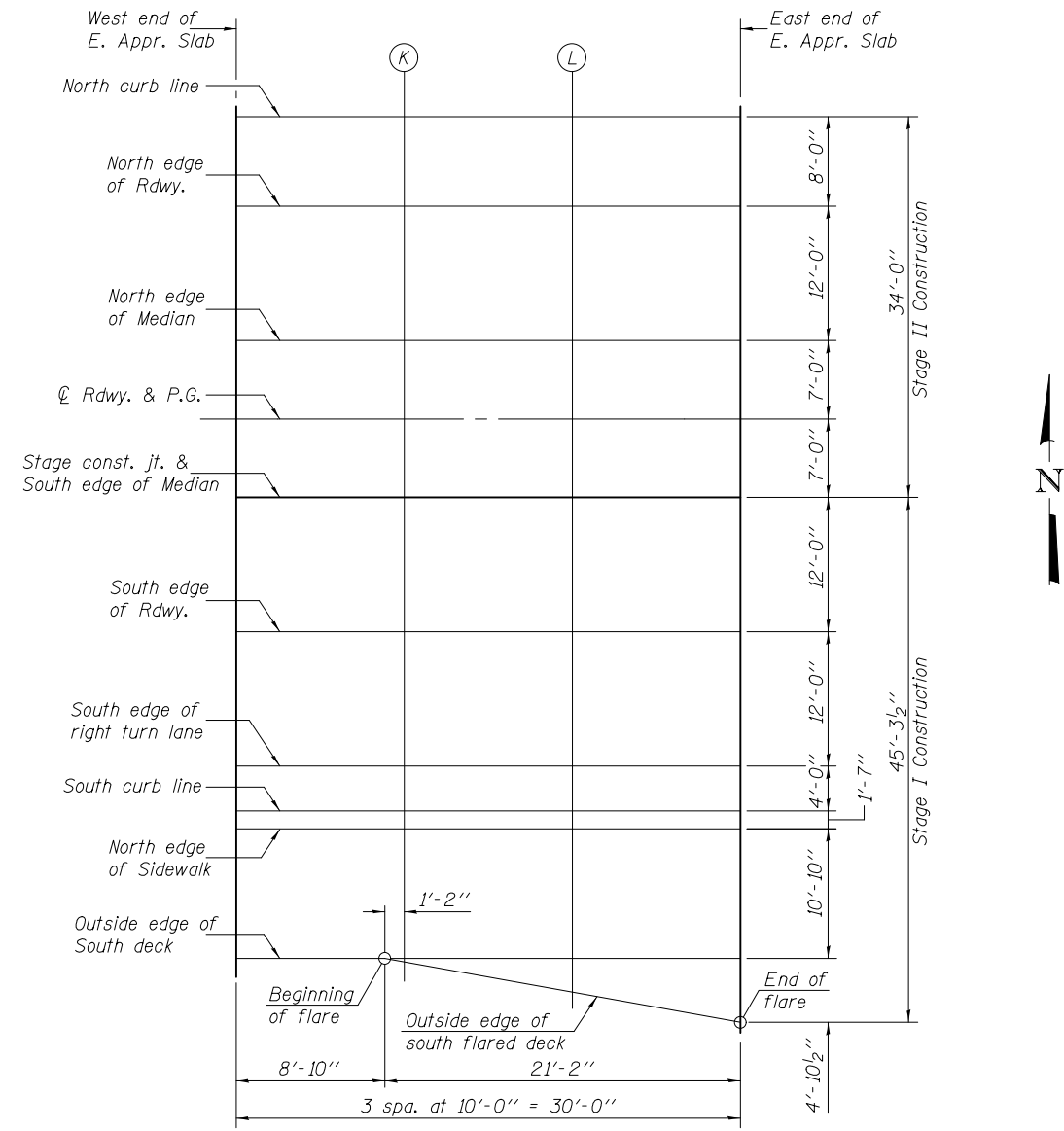

PLAN

DESIGNED - STEPHEN M. RYAN
 CHECKED - RAY AHANCHI
 DRAWN - h.t. duong
 CHECKED - S.M.R. / G.R.A.

EXAMINED *Joanne F. [Signature]*
 ACTING ENGINEER OF BRIDGE DESIGN
 PASSED *Carl [Signature]*
 ACTING ENGINEER OF BRIDGES AND STRUCTURES

DATE - MARCH 12, 2013
 REVISED
 REVISED

**STATE OF ILLINOIS
 DEPARTMENT OF TRANSPORTATION**

**TOP OF EAST APPROACH SLAB ELEVATIONS
 STRUCTURE NO. 081-0163**

SHEET NO. 9 OF 30 SHEETS

| | | | | |
|--------------------|---------|-------------|--------------|-----------|
| F.A.U. RTE. | SECTION | COUNTY | TOTAL SHEETS | SHEET NO. |
| 5789 | 40 BR | ROCK ISLAND | 225 | 130 |
| CONTRACT NO. 64341 | | | | |

ILLINOIS FED. AID PROJECT