

DATE	
BY	
FINAL SURVEY	SURVEYED
NOTE BOOK	PLOTTED
NO.	TEMPLATE
	AREAS
	CHECKED

DATE	
BY	
ORIGINAL SURVEY	SURVEYED
NOTE BOOK	PLOTTED
NO.	TEMPLATE
	AREAS
	CHECKED

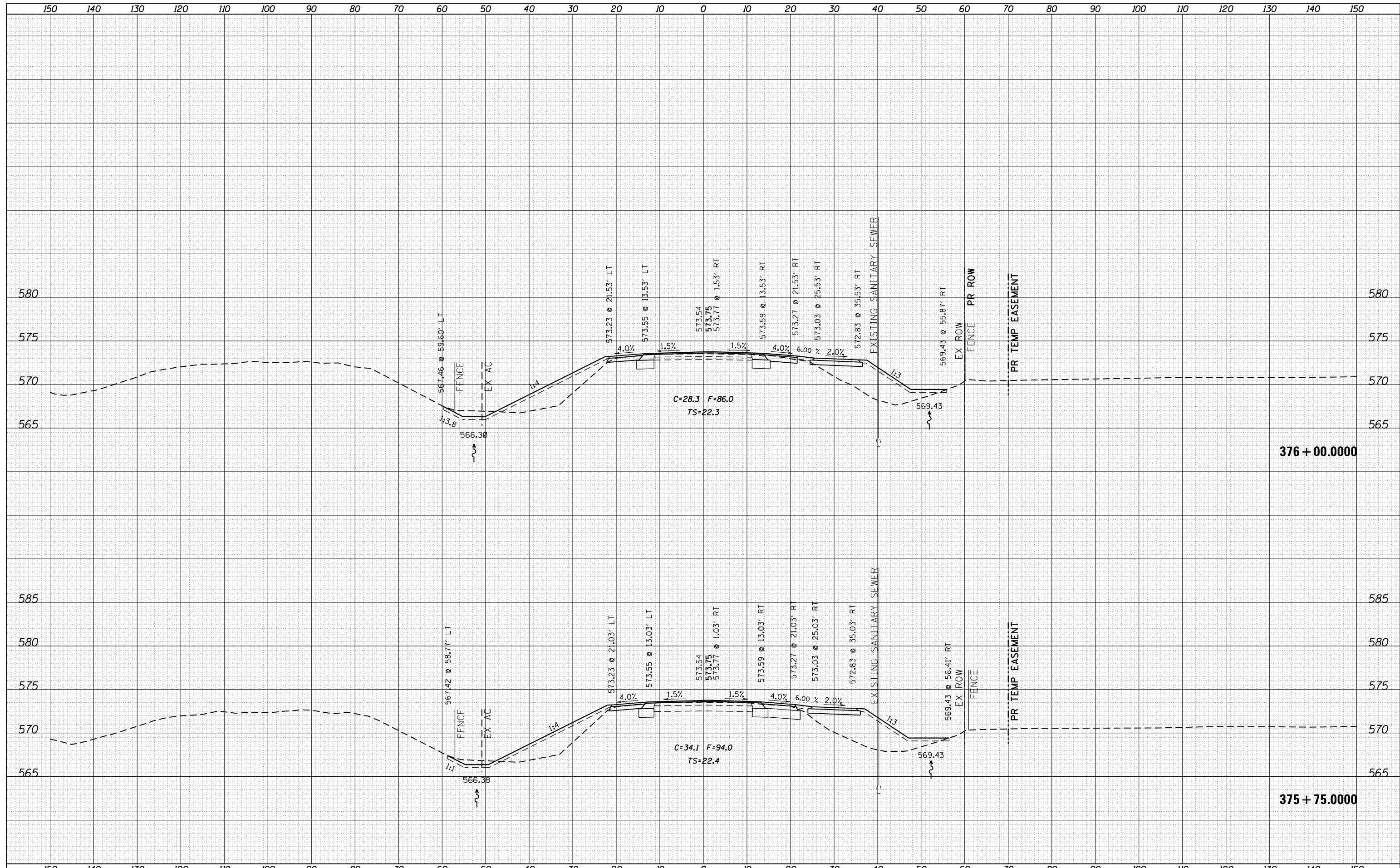

FILE NAME =	USER NAME = renkesw	DESIGNED -	REVISED -	<b>STATE OF ILLINOIS</b> <b>DEPARTMENT OF TRANSPORTATION</b>	<b>U.S. 6 CROSS SECTIONS</b>	F.A.U. RTE.	SECTION	COUNTY	TOTAL SHEETS	SHEET NO.	
Default	Plot Scale = 20.0000' / in.	CHECKED -	REVISED -			5789	40BR	ROCK ISLAND	225	172	
	PLOT DATE = Thu Dec 20 09:35:04 2012	DATE -	REVISED -			CONTRACT NO. 64341		ILLINOIS FED. AID PROJECT			
						SCALE:	SHEET	OF	SHEETS	STA. 375+75.0000 TO STA. 376+00.0000	