

**LEGEND**

- TREE REMOVAL
- PROPOSED DRAINAGE FLOW DIRECTION
- EXISTING DRAINAGE FLOW DIRECTION

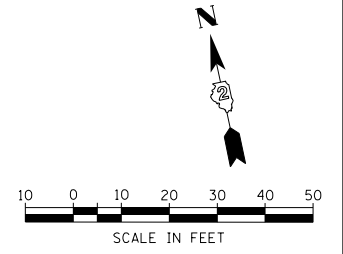

PLAN	SURVEYED	DATE
	PLOTTED	
	GRADES CHECKED	
	STRUCTURE NOTATIONS CHECKED	
	NO.	

PROFILE	SURVEYED	DATE
	PLOTTED	
	GRADES CHECKED	
	STRUCTURE NOTATIONS CHECKED	
	NO.	

FILE NAME = D:\Projects\Rock\_Island\64023.L74\_280.Bridge\_Replacement\_Over\_Coal\_Creek\Chad\_Spreeman\Phase 1\Submittals\100%\_Submit\1\CC-DGN\CAD\_Civil\CAD00\_Sheets\0286307\_sht.pln.03.dgn

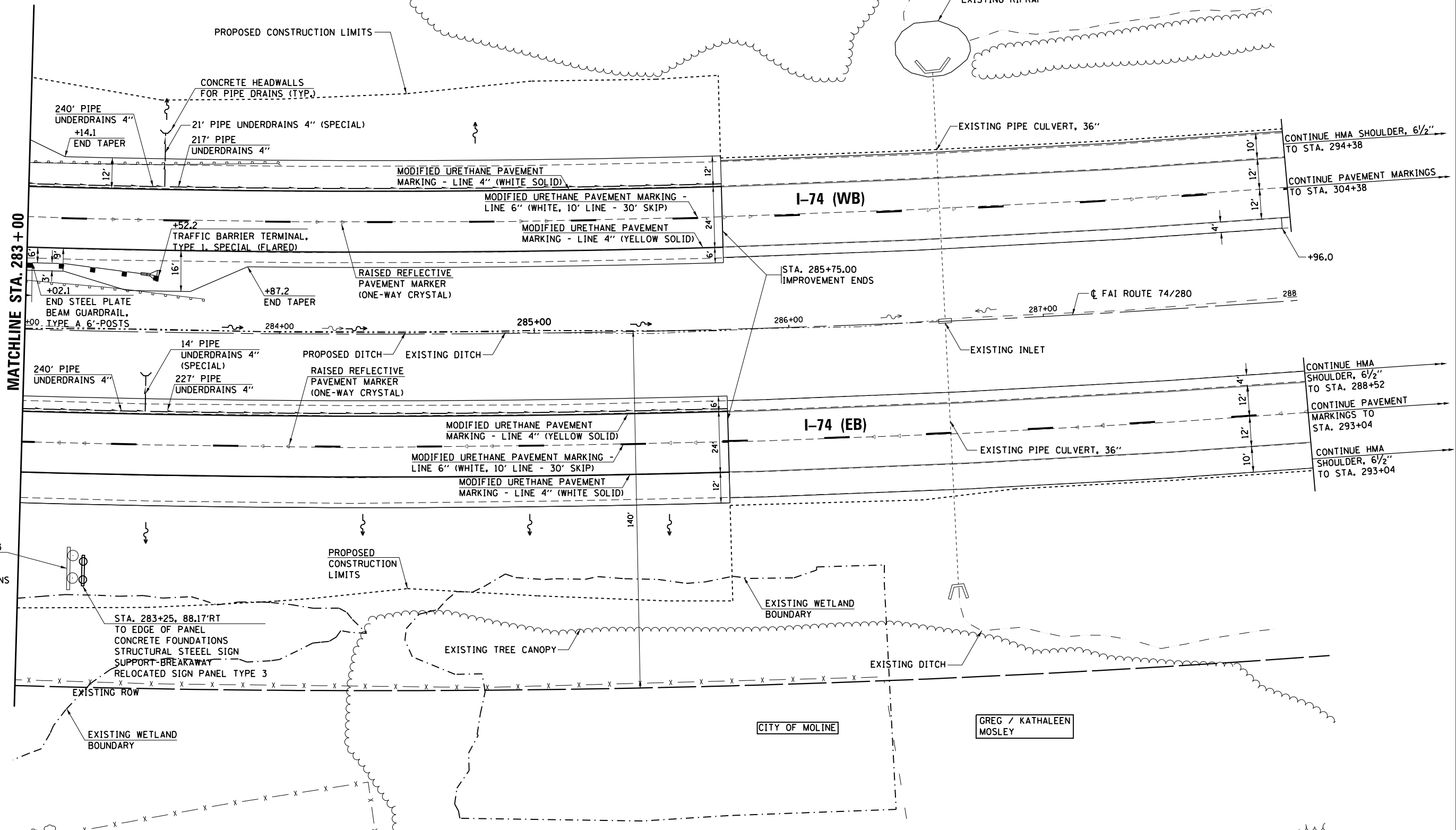

USER NAME = ankneyde	DESIGNED KMB	REVISED
	DRAWN TAY	REVISED
	CHECKED KAC	REVISED
	DATE 3-12-2013	REVISED

**STATE OF ILLINOIS  
DEPARTMENT OF TRANSPORTATION**

**FAI ROUTE 74/280 OVER COAL CREEK  
PROPOSED ROADWAY PLANS**

SCALE: 1" = 20' SHEET 3 OF 3 SHEETS STA. 283+00 TO STA. 288+00

F.A.I. RTE.	SECTION	COUNTY	TOTAL SHEETS	SHEET NO.
*	**	***	290	148
CONTRACT NO. 64D23				