

D:\Projects\Rock_Island\64023.L74.288.Bridge Replacement\Over_Coal_Creek\Chad Spreeman\Phase II\Submittals\100% Submittal\CC-DGN\CAD\Civil\CADD_Sheets\0286307-sht-stage1.dgn
 Fr: Mar 15 14:17:16 2013

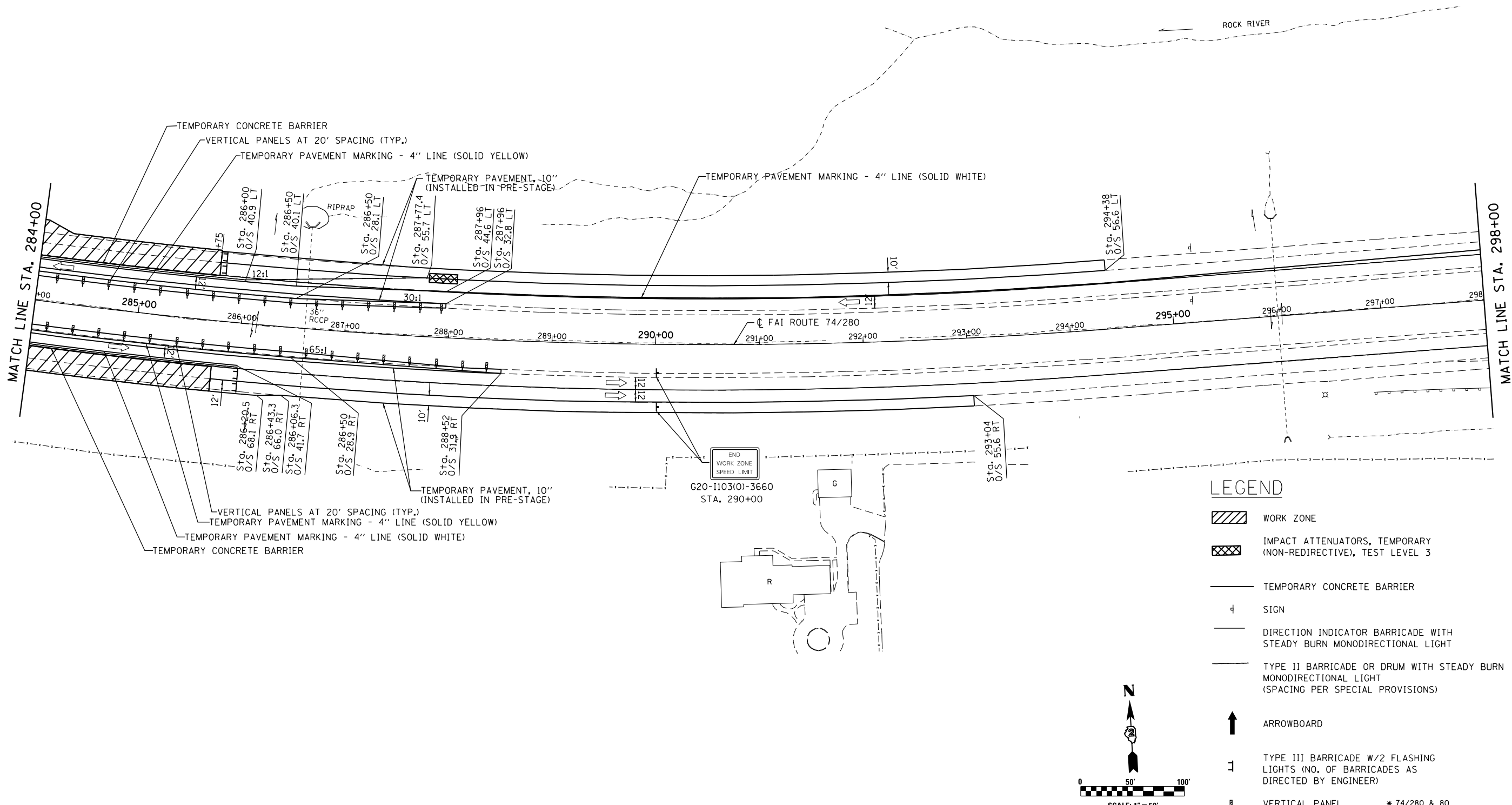

LEGEND

- WORK ZONE
- IMPACT ATTENUATORS, TEMPORARY (NON-REDIRECTIVE), TEST LEVEL 3
- TEMPORARY CONCRETE BARRIER
- SIGN
- DIRECTION INDICATOR BARRICADE WITH STEADY BURN MONODIRECTIONAL LIGHT
- TYPE II BARRICADE OR DRUM WITH STEADY BURN MONODIRECTIONAL LIGHT (SPACING PER SPECIAL PROVISIONS)
- ARROWBOARD
- TYPE III BARRICADE W/2 FLASHING LIGHTS (NO. OF BARRICADES AS DIRECTED BY ENGINEER)
- VERTICAL PANEL

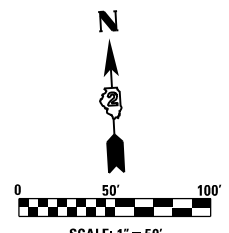

DESIGNED - GRE	REVISED -
CHECKED - GRE	REVISED -
DRAWN - ST	REVISED -
PLotted DATE - Fr: Mar 15 14:17:16 2013	REVISED -

STATE OF ILLINOIS
DEPARTMENT OF TRANSPORTATION

FAI ROUTE 74 / 280 OVER COAL CREEK
MAINTENANCE OF TRAFFIC PLAN - STAGE 1
 SCALE: 1"=50' SHEET NO. OF SHEETS STA. 284+00 TO STA. 298+00

F.A.I. RTE.	SECTION	COUNTY	TOTAL SHEETS	SHEET NO.
*	**	***	290	153
CONTRACT NO. 64D23				
ILLINOIS FED. AID PROJECT				

* 74/280 & 80
 ** (81-2, 81-3, 37-1, 37-2-1) RS-1 & 81-3BR
 *** ROCK ISLAND/HENRY COUNTY