

# FOR INFORMATION ONLY

FOR INFORMATION ONLY  
W.B. I-280 ENTRANCE RAMP

FAI 74280 (6-74280)  
Section (81-2, 81-3, 37-1, 37-2-1) RS-1 & 81-3BR  
Henry & Rock Island County  
Job No. D-92-063-07  
Contract No. 64D23  
Sheet \_\_\_\_\_ of \_\_\_\_\_

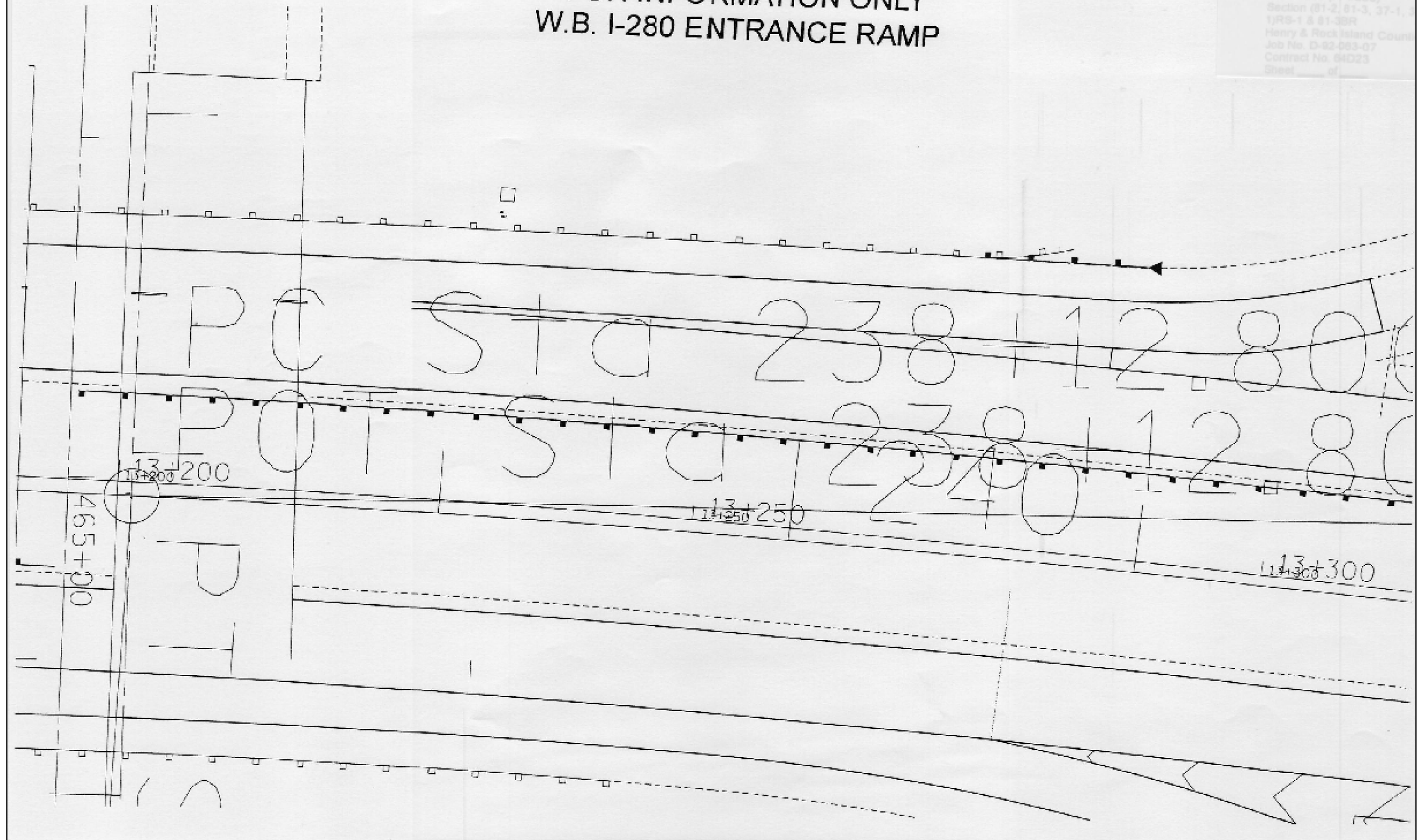

FILE NAME =	USER NAME = hensonke	DESIGNED -	REVISED -
ct:\pwork\pwork\hensonke\0117904\0206307-sht-details.dgn		DRAWN -	REVISED -
Default	PLOT SCALE = 48.0000' / in.	CHECKED -	REVISED -
	PLOT DATE = Fri May 15 09:29:27 2013	DATE -	REVISED -

STATE OF ILLINOIS  
DEPARTMENT OF TRANSPORTATION

FOR INFORMATION ONLY

SCALE: SHEET OF SHEETS STA. TO STA.

\* 74/280 & 80  
\*\* (81-2, 81-3, 37-1, 37-2-1) RS-1 & 81-3BR  
\*\*\* ROCK ISLAND/HENRY COUNTY

F.A.I. RTE.	SECTION	COUNTY	TOTAL SHEETS	SHEET NO.
*	**	***	290	212
			CONTRACT NO. 64D23	
ILLINOIS FED. AID PROJECT				