

FOR INFORMATION ONLY

FOR INFORMATION ONLY
 W.B. I-280 ENTRANCE RAMP .45'

FAI 74/280 (I-74/280)
 Section (81-2, 81-3, 37-1,
 1)RS-1 & 81-3BR
 Henry & Rock Island Coun
 Job No. D-82-083-07
 Contract No. 64D23
 Sheet ___ of ___

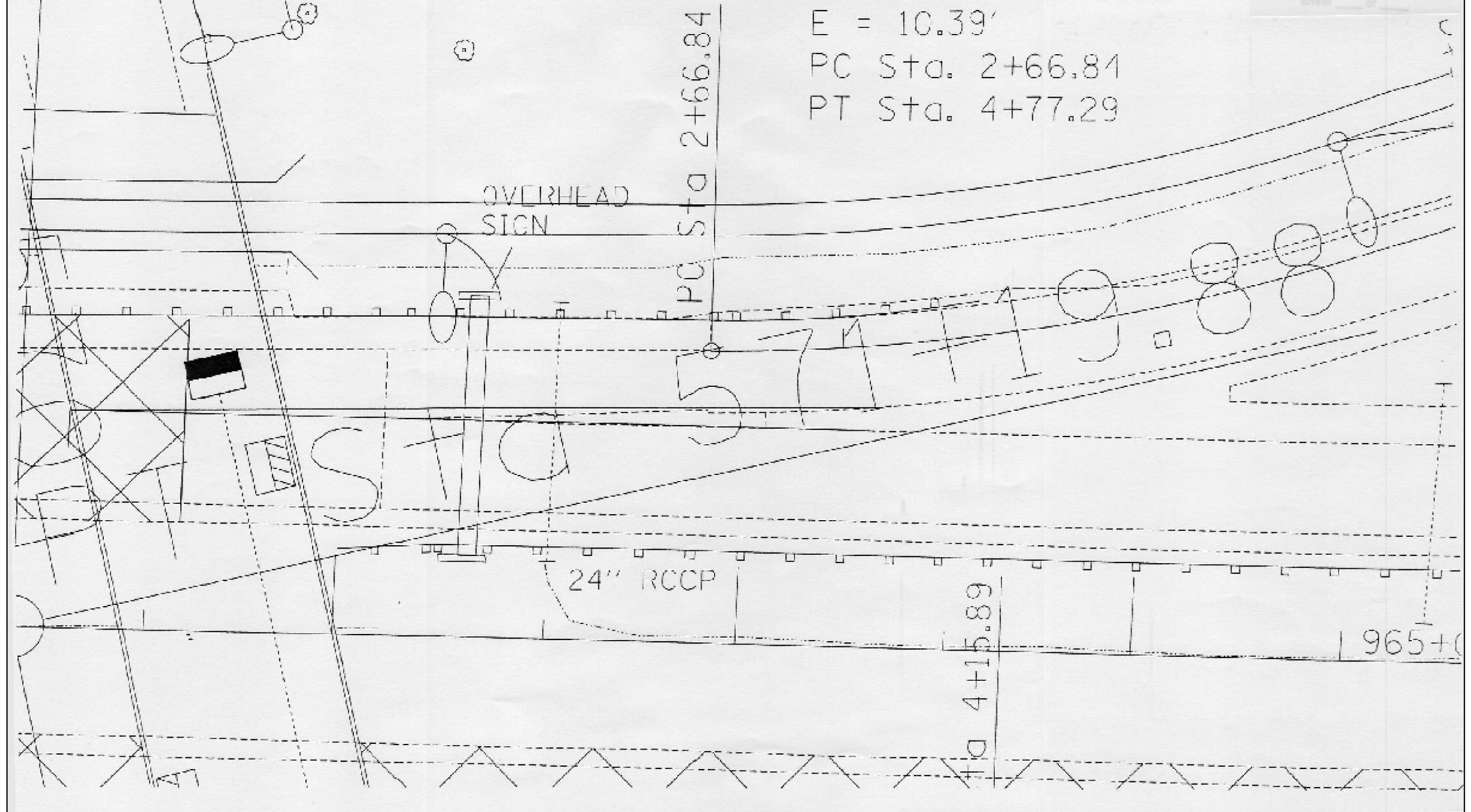

E = 10.39'
 PC Sta. 2+66.84
 PT Sta. 4+77.29

24" RCCP

* 74/280 & 80
 ** (81-2, 81-3, 37-1, 37-2-1) RS-1 & 81-3BR
 *** ROCK ISLAND/HENRY COUNTY

FILE NAME =	USER NAME = hensonke	DESIGNED -	REVISED -
ct:\pwork\pwork\hensonke\d0117904\0206307-sht-details.dgn		DRAWN -	REVISED -
Default	PLOT SCALE = 48.0000' / in.	CHECKED -	REVISED -
	PLOT DATE = Fri May 15 09:39:14 2013	DATE -	REVISED -

STATE OF ILLINOIS
 DEPARTMENT OF TRANSPORTATION

FOR INFORMATION ONLY

SCALE: SHEET OF SHEETS STA. TO STA.

F.A.I. RTE.	SECTION	COUNTY	TOTAL SHEETS	SHEET NO.
*	**	***	290	217
CONTRACT NO. 64D23			ILLINOIS FED. AID PROJECT	