

PLAN	SURVEYED	BY	DATE
	PLOTTED		
	ALIGNED		
	CHECKED		
	FILED		
	NO.		

PROFILE	SURVEYED	BY	DATE
	PLOTTED		
	GRADES CHECKED		
	STRUCTURE NOTATIONS CHECKED		
	NO.		

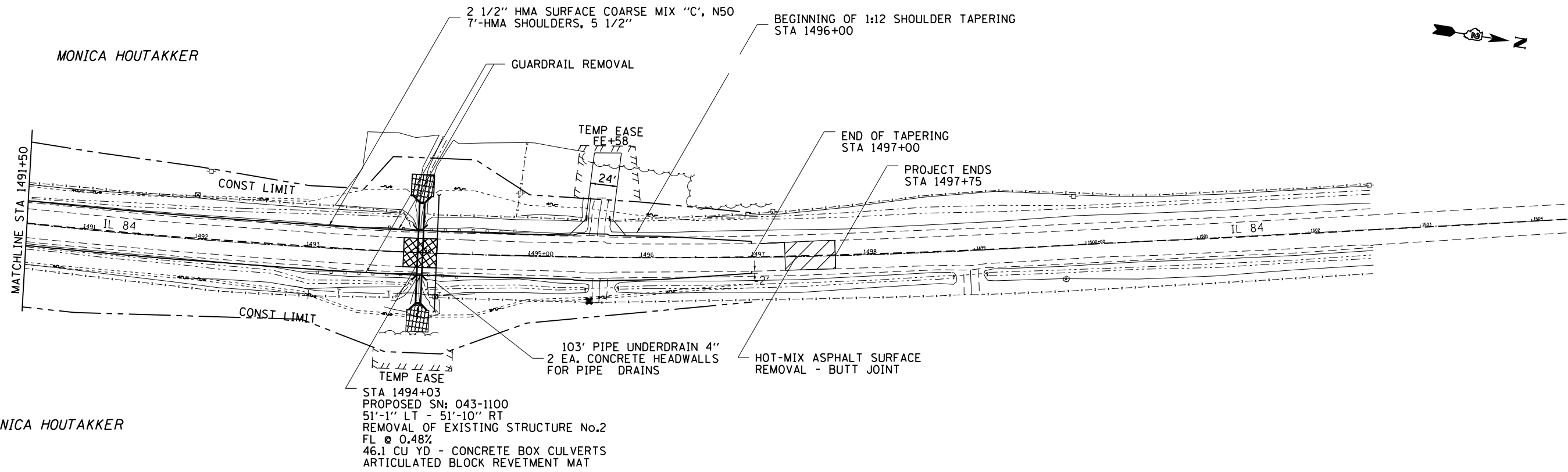

MONICA HOUTAKKER

MONICA HOUTAKKER

STA 1494+03
 PROPOSED SN: 043-1100
 51'-1" LT - 51'-10" RT
 REMOVAL OF EXISTING STRUCTURE No.2
 FL @ 0.48%
 46.1 CU YD - CONCRETE BOX CULVERTS
 ARTICULATED BLOCK REVETMENT MAT

✕ = TREE REMOVAL

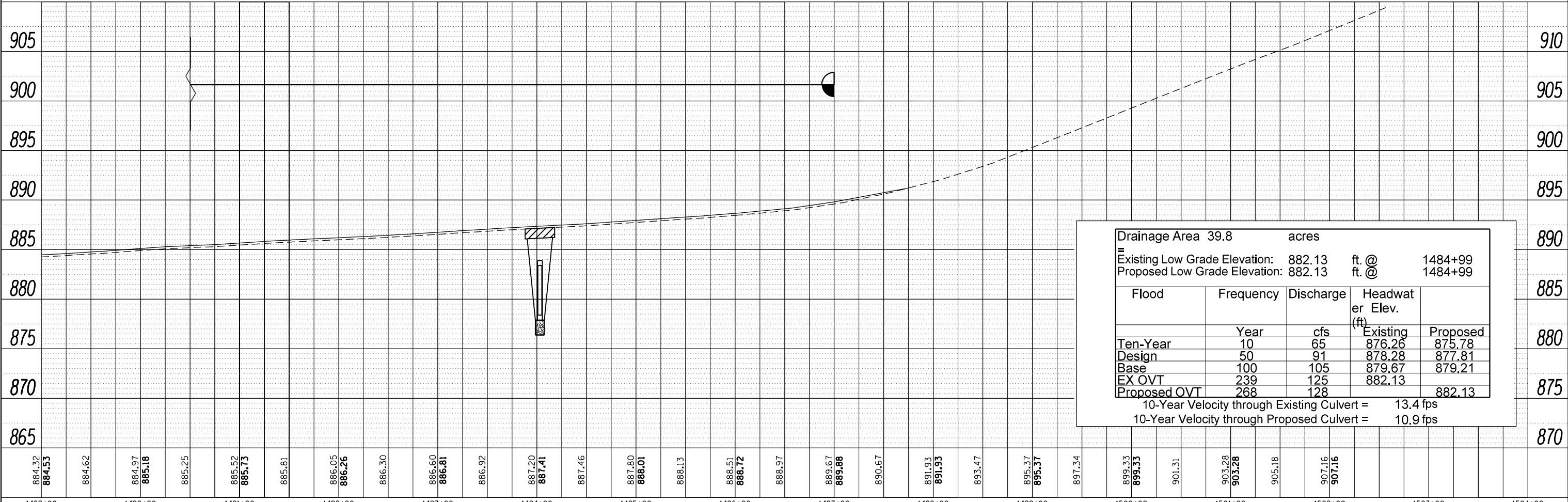

Drainage Area 39.8 acres				
Existing Low Grade Elevation:		882.13	ft. @	1484+99
Proposed Low Grade Elevation:		882.13	ft. @	1484+99
Flood	Frequency	Discharge	Headwater Elev.	
	Year	cfs	Existing	Proposed
Ten-Year	10	65	876.26	875.78
Design	50	91	878.28	877.81
Base	100	105	879.67	879.21
EX OVT	239	125	882.13	
Proposed OVT	268	128		882.13
10-Year Velocity through Existing Culvert = 13.4 fps				
10-Year Velocity through Proposed Culvert = 10.9 fps				

FILE NAME =	USER NAME =	DESIGNED -	REVISED -	STATE OF ILLINOIS DEPARTMENT OF TRANSPORTATION	IL 84 Plan and Profile	F.A.P. RTE.	SECTION	COUNTY	TOTAL SHEETS	SHEET NO.	
c:\pwork\pwork\pwork\dossdd\0233029\0201410	sh-t-plan.dgn	DRAWN -	REVISED -			570	101T	JO DAVIES	64	22	
	PLOT SCALE = 100.0000' / in.	CHECKED -	REVISED -			CONTRACT NO. 64F75					
	PLOT DATE = Tue Jan 22 13:37:17 2013	DATE -	REVISED -			ILLINOIS FED. AID PROJECT					