

**DETAIL A**  
(Typical Treated Timber Splices)

SPLICE LOCATED BETWEEN GUARDRAIL POSTS  
treated timber splice plate 2x12 (50x300),  
actual size 1 1/2x1 1/2 (40x290), 24(600) long  
with 8 evenly spaced 1/2(M12) galvanized  
bolts with nuts & washers.

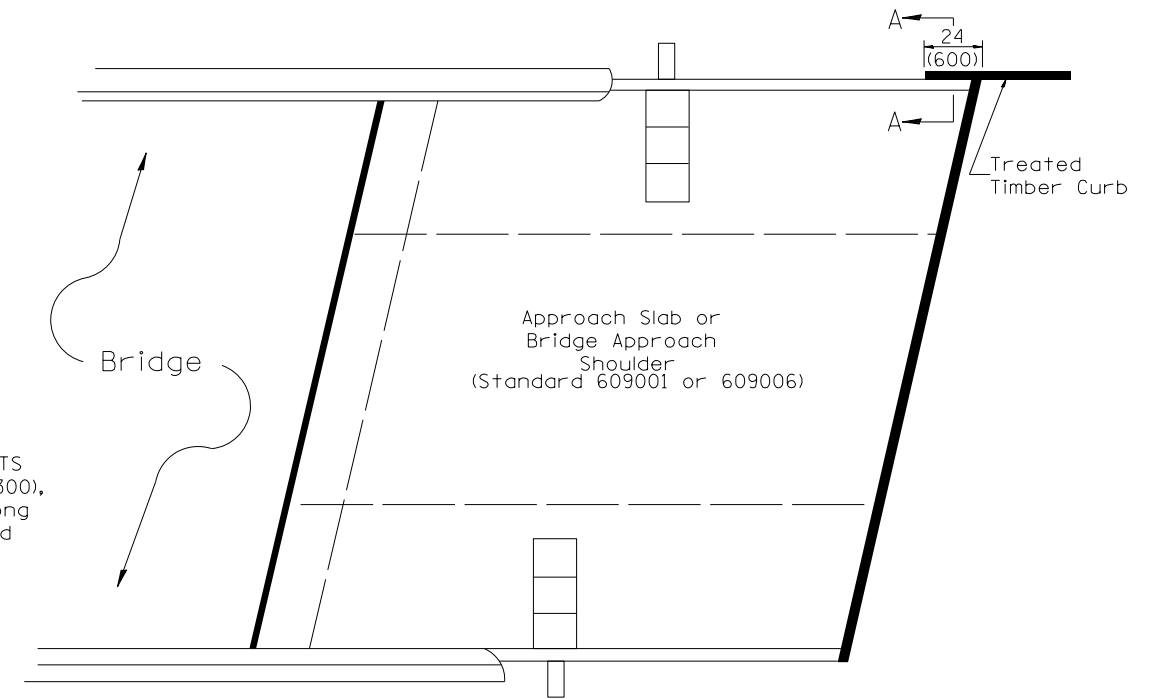

**PLAN VIEW**  
**APPROACH SLAB OR BRIDGE APPROACH SHOULDER**  
(STANDARD 609001 or 609006)

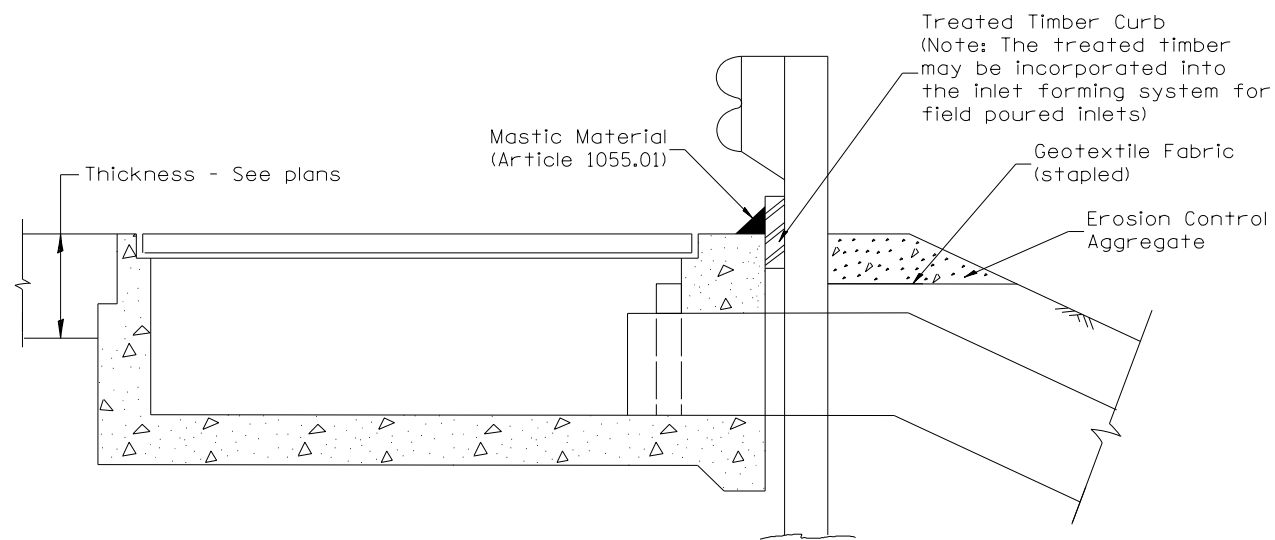

**TYPICAL SECTION WITH EROSION CONTROL CURB**  
**AT INLETS TYPE E & F (STANDARD 610001)**

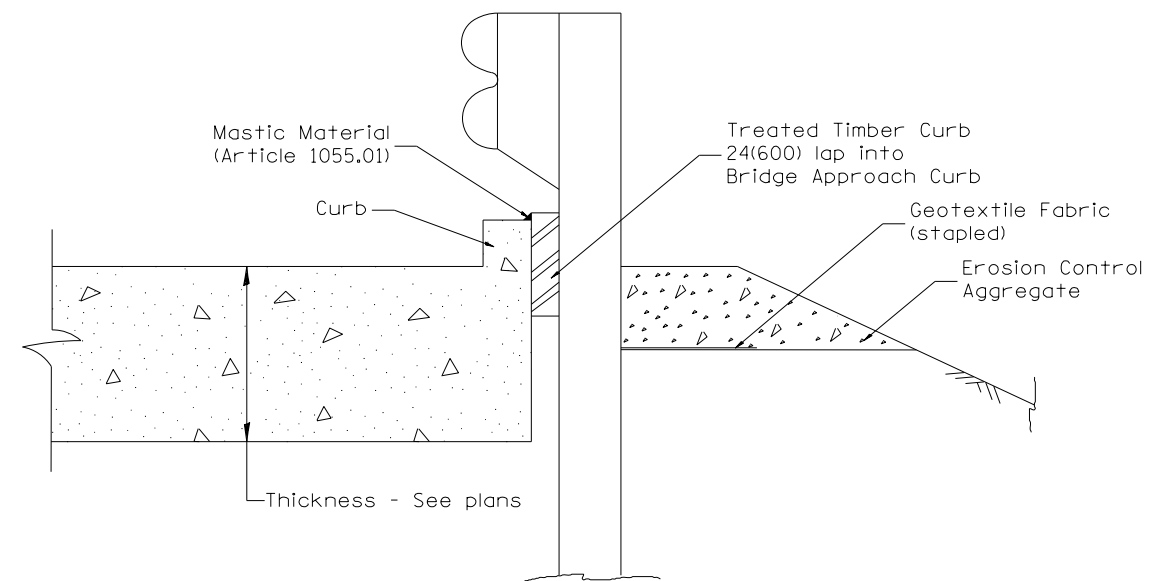

**SECTION A-A**  
**TYPICAL SECTION WITH EROSION CONTROL CURB**  
**AT BRIDGE APPROACH CURB**  
(STANDARD 609001 OR 609006)

**GUARDRAIL EROSION CONTROL TREATMENTS**

All dimensions are in inches (millimeters) unless otherwise noted.



USER NAME = \$USER*	DESIGNED -	REVISED -
PLOT SCALE = \$SCALE*	DRAWN -	REVISED -
PLOT DATE = \$DATE*	CHECKED -	REVISED -
	DATE - 11/2012	REVISED -

**STATE OF ILLINOIS**  
**DEPARTMENT OF TRANSPORTATION**

<b>DISTRICT 4 STANDARDS</b>		
<b>IL ROUTE 116</b>		
SCALE: N.T.S.	SHEET NO. 5 OF 11 SHEETS	STA. TO STA.

F.A.P. RTE.	SECTION	COUNTY	TOTAL SHEETS	SHEET NO.
665	(144-B-1)BR	FULTON	48	39
630101 PAGE 2 OF 2			CONTRACT NO. 68778	
ILLINOIS FED. AID PROJECT				