

WEST EDGE OF SHOULDER

Location	Station	Offset	Theoretical Grade Elevations	Theoretical Grade Elevations Adjusted for Grinding
N. End North Appr. Pav't.	211+92.43	16.50	665.55	665.57
A4	211+82.43	16.50	665.56	665.58
A3	211+72.43	16.50	665.56	665.58
S. End North Appr. Pav't.	211+62.43	16.50	665.57	665.59
N. End South Appr. Pav't.	210+71.58	16.50	665.60	665.62
A2	210+61.58	16.50	665.55	665.58
A1	210+51.58	16.50	665.51	665.53
S. End South Appr. Pav't.	210+41.58	16.50	665.46	665.48

WEST EDGE OF PAVEMENT

Location	Station	Offset	Theoretical Grade Elevations	Theoretical Grade Elevations Adjusted for Grinding
N. End North Appr. Pav't.	211+90.79	12.00	665.62	665.64
A4	211+80.79	12.00	665.63	665.65
A3	211+70.79	12.00	665.63	665.65
S. End North Appr. Pav't.	211+60.79	12.00	665.64	665.66
N. End South Appr. Pav't.	210+69.94	12.00	665.66	665.68
A2	210+59.94	12.00	665.61	665.64
A1	210+49.94	12.00	665.57	665.59
S. End South Appr. Pav't.	210+39.94	12.00	665.52	665.54

☉ STRUCTURE/☉ ROADWAY/ PROFILE GRADE LINE

Location	Station	Offset	Theoretical Grade Elevations	Theoretical Grade Elevations Adjusted for Grinding
N. End North Appr. Pav't.	211+86.43	0.00	665.80	665.82
A4	211+76.43	0.00	665.81	665.83
A3	211+66.43	0.00	665.81	665.84
S. End North Appr. Pav't.	211+56.43	0.00	665.82	665.84
N. End South Appr. Pav't.	210+65.57	0.00	665.82	665.84
A2	210+55.57	0.00	665.77	665.79
A1	210+45.57	0.00	665.73	665.75
S. End South Appr. Pav't.	210+35.57	0.00	665.68	665.70

EAST EDGE OF PAVEMENT

Location	Station	Offset	Theoretical Grade Elevations	Theoretical Grade Elevations Adjusted for Grinding
N. End North Appr. Pav't.	211+82.06	-12.00	665.63	665.65
A4	211+72.06	-12.00	665.63	665.65
A3	211+62.06	-12.00	665.64	665.66
S. End North Appr. Pav't.	211+52.06	-12.00	665.64	665.66
N. End South Appr. Pav't.	210+61.21	-12.00	665.62	665.64
A2	210+51.21	-12.00	665.57	665.59
A1	210+41.21	-12.00	665.53	665.55
S. End South Appr. Pav't.	210+31.21	-12.00	665.48	665.50

EAST EDGE OF SHOULDER

Location	Station	Offset	Theoretical Grade Elevations	Theoretical Grade Elevations Adjusted for Grinding
N. End North Appr. Pav't.	211+80.42	-16.50	665.56	665.58
A4	211+70.42	-16.50	665.56	665.59
A3	211+60.42	-16.50	665.57	665.59
S. End North Appr. Pav't.	211+50.42	-16.50	665.58	665.60
N. End South Appr. Pav't.	210+59.57	-16.50	665.55	665.57
A2	210+49.57	-16.50	665.50	665.52
A1	210+39.57	-16.50	665.45	665.47
S. End South Appr. Pav't.	210+29.57	-16.50	665.40	665.42

APPROACH SLAB STAGE CONSTRUCTION JOINT

Location	Station	Offset	Theoretical Grade Elevations	Theoretical Grade Elevations Adjusted for Grinding
N. End North Appr. Pav't.	211+85.64	-2.17	665.77	665.79
A4	211+75.64	-2.17	665.78	665.80
A3	211+65.64	-2.17	665.78	665.80
S. End North Appr. Pav't.	211+55.64	-2.17	665.79	665.81
N. End South Appr. Pav't.	210+64.79	-2.17	665.78	665.81
A2	210+54.79	-2.17	665.74	665.76
A1	210+44.79	-2.17	665.69	665.71
S. End South Appr. Pav't.	210+34.79	-2.17	665.64	665.66

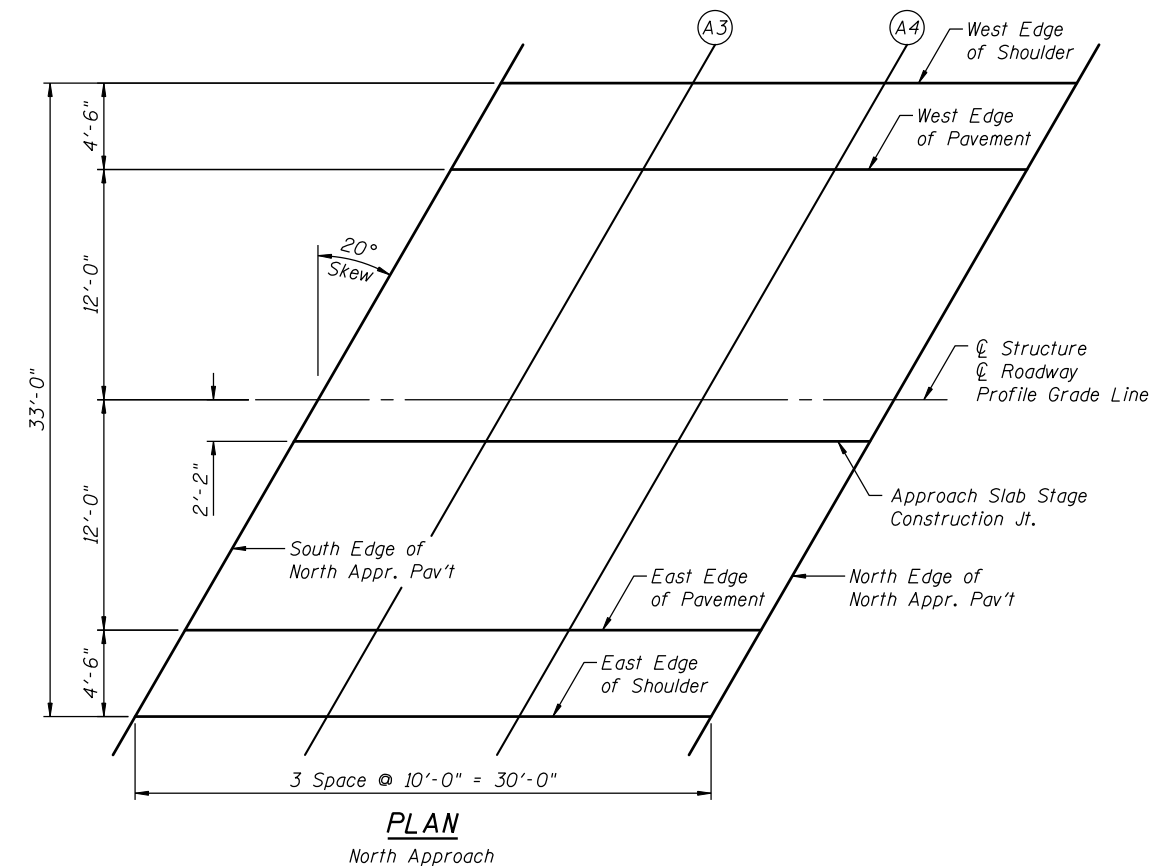
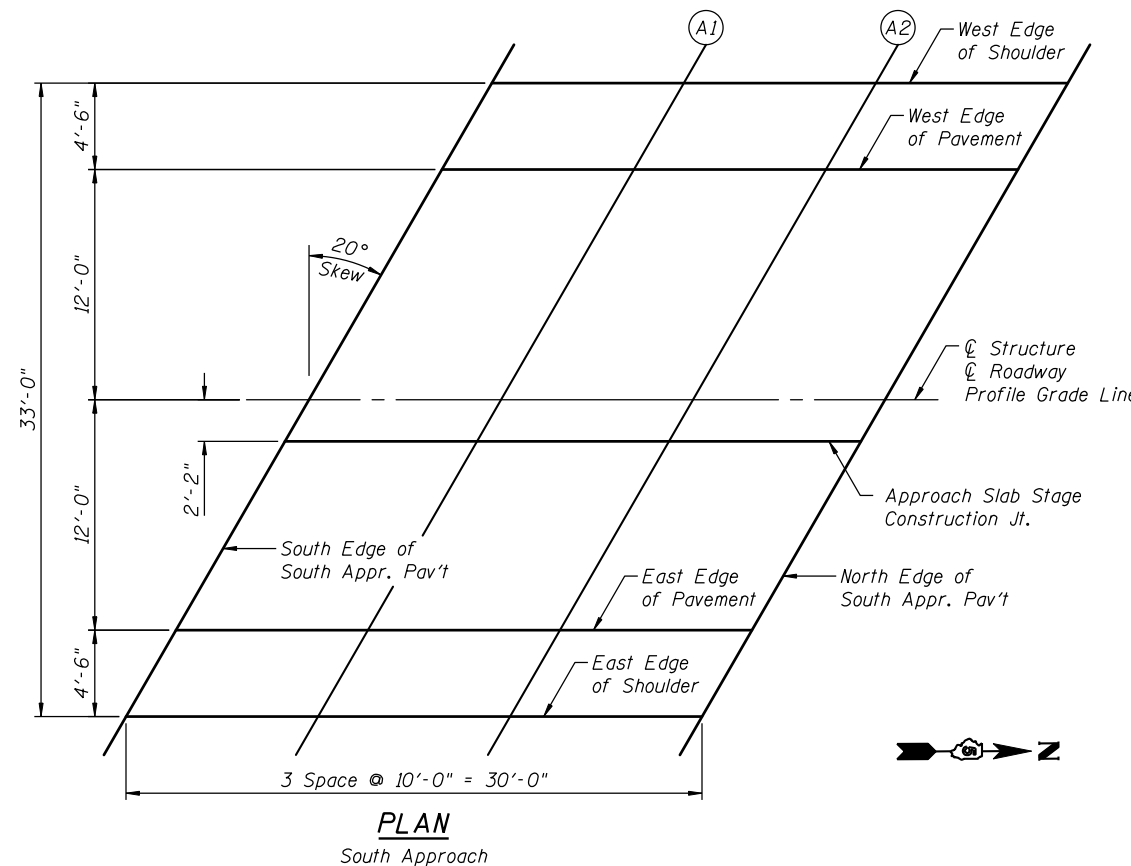

Note:
Approach Slab Stage Construction Joint is aligned with the Concrete Wearing Surface Construction Joint.

STATE OF ILLINOIS
DEPARTMENT OF TRANSPORTATION

TOP OF APPROACH SLAB ELEVATIONS
STRUCTURE NO. 092-0171

SHEET NO. 4 OF 16 SHEETS

F.A.P. RTE.	SECTION	COUNTY	TOTAL SHEETS	SHEET NO.
840	120BR-1	VERMILION	44	16
CONTRACT NO. 70615				

ILLINOIS FED. AID PROJECT

FILE NAME = s:\p1\6380--6395\6346\024\microa\finds\plans\structural\004-T00.dgn

1170 SOUTH HOUBOLT ROAD
JOLIET, ILLINOIS 60431
(815) 744-4200

USER NAME = rjgnd
DESIGNED RRD
CHECKED AJS
DRAWN BJF
PLOT SCALE =
PLOT DATE = 6/24/2011

DESIGNED RRD
CHECKED AJS
DRAWN BJF
CHECKED AJS

REVISED -
REVISED -
REVISED -
REVISED -

