

LOCATION MAP #2

(SHEET 1 OF 2)

F.A.I. ROUTE 74 (I-74) FROM NORTH OF I-55 BUSINESS LOOP TO EAST OF U.S. 51

MCLEAN COUNTY / URBAN INTERSTATE

(SEE DETAILED LOCATION MAP)

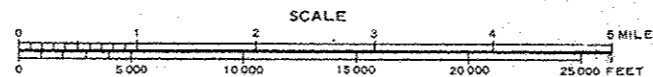
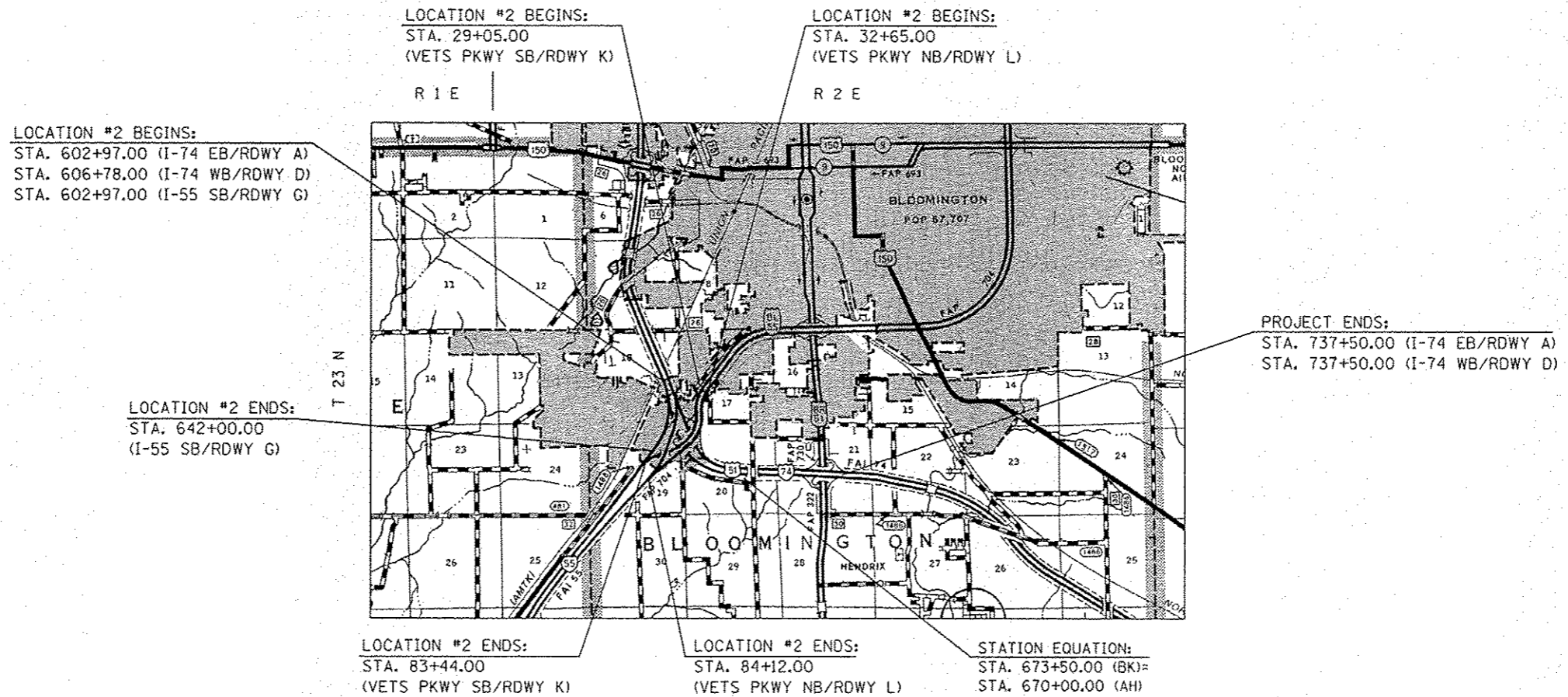

TOWNSHIP:
BLOOMINGTON

GROSS LENGTH OF LOCATION #2 = 22,853.00 FT. = 4.328 MILES (RDWAY A, G, L)
NET LENGTH OF LOCATION #2 = 22,381.31 FT. = 4.239 MILES (RDWAY A, G, L)

FILE NAME =	USER NAME = ppersonbr	DESIGNED -	REVISED -	STATE OF ILLINOIS DEPARTMENT OF TRANSPORTATION	LOCATION MAP #2			F.A. RTE.	SECTION	COUNTY	TOTAL SHEETS	SHEET NO.	
e:\p\work\p\widot\personbr\d333862\05	0901\shl-loc_maps.dgn	DRAWN -	REVISED -		SCALE: NONE	SHEET 1	OF 2	SHEETS	STA.	TO STA.	MCLEAN	26	4
		CHECKED -	REVISED -										
		DATE -	REVISED -										
	PLOT SCALE = 40.0000' / in.												
	PLOT DATE = 2/1/2013												
										CONTRACT NO. 70981			
										ILLINOIS FED. AID PROJECT			