

LOCATION MAP #4
F.A.P. ROUTE 697 (IL. 9)
FROM ECL OF HOOPESTON TO INDIANA STATE LINE
VERMILION COUNTY /RURAL 2 LANE

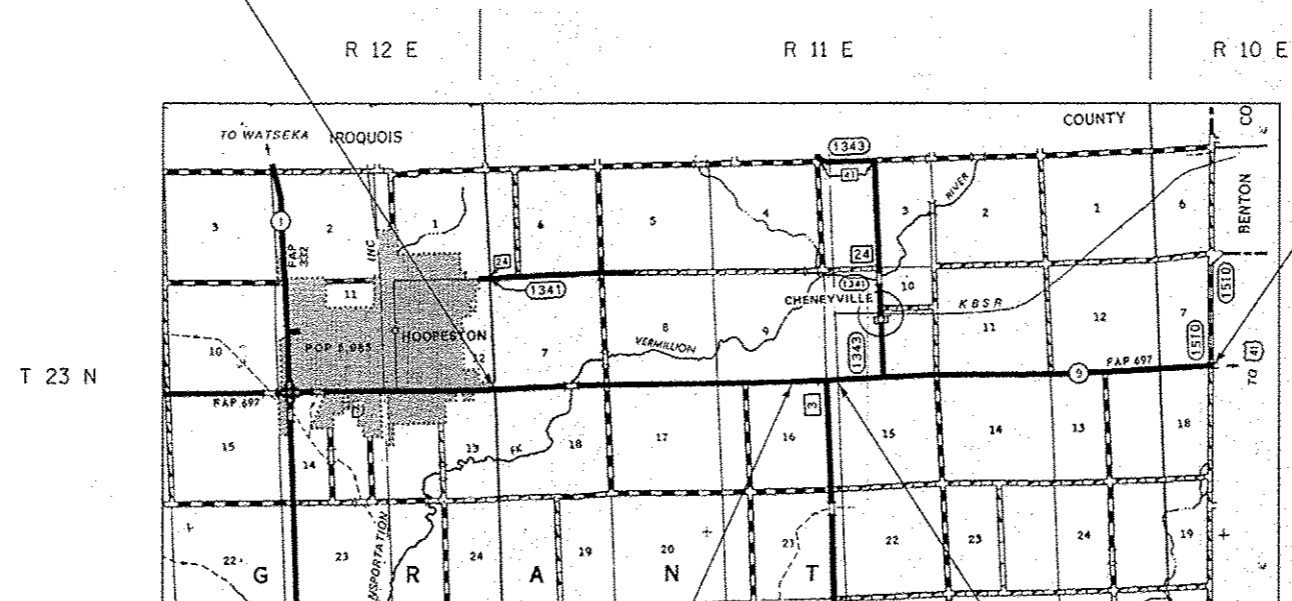

LOCATION #4 BEGINS:
 STA. 1207+00.00

LOCATION #4 ENDS:
 STA. 1552+29.35



STATION EQUATION:
 STA. 1359+99.91 (BK) =
 STA. 1359+99.69 (AH)

RAILROAD OMISSION:
 STA. 1372+05.00 TO
 STA. 1373+05.00

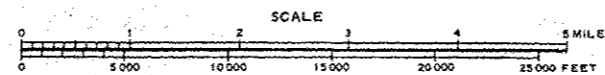

TOWNSHIP:
 GRANT

GROSS LENGTH OF LOCATION #4 = 34,529.57 FT = 6.540 MILES
NET LENGTH OF LOCATION #4 = 34,429.57 FT = 6.521 MILES

• D5 CRACK & JOINT SEAL 2013-2

FILE NAME :	USER NAME : bakerc	DESIGNED -	REVISED -	STATE OF ILLINOIS DEPARTMENT OF TRANSPORTATION	LOCATION MAP #4	F.A.P. RTE. VAR.	SECTION	COUNTY	TOTAL SHEETS	SHEET NO.
ct:\p\work\p\idat\bakerc-14032761-0570	102+ah\location map.dgn	DRAWN -	REVISED -					VARIES	36	6
#MODELNAME#	PLOT SCALE = 40.0000 1/1 in.	CHECKED -	REVISED -		SCALE:	SHEET 1	OF 1	SHEETS	STA.	TO STA.
	PLOT DATE = 1/29/2013	DATE -	REVISED -							
									ILLINOIS FED. AID PROJECT CONTRACT NO. 70982	