

LOCATION MAP #6
F.A.P. ROUTE 323 (U.S. 36)
FROM MOULTRIE COUNTY LINE TO U.S. 45 OVERPASS
DOUGLAS & PIATT COUNTY /RURAL 2 LANE

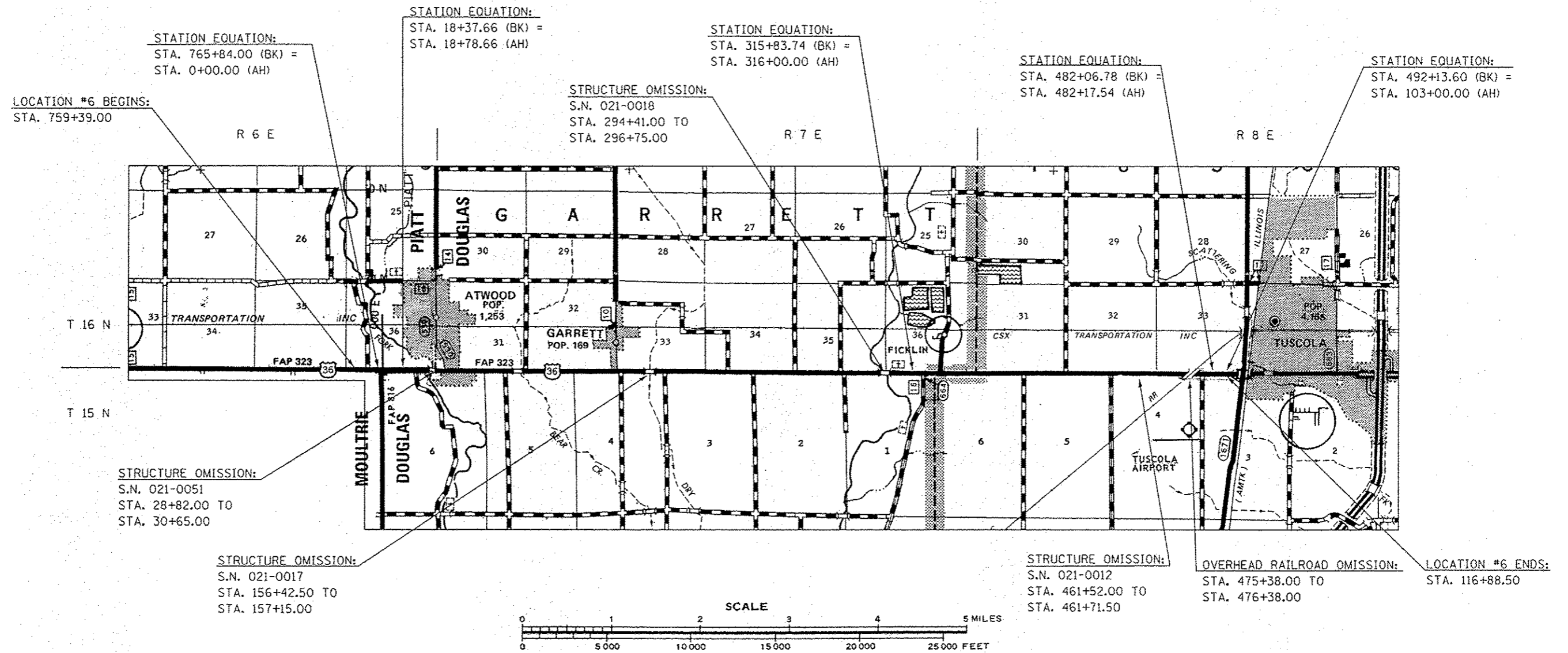

GROSS LENGTH OF LOCATION #6 = 51,179.08 FT = 9.693 MILES
NET LENGTH OF LOCATION #6 = 50,570.08 FT = 9.578 MILES

TOWNSHIP:
 TUSCOLA & GARRETT

• D5 CRACK & JOINT SEAL 2013-2

FILE NAME :	USER NAME : baker	DESIGNED -	REVISED -	STATE OF ILLINOIS	LOCATION MAP #6	F.A. RTE.:	SECTION:	COUNTY:	TOTAL SHEETS:	SHEET NO.:
cs:\pwork\p\sidot\baker\108327161\0570	02-sht-location map.dgn	DRAWN -	REVISED -	DEPARTMENT OF TRANSPORTATION	SCALE:	VAR.	*	VARIABLES	36	8
#MODELNAME#	PLOT SCALE = 40,0000' / 1"	CHECKED -	REVISED -		SHEET 1 OF 1 SHEETS			CONTRACT NO. 70982		
	PLOT DATE = 1/29/2013	DATE -	REVISED -		STA. TO STA.			ILLINOIS FED. AID PROJECT		