

**LOCATION #1**

FAP 749 (IL 133)  
DOUGLAS COUNTY

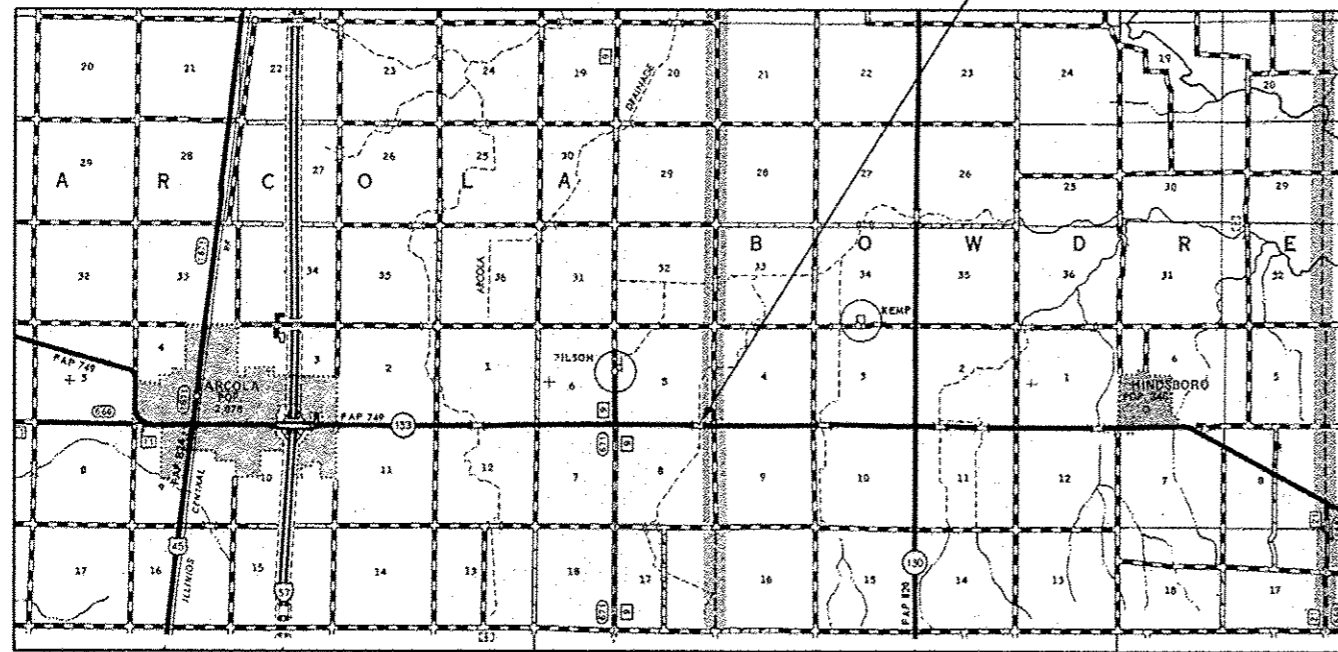

S.N. 021-8028  
LOCATION #1  
STA. 232 + 51



R 8 E

R 9 E

R 10 E

T 15 N

T 14 N

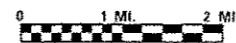

**LOCATION #1**

PROJECT BEGINS STA. 232 + 45.5  
PROJECT ENDS STA. 232 + 56.5

**LOCATION #2**

FAP 332 (IL 1)  
VERMILION COUNTY



S.N. 092-0130  
LOCATION #2  
STA. 927 + 68.66

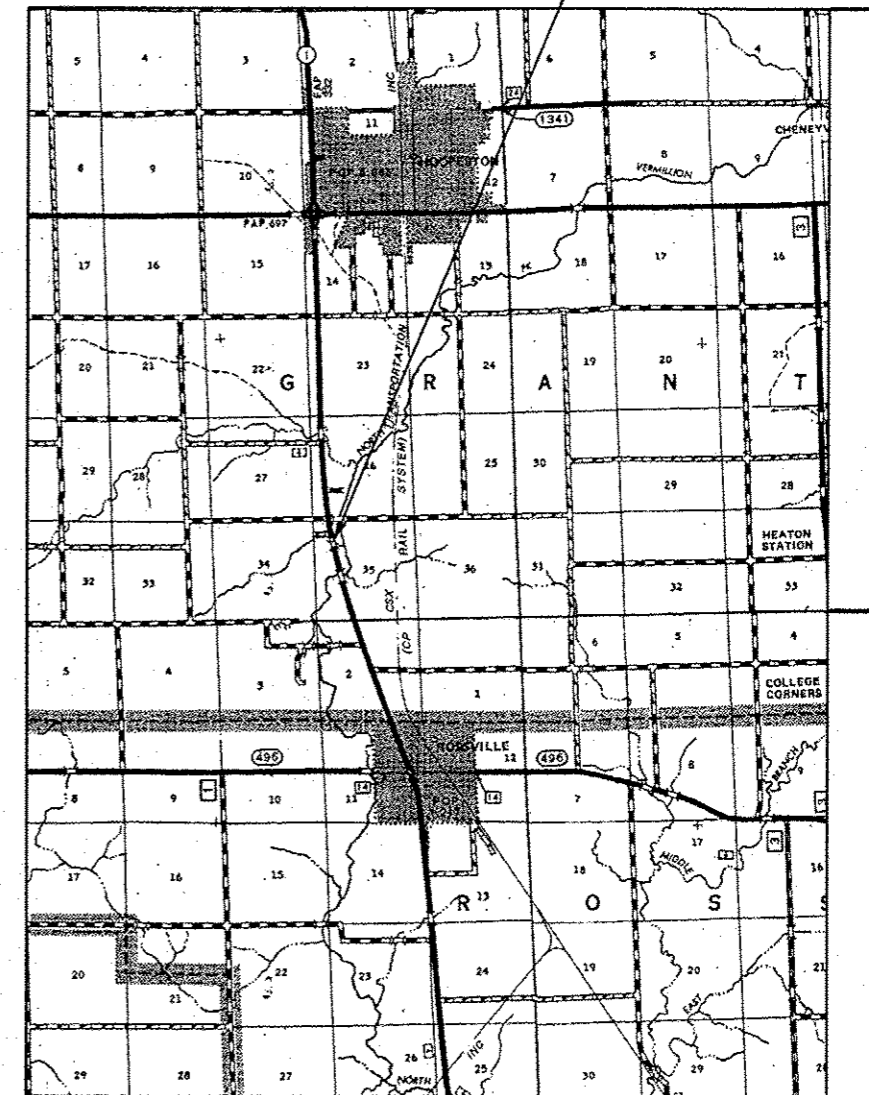

R 12 W

R 11 W

T 24 N

T 23 N

T 22 N



**LOCATION #2**

PROJECT BEGINS STA. 927 + 56.66  
PROJECT ENDS STA. 927 + 80.66

\* ROUTES FAP 749 (IL 133) & FAP 332 (IL 1)  
\*\* POSTING MITIGATION FY2013-1  
\*\*\* DOUGLAS / VERMILION

FILE NAME *	USER NAME * Joynef	DESIGNED -	REVISED -
ci:\pwork\pvidot\joynef\10318412\0578\11-ah\cover.dgn		DRAWN - DFJ	REVISED -
		CHECKED -	REVISED -
		DATE - 12/20/12	REVISED -

STATE OF ILLINOIS  
DEPARTMENT OF TRANSPORTATION

LOCATION MAPS

SCALE: SHEET NO. 01 OF 01 SHEETS STA. TO STA.

F.A. RTE.	SECTION	COUNTY	TOTAL SHEETS	SHEET NO.
*	**	***	17	2
			CONTRACT NO. 70A11	
ILLINOIS FED. AID PROJECT				