

SCALE:
 1"=30' FULL SIZE SHEET
 1"=60' QUARTER SIZE SHEET

NOTES:
 THE PROPOSED E.O.P. STRIPING IS NOT SHOWN ON THIS PLAN SHEET. SEE THE PROPOSED PAVEMENT MARKING SHEETS AND SCHEDULES FOR MARKING LOCATIONS.
 THE WIDTH OF PROPOSED HMA SHOULDERS IS 4' UNLESS OTHERWISE STATED WITHIN THESE PLANS.
 THE WIDTH OF PROPOSED AGGREGATE SHOULDERS IS 4' UNLESS OTHERWISE STATED WITHIN THESE PLANS.
 SEE SIDEROAD AND ENTRANCE DETAILS SCHEDULES FOR THEIR PROPOSED IMPROVEMENTS.
 SEE HIGHWAY STD. 642006 AND THE SCHEDULE OF QUANTITIES FOR THE PLACEMENT OF PROPOSED SHOULDER RUMBLE STRIPS.

=====
 = PROPOSED REMOVAL OF EXISTING HMA SHOULDERS IS INCLUDED IN THE COSTS FOR "EXCAVATING AND GRADING EXISTING SHOULDERS".
 REMOVAL WIDTH = 1'-6"
 REMOVAL DEPTH = 6 1/2" OR 8" (SEE TYPICAL CROSS SECTIONS AND SCHEDULES FOR SPECIFIED DEPTH LOCATIONS.)

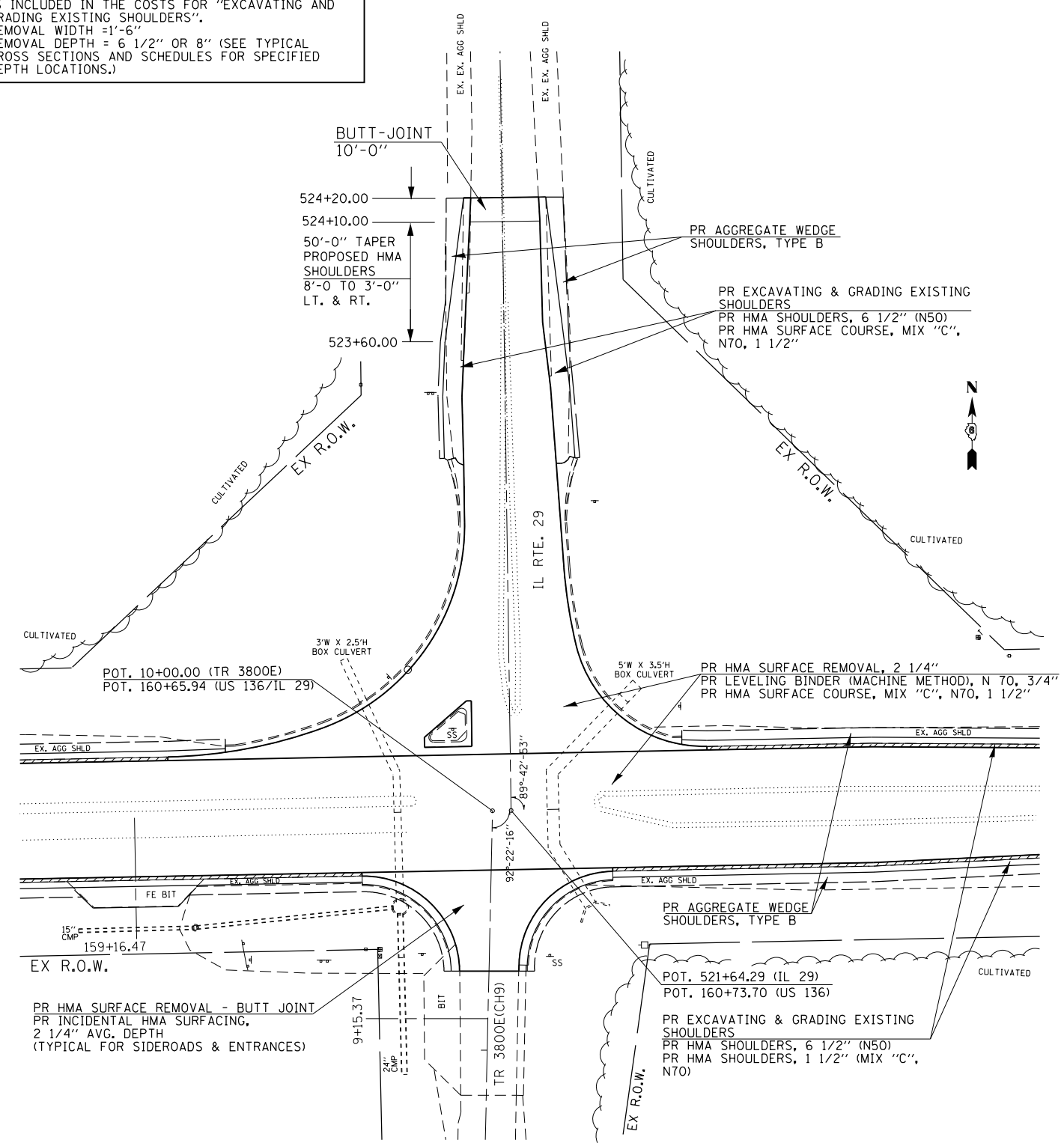
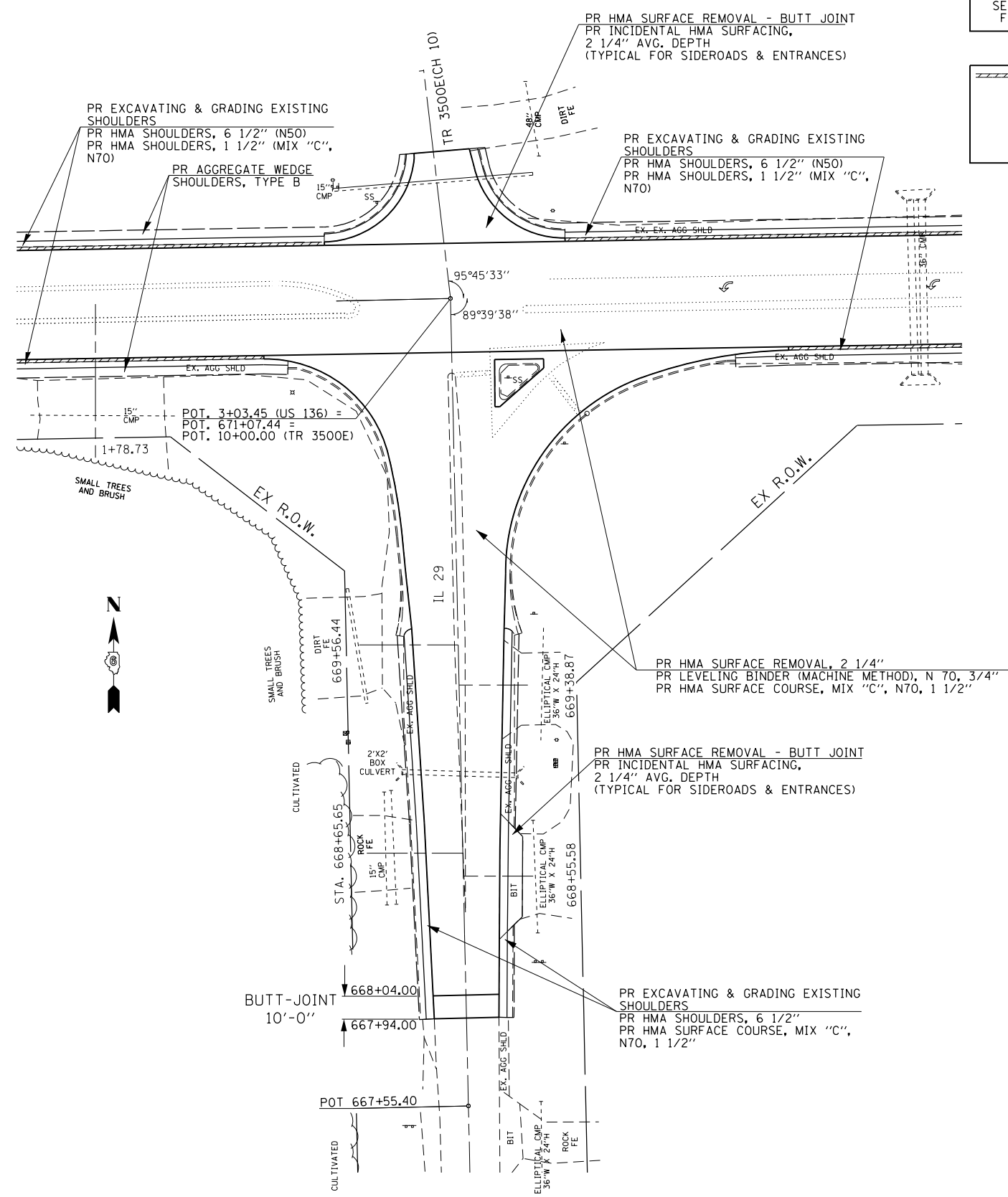

FILE NAME =	USER NAME = sparksgw	DESIGNED - ML	REVISED - RTS
Default	Plot Date = Dec-14-2012 12:00:59PM	CHECKED - RTS	REVISED -

**STATE OF ILLINOIS
 DEPARTMENT OF TRANSPORTATION**

PLAN SHEET			
SCALE:	SHEET 18	OF 18 SHEETS	STA. TO STA.

F.A.P. RTE.	SECTION	COUNTY	TOTAL SHEETS	SHEET NO.
315	.	MASON	62	48
CONTRACT NO. 72E03				
ILLINOIS FED. AID PROJECT				

-- (HRS-2, (124)RS-3, (116)RS