

F.A.P. RTE.	SECTION	COUNTY	TOTAL SHEETS	SHEET NO.
662		SANGAMON	28	1
		ILLINOIS	CONTRACT NO. 72F72	

\* (H)RS-10, (C)RS-9, (P)RS-7

\*\* 28+1 = 29

## INDEX OF SHEETS

- 1 COVER SHEET
- 2 GENERAL NOTES
- 3, 4 SUMMARY OF QUANTITIES
- 5, 6 SCHEDULES OF QUANTITIES
- 7-11 TYPICAL CROSS SECTIONS
- 12-21 PLAN SHEETS
- 22 SUPERELEVATION DETAILS
- 23 CENTERLINE RUMBLE STRIP DETAIL
- 24, 25 SIDE ROAD DETAILS
- 26 BUTT-JOINT DETAILS
- 27 CULVERT EXTENSION DETAILS
- 28 CULVERT CROSS SECTIONS

## STANDARDS

701201-04	701501-06
701301-04	701901-03
701306-03	780001-03
701311-03	781001-03

ADT: 6900 (2011)  
 PV 91.3%  
 SU 6.1%  
 MU 2.6%

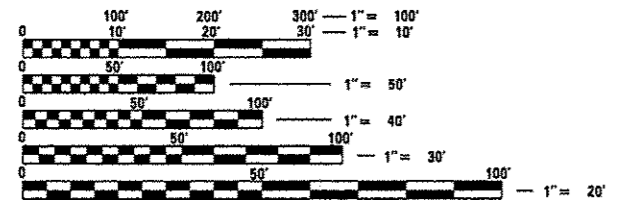

FULL SIZE PLANS HAVE BEEN PREPARED USING STANDARD ENGINEERING SCALES. REDUCED SIZED PLANS WILL NOT CONFORM TO STANDARD SCALES. IN MAKING MEASUREMENTS ON REDUCED PLANS, THE ABOVE SCALES MAY BE USED.

J.U.L.I.E.  
 JOINT UTILITY LOCATION INFORMATION FOR EXCAVATION  
 1-800-892-0123  
 OR 811

SENIOR TEAM ENGINEER: VINCE MADONIA (217)785-9046  
 TEAM ENGINEER: JULIET SHOULTZ (217)785-2739  
 CONTRACT NO. 72F72

# STATE OF ILLINOIS DEPARTMENT OF TRANSPORTATION DIVISION OF HIGHWAYS

## PROPOSED HIGHWAY PLANS

FAP ROUTE 662 (IL 4)  
 SECTION (H)RS-10, (C)RS-9, (P)RS-7  
 PROJECT ACF-0662(068)  
 PPP RESURFACING, MAINLINE & SHOULDERS  
 SANGAMON COUNTY  
 C-96-004-13

D-96-004-13

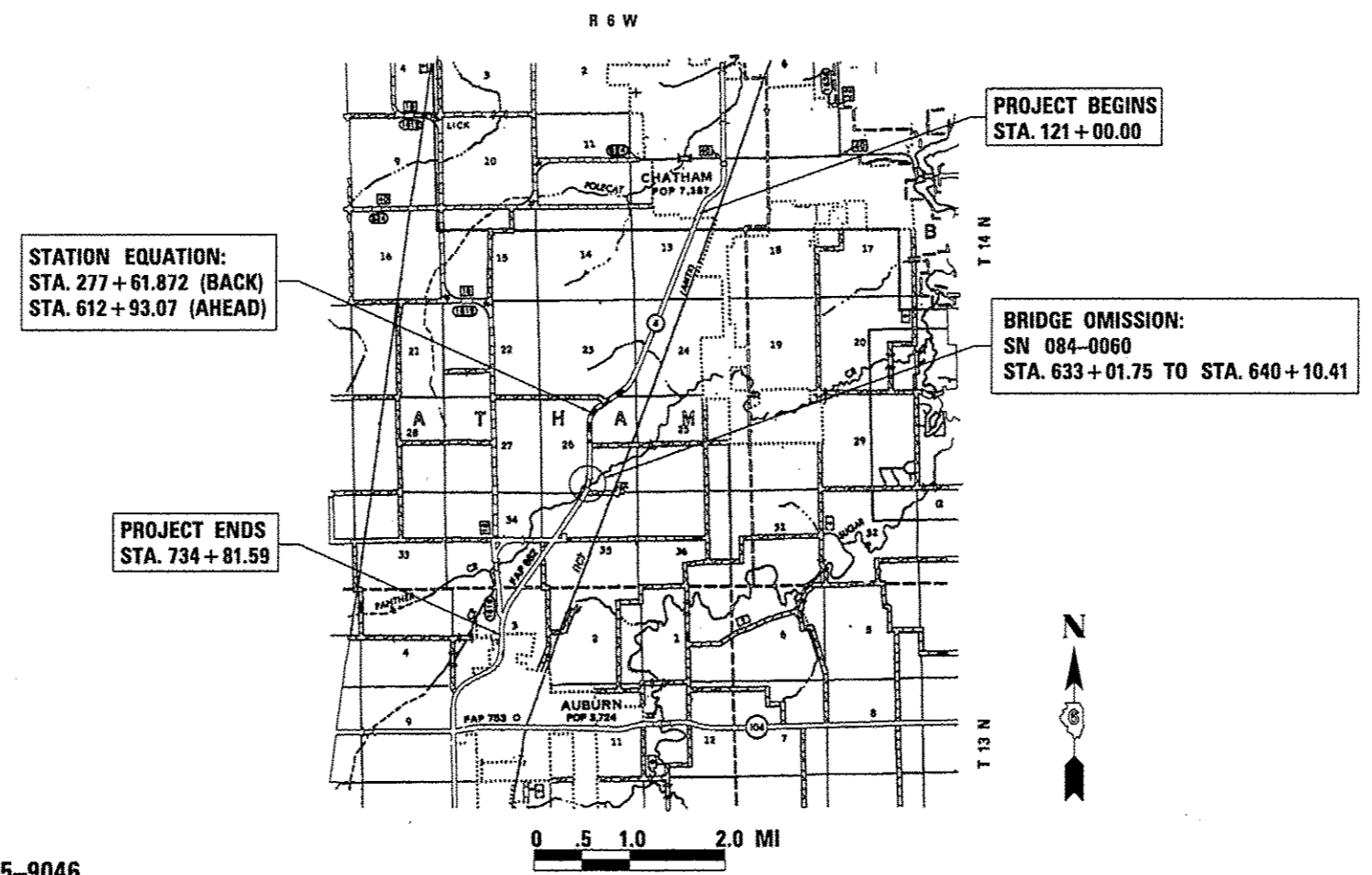

STATE OF ILLINOIS  
 DEPARTMENT OF TRANSPORTATION  
 DIVISION OF HIGHWAYS

SUBMITTED October 20 12  
Royan L. Driskell  
 DEPUTY DIRECTOR OF HIGHWAYS, REGION ENGINEER

Dec 7 20 12  
John D. Baranzelli, P.E.  
 acting ENGINEER OF DESIGN AND ENVIRONMENT

Dec 7 20 12  
William R. Frey, Jr.  
 acting DIRECTOR OF HIGHWAYS, CHIEF ENGINEER

PRINTED BY THE AUTHORITY  
 OF THE STATE OF ILLINOIS