

STA. 793+10 LT.
 EXIST. 18" PIPE
 EXIST. DOUBLE GUTTER OUTLET W/ 2
 TY. B GRATE, STD. 1795 (MOD.)
 PROP. CONSTRUCT DOUBLE OUTLET FOR
 TY. 2B GUTTER, STD. 606211-03 (MOD.)
 SEE SHEET NO. 19

STA. 811+80 LT.
 EXIST. 18" PIPE CULV.
 EXIST. TY 10 FR & GRATE PLUG DROP
 INLET RT. SPBGR
 PROP. CONSTRUCT DOUBLE OUTLET FOR
 TY. 2B GUTTER, STD. 606211-03 (MOD.)
 USFL: 588.52
 DSFL: 576.72
 SEE SHEET NO. 15

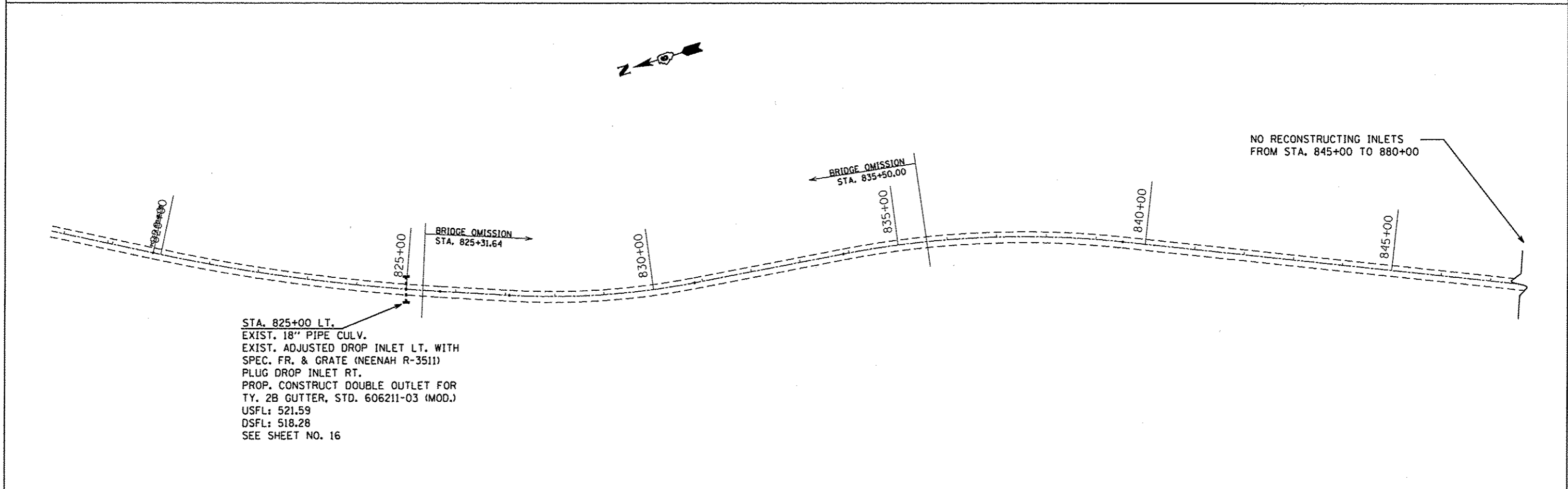

STA. 825+00 LT.
 EXIST. 18" PIPE CULV.
 EXIST. ADJUSTED DROP INLET LT. WITH
 SPEC. FR. & GRATE (NEENAH R-3511)
 PLUG DROP INLET RT.
 PROP. CONSTRUCT DOUBLE OUTLET FOR
 TY. 2B GUTTER, STD. 606211-03 (MOD.)
 USFL: 521.59
 DSFL: 518.28
 SEE SHEET NO. 16

NO RECONSTRUCTING INLETS
 FROM STA. 845+00 TO 880+00

BRIDGE OMISSION
 STA. 835+50.00

BRIDGE OMISSION
 STA. 825+31.64

FILE NAME =	USER NAME = shahdm	DESIGNED -	REVISED -	STATE OF ILLINOIS DEPARTMENT OF TRANSPORTATION	DRAINAGE PLANS			F.A.P. RTE.	SECTION	COUNTY	TOTAL SHEETS	SHEET NO.
c:\pwwork\pwwork\shahdm\08316114\06xxxx	shh-details.dgn	DRAWN - DMS	REVISED -					510	(120)T	HANCOCK	28	7
PLOT SCALE = N/A		CHECKED -	REVISED -		CONTRACT NO. 72F73			ILLINOIS FED. AID PROJECT				
PLOT DATE = Nov-28-2012 10:00:19AM		DATE -	REVISED -		SCALE: N/A	SHEET 2	OF 6 SHEETS	STA. 789+00	TO STA. 890+00			