

PLAN	SURVEYED	DATE
	PLOTTED	
	GRADES CHECKED	
	STRUCTURE NOTATIONS CHECKED	
	NO. _____	

PROFILE	SURVEYED	DATE
	PLOTTED	
	GRADES CHECKED	
	STRUCTURE NOTATIONS CHECKED	
	NO. _____	

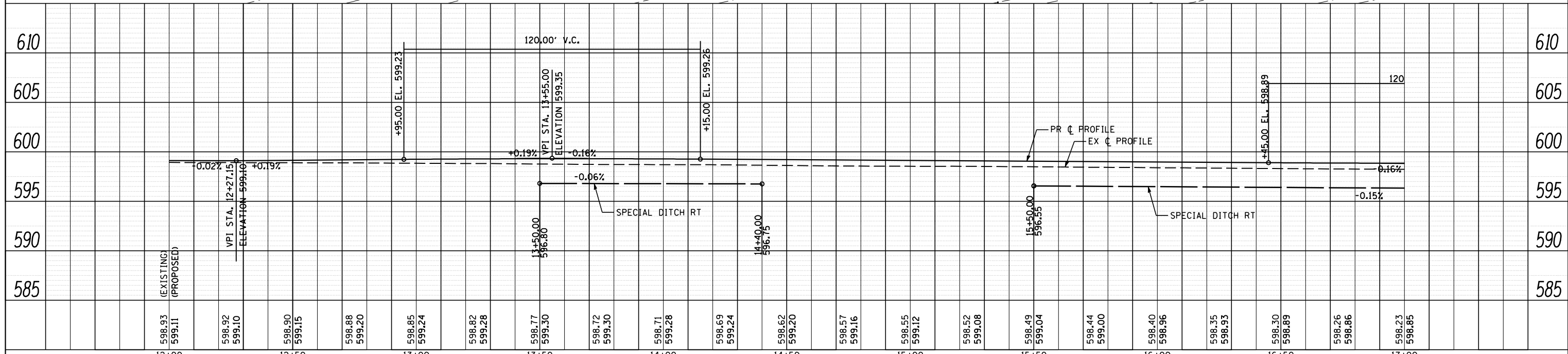
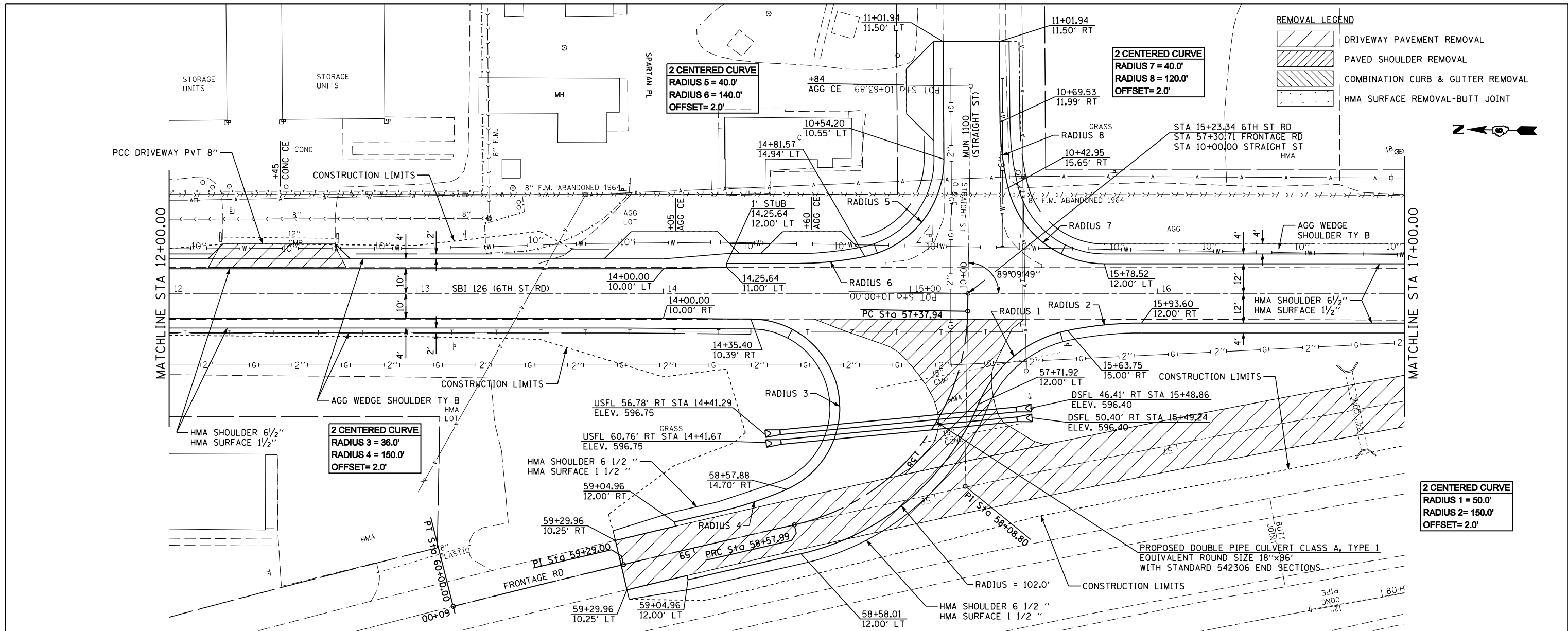

<b>CEC</b> Cummins Engineering Corporation Civil and Structural Engineering	JOB = 2265.11	DESIGNED - NAK	REVISED -	<b>STATE OF ILLINOIS</b> <b>DEPARTMENT OF TRANSPORTATION</b>	<b>PLAN AND PROFILE SHEET</b> <b>SBI 126 (6TH STREET ROAD)</b>	S.B.I. RTE. 126	SECTION (110) I-2	COUNTY SANGAMON	TOTAL SHEETS 93	SHEET NO. 30
	FILE NAME = D672F74-sh1-pln.dgn	DRAWN - SJS	REVISED -			SCALE: SHEET OF SHEETS STA. 12+00 TO STA. 17+00	FED. ROAD DIST. NO. ILLINOIS	FED. AID PROJECT		
	PLOT SCALE = 40.0000' / IN.	CHECKED - NAK	REVISED -					CONTRACT NO. 72F74		
	PLOT DATE = 2/4/2013	DATE - 10/8/2012	REVISED -							