

AA— STA 2164+00 (S.N. 001-7065)
EX 11' x 5' RCBC
(NO IMPROVEMENTS)

- A— STA 2164+91.3, 1.1' RT
REMOVE EX INLET
PLUG EX CULVERT
- B— EX C&G / MEDIAN SURFACE REMOVAL
PR CONC MEDIAN SURFACE, 4"
PR C&G, TY M-4.06 (BOTH SIDES)
- C— EX MEDIAN REMOVAL
PR SOLID CONC MEDIAN, TY SM-4.06 (6' RAMPED NOSE)
- D— EX MEDIAN REMOVAL
PR PCC BSE CSE, 11 1/4"
PR HMA SURFACING, 3 3/4"
- E— EX PVMT REMOVAL
PR PCC BSE CSE, 11 1/4"
PR HMA SURFACING, 3 3/4"
- F— EX MEDIAN REMOVAL
PR SOLID CONC MEDIAN, TY SM-4.06
- G— EX C&G / MEDIAN SURFACE REMOVAL
PR SOLID CONC MEDIAN, TY SM-4.06
- H— EX C&G / MEDIAN SURFACE REMOVAL
PR CONC MEDIAN SURFACE, 4"
PR C&G, TY M-4.06 (BOTH SIDES)
(SEE SHT 22 FOR LAYOUT INFORMATION)

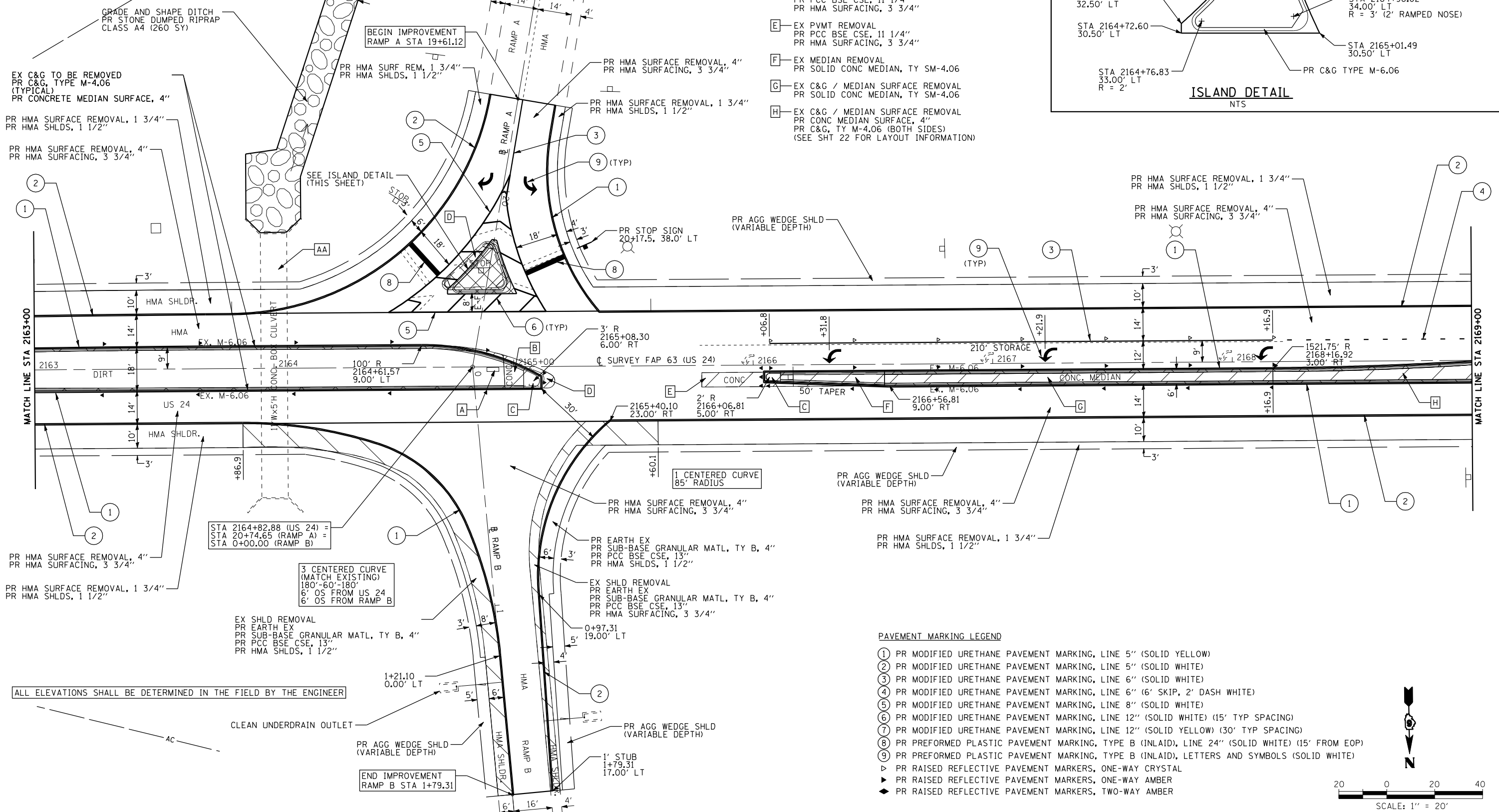

- PAVEMENT MARKING LEGEND**
- ① PR MODIFIED URETHANE PAVEMENT MARKING, LINE 5" (SOLID YELLOW)
 - ② PR MODIFIED URETHANE PAVEMENT MARKING, LINE 5" (SOLID WHITE)
 - ③ PR MODIFIED URETHANE PAVEMENT MARKING, LINE 6" (SOLID WHITE)
 - ④ PR MODIFIED URETHANE PAVEMENT MARKING, LINE 6" (6' SKIP, 2' DASH WHITE)
 - ⑤ PR MODIFIED URETHANE PAVEMENT MARKING, LINE 8" (SOLID WHITE)
 - ⑥ PR MODIFIED URETHANE PAVEMENT MARKING, LINE 12" (SOLID WHITE) (15' TYP SPACING)
 - ⑦ PR MODIFIED URETHANE PAVEMENT MARKING, LINE 12" (SOLID YELLOW) (30' TYP SPACING)
 - ⑧ PR PREFORMED PLASTIC PAVEMENT MARKING, TYPE B (INLAID), LINE 24" (SOLID WHITE) (15' FROM EOP)
 - ⑨ PR PREFORMED PLASTIC PAVEMENT MARKING, TYPE B (INLAID), LETTERS AND SYMBOLS (SOLID WHITE)
 - ▷ PR RAISED REFLECTIVE PAVEMENT MARKERS, ONE-WAY CRYSTAL
 - ▶ PR RAISED REFLECTIVE PAVEMENT MARKERS, ONE-WAY AMBER
 - ◆ PR RAISED REFLECTIVE PAVEMENT MARKERS, TWO-WAY AMBER

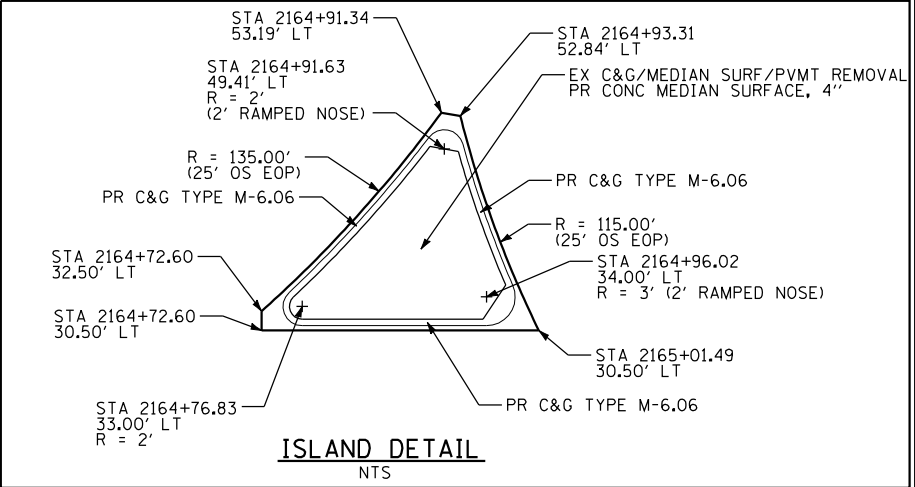
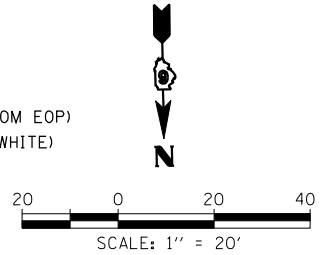

FILE NAME =	USER NAME = ebb	DESIGNED -	REVISED -	STATE OF ILLINOIS DEPARTMENT OF TRANSPORTATION	PLAN SHEET	F.A.P. RTE.	SECTION	COUNTY	TOTAL SHEETS	SHEET NO.
q:\08files\080224\wo 2 - us 24 over frazier creek - roadway plans\us 24 & 1-172\code\DRAWN\0672F76-sht-plan02.dgn		CHECKED -	REVISED -			63	(1)RS-6	ADAMS	24	18
PLOT SCALE = 40.0000' / IN.		DATE -	REVISED -			CONTRACT NO. 72F76				
PLOT DATE = 10/16/2012						FED. ROAD DIST. NO. 6 ILLINOIS FED. AID PROJECT				